

**PLEASE NOTE:**

- FURTHER INVESTIGATION REQUIRED TO ASCERTAIN TRUE EXTENT OF COLUMNS AS HIGHLIGHTED ON THE PLANS.
- SIGNS OF WATER DAMAGE/ DAMP IN BASEMENT AT LOW LEVEL.
- EXISTING SHOP FRONT DOORS HAVE A STEPPED THRESHOLD.
- VENT LOCATED NEAR THE SHOP FRONT BETWEEN GROUND AND BASEMENT.

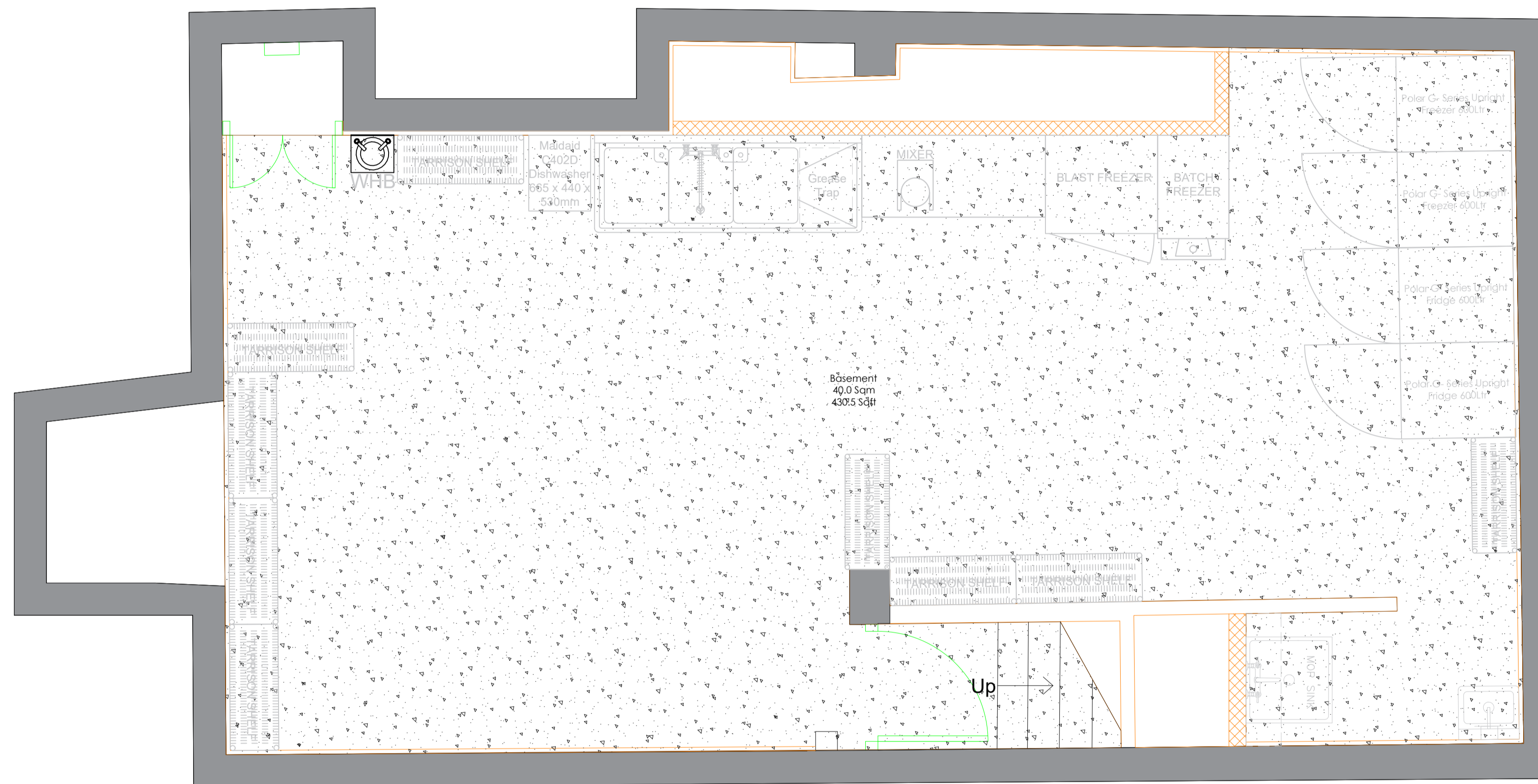

TOTAL SEAT COUNT - 20

SOLID WALLS

NEW PARTITION WALLS

Proposed Basement Floor Finishes  
Scale 1:25 @ A1

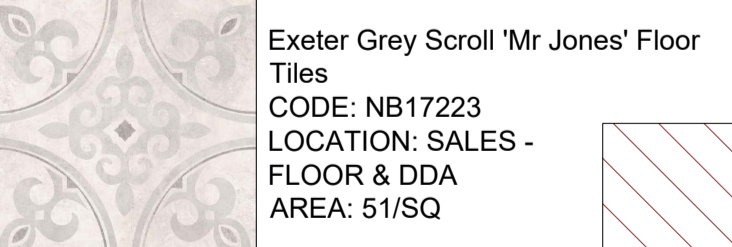
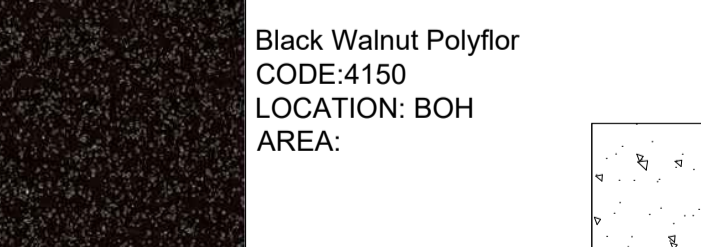
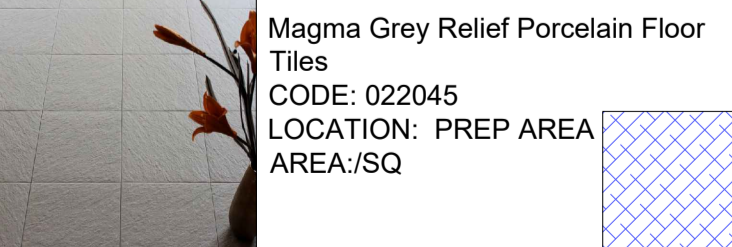
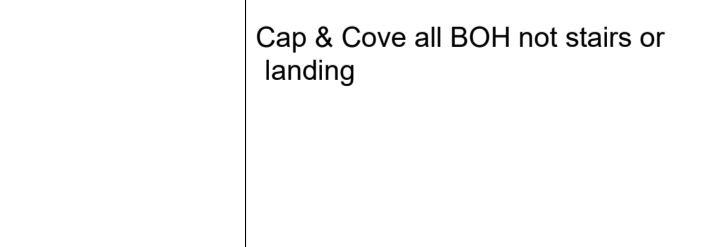
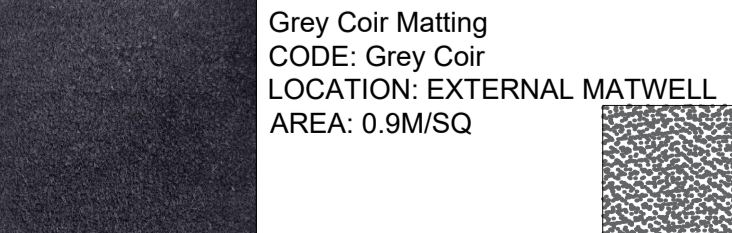
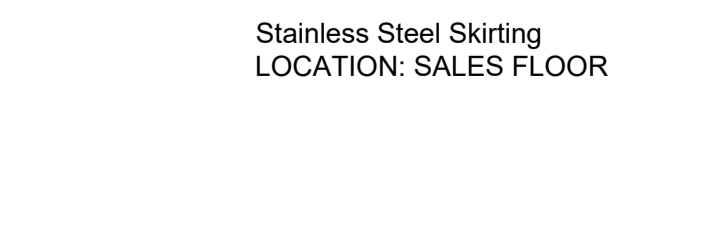
FLOOR KEY	
 <p>Exeter Grey Scroll 'Mr Jones' Floor Tiles CODE: NB17223 LOCATION: SALES - FLOOR &amp; DDA AREA: 51/SQ</p>	 <p>Black Walnut Polyflor CODE:4150 LOCATION: BOH AREA:</p>
 <p>Magma Grey Relief Porcelain Floor Tiles CODE: 022045 LOCATION: PREP AREA AREA:/SQ</p>	 <p>Cap &amp; Cove all BOH not stairs or landing</p>
 <p>Grey Coir Matting CODE: Grey Coir LOCATION: EXTERNAL MATWELL AREA: 0.9M/SQ</p>	 <p>Stainless Steel Skirting LOCATION: SALES FLOOR</p>

**GENERAL NOTES**

1. ALL WORKS WITHIN THIS DOCUMENT TO BE INSTALLED/CARRIED OUT IN COMPLIANCE WITH THE LATEST BUILDING REGULATIONS AND BRITISH STANDARDS.
2. CONTRACTOR TO CHECK AND VERIFY ALL ON-SITE DIMENSIONS PRIOR TO MANUFACTURE/INSTALLATION AND MUST REPORT ANY DISCREPANCIES BACK TO RETAIL DESIGN SOLUTIONS. FAILURE TO DO SO WILL BE AT THE CONTRACTOR'S EXPENSE.
3. THIS DRAWING MUST NOT BE SCALED. WORK TO DIMENSIONS ONLY.
4. ANY CONSTRUCTION/WORKING DRAWINGS IN THIS DOCUMENT ARE INDICATIVE ONLY. IT IS THE RESPONSIBILITY OF THE CONTRACTOR TO ENSURE THEY ARE FIT FOR PURPOSE, AND TO MAKE AMENDMENTS WHERE NECESSARY PRIOR TO INSTALLATION.
5. THE CONTENTS OF THIS DOCUMENT ARE THE PROPERTY OF RETAIL DESIGN SOLUTIONS. IT IS NOT TO BE COPIED OR DISTRIBUTED IN WHOLE OR PART WITHOUT FORMAL CONSENT.

DATE	NOTES
30.03.22	EXISTING LAYOUTS PRODUCED
01.04.22	PROPOSED LAYOUTS PRODUCED

PROJECT: CREPE DELICIOUS

ADDRESS:  
89 LEATHER LANE  
CENTRAL LONDON  
EC1N 7TS

PROPOSED  
BASEMENT  
FLOOR  
FINISHES

SCALE: 10.2 1:50 @ A1

DATE: 30.03.22

CLIENT: Crêpe Delicious



DRAWN BY:



The Mill Store, Foundry Lane, Earls Colne, Essex, CO6 2SB  
Tel. 01787 224878

**PROPOSED GROUND FLOOR FINISHES NOTES**

- General**
- PC to confirm dimensions prior to ordering.
  - PC to ensure all installation is completed in the relevant order and does not interfere with any additional works.
  - PC to ensure all access points remain accessible during and after installation of equipment.

- Flooring**
- PC to see floor finishes for clarification of where to source and who to supply and fix.
  - PC to ensure flooring is prepared suitably to accept proposed flooring.
  - PC to supply and fit sunken matwell at store entrance including trim.
  - All proposed flooring to be sealed with relevant sealant and to ensure all floor finishes are flush.
  - Flooring contractor to supply and install transitional strips between floor changes.
  - Flooring contractor to ensure wooden floor is laid in the direction as shown on the plan.
  - PC to install 100mm upstand skirting 40mm deep to be installed and finished in suitable black finish.