

GENERAL NOTES

1. ALL WORKS WITHIN THIS DOCUMENT TO BE INSTALLED/CARRIED OUT IN COMPLIANCE WITH THE LATEST BUILDING REGULATIONS AND BRITISH STANDARDS.
2. CONTRACTOR TO CHECK AND VERIFY ALL ON SITE DIMENSIONS PRIOR TO MANUFACTURE/INSTALLATION AND MUST REPORT ANY DISCREPANCIES BACK TO RETAIL DESIGN SOLUTIONS. FAILURE TO DO SO WILL BE AT THE CONTRACTORS EXPENSE.
3. THIS DRAWING MUST NOT BE SCALED. WORK TO DIMENSIONS ONLY.
4. ANY CONSTRUCTION/WORKING DRAWINGS IN THIS DOCUMENT ARE INDICATIVE ONLY. IT IS THE RESPONSIBILITY OF THE CONTRACTOR TO ENSURE THEY ARE FIT FOR PURPOSE, AND TO MAKE AMENDMENTS WHERE NECESSARY PRIOR TO INSTALLATION.
5. THE CONTENTS OF THIS DOCUMENT ARE THE PROPERTY OF RETAIL DESIGN SOLUTIONS. IT MUST NOT BE COPIED OR DISTRIBUTED IN WHOLE OR PART WITHOUT FORMAL CONSENT.

DATE	NOTES
20.03.22	EXISTING LAYOUTS PRODUCED
21.04.22	PROPOSED LAYOUTS PRODUCED

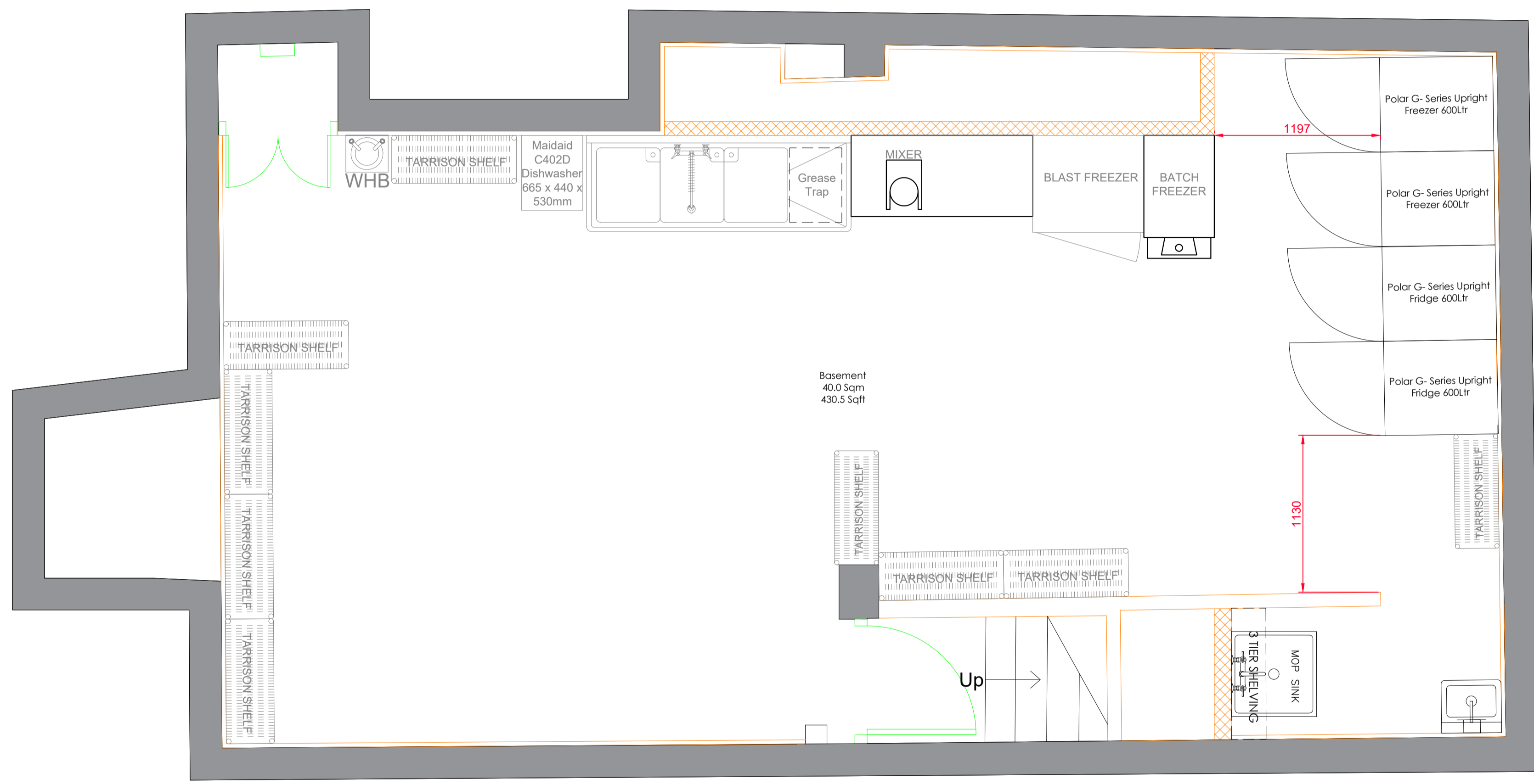

TOTAL SEAT COUNT - 20

SOLID WALLS 

NEW PARTITION WALLS 

Proposed Basement Floor
Scale 1:25 @ A1



PROJECT CREPE DELICIOUS

ADDRESS
89 LEATHER LANE
CENTRAL LONDON
EC1N 7TS

PROPOSED
BASEMENT
GENERAL
ARRANGMENT

SCALE 4.2 1:25@A1

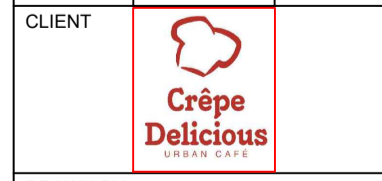

DRAWN BY

