

PLEASE NOTE:

- FURTHER INVESTIGATION REQUIRED TO ASCERTAIN TRUE EXTENT OF COLUMNS AS HIGHLIGHTED ON THE PLANS.
- SIGNS OF WATER DAMAGE/ DAMP IN BASEMENT AT LOW LEVEL.
- EXISTING SHOP FRONT DOORS HAVE A STEPPED THRESHOLD.
- VENT LOCATED NEAR THE SHOP FRONT BETWEEN GROUND AND BASEMENT.

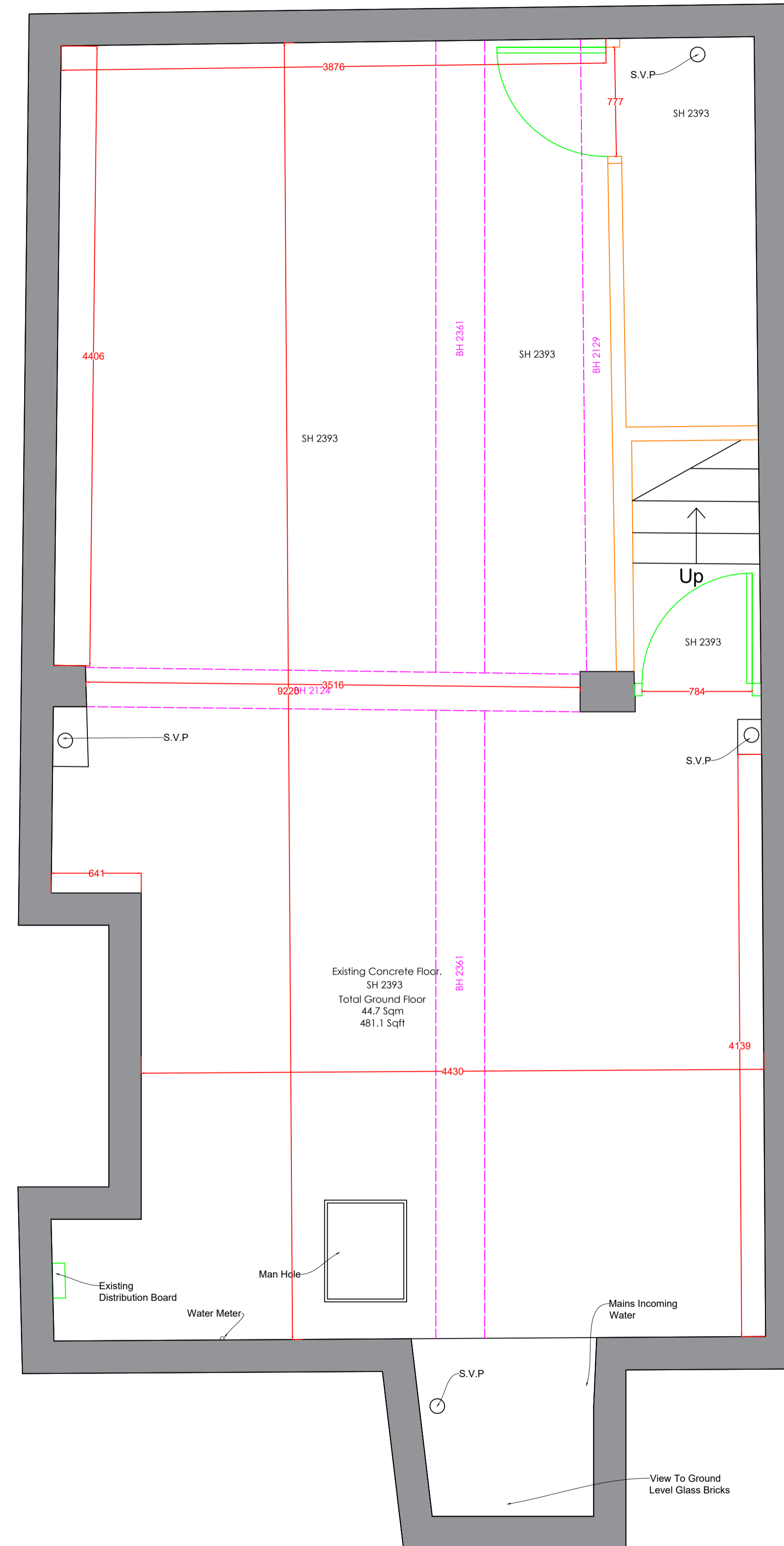

Existing Basement Floor
Scale 1:25 @ A1

GENERAL NOTES

1. ALL WORKS WITHIN THIS DOCUMENT TO BE INSTALLED/CARRIED OUT IN COMPLIANCE WITH THE LATEST BUILDING REGULATIONS AND BRITISH STANDARDS.
2. CONTRACTOR TO CHECK AND VERIFY ALL ON-SITE DIMENSIONS PRIOR TO MANUFACTURE/INSTALLATION AND MUST REPORT ANY DISCREPANCIES BACK TO RETAIL DESIGN SOLUTIONS. FAILURE TO DO SO WILL BE AT THE CONTRACTOR'S EXPENSE.
3. THIS DRAWING MUST NOT BE SCALED. WORK TO DIMENSIONS ONLY.
4. ANY CONSTRUCTION/WORKING DRAWINGS IN THIS DOCUMENT ARE INDICATIVE ONLY. IT IS THE RESPONSIBILITY OF THE CONTRACTOR TO ENSURE THEY ARE FIT FOR PURPOSE, AND TO MAKE AMENDMENTS WHERE NECESSARY PRIOR TO INSTALLATION.
5. THE CONTENTS OF THIS DOCUMENT ARE THE PROPERTY OF RETAIL DESIGN SOLUTIONS. IT IS NOT TO BE COPIED OR DISTRIBUTED IN WHOLE OR PART WITHOUT FORMAL CONSENT.

DATE	NOTES
30.03.22	EXISTING LAYOUTS PRODUCED

PROJECT: CREPE DELICIOUS

ADDRESS:
89 LEATHER LANE
CENTRAL LONDON
EC1N 7TS

ISSUE NAME:

EXISTING
STORE PLAN

SCALE: 1:25 @ A1

DATE: 30.03.22

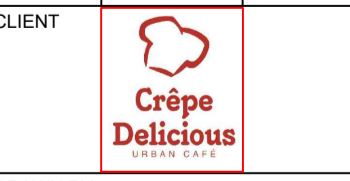

DRAWN BY:



The Mill Store, Foundry Lane, Earls
Colne, Essex, CO6 2SB
Tel. 01787 224878