

Issued
 / 23.11.21 Issued for planning
 A 24.02.22 Amended for planning
 B 08.07.22 Amended for planning
 C 18.07.22 Amended for planning

Notes

- Existing
- Proposed
- Amended 02/2022
- Amended 07/2022
- Amended 07/2022
- Site boundary

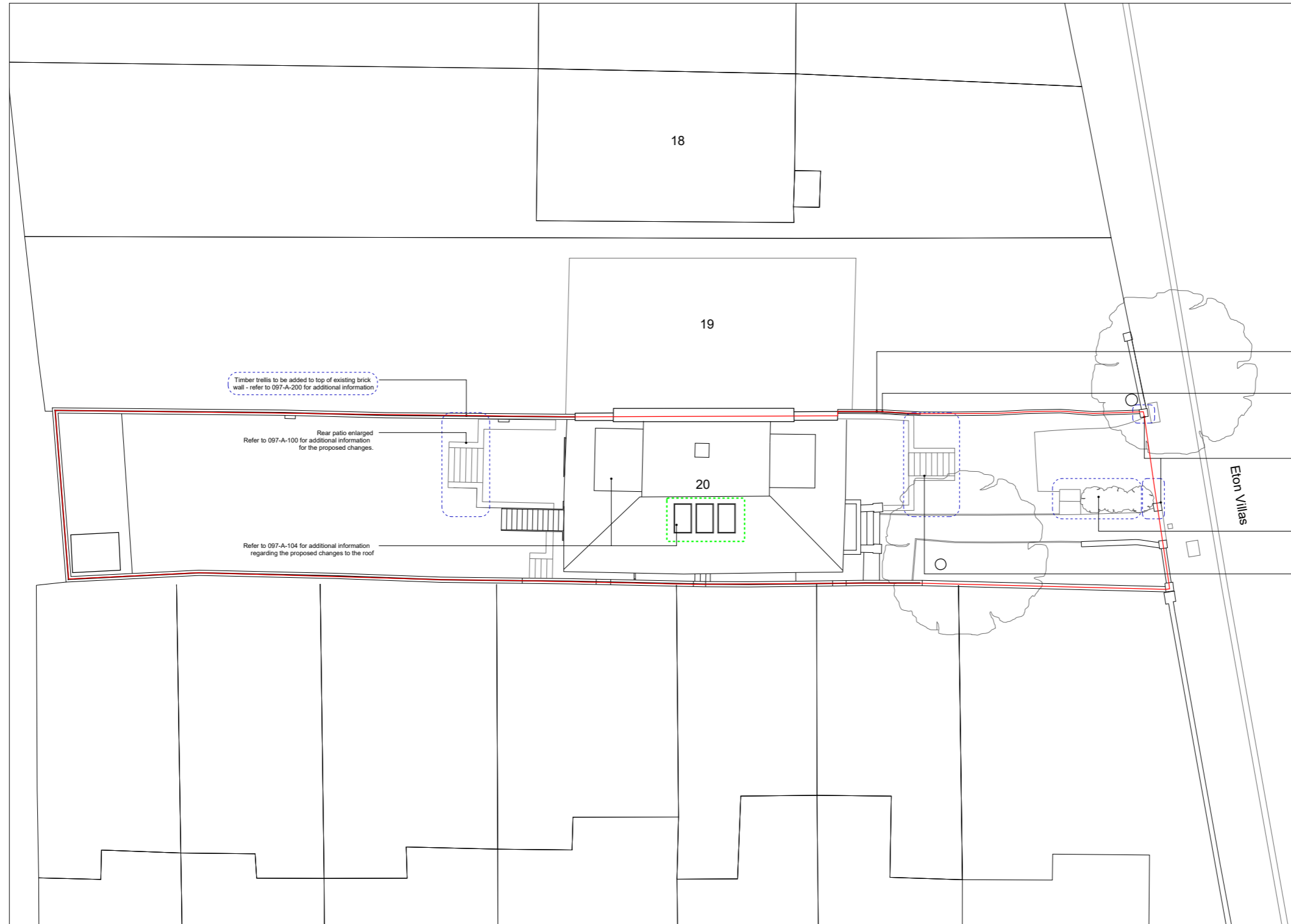

Refer to A-200 for amended trellis height

Timber trellis to be renovated and made taller - refer to 097-A-200 for additional information

Refer to 097-A-305 for additional information regarding the proposed changes to front garden wall

Low planter brick walls removed and replaced with a low hedge

Front lightwell enlarged Refer to 097-A-100 for additional information regarding the proposed changes

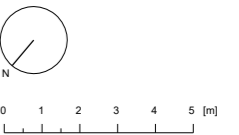

20 Eton Villas

Proposed

097-A-001

Site Plan

24.02.22 1:200 @ A3

RC MC

HESSELBRAND

© Hesselbrand Ltd. All rights described in Chapter IV of the Copyright, Designs and Patents Act 1988 have been asserted. The drawing is to be read in conjunction with specifications and all relevant drawings. Contractor to check all dimensions on site. Do not scale from this drawing. Hesselbrand Ltd is to be advised of any variation between the drawings and the site conditions.