

## Q52 Play and sports equipment systems

To be read with Preliminaries/ General conditions.

### GENERAL

### PRODUCTS

- 320A TRAMPOLINE REF: P1
- Standard: To BS EN 1176-1.
  - Manufacturer: Wicksteed Playscapes or equal approved  
Wicksteed Leisure Ltd  
Digby Street, Kettering  
Northamptonshire NN16 8YJ  
Tel: 01536 517028  
Email: sales@wicksteed.co.uk.
    - Product reference: Trampoline. Ref: 6030-080/1 or equal approved.
  - Age range: 4-12.
  - Materials: Safety slabs/Steel/ plastic slats.
    - Finish: As supplied.
    - Colour: Black.
  - Length: 1.5m x 1.5m.
  - Height: At grade.
  - Features: Vandal proof fixings.
  - Method of fixing: In strict accordance with supplier's recommendations.
- 330A SEE-SAW REF: P2
- Standard: To BS EN 1176-1.
  - Manufacturer: Wicksteed Playscapes or equal approved  
Wicksteed Leisure Ltd  
Digby Street, Kettering  
Northamptonshire NN16 8YJ  
Tel: 01536 517028  
Email: sales@wicksteed.co.uk.
    - Product reference: Buddy Board / Ref: 6060-089 or equal approved.
  - Age range: 6-16 years.
  - Type: See-saw.
  - Materials: Steel/.
    - Finish: As supplied.
    - Colour: As supplied, Black.
  - Plan size: 1545mm length x 530mm wide.
  - Height: 620mm.
  - Features: Vandal proof fixings.
  - Method of fixing: In strict accordance with supplier's details and recommendations..

- 330B SEE-SAW REF: P11
- Standard: To BS EN 1176-1.
  - Manufacturer: Wicksteed Playscapes or equal approved  
Wicksteed Leisure Ltd  
Digby Street, Kettering  
Northamptonshire NN16 8YJ  
Tel: 01536 517028  
Email: sales@wicksteed.co.uk.
    - Product reference: Springboard See-saw / Ref: 6060-071 or equal approved.
  - Age range: 6-12 years.
  - Type: See-saw.
  - Materials: High Density Polyethylene seat / Steel/.
    - Finish: As supplied.
    - Colour: As supplied, Yellow.
  - Plan size: 1220mm L x 245mm W x 635mm H.
  - Height: 635mm / critical fall height <0.6m.
  - Features: Vandal proof fixings.
  - Method of fixing: In strict accordance with supplier's details and recommendations..
- 350A SENSORY PLAY STRUCTURE RAIN WHEEL REF: P5
- Standard: To BS EN 1176-1.
  - Manufacturer: Broxap Ltd or equal approved  
Tel, 0844 800 4085  
Email: Enquiries@broxap.com.
    - Product reference: Rain Wheel / Ref: BX/HMP650004.
  - Sensory features: Tactile, Audio.
  - Components: Rainwheel.
  - Materials: Galvanized steel and Polyethylene.
    - Finish: Painted.
    - Colour: RAL TBC, Green.
  - Highest platform height: At grade.
  - Features: Vandal proof fixings.
  - Method of fixing: In strict accordance with supplier details and recommendations.
- 355A IMAGINATIVE PLAY STRUCTURE BEE PLAY SCULPTURE REF: P4
- Standard: To BS EN 1176-1.
  - Manufacturer: Broxap Ltd or equal approved  
Tel, 0844 800 4085  
Email: Enquiries@broxap.com.
    - Product reference: Bee Play Sculpture. Ref: BX/HMP350001 or equal approved.
  - Age range: 2-5.
  - Components: Static seating sculpture.
  - Materials: Timber as supplied.
    - Finish: As supplied (smooth, free from splinters or burrs).
    - Colour: As supplied.
  - Highest platform height: 0.6 m.
  - Features: None.
  - Method of fixing: In strict accordance with supplier details and recommendations.

- 356A IMAGINATIVE PLAY ELEMENT PLAY KITCHEN REF: P7
- Standard: To BS EN 1176-1.
  - Manufacturer: Broxap Ltd or equal approved  
Tel, 0844 800 4085  
Email: Enquiries@broxap.com.
  - Product reference: Messy Play Kitchen. Ref BX/HMP 250018 or equal approved.
  - Age range: 2-5.
  - Components: Static kitchen.
  - Materials: Timber as supplied.
    - Finish: As supplied (smooth, free from splinters or burrs).
    - Colour: As supplied.
  - Highest platform height: 0.6 m.
  - Features: None.
  - Method of fixing: In strict accordance with supplier details and recommendations.
- 357A IMAGINATIVE PLAY ELEMENT CAR REF: P8
- Standard: To BS EN 1176-1.
  - Manufacturer: Wicksteed Playscapes or equal approved  
Wicksteed Leisure Ltd  
Digby Street, Kettering  
Northamptonshire NN16 8YJ  
Tel: 01536 517028  
Email: sales@wicksteed.co.uk.
  - Product reference: Sports Car. Ref: 6070-071 or equal approved.
  - Age range: 2-5.
  - Components: Static car.
  - Materials: Polyethylene / Steel.
    - Finish: As supplied.
    - Colour: Red.
  - Highest platform height: 0.6 m.
  - Features: None.
  - Method of fixing: In strict accordance with supplier details and recommendations.
- 358 IMAGINATIVE PLAY ELEMENT TALKING FLOWER REF: P15
- Standard: To BS EN 1176-1.
  - Manufacturer: Wicksteed Playscapes or equal approved  
Wicksteed Leisure Ltd  
Digby Street, Kettering  
Northamptonshire NN16 8YJ  
Tel: 01536 517028  
Email: sales@wicksteed.co.uk.
  - Product reference: Talking Flower Ref: 6070-054 or equal approved.
  - Age range: 3-8 years.
  - Components: 2 no. static flower poles and connecting PVC hose.
  - Materials: Lamina flower head/Mild Steel stems/PVC hose.
    - Finish: As supplied.
    - Colour: Yellow/Green.
  - Highest platform height: n/a.
  - Features: None.
  - Method of fixing: In strict accordance with supplier details and recommendations.

- 390A ROCKING EQUIPMENT BIKE RE: P10
- Standard: To BS EN 1176-1 and -6.
  - Manufacturer: Wicksteed Playscapes or equal approved  
Wicksteed Leisure Ltd  
Digby Street, Kettering  
Northamptonshire NN16 8YJ  
Tel: 01536 517028  
Email: sales@wicksteed.co.uk.  
- Product reference: Scramble Bike Rocker / Ref: 6060-054.
  - Age range: 2-5 years.
  - Type: Sit-on rocker, single.
  - Number of seats: 1.
  - Height: 0.6m
  - Materials: Galvanized steel.
    - Finish: Polyester powder coated.
    - Colour: Red.
  - Features: None.
  - Method of fixing: In strict accordance with supplier's details and recommendations.
- 390B ROCKING EQUIPMENT CAR / REF: P9
- Standard: To BS EN 1176-1 and -6.
  - Manufacturer: Wicksteed Playscapes or equal approved  
Wicksteed Leisure Ltd  
Digby Street, Kettering  
Northamptonshire NN16 8YJ  
Tel: 01536 517028  
Email: sales@wicksteed.co.uk.  
- Product reference: Crazy Car Springie / Ref: 6060-105.
  - Age range: 2-5 years.
  - Type: Sit-on rocker, single.
  - Number of seats: 1.
  - Height: 0.6m
  - Materials: Galvanized steel.
    - Finish: Polyester powder coated.
    - Colour: Red.
  - Features: None.
  - Method of fixing: In strict accordance with supplier's details and recommendations.
- 390C ROCKING EQUIPMENT TONI TURTLE / REF: P12
- Standard: To BS EN 1176-1 and -6.
  - Manufacturer: Wicksteed Playscapes or equal approved  
Wicksteed Leisure Ltd  
Digby Street, Kettering  
Northamptonshire NN16 8YJ  
Tel: 01536 517028  
Email: sales@wicksteed.co.uk.  
- Product reference: Toni Turtle Springie / Ref:6060-055 .
  - Age range: 2-5 years.
  - Type: Sit-on rocker, single.
  - Number of seats: 1.
  - Height: <0.6m critical fall height
  - Materials: Thick HD Polyethylene panels / Steel frame and components.
    - Finish: As supplied.
    - Colour: Green.
  - Features: None.
  - Method of fixing: In strict accordance with supplier's details and recommendations.

- 390D ROCKING EQUIPMENT FREDDIE FROG / REF: P14
- Standard: To BS EN 1176-1 and -6.
  - Manufacturer: Wicksteed Playscapes or equal approved  
Wicksteed Leisure Ltd  
Digby Street, Kettering  
Northamptonshire NN16 8YJ  
Tel: 01536 517028  
Email: sales@wicksteed.co.uk.
    - Product reference: Freddie Frog Springie / Ref:6060-057.
  - Age range: 2-5 years.
  - Type: Sit-on rocker, single.
  - Number of seats: 1.
  - Height: <0.6m critical fall height
  - Materials: Thick HD Polyethylene panels / Steel frame and components.
    - Finish: As supplied.
    - Colour: Green.
  - Features: None.
  - Method of fixing: In strict accordance with supplier's details and recommendations.
- 430 SPINNING EQUIPMENT REF: P3
- Standard: To BS EN 1176-1 and -5.
  - Manufacturer: Wicksteed Playscapes Ltd or equal approved  
Wicksteed Leisure Ltd  
Digby Street, Kettering  
Northamptonshire NN16 8YJ  
Tel: 01536 517028  
Email: sales@wicksteed.co.uk.
    - Product reference: Junior Comet / Ref: 6020-087 or equal approved.
  - Age range: 6-12.
  - Type, to BS EN 1176-5: B.
  - Materials: Steel / HDPE Deck.
    - Finish: As supplied.
    - Colour: Yellow / Black.
  - Diameter: 1240mm (890mm high hand holds).
  - Deck height: 88mm to underside of deck.
  - Features: None.
  - Method of fixing: In strict accordance with supplier's details and recommendations.

- 440A SWINGING EQUIPMENT BASKET MINI SWING REF: P6
- Standard: To BS EN 1176-1 and -2.
  - Manufacturer: Wicksteed Playscapes Ltd or equal approved  
Wicksteed Leisure Ltd  
Digby Street, Kettering  
Northamptonshire NN16 8YJ  
Tel: 01536 517028  
Email: sales@wicksteed.co.uk .
  - Product reference: Basket Mini Swing / Ref: 6040-101 or equal approved.
  - Age range: 5-14.
  - Type: 1.
  - Frame: Dual post.
    - Bays: 1.
    - Materials: Steel / Nylon rope seat.
    - Finish: Polyester powder coated.
    - Colour: Red / Black.
    - Height: 1457mm to top of frame / 965mm max basket height.
  - Seats: 1 basket.
    - Materials: Nylon rope, to supplied details.
    - Ground clearance: 570mm in vertical (resting) position.
  - Features: Anti-wrap chain and Integral safety guards.
  - Method of fixing: In strict accordance with supplier details and recommendations.

#### **EXECUTION**

- 710 PLAY EQUIPMENT INSTALLATION GENERALLY
- Standard: To manufacturer's written instructions provided in accordance with BS EN 1176-1.
- 720 CONCRETE FOUNDATIONS GENERALLY
- Standard: To BS 8500-2.
  - Concrete: Designated, not less than GEN 1 or Standard prescribed, not less than ST2.
  - Admixtures: Do not use.
  - Foundation holes: Neat vertical sides.
  - Depth of foundations, bedding, haunching: Appropriate to provide adequate support and to receive overlying soft landscape or paving finishes.

- 725 **SETTING COMPONENTS IN CONCRETE**
- Holes: Strictly in accordance with manufacturer's instructions.
  - Components: Accurately positioned and securely supported.
  - Concrete fill: Fully compacted as filling proceeds.
  - Concrete foundations exposed to view: Finished to weathering profile to shed water and trowel smooth.
  - Temporary component support: Maintain undisturbed for minimum 48 hours.
- 740 **PRESERVATIVE TREATED TIMBER**
- Surfaces exposed by minor cutting and drilling: Treated by immersion or with two flood coats of a solution recommended for the purpose by main treatment solution manufacturer.
- 750 **DAMAGE TO GALVANIZED SURFACES**
- Minor damage in areas up to 40 mm<sup>2</sup> (including on fixings and fittings): Make good.
    - Materials: Low melting point zinc alloy repair rods or powders made for this purpose or at least two coats of zinc-rich paint to BS 4652.
    - Thickness: Sufficient to provide a zinc coating at least equal to the original layer.
- 760 **SITE PAINTING**
- Timing: Prepare surfaces and apply finishes as soon as possible after installing components.
- COMPLETION**
- 910 **INSPECTION**
- Standard: To BS EN 1176-1.
  - Timing: 2 weeks prior to date when work is expected to be practically complete  
Note: Independent RoSPA inspection of all play equipment, surfacing and access points to be carried out prior to handover. Results to be included in the O+M Manual.
  - Period of notice (minimum): 3 working days.
- 920 **CLEANING**
- General: Leave the works in a clean, tidy condition.
  - Surfaces: Clean immediately before handover.
- 930 **TESTING**
- Standard: To BS EN 1176-1.
- 940 **LABELS**
- Standard: To BS EN 1176-1.
  - Labels: Provide permanent labelling on all types of play equipment.
  - Location: Where visible when erected on site.
- 950 **DOCUMENTATION**
- Standard: To BS EN 1176-1.
  - Contents:
    - Copies of test reports.
    - General product information.
    - Installation information.
    - Inspection and maintenance information.
  - Number of copies: 3.
  - Submission: 2 weeks prior to date when work is expected to be practically complete.
- 970 **OPERATING TOOLS**
- Tools: Supply tools required for operation, maintenance and cleaning purposes.

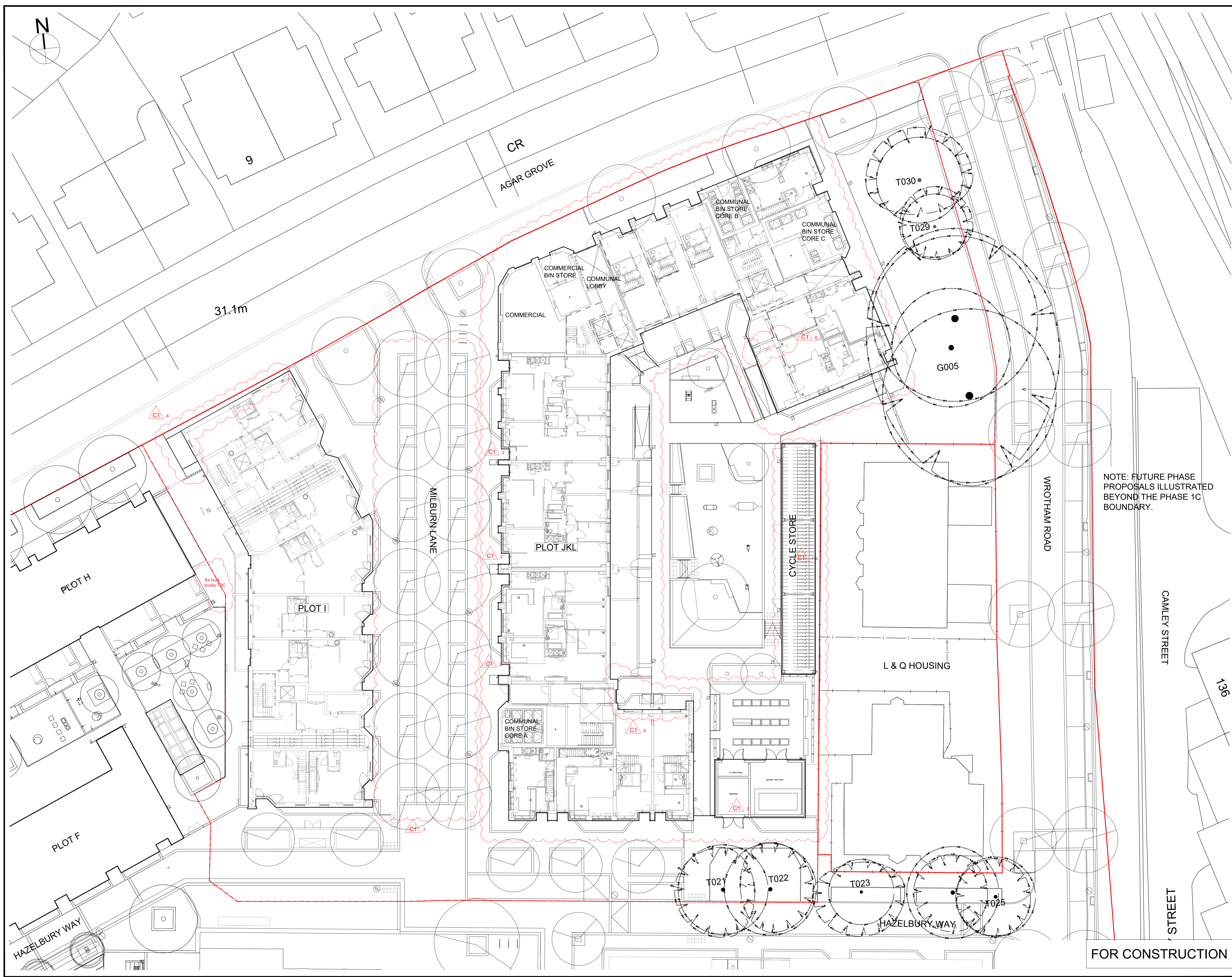

- GENERAL NOTES:**
- All dimensions and levels to be checked and verified on site before commencing any work or producing shop drawings
  - This drawing is to be read in conjunction with all other relevant drawings, specifications and schedules
  - Any discrepancy concerning the drawings should be referred to the originator / CA immediately
  - All dimensions in millimetres unless noted otherwise
  - All levels in metres
  - Existing service alignments to be checked on site by the contractor on site by the contractor prior to construction work commencing
  - The content of this drawing is to be read in conjunction with the latest project CDM risk register

- NOTES:**
- Refer to General Arrangement drawings, Landscape Details and Landscape Specification as cross reference documents for all landscape proposals.
  - Refer to Civil Engineer's details and specification for all proposed paving makeups and drainage. Shown indicatively in Landscape Architect's drawings.
  - Refer to M+E Engineer's details and specification for all utilities and lighting proposals. Shown indicatively in Landscape Architect's drawings.
  - Refer to Structural Engineer's information for all external structures and footings. Shown indicatively in Landscape Architect's drawings.
  - All works to existing trees or within the Root Protection Zone (RPZ) of the existing trees to be carried out in strict accordance with BS 5837:2012. To be read in conjunction with the Arboricultural Impact Assessment (AIA) by Hayden's Arboricultural Consultants.
  - Contractor to make provision for further site investigation to determine the exact extent of existing tree roots and localised level survey at each tree.
  - Please refer to the site wide drawing by Hawkins Brown, reference AGV-HBA-NE-00-DR-A-20-0001 for the Active Site Boundary including proposed hoarding lines.
  - Contractor to allow for positive connections of all tree drains to existing/proposed surface water drainage system or soakaway agreed with Engineer's prior to commencement. Refer to Engineer's details and specification for all structural, services, drainage and pavement makeup requirements.
  - Softworks Details to be read in conjunction with Soiling General Arrangement and Soft Landscape General Arrangement plans AGC377-AL-TZ-1-001 to 004 and AGC377-AL-SW-1-001 to 004 and Plant Schedules.
  - Exact location of aeration pipes to tree pits to be set out on site to allow for correct positioning of tree rootball in tree pits. Shown indicatively only on Landscape Details.

NOTE: FUTURE PHASE PROPOSALS ILLUSTRATED BEYOND THE PHASE 1C BOUNDARY.

- AMENDMENTS FOR C1:**
- Updated substation and cycle store layouts shown on drawing
  - Planter layout updated to avoid clash with manholes
  - Planter coordinated with walls connecting to building on revised architectural layout
  - Landscape to north west of block I amended to accommodate garden access from rear door - steel planter omitted and wall omitted. Paving and planting extents changed. Railing pulled back from wall and defensive planting added in accordance with SBD comments
  - Updated garden wall location to avoid clash with manhole
  - Updated wall and gate position following coordination with HBA
  - Tree pits moved to avoid clashes with installed drainage

Rev.	Date	Description	Drawn	Ch'd
C1	05.07.2022	FOR CONSTRUCTION	PJ	PC

**grant associates**  
 Landscape Architecture, Urban Design, Creative Ecology  
 22 Milk Street, Bath BA1 1JT  
 T: +44 (0) 1225 332664, F: +44 (0) 1225 420803  
 E: info@grant-associates.uk.com

**CLIENT**  
LB CAMDEN

**PROJECT**  
AGAR GROVE REGENERATION PHASE 1C

**TITLE**  
LANDSCAPE GENERAL ARRANGEMENT

Scale:	Date:	Drawn:	Checked:	Approved:
1:200@ A1	25/06/2019	MA	CH	PC
Status:	FOR CONSTRUCTION			
Drawing Number:	AGC377-GRA-1C-XX-DR-L-1121			Rev:
				C1

**FOR CONSTRUCTION**





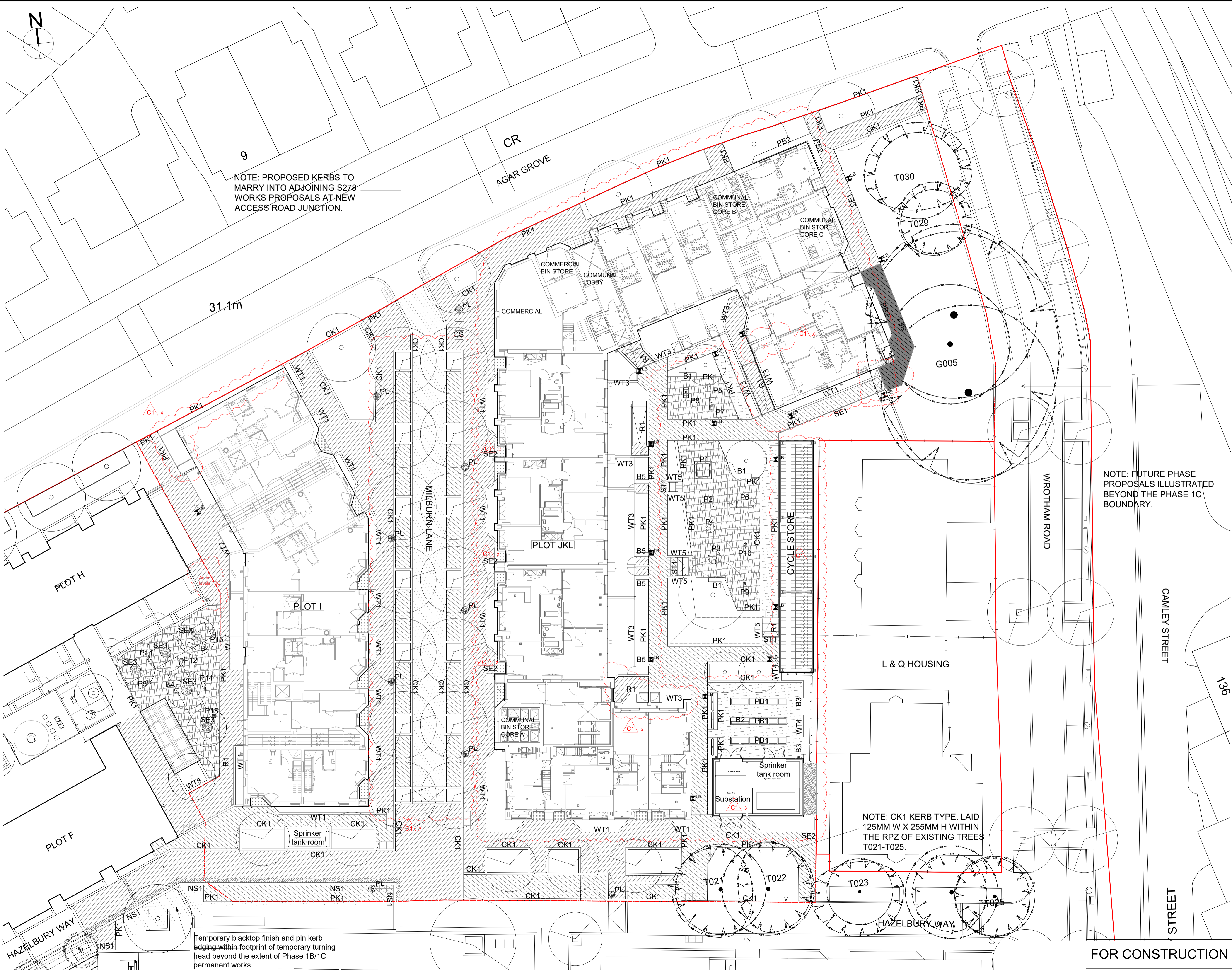

NOTE: PROPOSED KERBS TO MARRY INTO ADJOINING S278 WORKS PROPOSALS AT NEW ACCESS ROAD JUNCTION.

NOTE: FUTURE PHASE PROPOSALS ILLUSTRATED BEYOND THE PHASE 1C BOUNDARY.

NOTE: CK1 KERB TYPE. LAID 125MM W X 255MM H WITHIN THE RPZ OF EXISTING TREES T021-T025.

Temporary blacktop finish and pin kerb edging within footprint of temporary turning head beyond the extent of Phase 1B/1C permanent works

- GENERAL NOTES:
- All dimensions and levels to be checked and verified on site before commencing any work or producing shop drawings
  - This drawing is to be read in conjunction with all other relevant drawings, specifications and schedules
  - Any discrepancy concerning the drawings should be referred to the originator / CA immediately
  - All dimensions in millimetres unless noted otherwise
  - All levels in metres
  - Existing service alignments to be checked on site by the contractor on site by the contractor prior to construction work commencing
  - The content of this drawing is to be read in conjunction with the latest project CDM risk register

- NOTES:
- Refer to General Arrangement drawings, Landscape Details and Landscape Specification as cross reference documents for all landscape proposals.
  - Refer to Civil Engineer's details and specification for all proposed paving makeups and drainage. Shown indicatively in Landscape Architect's drawings.
  - Refer to M+E Engineer's details and specification for all utilities and lighting proposals. Shown indicatively in Landscape Architect's drawings.
  - Refer to Structural Engineer's information for all external structures and footings. Shown indicatively in Landscape Architect's drawings.
  - All works to existing trees or within the Root Protection Zone (RPZ) of the existing trees to be carried out in strict accordance with BS 5837:2012. To be read in conjunction with the Arboricultural Impact Assessment (AIA) by Hayden's Arboricultural Consultants.
  - Contractor to make provision for further site investigation to determine the exact extent of existing tree roots and localised level survey at each tree.
  - Please refer to the site wide drawing by Hawkins Brown, reference AGV-HBA-NE-00-DR-A-20-0001 for the Active Site Boundary including proposed hoarding lines.
  - Contractor to allow for positive connections of all tree drains to existing/proposed surface water drainage system or soakaway agreed with Engineer's prior to commencement. Refer to Engineer's details and specification for all structural, services, drainage and pavement makeup requirements.
  - Softworks Details to be read in conjunction with Soiling General Arrangement and Soft Landscape General Arrangement plans AGC377-AL-TZ-1-001 to 004 and AGC377-AL-SW-1-001 to 004 and Plant Schedules.
  - Exact location of aeration pipes to tree pits to be set out on site to allow for correct positioning of tree rootball in tree pits. Shown indicatively only on Landscape Details.

- AMENDMENTS FOR C1:
- Updated substation and cycle store layouts shown on drawing
  - Planter layout updated to avoid clash with manholes
  - Planter coordinated with walls connecting to building on revised architectural layout
  - Landscape to north west of block 1 amended to accommodate garden access from rear door - steel planter omitted and wall omitted. Paving and planting extents changed
  - Updated garden wall location to avoid clash with manhole
  - Updated wall and gate position following coordination with HBA
  - Tree pits moved to avoid clashes with installed drainage

C1	05.07.2022	FOR CONSTRUCTION	PJ	PC
Rev.	Date	Description	Drawn	Checked

**grant associates**  
 Landscape Architecture, Urban Design, Creative Ecology  
 22 Milk Street, Bath BA1 1UT  
 T: +44 (0) 1225 332664, F: +44 (0) 1225 420803  
 E: info@grant-associates.co.uk

CLIENT  
**LB CAMDEN**

PROJECT  
**AGAR GROVE REGENERATION PHASE 1C**

TITLE  
**HARD LANDSCAPE GENERAL ARRANGEMENT**

Scale:	Date:	Drawn:	Checked:	Approved:
1:200 @ A1	25/06/2019	MA	CH	PC
Status:	<b>FOR CONSTRUCTION</b>			
Drawing Number:	AGC377-GRA-1C-XX-DR-L-3121			Rev:
				C1

**FOR CONSTRUCTION**