

Copyright Hawkins\Brown Architects
No implied licence exists. This drawing should not be used to calculate areas for the purposes of valuation. Do not scale this drawing. All dimensions to be checked on the site by the contractor and such dimensions to be their responsibility. All work must comply with relevant British Standards and Building Regulations requirements. Drawing errors and omissions to be reported to the architect. To be read in conjunction with Architect's specification and other consultant information.

Rev	Description	Date
P1	Issued for Coordination	03/06/21
P2	Door frame/brick relationship amended	09/08/21
P3	Wall type amended to partial fill insulation, planter and DPC heights added. Issued for construction.	25/03/22

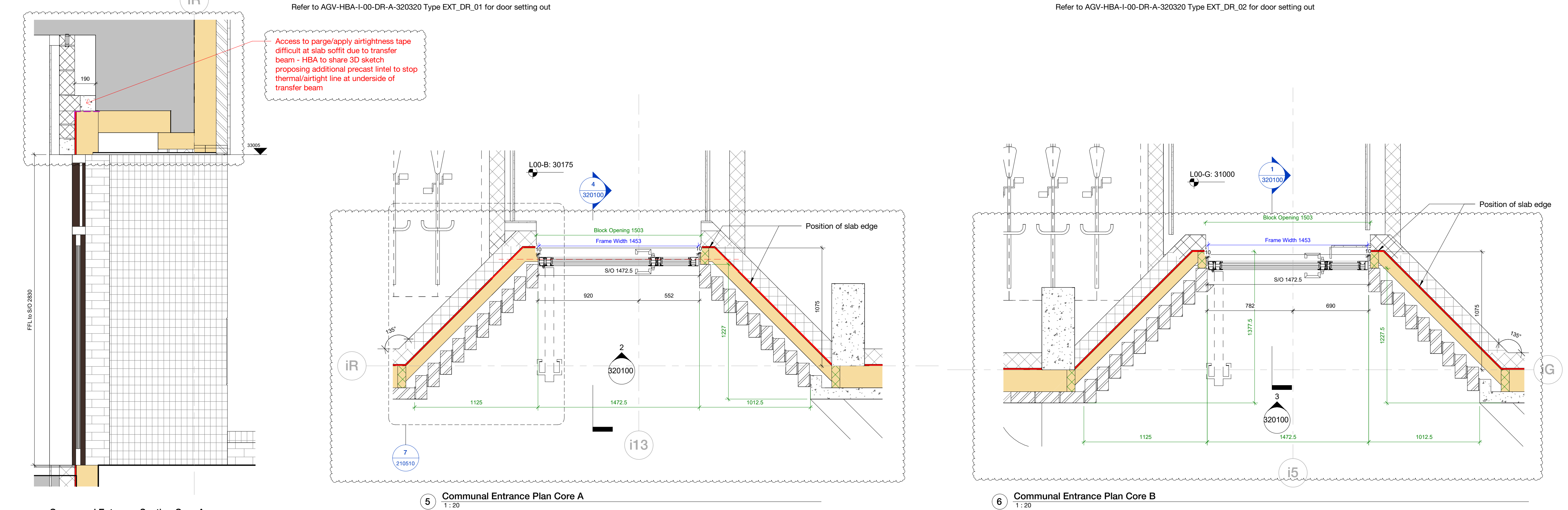
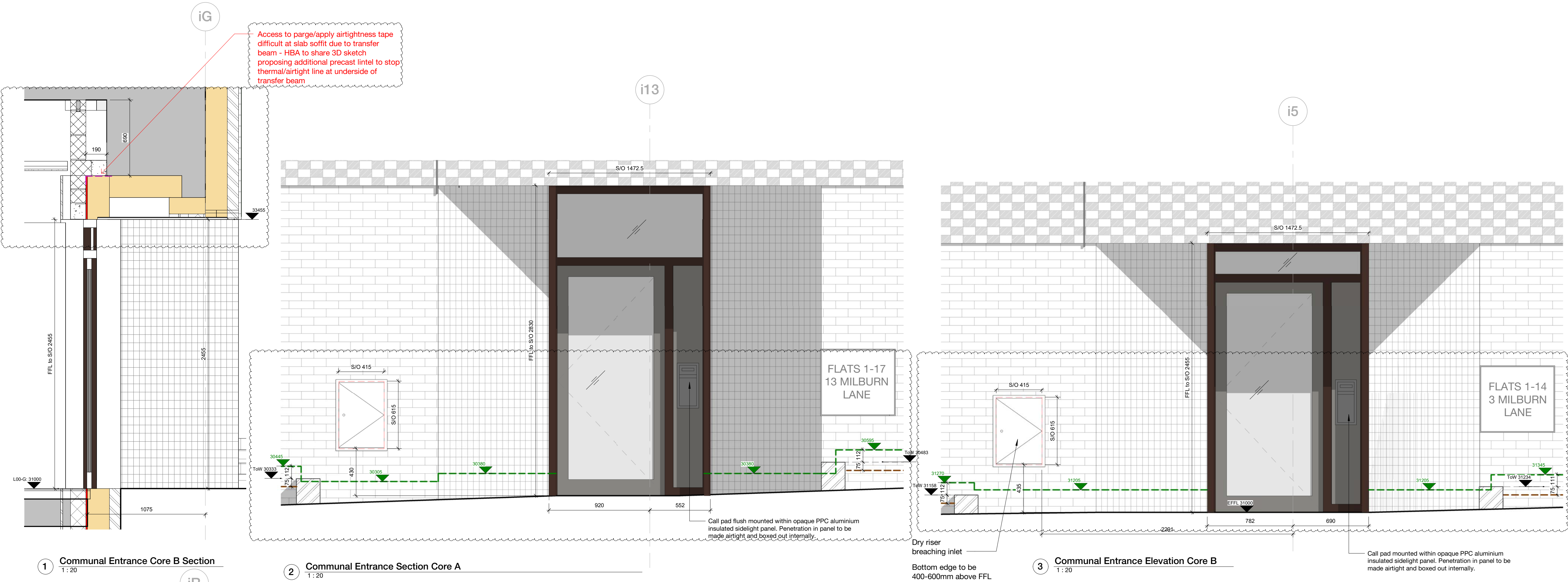

Key:	
	Window frame size dimension
	Top of soil level
	DPC level
GRA ToW	Top of wall level as indicated on AGC377-GRA-1C-XX-DR-L-2121
EFFL	External ground level as indicated on AGC377-GRA-1C-XX-DR-L-2121
AEFFL	Approx. external ground level extrapolated from levels on AGC377-GRA-1C-XX-DR-L-2121

Refer to AGV-PAM-SW-00-DR-S-001061 for masonry tie and footing requirements to planters
ToW heights indicated on AGC377-GRA-1C-XX-DR-L-2121 amended to suit brick coursing - Landscape Architect to confirm sufficient soil depth maintained

159 St John Street
London EC1V 4QU
mail@hawkinsbrown.com
hawkinsbrown.com

Hawkins\Brown

Project
Agar Grove Phase 1c
Block I

Drawing
East Communal Entrance Setting
Out

Scale @ A1
As indicated

Date
June 2021

Drawn By
TC

Checked By
JW

Job Number	Status	Purpose of Issue
1423-C	S2	Construction

Drawing No.	Rev
AGV-HBA-I-00-DR-A-320100	P3

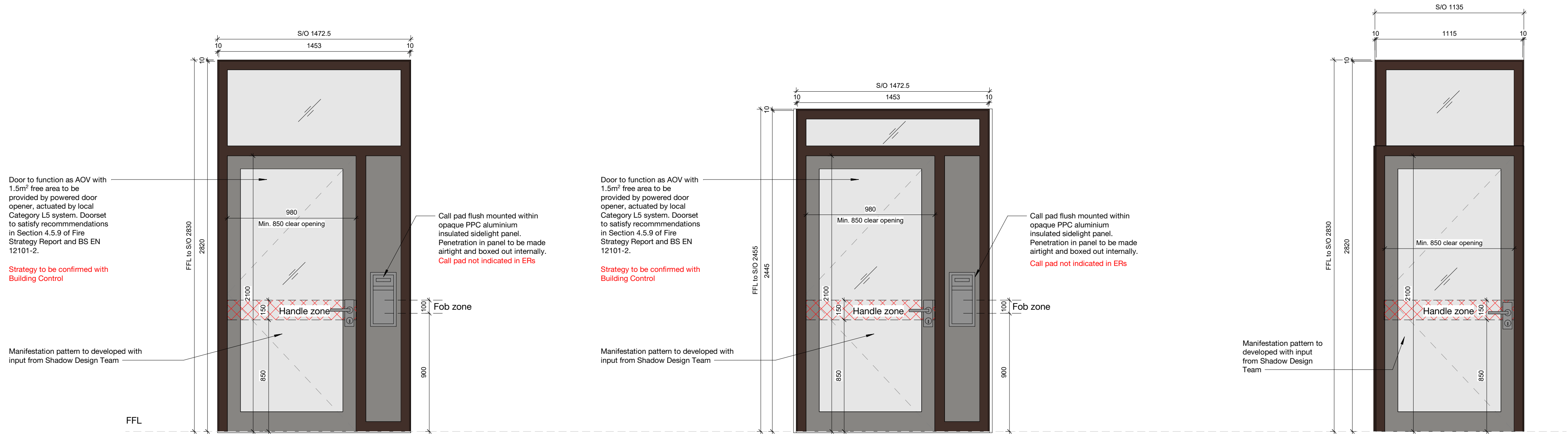

EXT_DR_01
L00 Core A East Communal entrance

Outward powered opening
Triple glazed with opaque insulated sidelight panel
Fixed/outer frame colour - RAL 8017
Leaf/inner frame colour - RAL 9007
U_g - 0.77 W/m²K
Airtightness - Class 4 BS EN 12207/1026
Security - Fob access entry and push button exit
G-value - Supplier to confirm resultant g-value

SBD certification (To be confirmed by DOCO):
-STS 202 Issue 6:2015 Burglary Rating 2
-PAS24:2016

Refer to View 2 AGV-HBA-I-00-DR-A-320100 for brickwork setting out

EXT_DR_01
L00 Core B East Communal entrance

Outward powered opening
Triple glazed with opaque insulated sidelight panel
Fixed/outer frame colour - RAL 8017
Leaf/inner frame colour - RAL 9007
U_g - 0.77 W/m²K
Airtightness - Class 4 BS EN 12207/1026
Security - Fob access entry and push button exit
G-value - Supplier to confirm resultant g-value

SBD certification (To be confirmed by DOCO):
-STS 202 Issue 6:2015 Burglary Rating 2
-PAS24:2016

Refer to View 3 AGV-HBA-I-00-DR-A-320100 for brickwork setting out

EXT_DR_03
L00 Core A West Communal entrance and bike store

Outward powered opening
Triple glazed
Fixed/outer frame colour - RAL 8017
Leaf/inner frame colour - RAL 9007
U_g - 0.77 W/m²K
Airtightness - Class 4 BS EN 12207/1026
Security - Fob access entry and push button exit
G-value - Supplier to confirm resultant g-value

SBD certification (To be confirmed by DOCO):
-STS 202 Issue 6:2015 Burglary Rating 2
-PAS24:2016



EXT_DR_04
L00 Core B West Communal entrance and bike store

Outward powered opening
Triple glazed
Fixed/outer frame colour - RAL 8017
Leaf/inner frame colour - RAL 9007
U_g - 0.77 W/m²K
Airtightness - Class 4 BS EN 12207/1026
Security - Fob access entry and push button exit
G-value - Supplier to confirm resultant g-value

SBD certification (To be confirmed by DOCO):
-STS 202 Issue 6:2015 Burglary Rating 2
-PAS24:2016

EXT_DR_05
L00 lobby doors

Outward powered opening
Fixed/outer frame colour - RAL 8017
Leaf/inner frame colour - RAL 9007
Screen (lanthorn/sidelight) fire rating - 60 min
Door fire rating - FD30S
Security - Fob access entry and push button exit

SBD certification (To be confirmed by DOCO):
-STS 202 Issue 6:2015 Burglary Rating 2
-PAS24:2016

External bin store doors to follow

Staircase/lobby doors to upper floors captured in Internal Door Schedule

External Door Types Schedule	
Type Mark	Count

EXT_DR_01	1
EXT_DR_02	1
EXT_DR_03	2
EXT_DR_04	2
EXT_DR_05	2

Copyright Hawkins\Brown Architects
No implied licence exists. This drawing should not be used to calculate areas for the purposes of valuation. Do not scale this drawing. All dimensions to be checked on the site by the contractor and such dimensions to be their responsibility. All work must comply with relevant British Standards and Building Regulations requirements. Drawing errors and omissions to be reported to the architect. To be read in conjunction with Architect's specification and other consultant information.

Rev	Description	Date
P1	Issued for Coordination	09/08/21

All glazing to satisfy Class 1(C)1 BS EN 12600, additional glazing/SBD requirements noted for each type on AGV-HBA-JKL-ZZ-DR-A-320322

Dashed opening direction lines drawn to UK convention ie. converging at hinge side

Handing orientation of type instances to follow

Final requirements to be confirmed with Building Control Officer and Designing Out Crime Officer

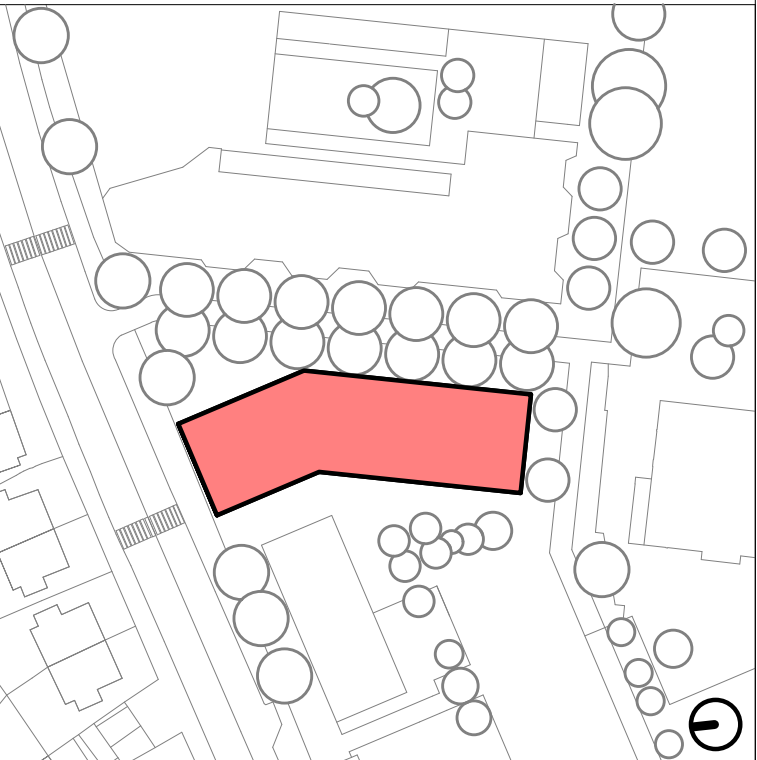
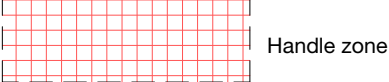

159 St John Street
London EC1V 4QJ

mail@hawkinsbrown.com
hawkinsbrown.com

Hawkins\Brown

Project
Agar Grove Phase 1c
Block I

Drawing
External Door Visual Schedule

Scale @ A1 1 : 20		Date Aug 2021	
Drawn By TC		Checked By JW	
Job Number 1423-C	Status S1	Purpose of Issue Coordination	
Drawing No. AGV-HBA-I-ZZ-DR-A-320320			Rev P1