

1 EXISTING SITE PLAN
Scale: 1:100

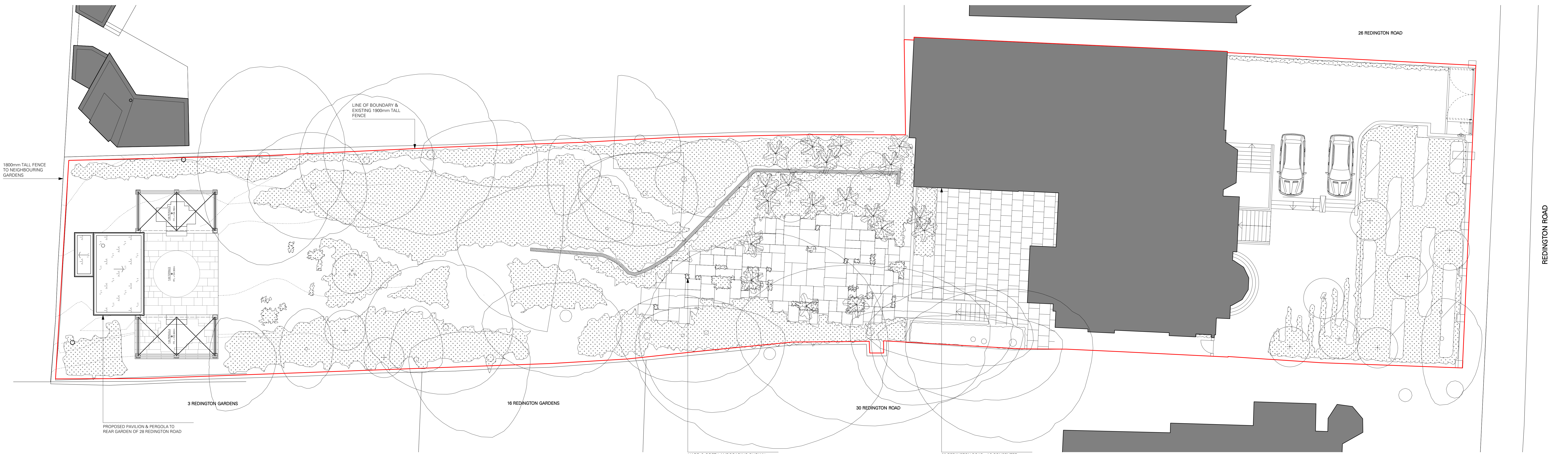

2 PROPOSED SITE PLAN
Scale: 1:100



© Do not scale working dimensions from this drawing. Read drawings in conjunction with all relevant consultation drawings and specifications. In case of discrepancies between information - consult the architect for final decision. Deviations from these drawings shall not be made without first consulting the architect.

NOTES
SITE BOUNDARY
REFER TO PLANNING, DESIGN AND ACCESS STATEMENT - APPENDIX A, EXISTING SITE PHOTOS

28 REDINGTON ROAD, LONDON NW3 7RH		EXISTING/ PROPOSED SITE PLAN	
NO	REVISION UPDATES	DATE	REV
01	PROVISION UPDATES	01/07/2022	P1
02	FOR PLANNING	18/01/2022	P0
03	FOR PLANNING	04/07/2022	P0
04	FOR PLANNING	04/07/2022	P0
05	FOR PLANNING	04/07/2022	P0
06	FOR PLANNING	04/07/2022	P0
07	FOR PLANNING	04/07/2022	P0
08	FOR PLANNING	04/07/2022	P0
09	FOR PLANNING	04/07/2022	P0
10	FOR PLANNING	04/07/2022	P0
11	FOR PLANNING	04/07/2022	P0
12	FOR PLANNING	04/07/2022	P0
13	FOR PLANNING	04/07/2022	P0
14	FOR PLANNING	04/07/2022	P0
15	FOR PLANNING	04/07/2022	P0
16	FOR PLANNING	04/07/2022	P0
17	FOR PLANNING	04/07/2022	P0
18	FOR PLANNING	04/07/2022	P0
19	FOR PLANNING	04/07/2022	P0
20	FOR PLANNING	04/07/2022	P0
21	FOR PLANNING	04/07/2022	P0
22	FOR PLANNING	04/07/2022	P0
23	FOR PLANNING	04/07/2022	P0
24	FOR PLANNING	04/07/2022	P0
25	FOR PLANNING	04/07/2022	P0
26	FOR PLANNING	04/07/2022	P0
27	FOR PLANNING	04/07/2022	P0
28	FOR PLANNING	04/07/2022	P0
29	FOR PLANNING	04/07/2022	P0
30	FOR PLANNING	04/07/2022	P0
31	FOR PLANNING	04/07/2022	P0
32	FOR PLANNING	04/07/2022	P0
33	FOR PLANNING	04/07/2022	P0
34	FOR PLANNING	04/07/2022	P0
35	FOR PLANNING	04/07/2022	P0
36	FOR PLANNING	04/07/2022	P0
37	FOR PLANNING	04/07/2022	P0
38	FOR PLANNING	04/07/2022	P0
39	FOR PLANNING	04/07/2022	P0
40	FOR PLANNING	04/07/2022	P0
41	FOR PLANNING	04/07/2022	P0
42	FOR PLANNING	04/07/2022	P0
43	FOR PLANNING	04/07/2022	P0
44	FOR PLANNING	04/07/2022	P0
45	FOR PLANNING	04/07/2022	P0
46	FOR PLANNING	04/07/2022	P0
47	FOR PLANNING	04/07/2022	P0
48	FOR PLANNING	04/07/2022	P0
49	FOR PLANNING	04/07/2022	P0
50	FOR PLANNING	04/07/2022	P0
51	FOR PLANNING	04/07/2022	P0
52	FOR PLANNING	04/07/2022	P0
53	FOR PLANNING	04/07/2022	P0
54	FOR PLANNING	04/07/2022	P0
55	FOR PLANNING	04/07/2022	P0
56	FOR PLANNING	04/07/2022	P0
57	FOR PLANNING	04/07/2022	P0
58	FOR PLANNING	04/07/2022	P0
59	FOR PLANNING	04/07/2022	P0
60	FOR PLANNING	04/07/2022	P0
61	FOR PLANNING	04/07/2022	P0
62	FOR PLANNING	04/07/2022	P0
63	FOR PLANNING	04/07/2022	P0
64	FOR PLANNING	04/07/2022	P0
65	FOR PLANNING	04/07/2022	P0
66	FOR PLANNING	04/07/2022	P0
67	FOR PLANNING	04/07/2022	P0
68	FOR PLANNING	04/07/2022	P0
69	FOR PLANNING	04/07/2022	P0
70	FOR PLANNING	04/07/2022	P0
71	FOR PLANNING	04/07/2022	P0
72	FOR PLANNING	04/07/2022	P0
73	FOR PLANNING	04/07/2022	P0
74	FOR PLANNING	04/07/2022	P0
75	FOR PLANNING	04/07/2022	P0
76	FOR PLANNING	04/07/2022	P0
77	FOR PLANNING	04/07/2022	P0
78	FOR PLANNING	04/07/2022	P0
79	FOR PLANNING	04/07/2022	P0
80	FOR PLANNING	04/07/2022	P0
81	FOR PLANNING	04/07/2022	P0
82	FOR PLANNING	04/07/2022	P0
83	FOR PLANNING	04/07/2022	P0
84	FOR PLANNING	04/07/2022	P0
85	FOR PLANNING	04/07/2022	P0
86	FOR PLANNING	04/07/2022	P0
87	FOR PLANNING	04/07/2022	P0
88	FOR PLANNING	04/07/2022	P0
89	FOR PLANNING	04/07/2022	P0
90	FOR PLANNING	04/07/2022	P0
91	FOR PLANNING	04/07/2022	P0
92	FOR PLANNING	04/07/2022	P0
93	FOR PLANNING	04/07/2022	P0
94	FOR PLANNING	04/07/2022	P0
95	FOR PLANNING	04/07/2022	P0
96	FOR PLANNING	04/07/2022	P0
97	FOR PLANNING	04/07/2022	P0
98	FOR PLANNING	04/07/2022	P0
99	FOR PLANNING	04/07/2022	P0
100	FOR PLANNING	04/07/2022	P0