

Goodenough College  
House 47  
Gas Pipe Replacement

Hi Jason

Below are the routes of the existing, council approved and newly proposed routes for the gas pipe replacement. We request for council approval on the new route, as the current gas pipe is corroded and needs urgent replacement.

**Existing:**

The pipe runs from the mains and deviates under the adjacent property (Coram Fields) and out back into our lightwell. Approval to dig down to access from the Coram Fields property was denied and therefore a new proposal was submitted which would eliminate the need to access the adjacent property.

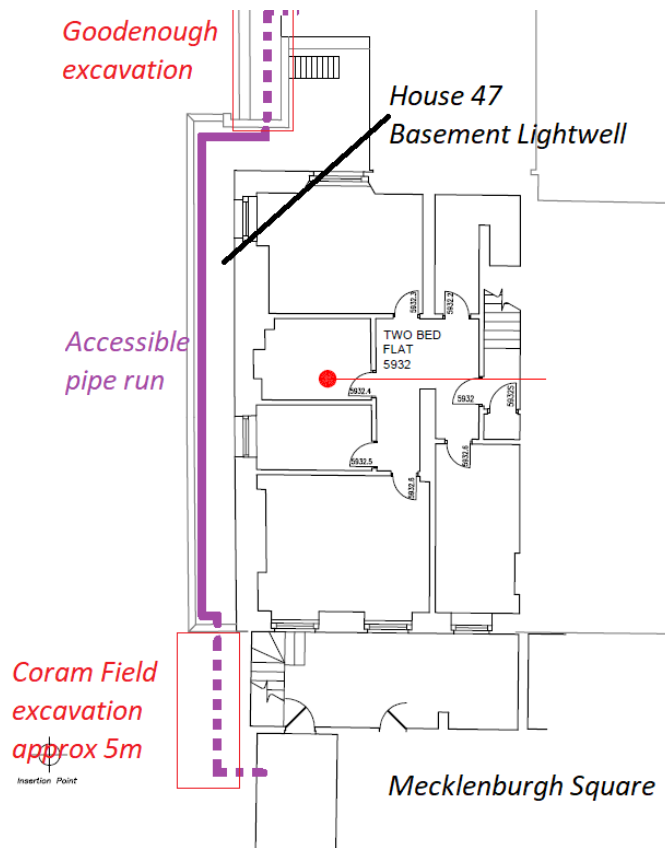

### Council approved route

The approved route (Application ref: 2021/4518/L) was to run the gas pipe out below the lightwell steps and into the building and out into the adjacent lightwell as no other alternative route was known of at the time.

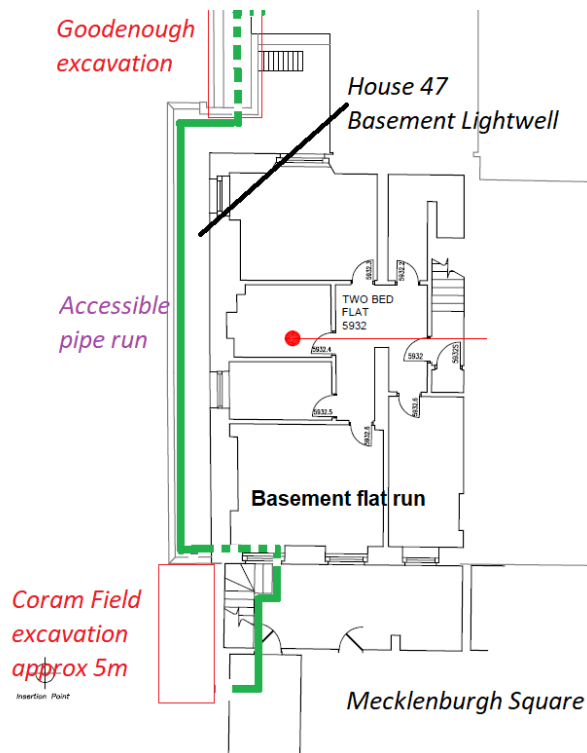

**New proposal**

Following opening up works an alternative pipe route is now available to us. This route allows the pipe to run under the lightwell steps and out through one of the steps and up the side lightwell wall and into the adjacent lightwell. We have been advised by our contractors following talks with Gas Safe that as there is an alternative route now possible, we should not run the pipe through the building due to H&S.

This route has the benefit of:

1. The amount of visible pipe is minimised greatly
2. The H&S risk of running a commercial gas pipe through a residential building has been eliminated.
3. Running a commercial pipe through the building would also now need additional ventilation created within the flat itself.
4. There will be no damage/opening up works required to the fabric of the building. Therefore, the integrity of the building will be persevered.

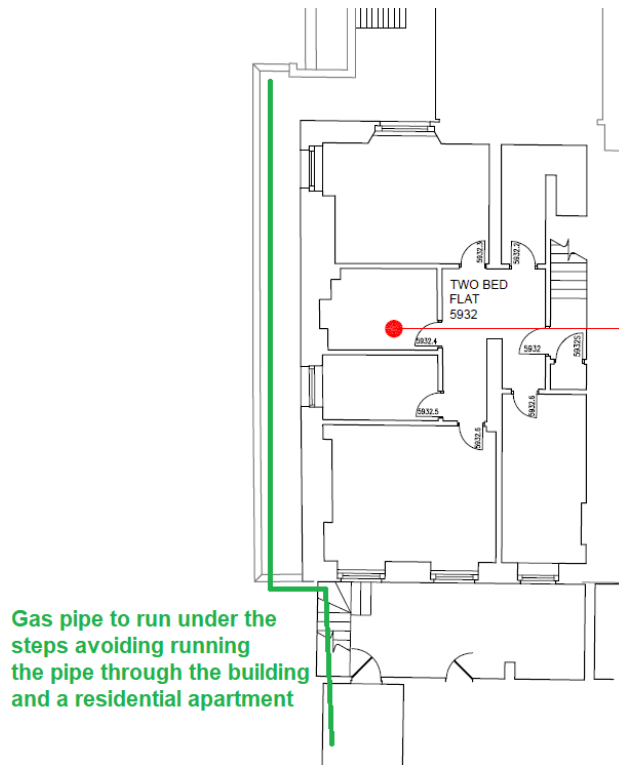



Gas pipe runs through the void under the steps and through the step, this will be done by core drilling through the step minimising damage. Minimal gas pipe will be visible as it extends up from the step into the adjacent lightwell wall. As opposed to the previous option which would have been more visible and created a potential trip hazard.

Site Location Plan

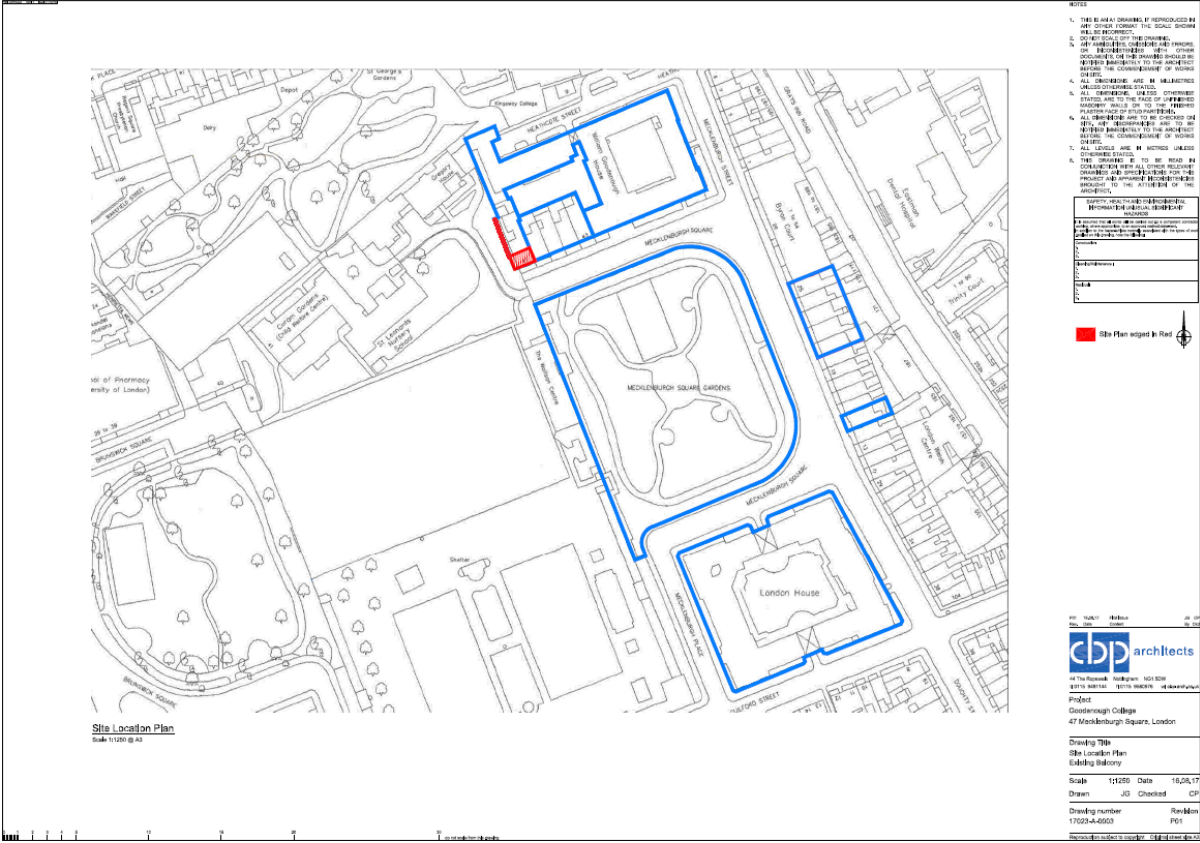



Gas pipe replacement in adjacent lightwell

Red line indicates the approximate area where the gas pipe will enter this lightwell from the front lightwell.

