

Half Brick Wall in stretcher bond  
 G20/210 Level of Dowel Laminated Timber, refer to structural engineer's drawings and specification  
 Structural opening for window  
 F10/110 Special shaped brick type A  
 F10/110 Special shaped brick type B  
 F10/110 Special shaped brick type C

F10/110 Skewback brick, special shaped brick type 3  
 Obscure Glazing

Elevation

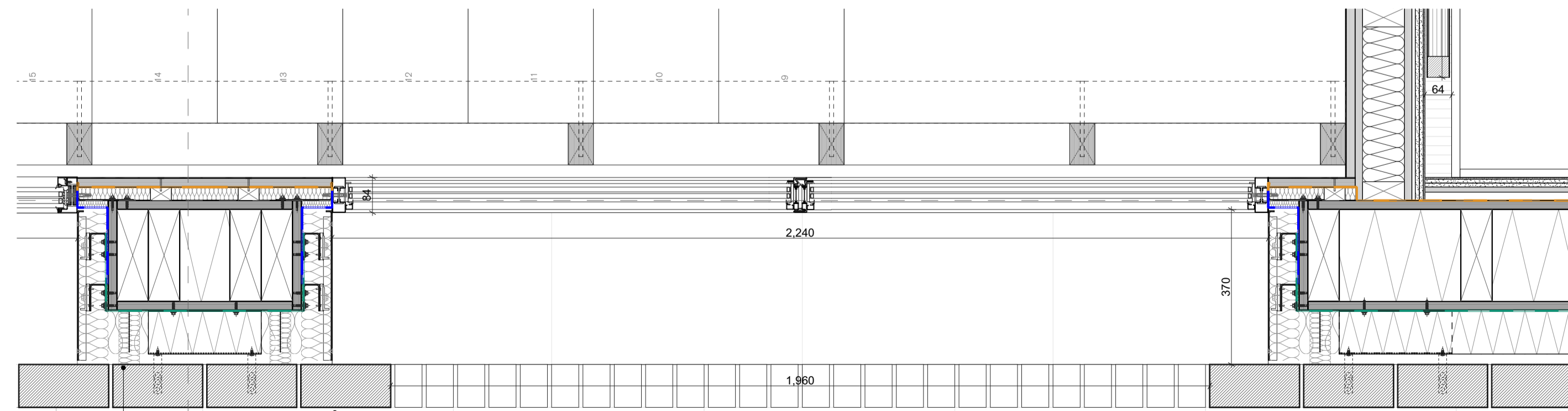

Plan

H92/110 Steel sheet hook-on panel  
 P10/410 Cavity barrier mineral wool  
 F30/248 Brick cavity tie  
 P10/320 Breather membrane

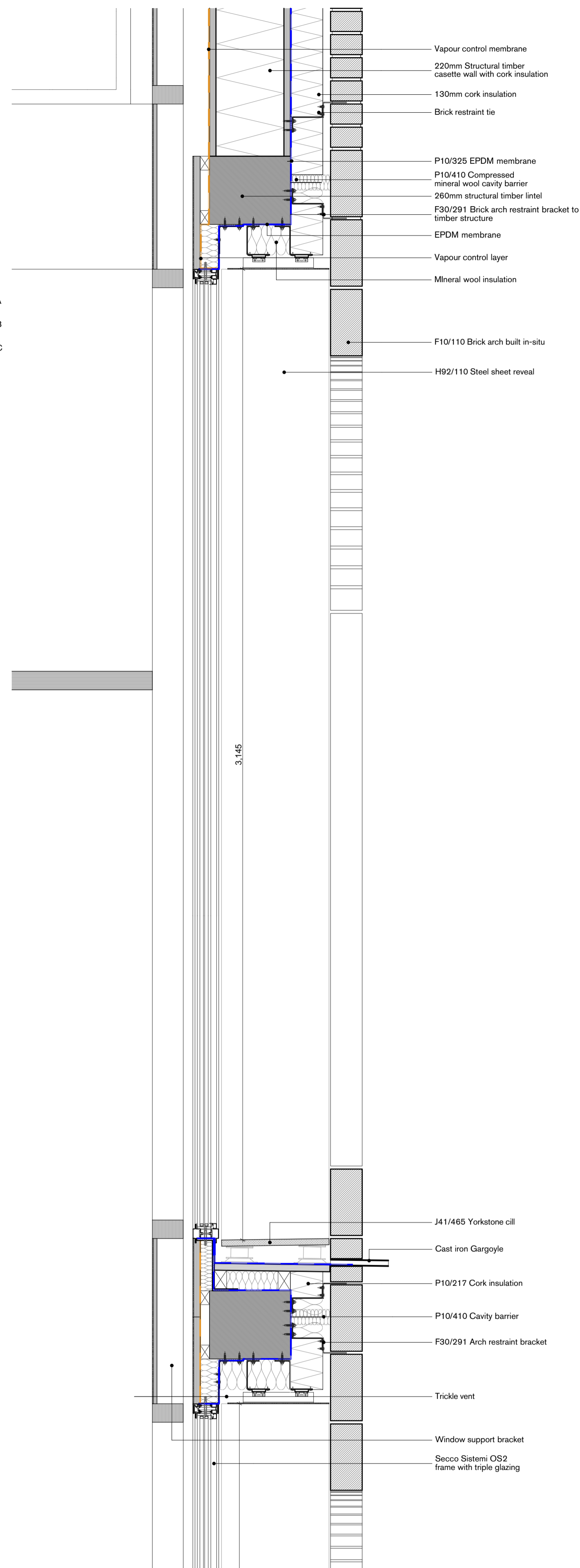

Section

Type B Obscure fixed staircase window

Secco System OS2-75 fixed window with opaque glazing, 84mm galvanised steel frame, powder coated Interpon D2525, Triple glazed unit u-value 1.3 W/(m²K), Security rating: RC3

Vapour control membrane  
 220mm Structural timber cassette wall with cork insulation  
 130mm cork insulation  
 Brick restraint tie  
 P10/325 EPDM membrane  
 P10/410 Compressed mineral wool cavity barrier  
 250mm structural timber lintel  
 F30/291 Brick arch restraint bracket to timber structure  
 EPDM membrane  
 Vapour control layer  
 Mineral wool insulation  
 F10/110 Brick arch built in-situ  
 H92/110 Steel sheet reveal

J41/465 Yorkstone sill  
 Cast iron Gargoyle  
 P10/217 Cork insulation  
 P10/410 Cavity barrier  
 F30/291 Arch restraint bracket  
 Trickle vent  
 Window support bracket  
 Secco Sistemi OS2 frame with triple glazing

**General notes:**  
 All dimensions are approximate and subject to a full measured survey  
 All drawings to be read in conjunction with Structural Engineers and Services Engineers drawings. Any discrepancies are to be highlighted and brought to the attention of the Architects.

**Notes:**

INDEX	DATE	REVISION
T00	10.06.22	Tender Information

**Caruso St John Architects**

9 Lyndhurst Terrace

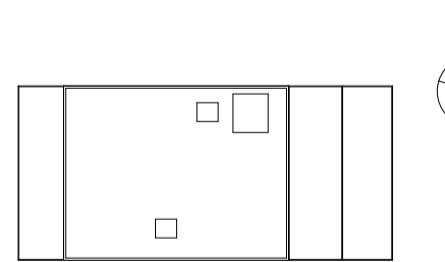

Typical Staircase Window Assembly

Suitable for Tender

474	CSJ	00	ZZ	DE	A	7284	D2	T00
Project No.	Author	Unit	Level	Type	Discipline	Number	Status	Revision
1:10	841 x 594	220713				CC	CC	
Scale	Size W x H (mm)	Date	Revised	Drawn	Checked			

Stage 4	±0.00 = #99.25 AOD
Project phase	Project datum

Client:  
 David Smith and Pushpa Gulhane  
 London, NW3 5QA

Architect:  
 Caruso St John Architects LLP  
 1 Coate Street, London E2 9AG, UK, +44 (0)20 7613 3161, london@carusostjohn.com