

Wainscot Detail - Fig.3



Wainscot - Panelling Detail
MDF Moulding & Panel details to create traditional effect wall panelling - Contractor to provide set out detail prior to construction

Construction Key:

	Type: Non-Sound insulated stud partition wall / Box work - Metal frame stud boxwork with single layer plasterboard lining Notes: Non-Sound insulated. Joints taped & filled to receive decorations. Contractor to verify construction conforms to building regulations. Refer to Drawing 1385-016 for finish details Skirting: 100mm high Painted MDF Flush Shadow gap skirting - Flush Skirting System Supplier: As per Contractor
--	--------------------------------------------------------------------------------------------------------------------------------------------------------------------------------------------------------------------------------------------------------------------------------------------------------------------------------------------------------------------------------------------------------------------------------------------------------------------------

Ceiling Key:

	Type: Indicates Extent of New Ceilings / bulkheads Notes: Plaster Board Finish - Joints Taped & Filled & prepared to receive decorated finish. Contractor to ensure construction conforms to building regulations. Location: Basement Finish: Decorated Finish - Refer to Decoration Plan - TBC
--	-----------------------------------------------------------------------------------------------------------------------------------------------------------------------------------------------------------------------------------------------------------------------------------------------------------------------------------------

Door Key

	Type: Existing Doors Finish: Decorated finish - Refer to Drawing TBC Notes: Contractor to verify condition & suitability of existing Doors Contractor to confirm Fire rating of existing Doors New doors to be provided as required - Contractor to advise
	Type: Standard Plain Door with Square Edge MDF architraves Fire Rating: Refer to door schedule Size: Refer to door schedule Supplier: As per contractor Finish: Decorated finish - Refer to Drawing TBC Notes: Contractor to verify all works conform to building regulations. Skirting to be 100mm High Square Edge MDF - Decorated finish Typical Door - Use with HD 1 Door handle
	Type: Standard Plain Door - Invisible Frames - ACUPANEL Finish Fire Rating: Refer to door schedule Size: Refer to door schedule Supplier: As per contractor Finish: To Receive ACUPANEL Slatted Timber finish Supplier: Smoked Oak ACUPANEL Finish www.thewoodvenerhub.co.uk Notes: Door to be invisible with no visible architraves with continuous ACUPANEL wall cladding to external face along beauty corridor - Contractor to provide setting out detail for approval. Contractor to verify all works conform to building regulations. Skirting to be 100mm - Recessed - Black finish Typical Door - Use with HD 1 Door handle
	Type: Sorrento Black Lever handle on Round Rose Ref: SC-2352 BLK LENA Finish: Black Supplier: www.handles4u.co.uk or as per contractor Notes: Compatible mechanism required Contractor to verify compatibility with doors & locking mechanism
	Type: 52mm ROUND Disabled Thumb Turn with Indicator Ref: 64-5095-F5 Finish: Matt Black To match HD1 Door handle Supplier: www.handles4u.co.uk or as per contractor Notes: Contractor to verify compatibility with doors & locking mechanism Location: D.W.C

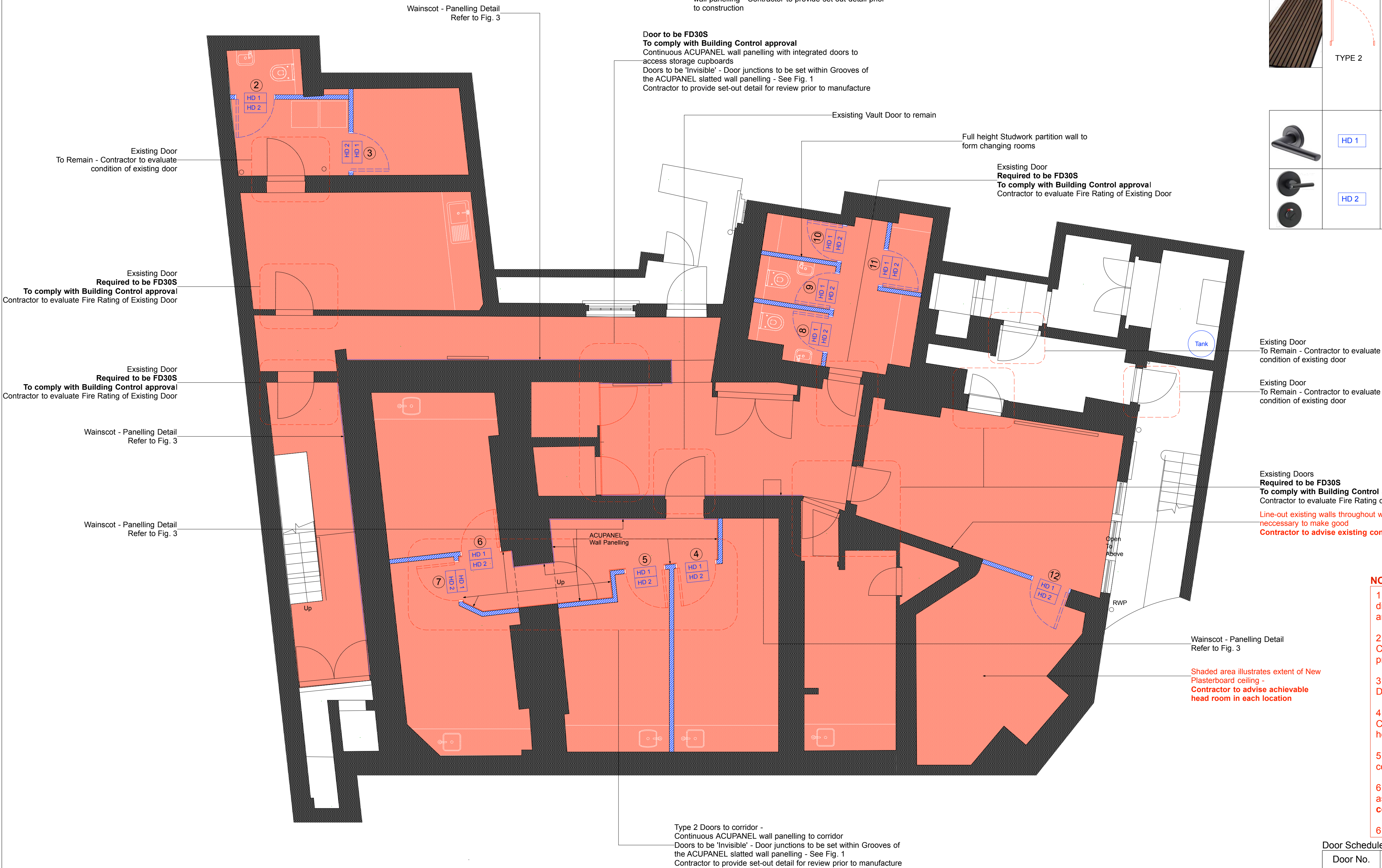

Type 2 Doors to corridor - Continuous ACUPANEL wall panelling to corridor
Doors to be 'Invisible' - Door junctions to be set within Grooves of the ACUPANEL slatted wall panelling - See Fig. 1
Contractor to provide set-out detail for review prior to manufacture

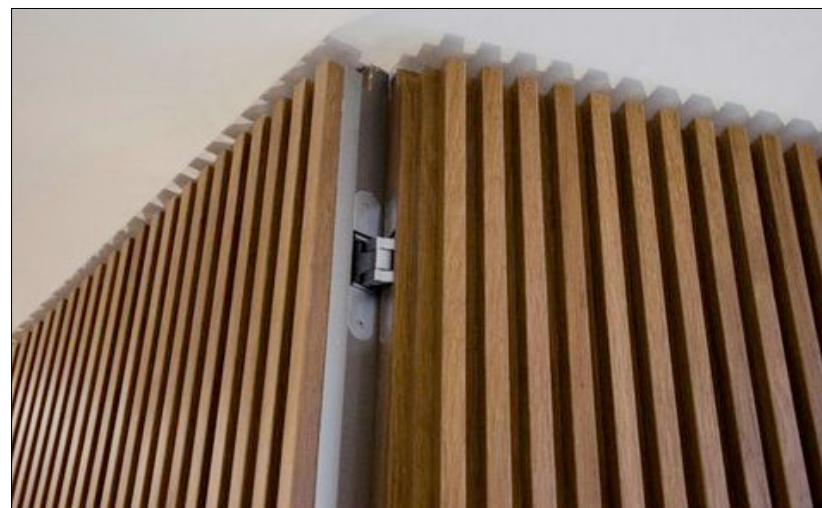

Fig. 1



Fig. 2 - ACUPANEL Wall Panelling

NOTES:

1. Dimensions shown are indicative only. Contractor to verify all dimensions on site prior to construction and notify Reis Design of any site discrepancies.
2. This drawing is intended to illustrate design intent only. Contractor to supply setting-out details for approval by Reis design prior to manufacture.
3. All works to comply with latest Building Regulations Door Fire Rating status - Subject to Building Control approval
4. Indicative location for water heater located within Plant Room. Contractor to advise suitable specification & location for water heater to facilitate adequate hot water supply for the salon.
5. Existing Air Conditioning to be utilised - Contractor to advise condition / Functionality of existing equipment.
6. Line-out existing walls throughout with new plasterboard finish as necessary to make good - **Contractor to advise existing condition of existing wall finishes**
6. Basement Pipe routes to be located at ceiling level

Door Schedule

Door No.	Type	Size (Estimated)	Fire rating
2	Standard Door	850mm W x 2100mm H	None
3	Standard Door	850mm W x 2100mm H	None
4	Standard Door	850mm W x 2100mm H	FD30S
5	Standard Door	850mm W x 2100mm H	FD30S
6	Standard Door	850mm W x 2100mm H	FD30S
7	Standard Door	850mm W x 2100mm H	FD30S
8	Standard Door	850mm W x 2100mm H	None
9	Standard Door	850mm W x 2100mm H	None
10	Standard Door	850mm W x 2100mm H	None
11	Standard Door	850mm W x 2100mm H	None
12	Standard Door	850mm W x 2100mm H	FD30S