



17 North End

Site

Wildwood

**GENERAL NOTES**

All dimensions to be checked on site.  
Report any discrepancies to the Architect.

**Key**

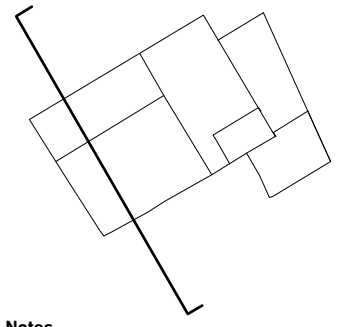

**Notes**

- A - External Wall
- A1 - Lime render
- A2 - Concrete plinth
- A3 - Timber weatherboard
- A4 - Yellow stock brick to match existing
- A5 - Timber screen
- A6 - Timber columns
  
- B - Windows
- B1 - Timber windows
- B2 - PPC aluminium window
  
- C - External Doors
- C1 - Solid timber panel door
- C2 - Glazed timber door
  
- D - Roof
- D1 - Bauder extensive sedum green roof
- D2 - Standing seam zinc

rev A 30.05.22 Minor Amendments

**Artefact**  
info@artefact-studio.com

**Project Name** North End  
**Project Reference** NOR  
**Project Address** Land at Rear of 17 North End  
 NW3 7HR  
**Drawing Name** Proposed Garden NE Elevation

**Drawing Number** 302 **Revision** A

**Scale** 1:100 @A3 **Date** 03 12 21  
 1:50 @A1

**Drawing Status** Planning

