

- JOB:**
St Pancras Chambers
- REVISIONS:**
- A:17.04.10 - M.Tait**
 - 1. Ceiling height lowered in both Wc.s.
 - 2. Shadow gaps to wall panels & wc removable wall panels amended.
 - 3. Vanity Units amended..
 - 4. Floor tiling size confirmed & setting out points adjusted.
 - 5. Wc cubicle entrance wall fascia panelling amended.
 - 6. Patresses to artwork/mirrors shown.
 - 7. Picture rail omitted.
 - 8. Lower service wall shown.
 - B:13.09.10 - M.Tait**
 - Drg updated to reflect latest architects comments.
 - C:30.10.10 - M.Tait**
 - Drg updated to reflect latest architects comments.
 - D:18.11.10 - M.Tait**
 - Low level service wall amended and coat hook positions changed.
 - E:15.12.10 - G.Olszynska**
 - Urinal modesty screen design revised.
 - Door stop and coat hook positions revised.

CLIENT:
Galliford Try
St Pancras Chambers
Euston
London

PROJECT:
St Pancras Chambers - Hotel
Euston
London

TITLE:
Public Areas - Wc's
Platform-Mezzanine Level PM.004-005
Floor Plan

DRAWING No:
PA.WC/PM.004-005/01

REVISION: REV E	APPROVED FOR DISTRIBUTION BY:
DRAWN BY: M.Tait	DATE: 29th Jan 10
SCALE: NTS	SHEET: A1

DRAWING FILE NAME (DWG):
ST PANCRAS CHAMBERS - HOTEL M1448 (PA.WC/PM.004-005/01)

DRAWING FILE LOCATION:
C:\Quote\N6\02801-2803\02818 St Pancras Chambers\Drawings\Design\St Pancras Chambers Hotel M1448

COPYRIGHT

THIS DRAWING THE INFORMATION CONTAINED AND THE DESIGNS EXPRESSED ARE THE SOLE PROPERTY AND COPYRIGHT OF MARTEK CONTRACTS LTD. REPRODUCTION IN ANY FORM BY ANY PERSONS OF THE WHOLE OR ANY PART OF THIS DRAWING OR THE USE OF THE INFORMATION IN WRITING BY THIRD PARTY UNLESS EXPRESSLY AUTHORISED IN WRITING BY MARTEK CONTRACTS LTD. WILL BE AN INFRINGEMENT OF COPYRIGHT.

Martek
INTERIORS CONCEPTS
Martek Contracts Ltd
High Point Mill
King Henry's Drive, New Addington
Croydon, Surrey, CR0 0AE, England
tel: +44 (0)1689 808 600 fax: +44 (0)1689 808 608
e-mail: cad@martek.co.uk internet: www.martek.co.uk

Martek CRS Inc.
2153 Wealthy Street SE, Suite 303
Grand Rapids, MI 49505, USA
tel: +1 (616) 363-2900 fax: +1 (616) 454-4001
e-mail: cad@martek-us.com internet: www.martek-us.com

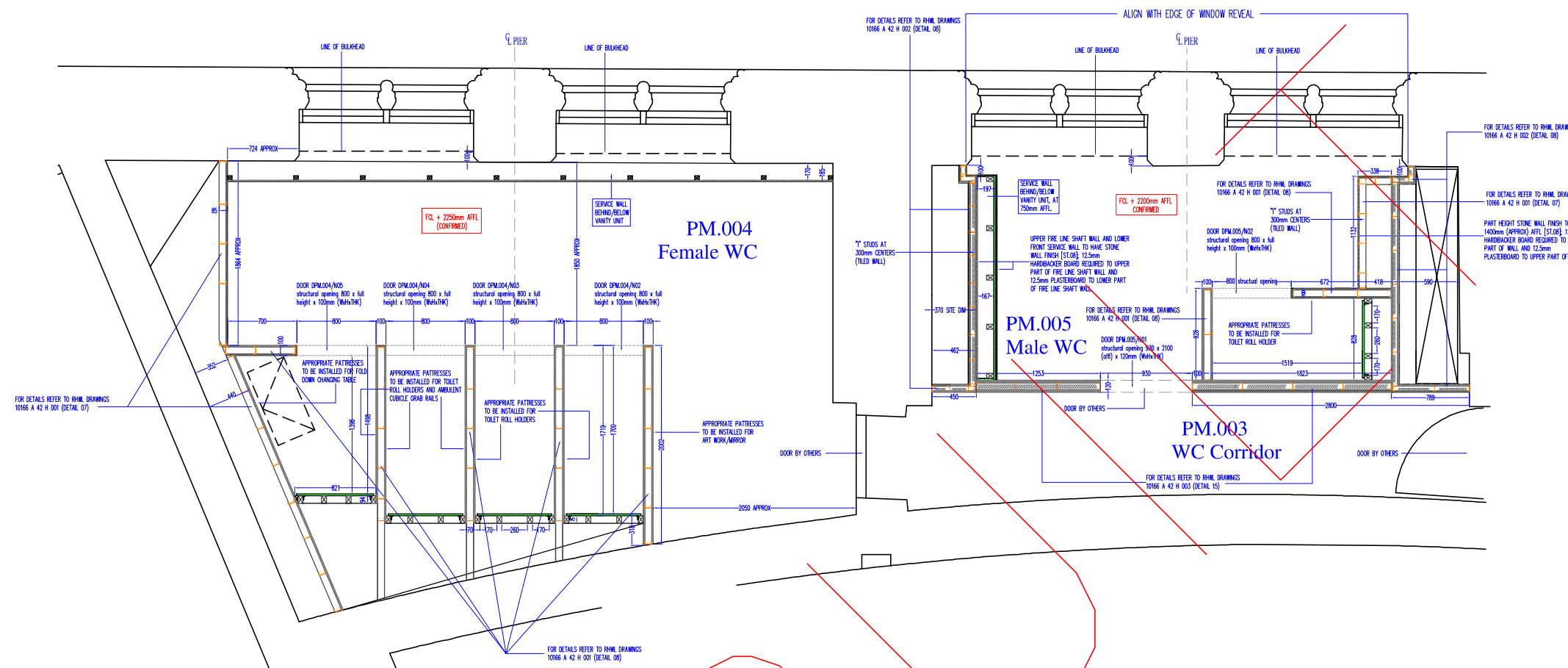

01 PM.004 & PM.005 MALE & FEMALE WC'S (PUBLIC AREA)
FLOOR PLAN - DRYLINING SETTING OUT

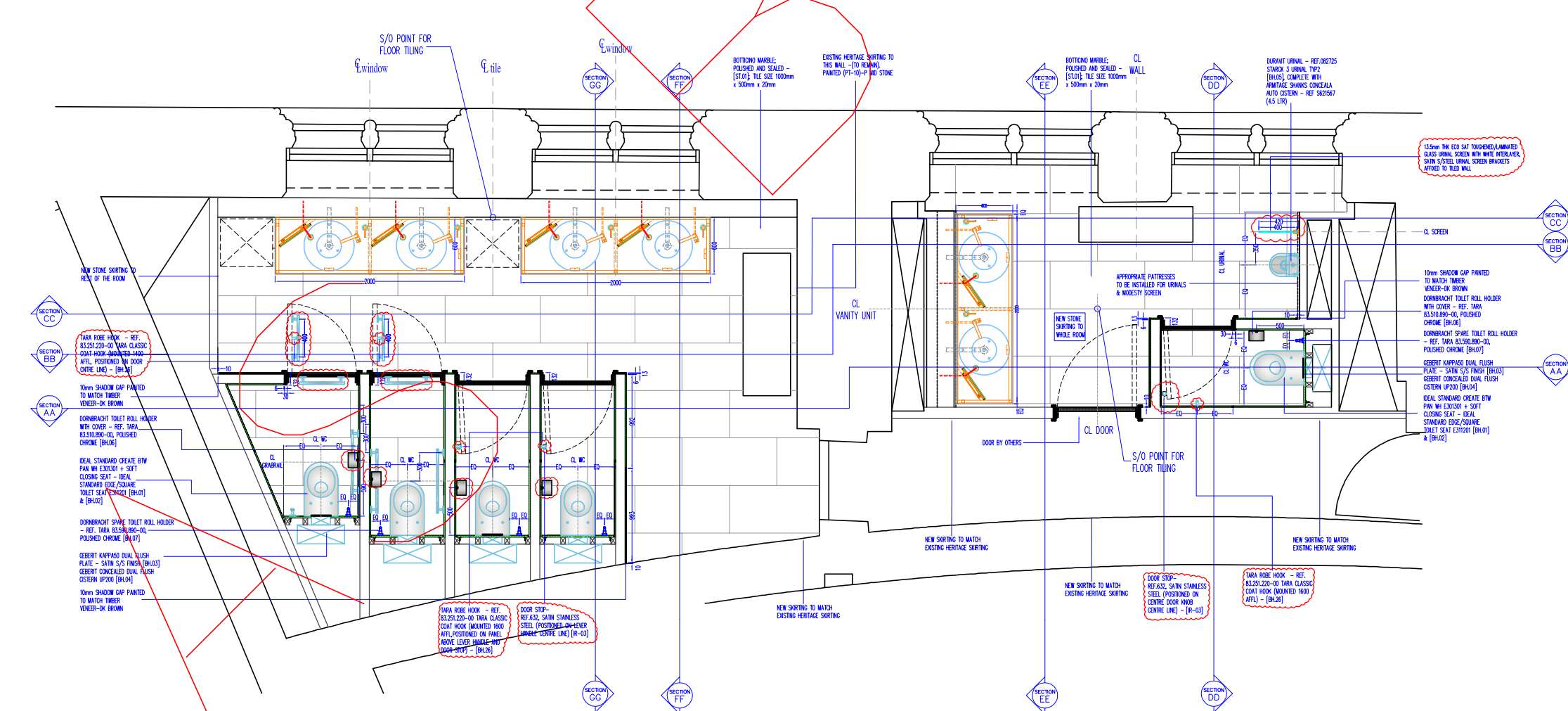

02 PM.004 & PM.005 MALE & FEMALE WC'S (PUBLIC AREA)
FLOOR PLAN