



**Starbucks Coffee Company**  
 Building 4, Chiswick Park  
 566 Chiswick High Road  
 London, W4 5YE

These Drawings and Specifications are confidential and shall remain the sole property of Starbucks Corporation, which is the owner of the copyright in this work. They shall not be reproduced (in whole or in part), shared with third parties or used in any manner on other projects or extensions to this project without the prior written consent of Starbucks Corporation. These drawings and specifications are intended to express Design Intent for a prototypical Starbucks store (which is subject to change at anytime) and do not reflect actual site conditions. Neither party shall have any obligation nor liability to the other (except as stated above) until a written agreement is fully executed by both parties.

**Architect of Record**  
 Evolve Architecture  
 Unit 1-02 The Hive  
 6 Beaufighter Road  
 Weston Super Mare  
 North Somerset  
 BS24 8EE



Revision Schedule			
Rev	Date	By	Description

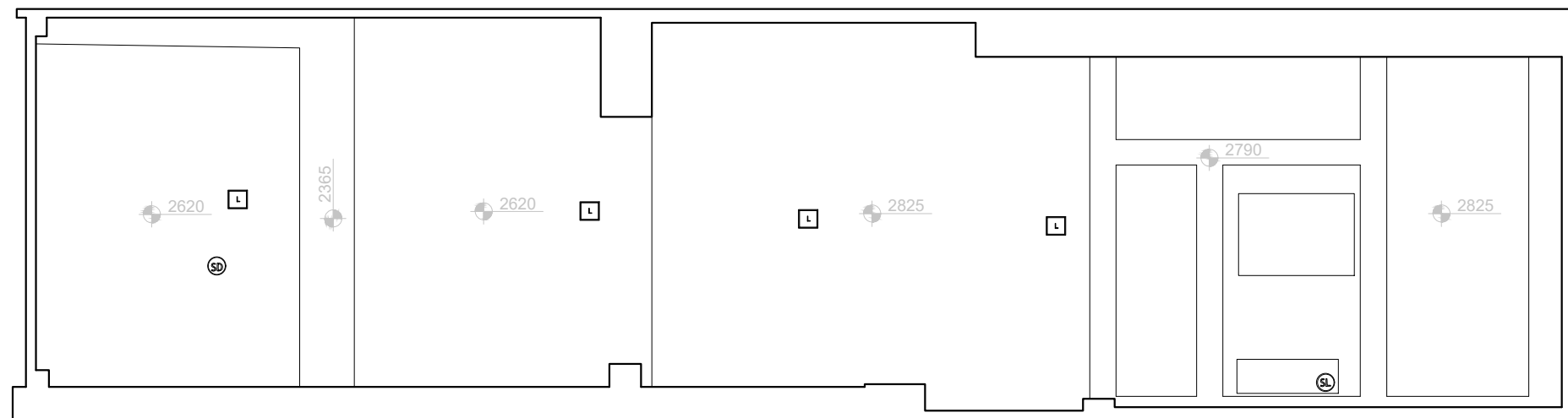

**EXISTING RCP GROUND FLOOR**

SCALE: 1:75

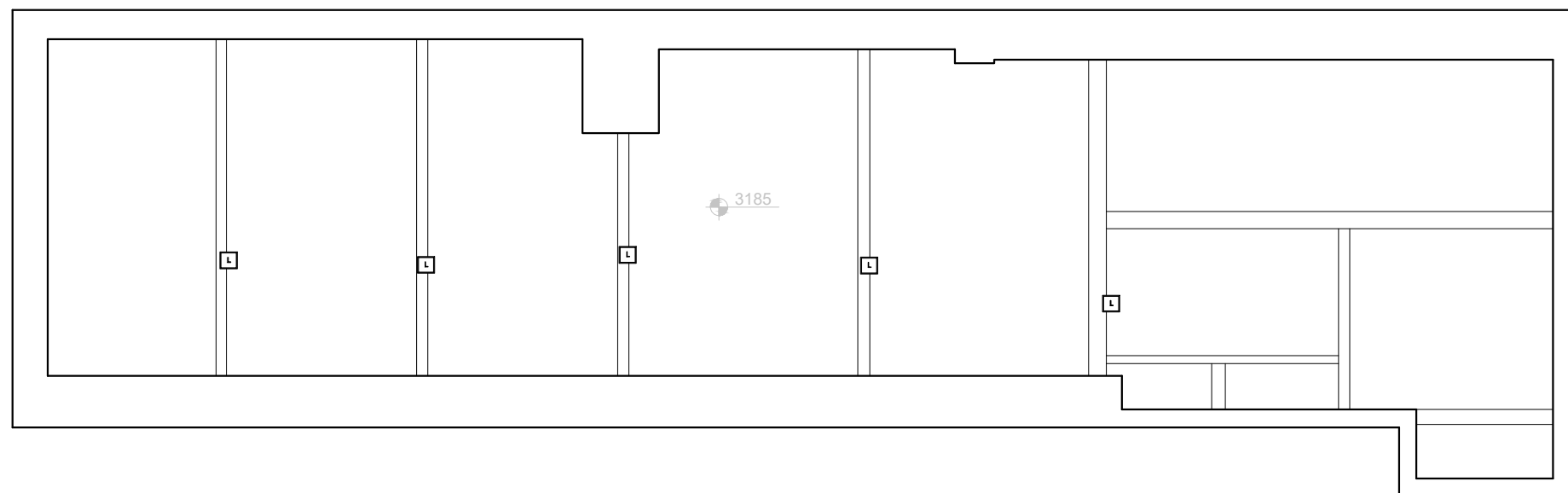

**EXISTING RCP BASEMENT FLOOR**

SCALE: 1:75

- L Light
- SD Smoke detector
- SL Spot Light

CONSTRUCTION DRAWING SET

Project Name:  
**CAMDEN - 253 HIGH ST**

Project Address:  
**UNITED KINGDOM  
 LONDON  
 CAMDEN 253 HIGH STREET  
 NW1 8NJ**

Store #: 68515  
 Project #: 94563-001  
 Concept:  
 Palette:  
 Issue Date: 16/05/22  
 Design Manager: ADRIENNE COOPER  
 Project Designer: JULIA JANOSA  
 Production Designer: MJ (EVOLVE)  
 Checked by: RM (EVOLVE)

Sheet Title:  
**Existing RCP**

Scale: As indicated

Sheet Number:  
**SH-1003**