

SCREEN 1 EXIT  
GROUND FLOOR LEVEL  
Scale 1:100@A1

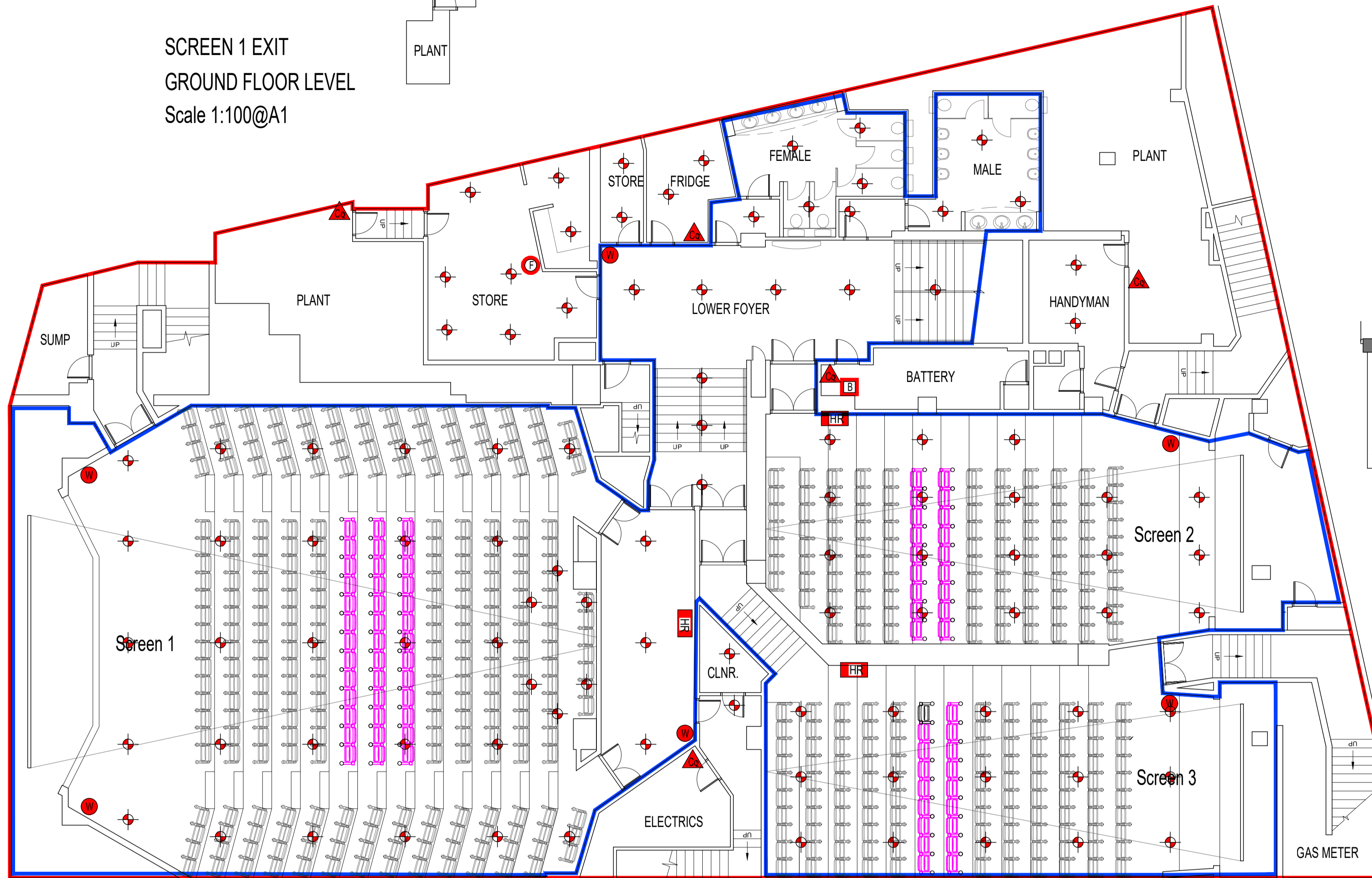

BASEMENT PLAN  
Scale 1:100@A1

FIRE EQUIPMENT KEY :-

- Water Fire Extinguisher.
- Carbon-dioxide Fire Extinguisher.
- Foam Fire Extinguisher.
- Fire Bucket
- Dry Powder Fire Extinguisher.
- Hose Reel
- Sprinkler Heads at ceiling level

FIRE ALARMS: a fully automatic fire alarm system in accordance with BS:5839 Part 1: 2002 is installed. This system provides automatic detection to at least the L2 standard of the BS. The means of warning is voice evacuation.

FIRE DOORS: a fire risk assessment in accordance with the Regulatory reform (Fire Safety) Order 2005 has been completed for the premises. This has concluded that the fire doors and other aspects of fire separation are suitable, subject to the recommendations contained within the assessment.

EMERGENCY LIGHTING: a fire risk assessment in accordance with the regulatory Reform (Fire safety) order 2005 has been completed for the premises. This has concluded that the emergency lighting throughout the premises is adequate, subject to the recommendations contained within the assessment.

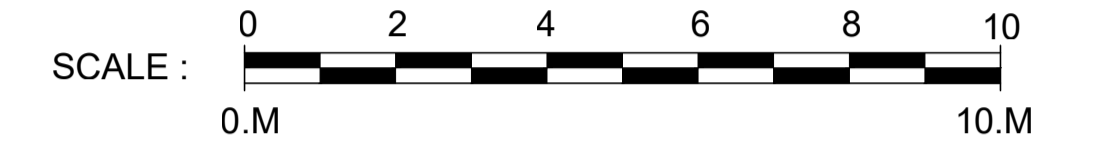

LICENSING KEY :

ENTERTAINMENT ELEMENTS  
(Video / projection equipment showing film trailers)

DENOTES AREA TO BE USED FOR THE PROVISION OF REGULATED ENTERTAINMENT / PROVISION OF ENTERTAINMENT FACILITIES / PROVISION OF LATE NIGHT REFRESHMENT / SALE BY RETAIL OF ALCOHOL

EXTENT OF ODEON DEMISE

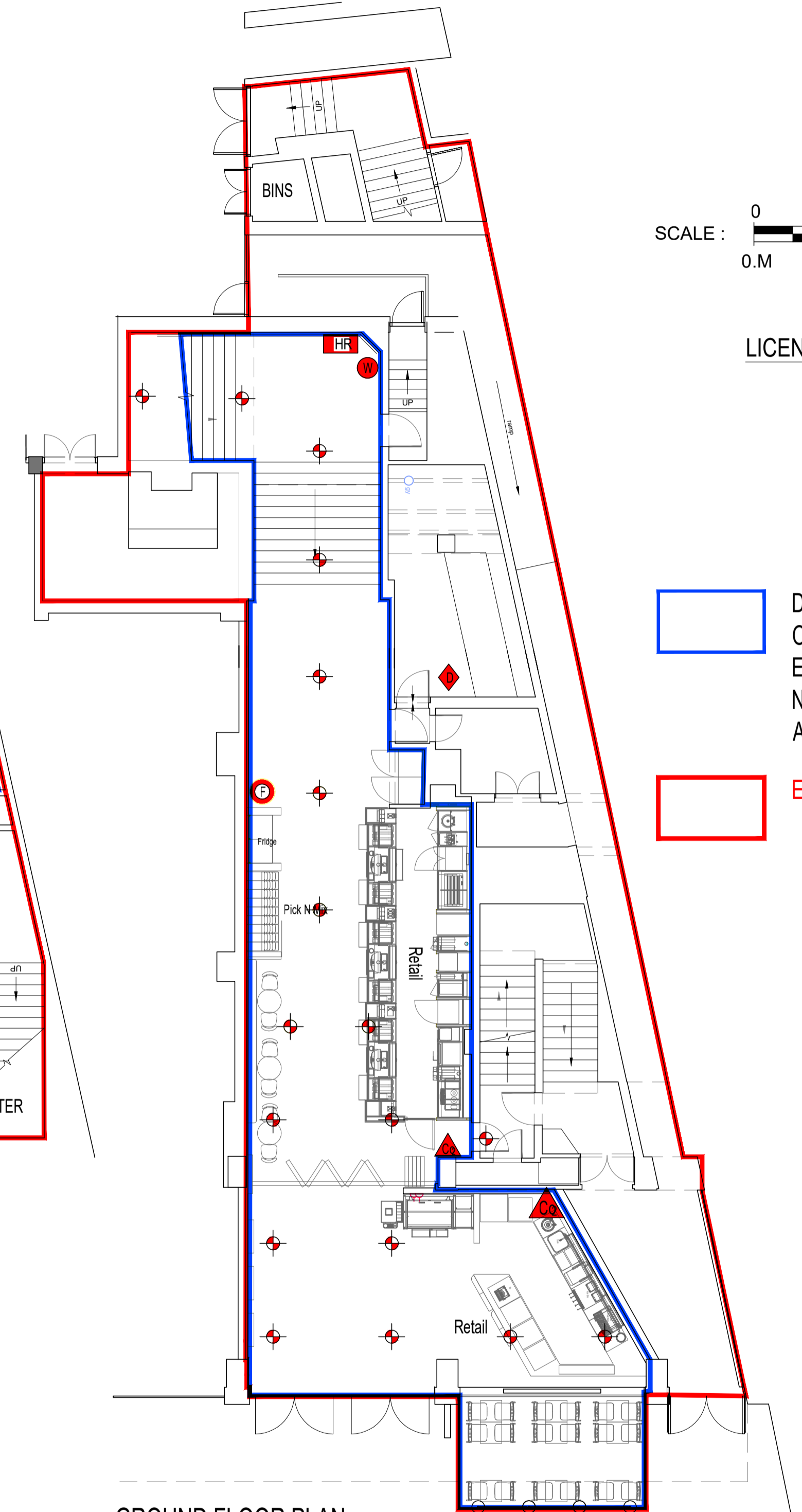

GROUND FLOOR PLAN  
Scale 1:100@A1

Revision	Description	Date
A	Updated licencing drawing	30.06.22

**NB DA**  
Architects

www.nbda-architects.co.uk Tel 01625 575550

Client ODEON CINEMAS

Project ODEON TOTTENHAM COURT ROAD

Drawing LICENSING DRAWING  
BASEMENT AND GROUND FLOOR

Drawing No. 2119\TCR-002 Revision A

Scale 1:100@A1 Date 30.06.22 Drawn AT

This drawing is copyright of N.B.D.A. Ltd. and should not be reproduced without permission. Dimensions should not be scaled off this drawing. All dimensions should be checked on site.