

PV SOLAR SYSTEM SIZE (9.37 KW-DC STC)
(25) LONGI SOLAR LR4-60HPH-375M PANELS
13 X1 PANELS CONNECTED IN STRING TO MPPT #1
12 X1 PANELS CONNECTED IN STRING TO MPPT #2

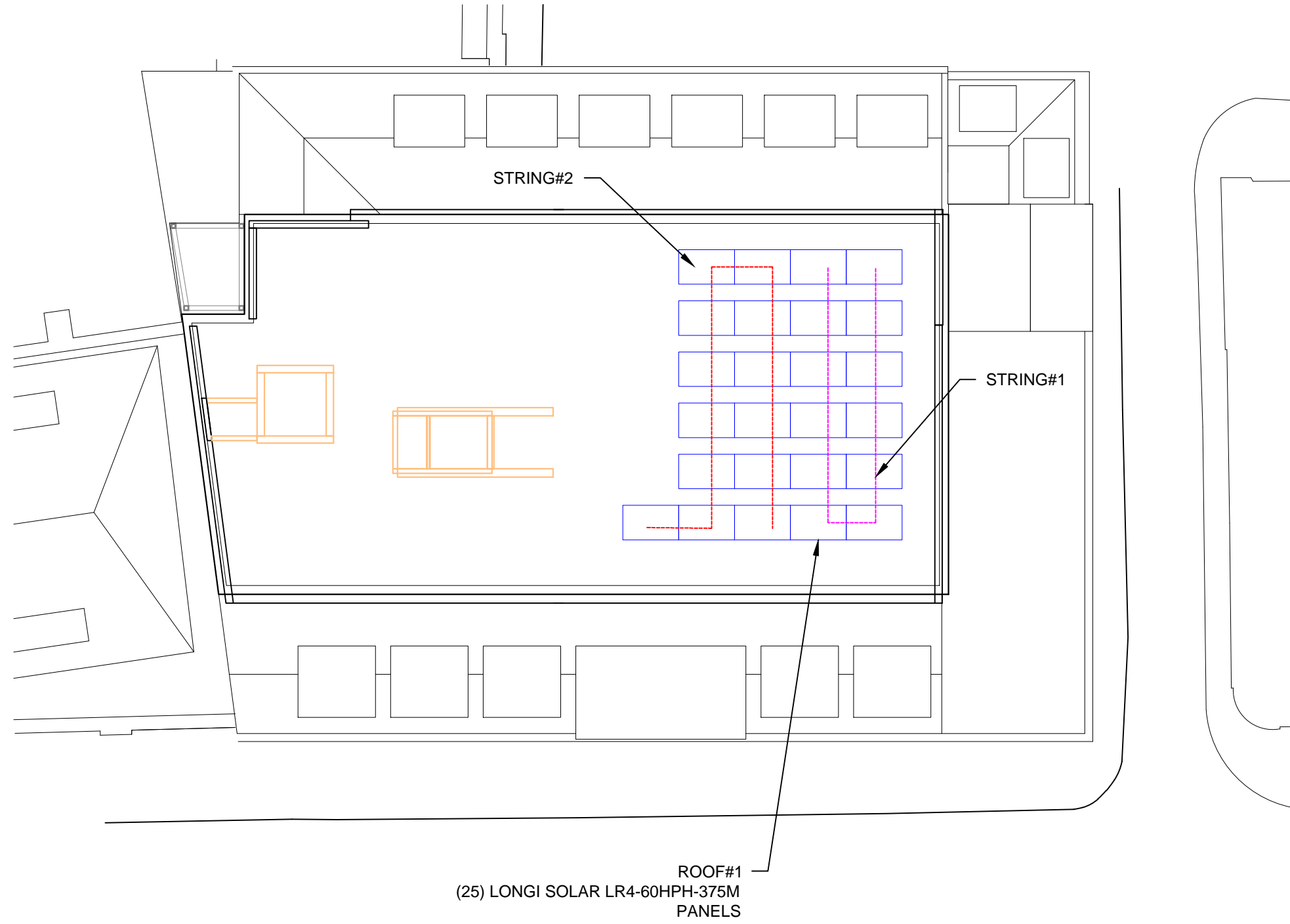

ELCO GROUP LTD
 UNIT 67 BASEPOINT BUSINESS
 CENTRE, VICTORIA RD
 DARTFORD, KENT, DA1 5FS UK
 Ph:- 01322-479957
 Email:- info@elco-group.co.uk

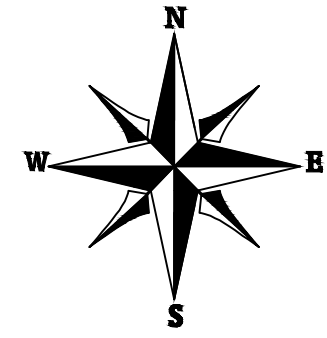

DATE	20/08/2021
DESIGN BY	
CHECKED BY	
REVISION	

PROJECT NAME

 GREVILLE STREET

SHEET NAME
**STRING PLAN
 DETAILS**

SHEET SIZE
 ANSI B
 279 X 432

SHEET NUMBER
E.02

1 **STRING PLAN DETAILS**
 SCALE: 1:150