

EXISTING USE = VACANT OFFICE

Reference: Proposed Plans 1

Existing Temporary Walls

PROPOSED SITE

PROPOSED TEMPORARY WALLS

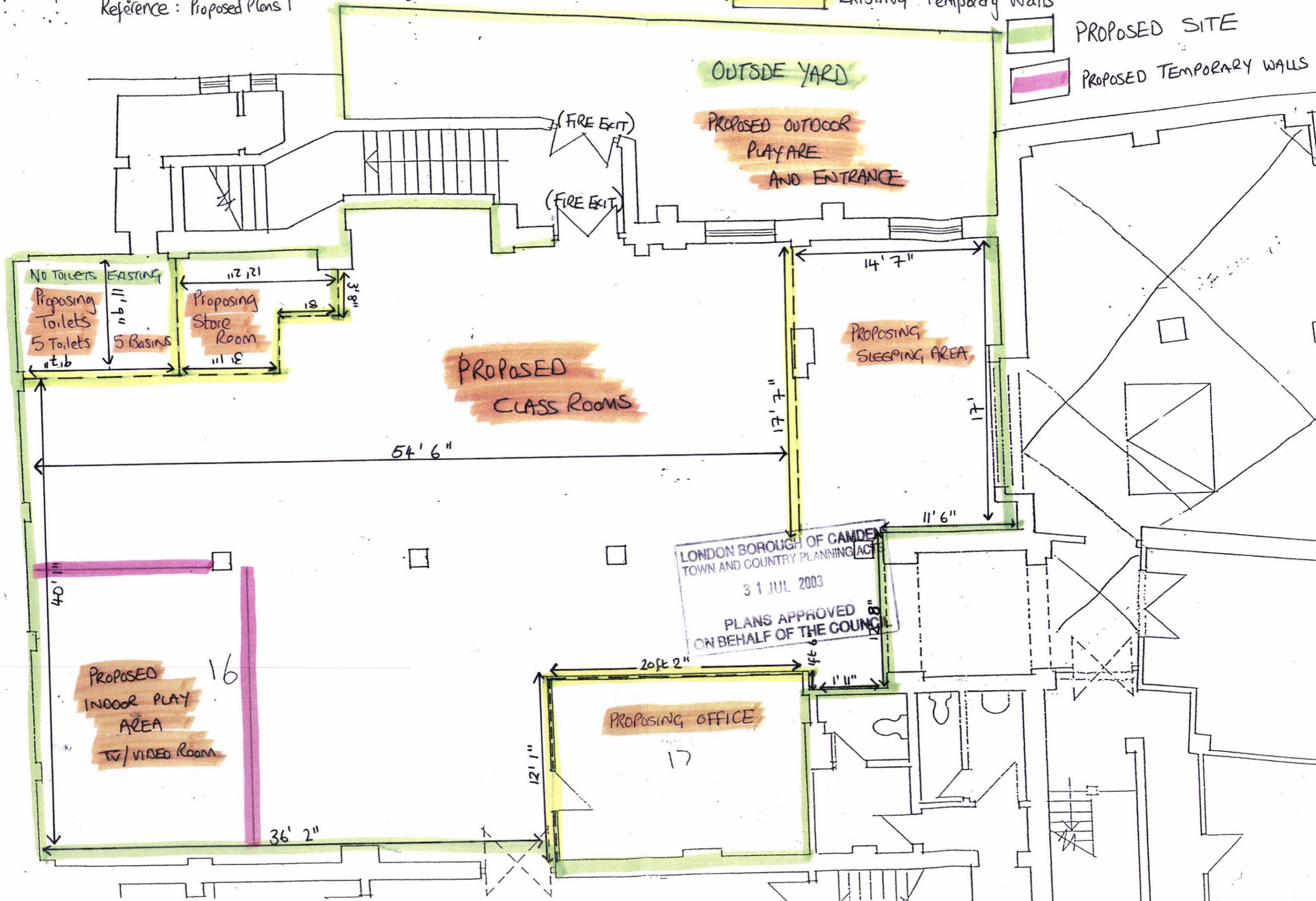

OUTSIDE YARD
PROPOSED OUTDOOR
PLAY AREA
AND ENTRANCE

PROPOSED
CLASS ROOMS

PROPOSING
SLEEPING AREA

NO TOILETS
EXISTING
11' 9"
5 Basins
11' 12"
12' 21"
3' 8"
18"
11' 12"
PROPOSING
TOILETS
5 Toilets
11' 16"

PROPOSING
STORE
ROOM

LONDON BOROUGH OF CAMDEN
TOWN AND COUNTRY PLANNING ACT
31 JUL 2003
PLANS APPROVED
ON BEHALF OF THE COUNCIL

PROPOSED
INDOOR PLAY
AREA
TV/VIDEO ROOM

PROPOSING OFFICE

54' 6"

40' 11"

16

20ft 2"

12' 1"

36' 2"

17

14' 7"

17' 7"

17'

11' 6"

8' 1"

1' 11"

12' 1"

12' 1"