

Typical Permeable Paving Construction Detail
Scale 1:10

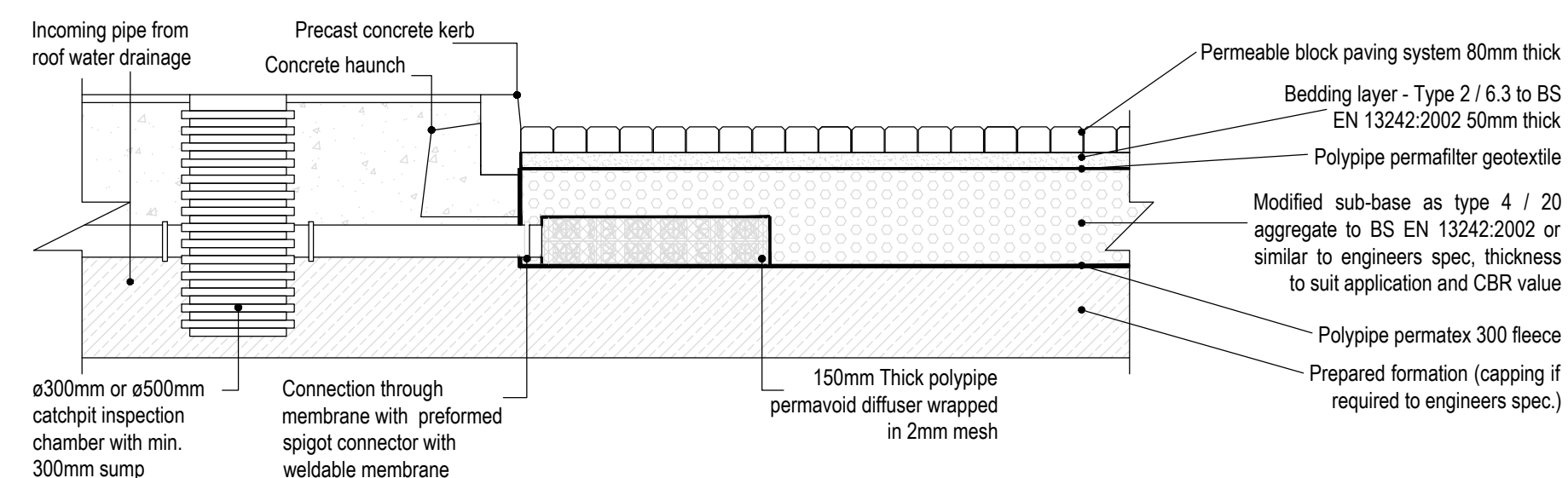

Typical Detail for Rainwater Downpipe Drainage into a Sub-Base Reservoir
Scale 1:20

- General Notes:
1. Do not scale this drawing. All dimensions are in metres unless otherwise noted. Any discrepancies are to be recorded and reported to the engineers immediately.
 2. This drawing is to be read in conjunction with all other engineers and architects drawings, and the specification.
 3. All work is to be to the satisfaction of the engineer and local authority building control.
 4. The contractor is responsible for and must take all necessary precautions to ensure the stability of the works at all times during construction.
 5. All workmanship and materials are to be to current British Standards.
 6. All services are to be located and protected as necessary by the contractor prior to the commencement of the works.
 7. Any existing details which are shown on this drawing are for guidance only and are to be checked on site by the contractor. Any variations are to be recorded and reported to the engineer immediately.
 8. All highway works are to be in accordance with the local authorities design guide and specification.
 9. Prior to the occupation of the first dwelling, street nameplates shall be erected in accordance with the highway authority and to the wording agreed with the planning authority.
 10. During construction works on site, all roads and footpaths are to be swept and kept clear of obstructions; this is to include existing highways as appropriate to ensure safe passage of all road users.
 11. Provision shall be made for the installation of all mains services including ducting prior to the laying of the road base-course.
 12. All road markings and signs are to be in accordance with 'the traffic signs regulations and directions' 2016.
 13. All sewer works are to be in accordance with sewers for adoption 6th edition.
 14. All private connections to adoptable sewers should be a minimum of 100mm diameter (boul) and 150mm diameter (surface) made in vitrified clay connecting suilt to soilt.

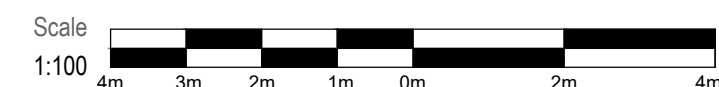

PT Preliminary Issue		LF	DB	24.06.2022
Issue	Notes	Drawn	Approved	Date
<div><div>SuDS DESIGNS Sustainable Drainage Designs</div><div>jms™ Group</div></div>				
Issuing Office: JMS East Anglia (Ipswich): Unit 27, Brightwell Barns Brightwell, Suffolk, United Kingdom, IP10 0BJ, Tel: 01473 487047				
Project Land rear of 17 Frogna, NW3 6AR				
Drawing Title SuDS Designs Drainage Strategy Layout				
Project No. SD22 04 112		Drawing No. 200		Issue P1
PRELIMINARY				