

LEGEND

EXISTING WALL TO REMAIN.

NEW WALL INFILL.

Disclaimer and Notes

Do not scale this drawing. All dimensions should be checked on site. Any discrepancy found between this drawing, site and any other document should be referred immediately to Fresson and Tee. All drawings should be read in conjunction with all other contract documents and specifications and all other consultants drawings.

Copying or reproduction of this drawing without the written permission of Fresson and Tee is not permitted. Copyright is Reserved

The PDF hard copy accompanying the CAD data is legal transmission of information. The electronic copies are issued only for convenience of use and record of original file. No liability for the accuracy or for any consequence resulting from the use, additions or alteration of information is accepted by Fresson and Tee.

Title plan at 1:1250 and North point is up

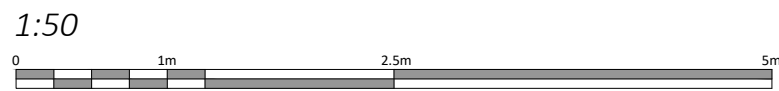
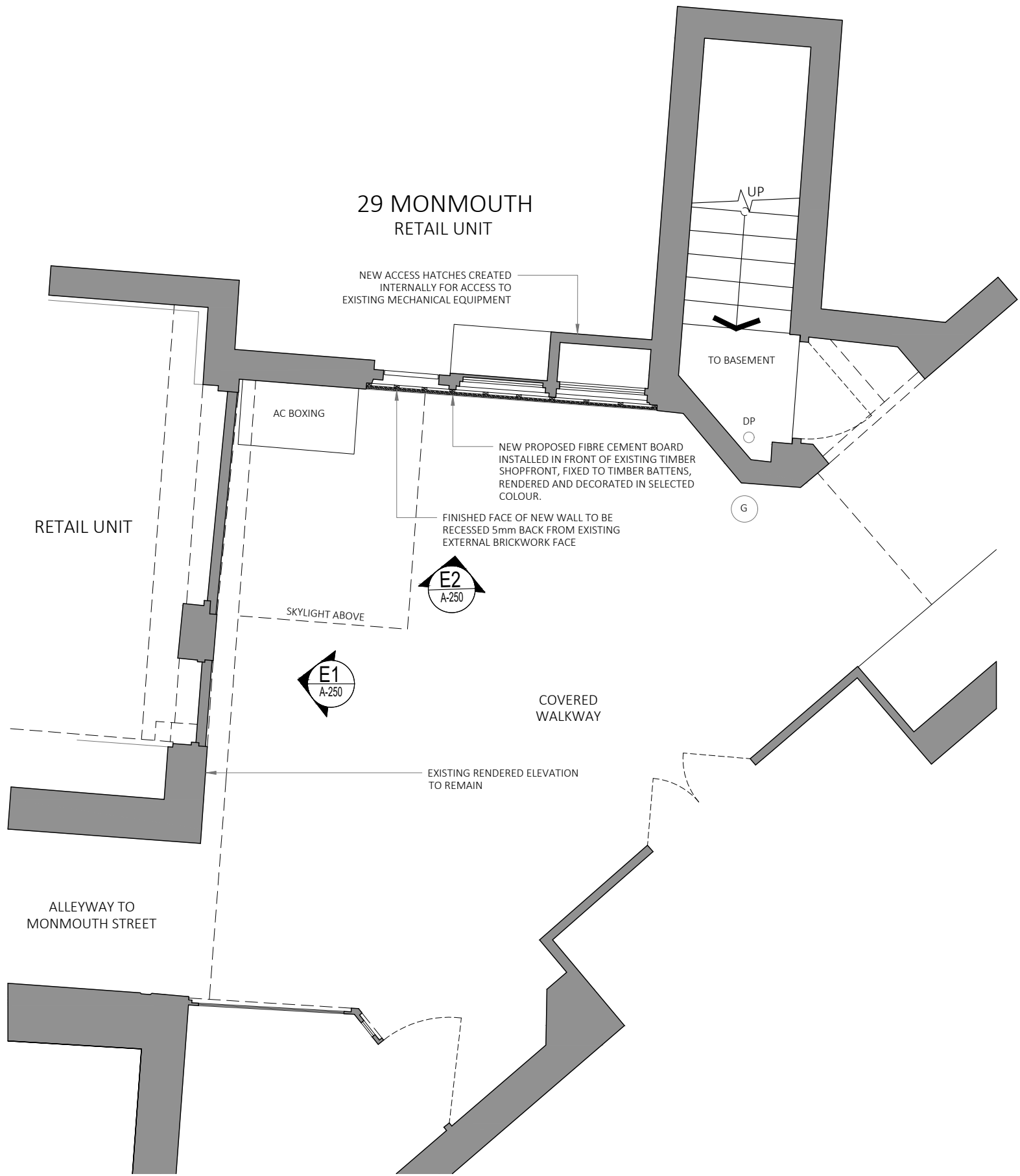
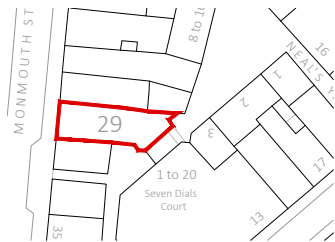

P1	DF	ISSUE FOR PLANNING APPLICATION	27.06.2022
Rev	Iss.	Description	Date
DRAWING TITLE			
Ground floor level - Proposed			
PROJECT NAME			
Shopfront Alterations			
ADDRESS			
29 Monmouth Street			
CLIENT			
Shaftesbury Covent Garden Ltd			
DRAWN BY		CHECKED BY	
DF		-	
JOB NO.			
25478			
SCALE			
1:100@A3			
DATE			
May 22			
DRAWING NO.			
A-200-P1			

