

PLAN  
1:200

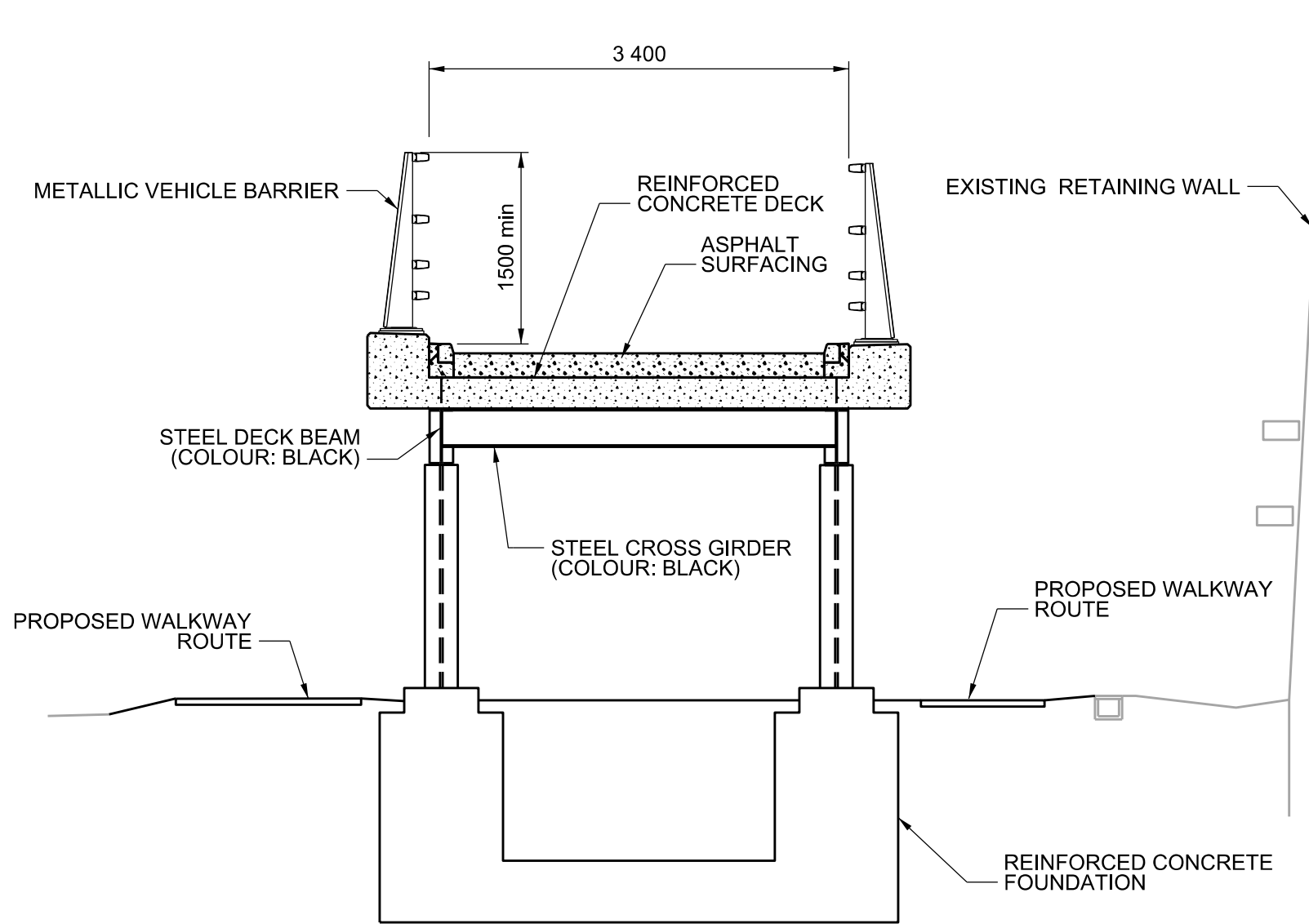

ELEVATION C  
510102 1:50

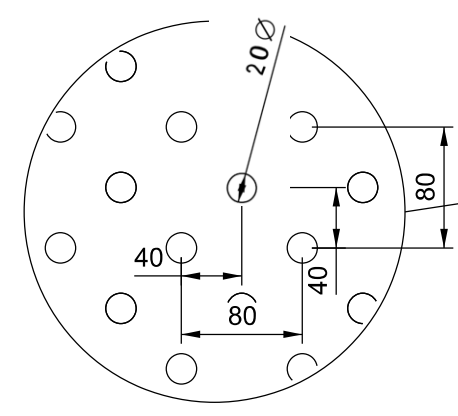

DETAIL 1  
510102 1:5

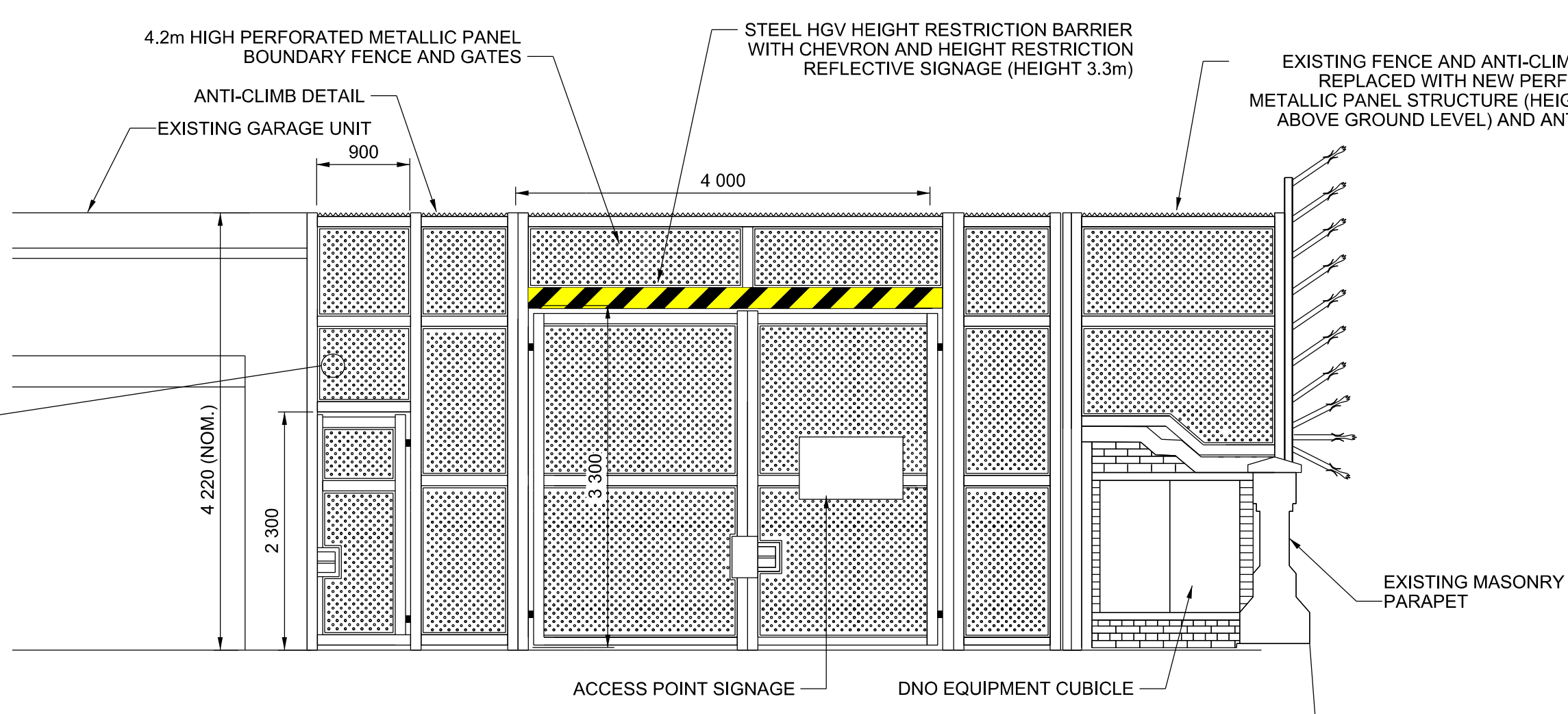

ELEVATION B  
510102 1:50

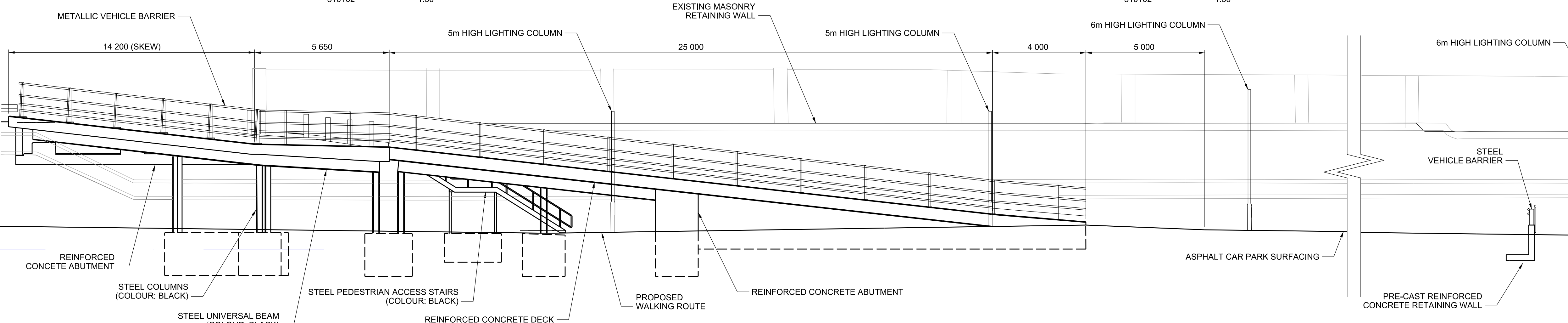

ELEVATION A  
510102 1:100

Legend/Notes

1. ALL DIMENSIONS ARE IN MILLIMETRES UNLESS NOTED OTHERWISE.
2. DO NOT SCALE FROM DRAWING.
3. ALL LEVELS ARE IN METRES AND ARE ABOVE ORDNANCE DATUM.
4. ALL NEW FENCING AND GATES TO BE IN ACCORDANCE WITH SECURITY RATING LPS 1175 SR2 (MIN.)

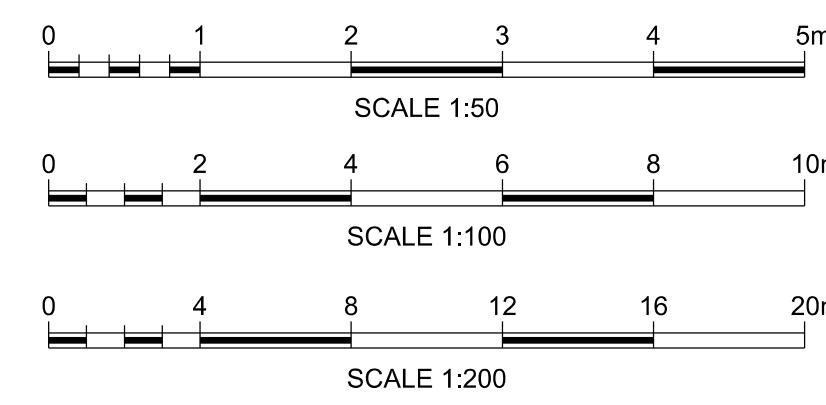

Rev	Date	Description of Revisions	Drawn	Chkd	Appr	Suitability
P02	25/06/21	FOR PLANNING PERMISSION	SA	PN	RH	
P06	24/01/22	FOR PLANNING PERMISSION	SA	PN	RH	
B01	09/03/22	FOR PLANNING PERMISSION	SA	PN	RH	
P07	17/06/22	For Planning Approval	SB	PN	KM	
B02	17/06/22	For Planning Approval	SB	PN	KM	

Status  
**Fit for Internal Review & Comment** S3



Authorised		Signed		Date	
Contractor(s) Atkins Ltd					
Asset Location Location					
Sub-Asset					
Type CAD Drawing			Sub-Type		
Role Civil Engineer			Sub-Role General		
Location Zone LONDON EUSTON - RUGBY TRENT VALLEY JCN					
Phasing		Grip Stage GRIP 5		Withdrawn	
Project HS2 On-Network Works					
Contract No. 158085					
Contract Title Euston Existing Assets Model					
Drawing Title CLARKSON ROW ACCESS POINT PLANNING APPLICATION PROPOSED GENERAL ARRANGEMENT					
Designed W.Dambam		Signed		Date 27/04/21	
Drawn S.Bell		Signed Electronically Signed		Date 17/06/22	
Checked P.Neal		Signed Electronically Signed		Date 17/06/22	
Approved K.McGregor		Signed Electronically Signed		Date 17/06/22	
Scale(s) As Shown		ELR & Mileage LEC1		To 83.0495	
Alternative Reference				From -0.0066	
Drawing Reference HS2_158085-16610-LEC1-ZN18-DDR-C-510102				Sheet 1 of 1	
				Revision B02	