

# **Panther House** Planning Conditions

## **Condition 11: Waste Storage**

*Prior to the commencement of the above ground superstructure works details of the location, design and method of waste storage and removal including recycled materials, shall be submitted to and approved by the local planning authority in writing. The facility as approved shall be provided prior to the first occupation of any of the new units and permanently retained thereafter.*

# Panther House Planning Conditions

## Condition 11: Waste Storage

The waste store for Panther House will be located in the north east corner of the building with convenient access for collection from Mount Pleasant. Observations of the Council refuse vehicle collecting Eurobins from other addresses along Mount Pleasant suggests a dwell time in the order of 2-3 minutes for 4-6 Eurobins.

At Panther House collection will be arranged on a daily basis in order to reduce the number of bins to be collected at any one time, the expectation is that 2-3 bins will be collected per visit and hence the dwell time of the vehicle will be sufficiently low not to cause unacceptable delay to any other vehicles using Mount Pleasant.

Along the Gray's Inn Road frontage waste will be collected in accordance with the existing arrangements for residential and commercial premises and hence the number of vehicle movements is not expected to noticeably change as a result of development. The waste will be stored on site in separate storage areas for the residential, office and A1/A3 uses.

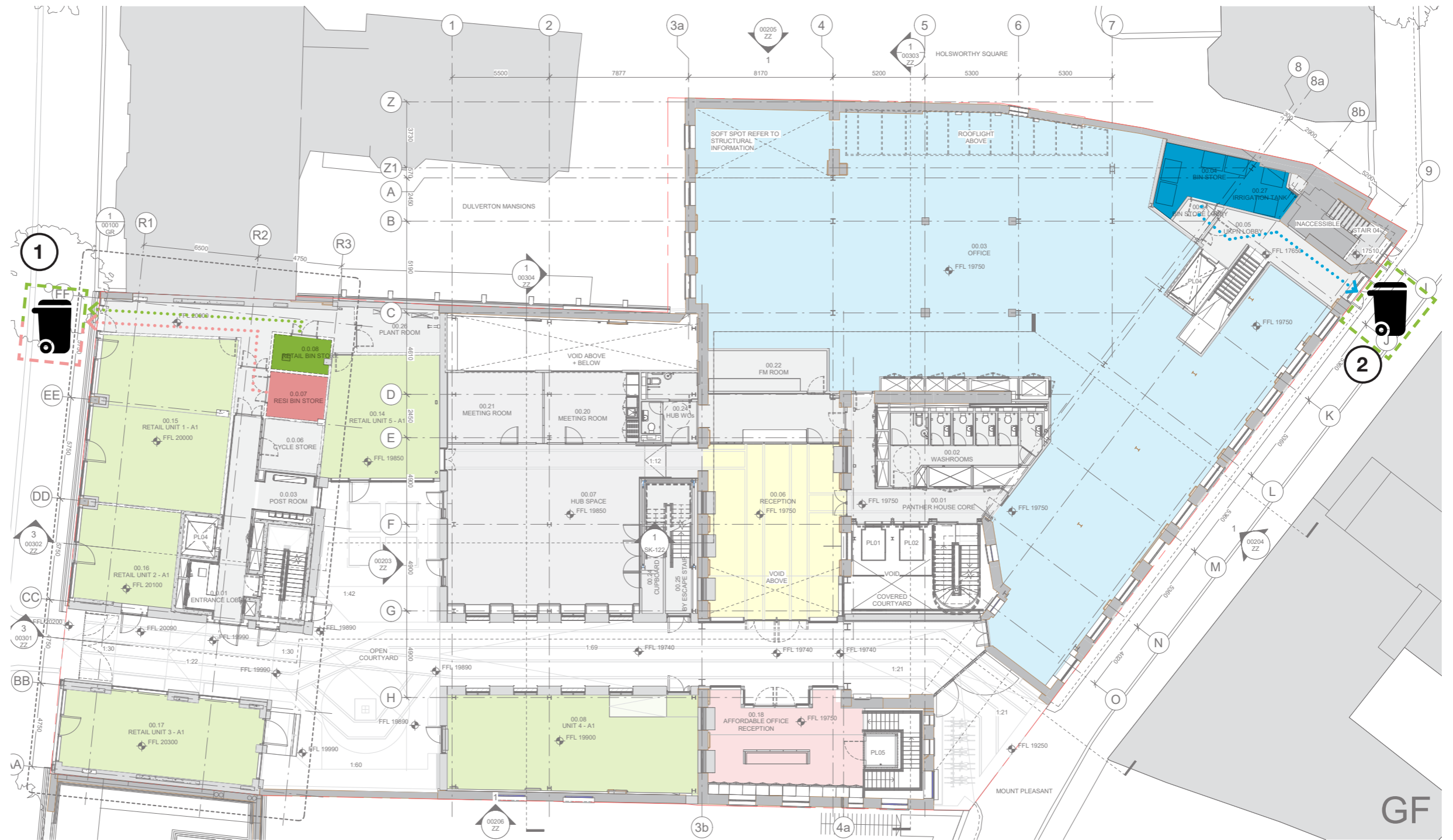

Ground Floor Plan

### Key

- Retail bin store
- Residential bin store
- Commercial bin store (x eurobins recycling)
- Retail route to street
- Residential route to street
- Commercial waste route

- 1 Presentataion area (retail daily collection)
- 2 Collection from Mount Pleasant

# Panther House Planning Conditions

## Condition 11: Waste Storage



Retail and Residential Refuse Store at Gray's Inn Road

**1** Retail Refuse Store

**Capacity:**

- 1No. 660L (Recycling) [848L]\*
- 1No. 360L (Recycling)
- 1No. 360L (General Waste) [363L]\*

**2** Residential Refuse Store

**Capacity:**

- 1No. 1280L Eurobins (Recycling) [2,100L]\*\*
- 1No. 1280L Eurobins (Recycling)
- 1No. 1280L Eurobins (General Waste) [1,800L]\*\*
- 1No. 660L Eurobins (General Waste)
- 1No. 360L (Food Waste) [345L]\*\*

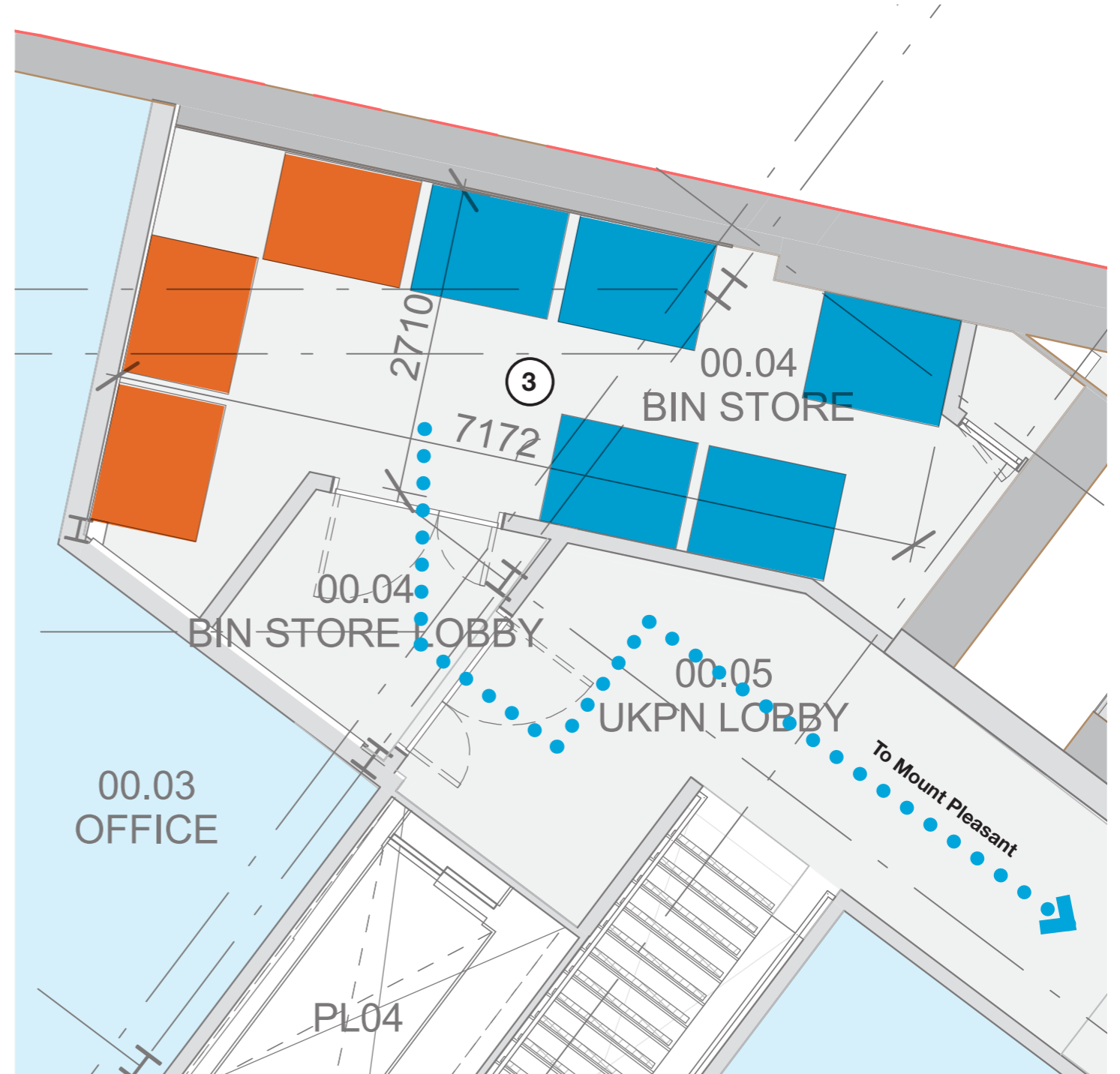

Commercial Refuse Store at Panther House

**3** Office Refuse Store

**Capacity:**

- 5No. 1280L Eurobins (Recycling) [11,279L]\*
- 3No. 1280L Eurobins (General) [11,279L]\*

**Collection:**

Three times weekly collection of 2-3 bins to reduce vehicle dwell time on street

**Capacity Calculations**

\* [xxxxxL] based on Westminster SPG at 70% recycling and 30% General Waste

\*\* [xxxxxL] based on Camden ES Technical Waste Planning Guidance 2018