

W 07

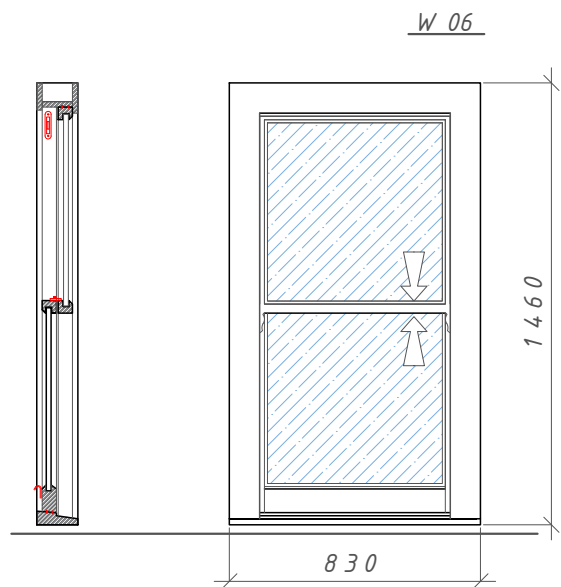

W 06

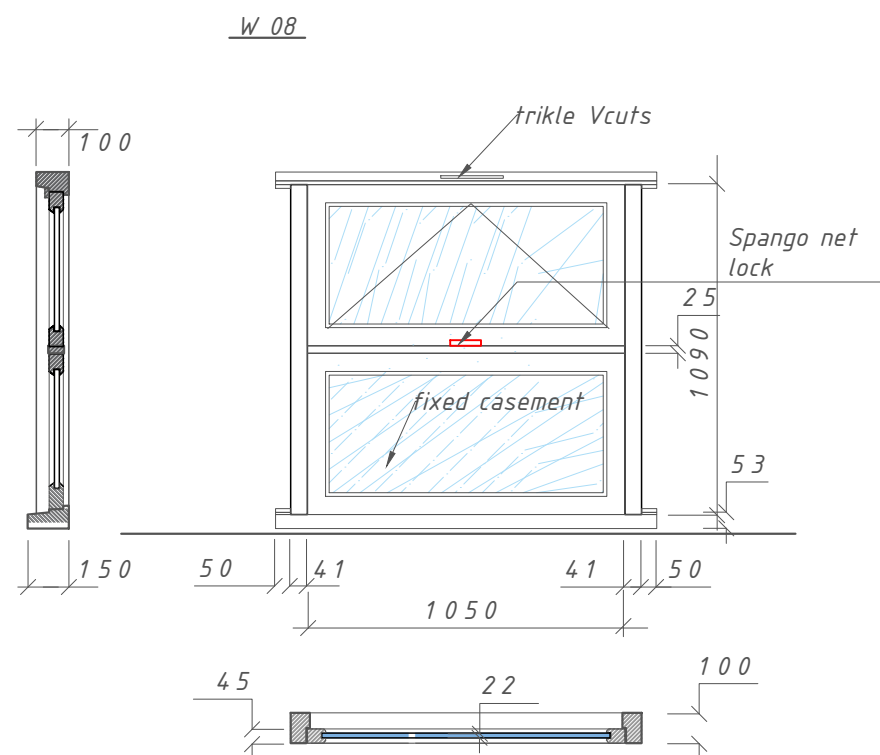
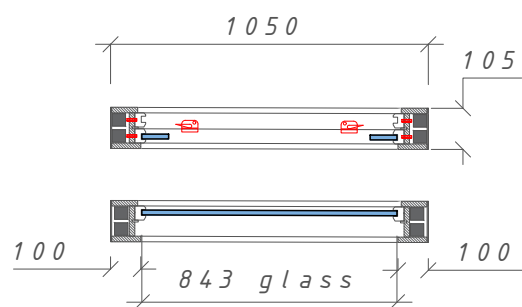
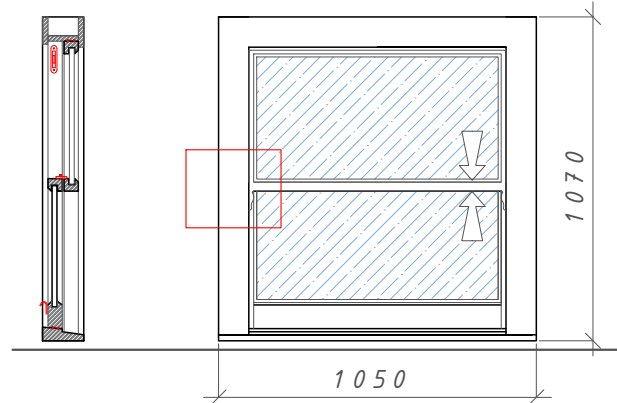
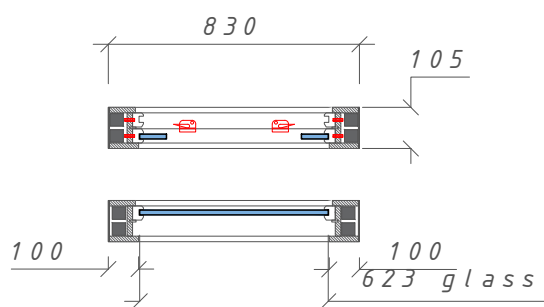

W 08

notes
 1. This drawing has been prepared to cover matters which are the requirements of the company listed below and do not constitute a full specification of the work.
 2. all dimensions, details, components and assemblies are to be verified by the contractor PRIOR to construction manufacture or supply.
 3. Any conflicting information errors or commissions shown or implied on this drawing shall be referred to the Contractor PRIOR to construction or ordering of materials.
 4. Do not scale this drawing.
 5. this drawing is the copy right of GRCarpentry LTD and may not be copied in part or whole without written permission.

revisions
 First issue for approval

Specifications material
 *cills from sapple
 *frame from joinery grade red wood
 *sashes from joinery grade redwood

HARDWARE
 *45mm steel weight
 *No 2 sash lifts
 *securifited right hand sash locks & 11mm keep in
 *mighton palleys with pylon wheel in
 *aquamac 3 white weatherseals
 *white brush seals
 *timber parting beads with integral white brush strip
 *white slidex

FINISH
 *fully paint finished in sikkens rubbol WF 382 RAL 9016
 NOTES
 *client to confirm design prior to manufacture

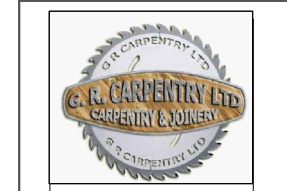

client
 BARBARELLA STUDIO
 project
 FLAT3 7 EATON AVE NW3
 title
 NEW EXTERNAL WINDOWS
 TYPICAL SECTIONDETAILS

issue
 CLIENT APPROVAL

Job No	GRC 01
Drawing	No 001
Cut list	No 02
Scale	
drawing by	GRC
CHEKED BY	

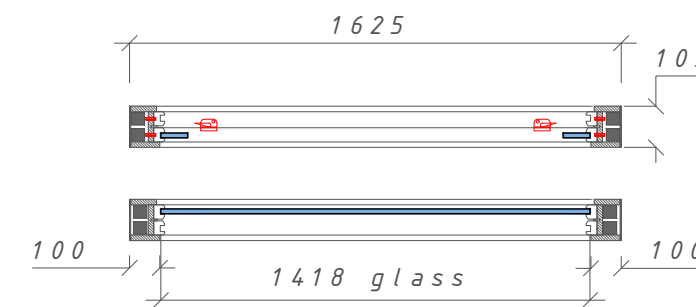
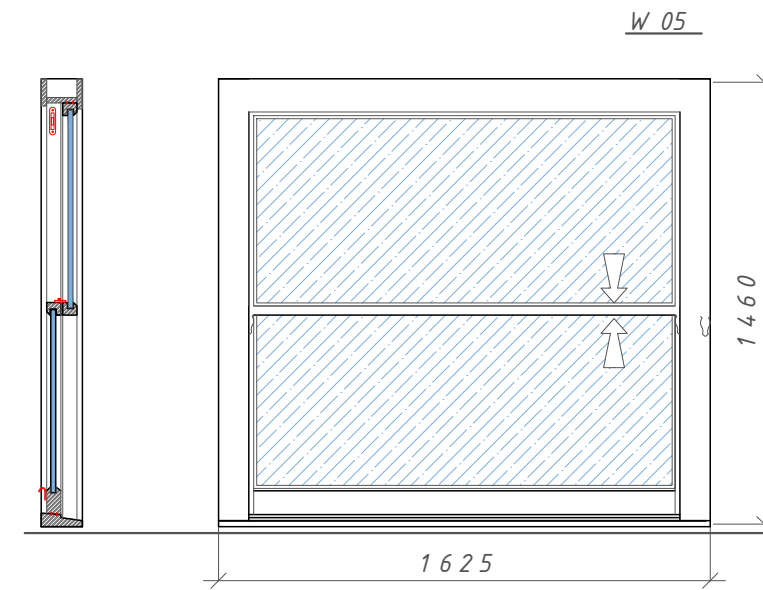
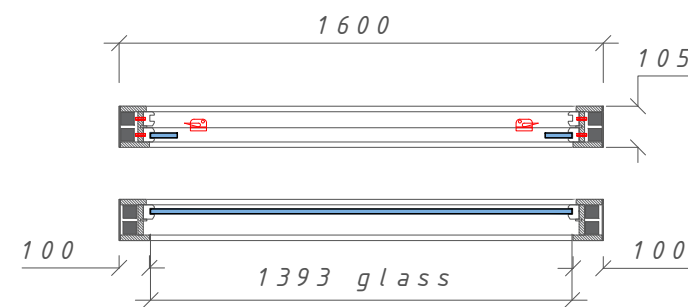
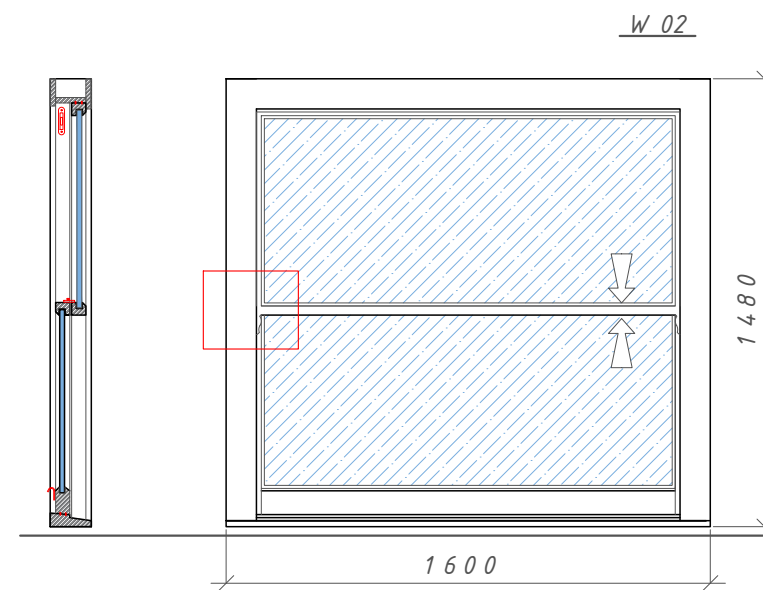
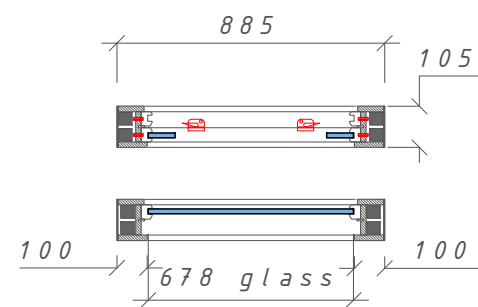
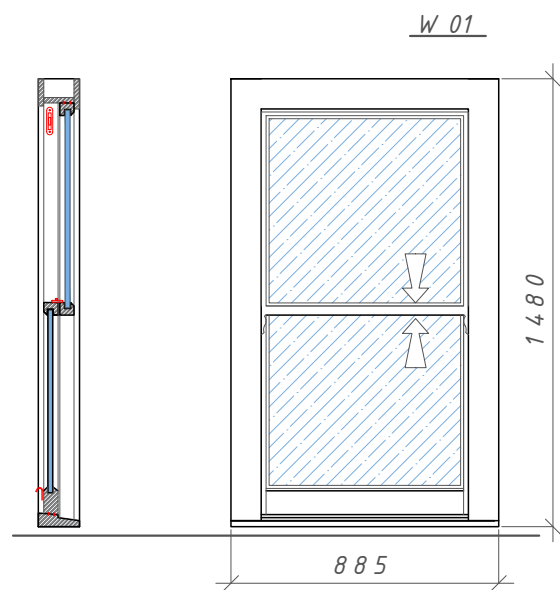
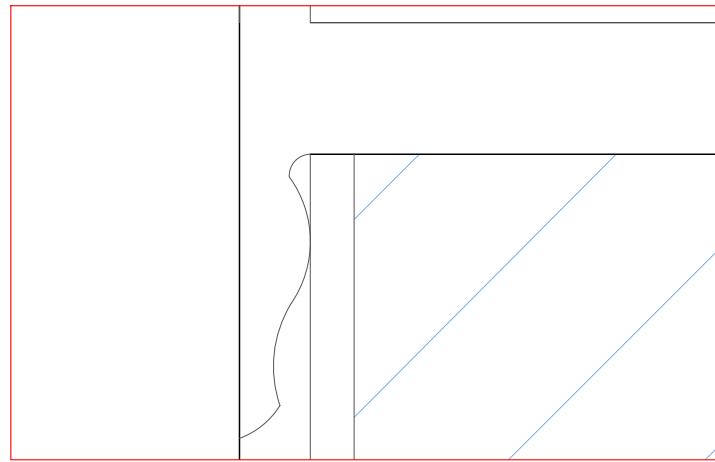

- notes
1. This drawing has been prepared to cover matters which are the requirements of the company listed below and do not constitute a full specification of the work.
 2. all dimensions, details, components and assemblies are to be verified by the contractor PRIOR to construction manufacture or supply.
 3. Any conflicting information errors or commissions shown or implied on this drawing shall be referred to the Contractor PRIOR to construction or ordering of materials.
 4. Do not scale this drawing.
 5. this drawing is the copy right of GRCarpentry LTD and may not be copied in part or whole without written permission.

revisions

First issue for approval

- Specifications material
- *cills from sapple
 - *frame from joinery grade red wood
 - *sashes from joinery grade redwood

- HARDWARE
- *45mm steel weight
 - *No 2 sash lifts
 - *securifited right hand sash locks & 11mm keep in
 - *mighton palleyes with pylon wheel in
 - *aquamac 3 white weatherseals
 - *white brush seals
 - *timber parting beads with integral white brush strip
 - *white slidex
- FINISH
- *fully paint finished in sikkens rubbol WF 382 RAL 9016
- NOTES
- *client to confirm design prior to manufacture

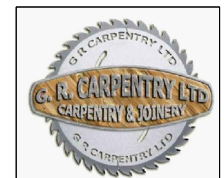

client	BARBARELLA STUDIO
project	FLATS 7 EATON AVE NW3
title	NEW EXTERNAL WINDOWS TYPICAL SECTIONDETAILS
issue	CLIENT APPROVAL
Job No	GRC 01
Drawing	No 004
Cut list	No 02
Scale	
drawing by	GRC
CHEKED BY	

notes
 1. This drawings has been prepared to cover matters which are the requirements of the company listed below and do not constitute a full specification of the work.
 2. all dimensions, details, components and assemblies are to be verified by the contractor PRIOR to construction manufacture or supply.
 3. Any conflicting information errors or commissions shown or implied on this drawing shall be referred to the Contractor PRIOR to construction manufacture or supply.
 4. Do not scale this drawing.
 5. this drawing is the copy right of GRCarpentry LTD and may not be copied in part or whole without written permission.

revisions
 16/04/2018
 First issue for approval
 A. 27/04/2018

Specifications
 material
 *cills from sapple
 *frame from joinery grade red - wood
 *sashes from joinery grade redwood
 GLASS
 *toughened units
 *argon gas filled
 *soft coat lower
 *silver spacers
 *externaly bead glazed
 HARDWARE
 *45mm steel weight
 *No 2 sash lifts
 *securifited right hand sash locks & 11mm keep in
 *mighton palleyes with pylon wheel in
 *aquamac 3 white weatherseals
 *white brush seals
 *timber parting beads with integral white brush strip
 *white slidex
 FINISH
 *fully paint finished in sikkens rubbol WF 382 RAL 9016
 NOTES
 *client to confirm design prior to manufacture

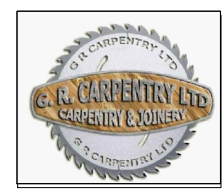

client
 BARBARELLA STUDIO
 project
 FLAT3 7 EATON AVE NW3
 title
 NEW EXTERNAL WINDOWS
 TYPICAL SECTIONDETAILS

issue
 CLIENT APPROVAL

Job No	GRC 01
Drawing	No3cm 001
Cut list	No 03
Scale	
drawing by	GRC
CHEKED BY	

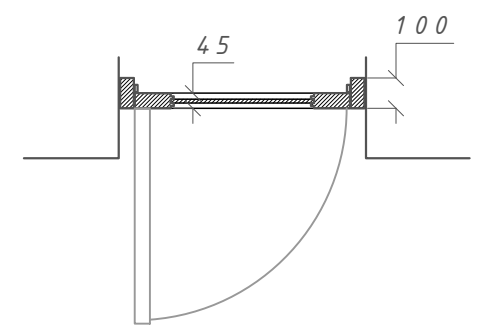
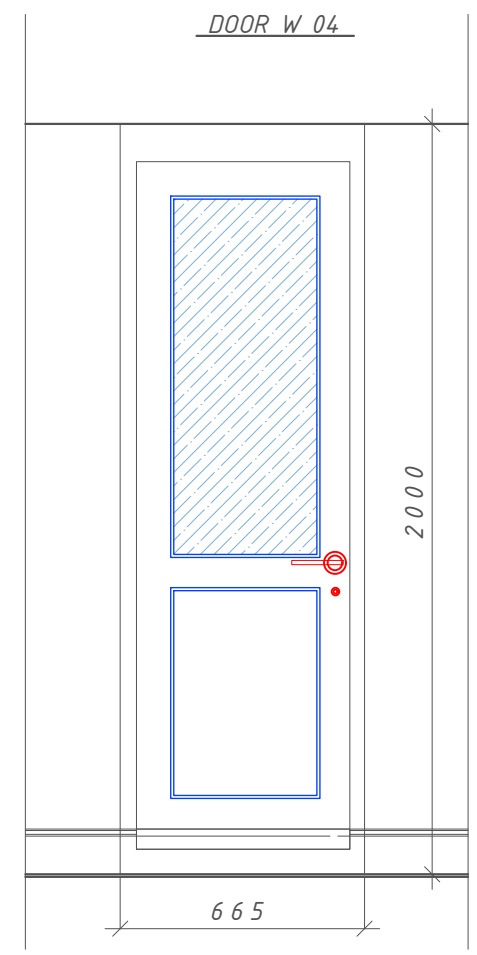
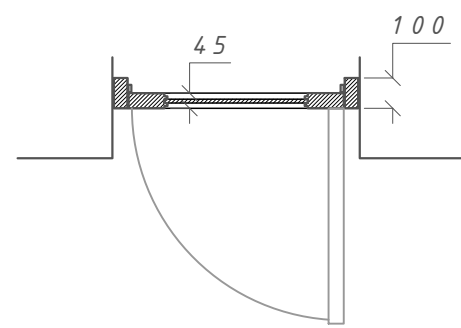
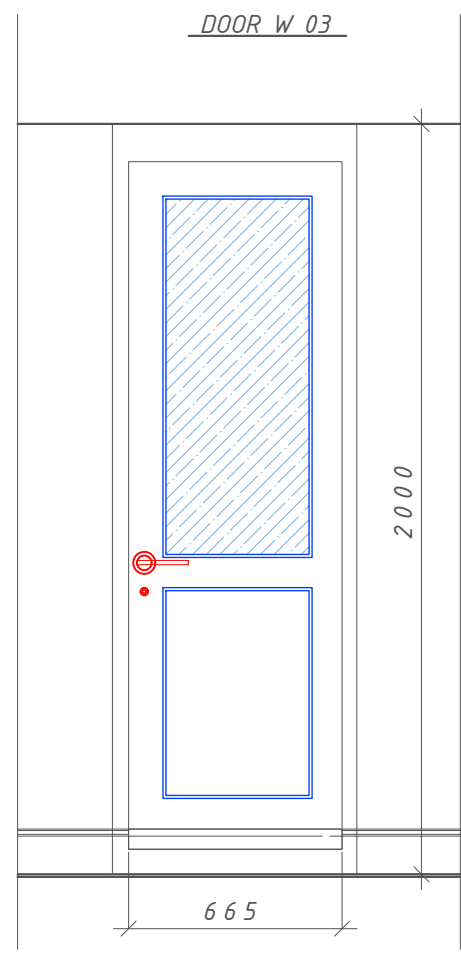
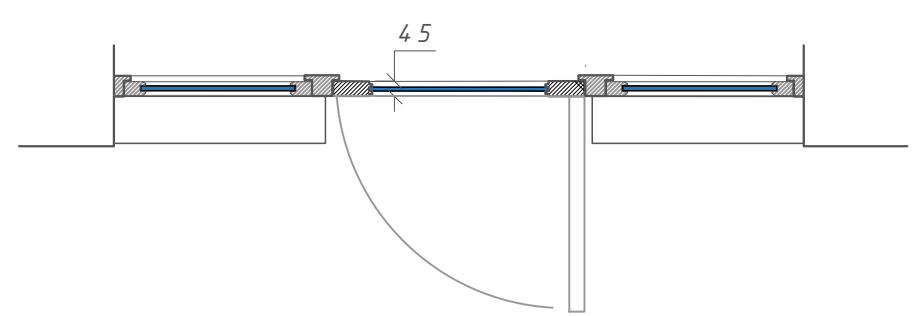
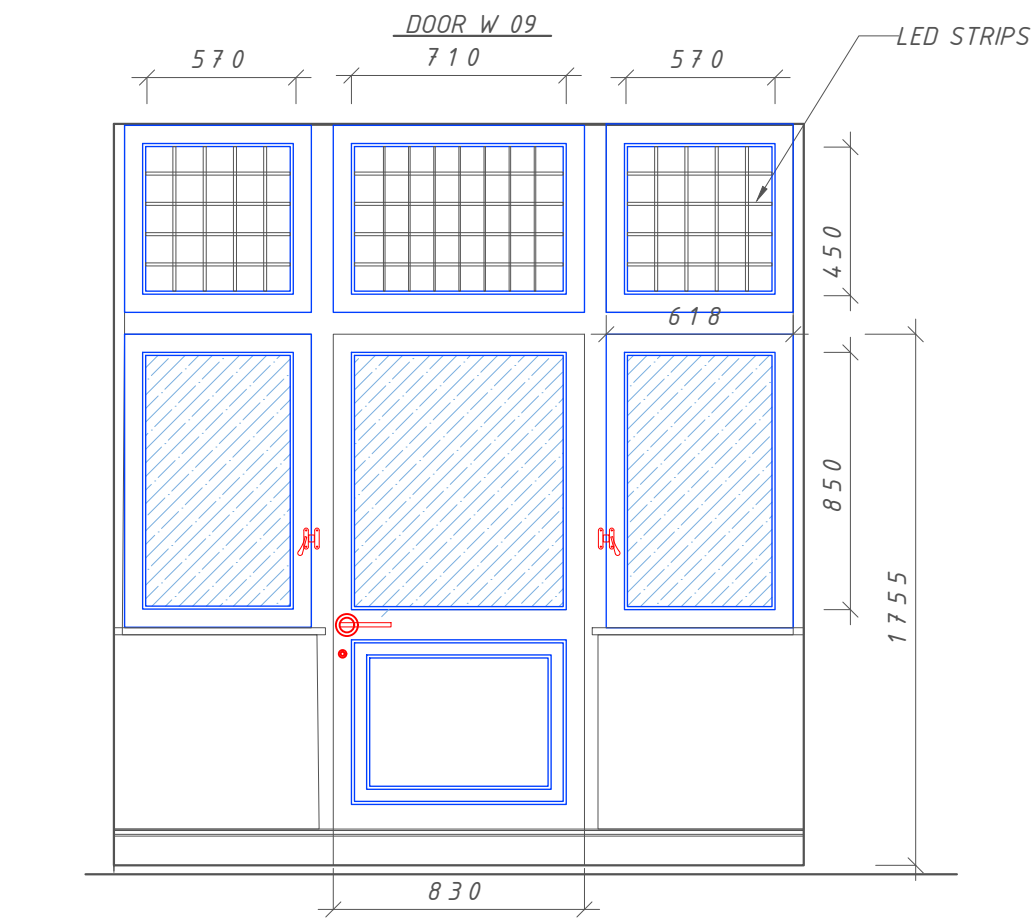

REAR ELEVATION VIEW FROM INSIDE (ROOM VIEW)

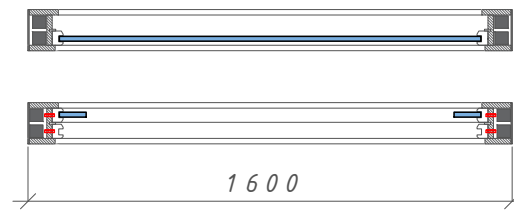

PLAN

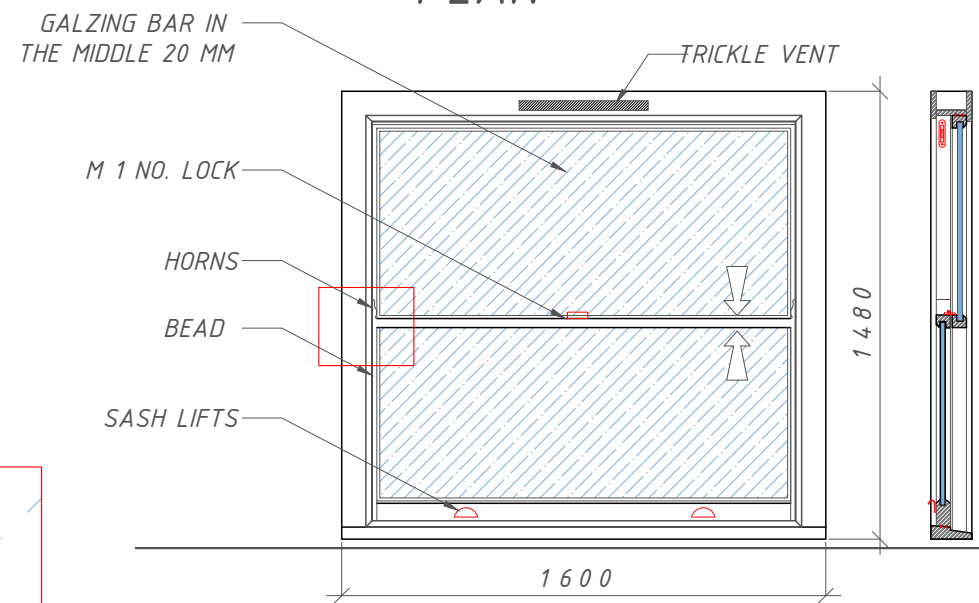

INTERNAL ELEVATION SIDE

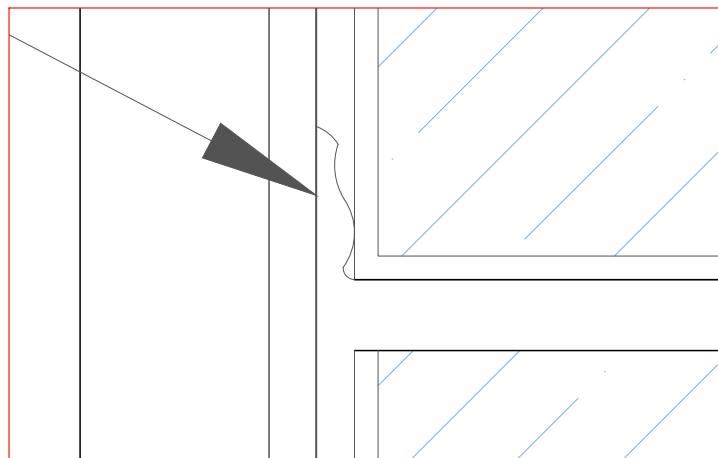

notes

1. This drawing has been prepared to cover matters which are the requirements of the company listed below and do not constitute a full specification of the work.
2. all dimensions, details, components and assemblies are to be verified by the contractor PRIOR to construction manufacture or supply.
3. Any conflicting information errors or commissions shown or implied on this drawing shall be referred to the Contractor PRIOR to construction or ordering of materials.
4. Do not scale this drawing.
5. this drawing is the copy right of GRCarpentry LTD and may not be copied in part or whole without written permission.

revisions

25. 05. 22
First issue for approval

Specifications

material

- *cills from sapple
- *frame from joinery grade red - wood
- *sashes from joinery grade redwood

HARDWARE

- *45mm steel weight
- *No 2 sash lifts
- *securifited right hand sash locks & 11mm keep in
- *mighton palleys with pylon wheel in
- *aquamac 3 white weatherseals
- *white brush seals
- *timber parting beads with integral white brush strip
- *white slidex

FINISH

- *fully paint finished in sikkens rubbol WF 382 RAL 9016

NOTES

- *client to confirm design prior to manufacture

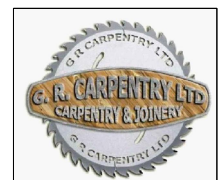

client
BARBARELLA STUDIO

project
FLAT3 7 EATON AVE NW3

title NEW EXTERNAL WINDOWS
TYPICAL SECTIONDETAILS

issue
CLIENT APPROVAL

<i>Job No</i>	JCS2235
<i>Drawing</i>	No 05

<i>Cut list</i>	
<i>Scale</i>	

<i>drawing by</i>	GRC
<i>CHEKED BY</i>	

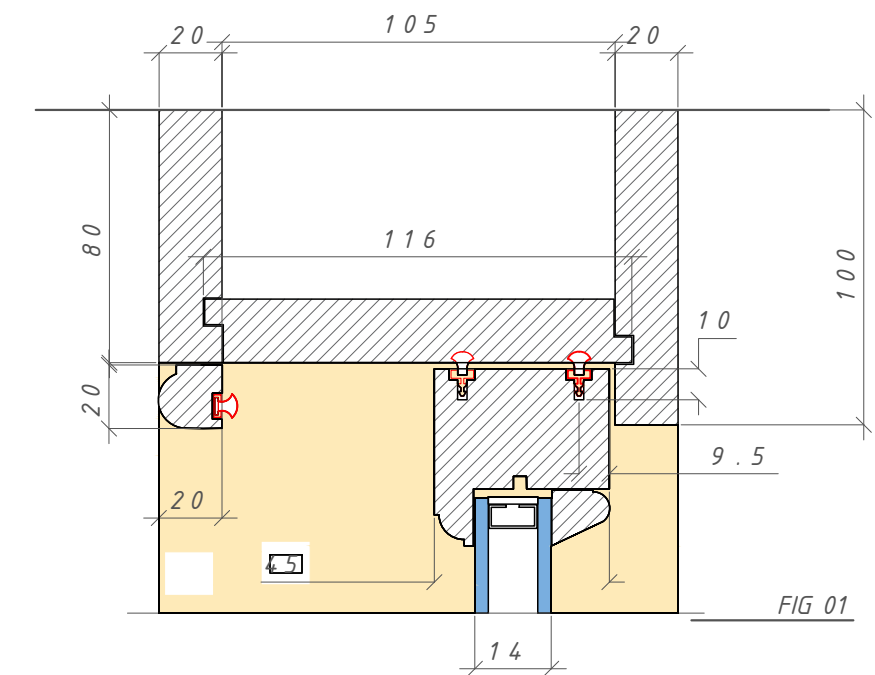

FIG 01

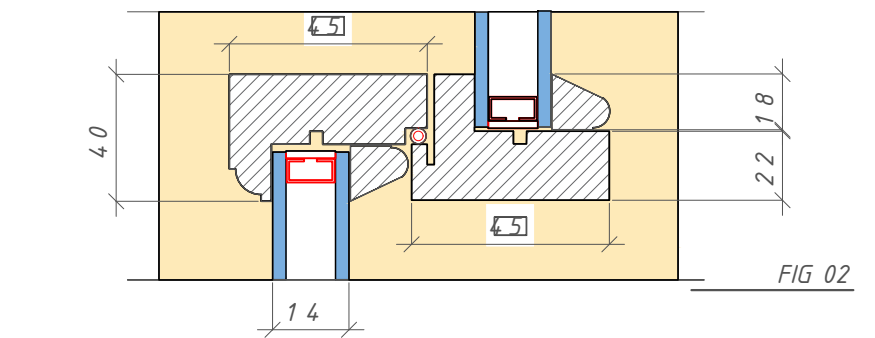

FIG 02

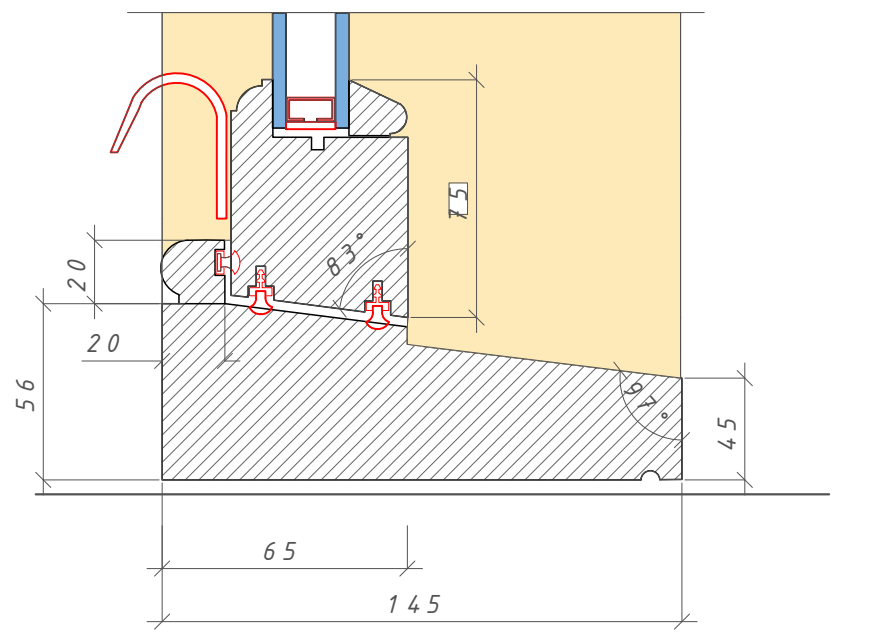

FIG 03

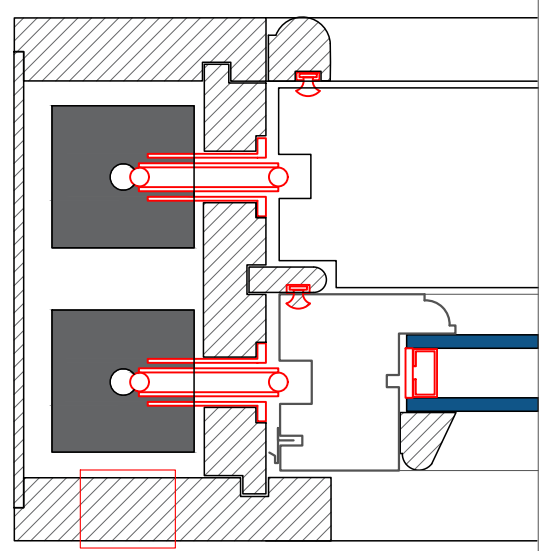

FIG 04

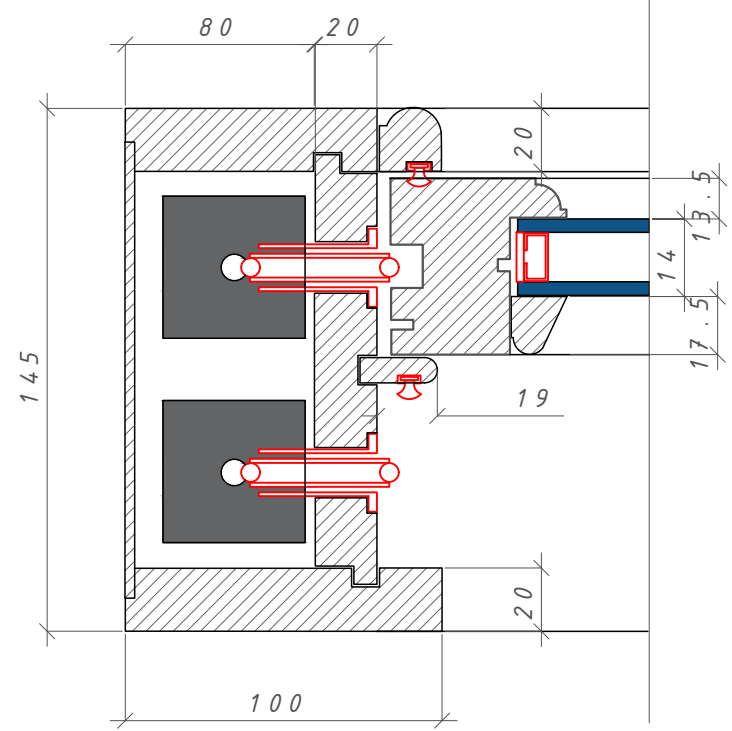

FIG 05

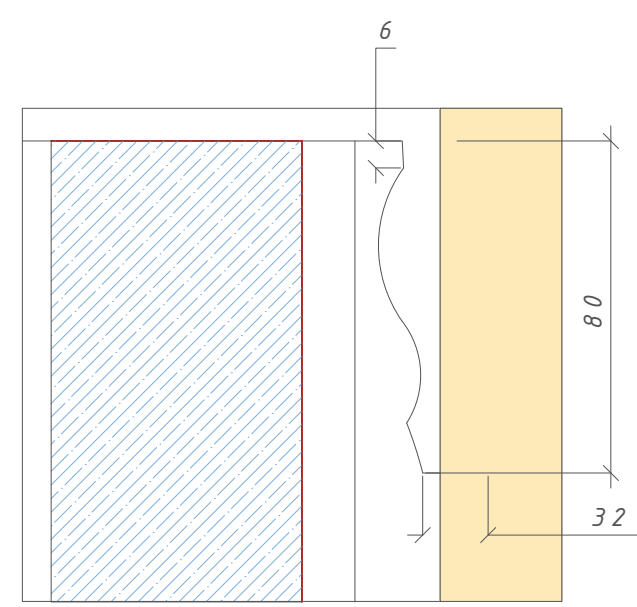
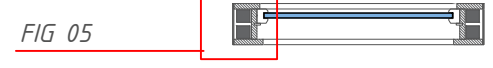
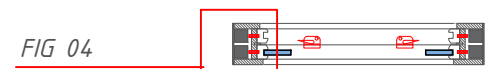
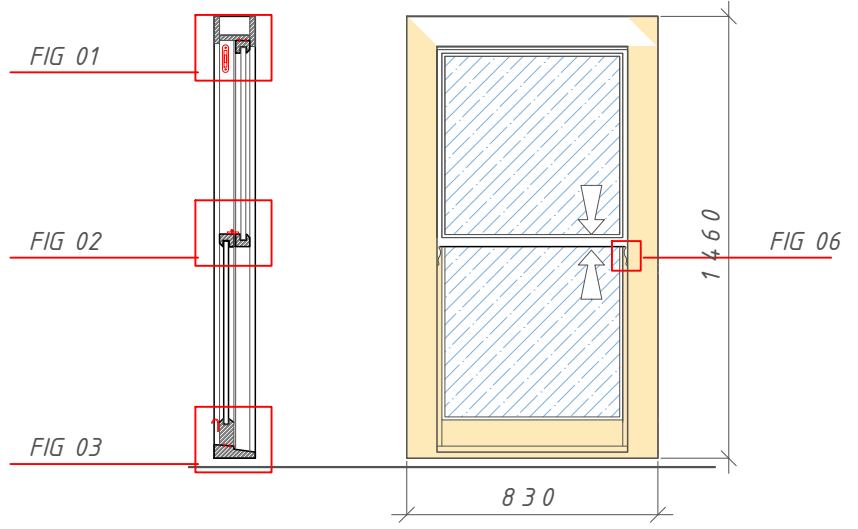

FIG 06

notes
 1. This drawings has been prepared to cover matters which are the requirements of the company listed below and do not constitute a full specification of the work.
 2. all dimensions, details, components and assemblies are to be verified by the contractor PRIOR to construction manufacture or supply.
 3. Any conflicting information errors or commissions shown or implied on this drawing shall be referred to the Contractor PRIOR to construction or ordering of materials.
 4. Do not scale this drawing.
 5. this drawing is the copy right of GRCarpentry LTD and may not be copied in part or whole without written permission.

revisions
 First issue for approval

Specifications
 material
 *cills from sapple
 *frame from joinery grade red wood
 *sashes from joinery grade redwood
 GLASS
 *toughened units
 *argon gas filled
 *soft coat lower
 *silver spacers
 *externaly bead glazed
 HARDWARE
 *45mm steel weight
 *No 2 sash lifts
 *securifited right hand sash locks & 11mm keep in
 *mighton palleys with pylon wheel in
 *aquamac 3 white weatherseals
 *white brush seals
 *timber parting beads with integral white brush strip
 *white slidex
 FINISH
 *fully paint finished in sikkens rubbol WF 382 RAL 9016
 NOTES
 *client to confirm design prior to manufacture



client	BARBARELLA STUDIO
project	FLAT 3 7 EATON AVE NW3
title	NEW EXTERNAL WINDOWS TYPICAL SECTIONDETAILS
issue	CLIENT APPROVAL
Job No	GRS 01
Drawing	No 001
Cut list	No 01
Scale	
drawing by	GRC
CHEKED BY	