

REV	DESCRIPTION
MATERIAL KEY LIST	
FINISHINGS	
A	MILL FINISH
B	BLACK ANODISED
C	PREPAINTED PPC RAL 9005 MATT - BLACK
D	PREPAINTED LIQUID PAINT RAL 5008 NO METALLIC
E	PPC COBALT BLUE METALLIC CL. 2 [TIGER 068/40444]
F	PPC ANTRACITE GREY METALLIC CL. 2 [TIGER 068/71426]
G	PPC LIGHT GREY METALLIC CL. 2 [TIGER 068/90348]
H	PPC RAL 5008 NO METALLIC CL. 1 [TIGER 029/40830]
I	PPC RAL 5008 NO METALLIC CL. 2 [TIGER 068/40012]
L	PPC RAL 8029 METALLIC CL.2 [TIGER 068/61180]
ALUMINIUM COMPONENTS	
01	ALUMINIUM BRACKET
02	EXTRUDED ALUMINIUM PROFILE
03	ALUMINIUM SHEET
GALVANIZED STEEL COMPONENTS	
11	GALVANIZED STEEL PROFILE - BS EN ISO 1461
12	GALVANIZED STEEL SHEET
13	HOT DIPPED GALVANIZED CAST IN CHANNEL
14	HOT DIPPED GALVANIZED STEEL BRACKET
15	HOT DIPPED GALVANIZED STEEL REINFORCEMENT
16	SANDBLASTED STEEL LIQUID PAINTED ANTRACITE GREY METALLIC MATT
STAINLESS STEEL COMPONENTS	
21	STAINLESS STEEL PROFILE AISI 304
22	STAINLESS STEEL SHEET AISI 316
23	STAINLESS STEEL BRACKET/STRUCTURE AISI 304
EPDM / SILICONE COMPONENTS	
31	BLACK EPDM GASKET
32	BLACK SILICONE GASKET
33	BLACK STRUCTURAL SILICONE
34	BLACK SILICONE WATERPROOF
35	PRIMARY DGU SEAL BLACK STRUCTURAL SILICONE
36	VULCANIZED EPDM GASKET BLACK
37	VULCANIZED EPDM GASKET COMPATIBLE WITH SILICONE BLACK
FIXINGS	
41	GALVANISED STEEL FIXING
42	STAINLESS STEEL FIXING A2
43	STAINLESS STEEL FIXING A4
GLASS TYPES	
50	GLASS PANE AS PER GLASS SCHEDULE
VARIOUS MATERIAL	
61	MINERAL WOOL 60 KG/M3
62	INSECT MESH
63	PLASTIC SHIM
64	FIRE STOP BARRIER
65	GLAZED TERRACOTTA TILE COLOUR COBALT BLUE
66	MEMBRANE EPDM
67	ALUMINIUM FILM
68	BACKING ROD
69	SANDWICH INSULATED PANEL
99	BY OTHERS

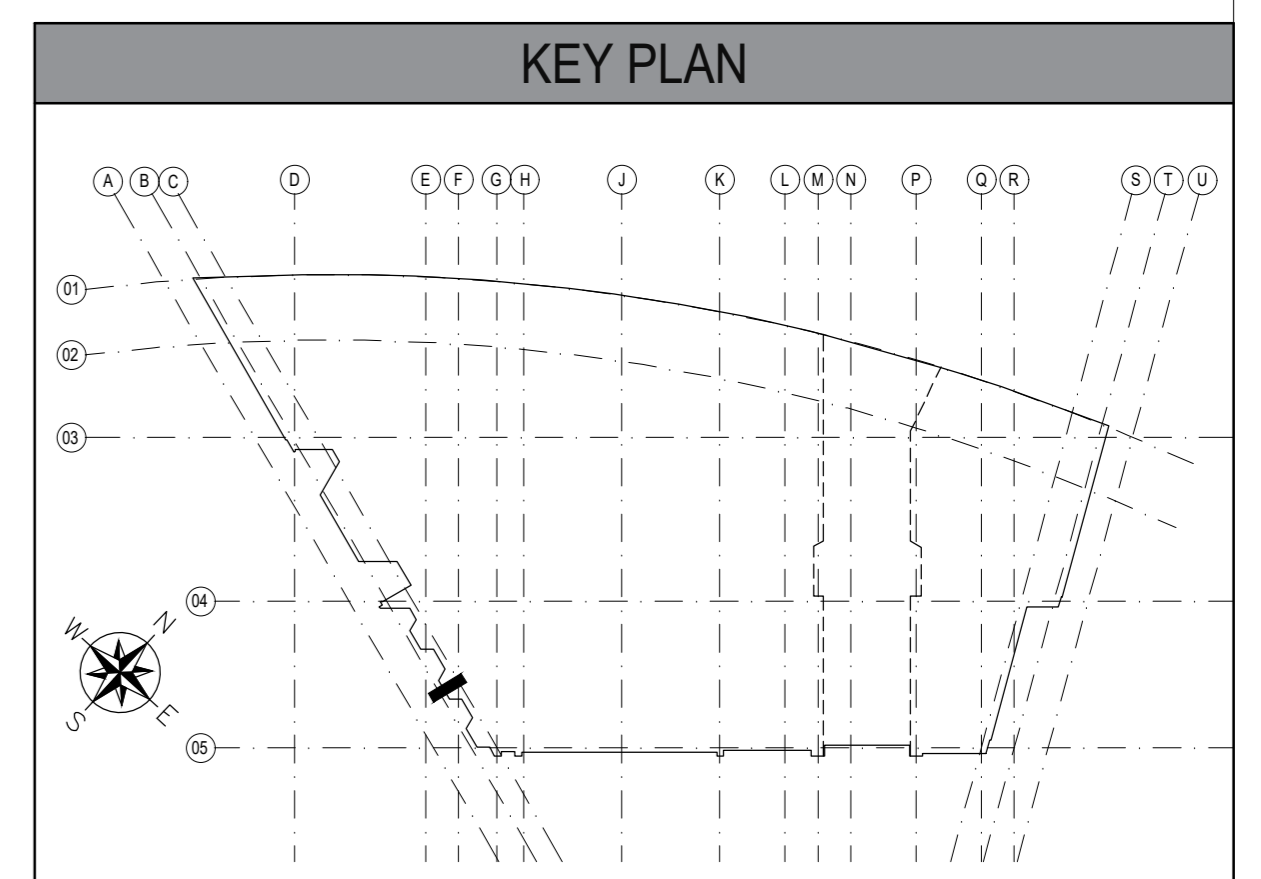

Project : KING'S CROSS CENTRAL S3
 London
 Architect : *
 Client : BAM
 Package : Curtain wall

Issue : 02
 Job : CONSTRUCTION PROPOSAL S3
 Scale : 1:2@A3
 Dwg: KXC-S3-001-Y-FCI+21-6603GF

Description : SEE CLOUDS
 Checked by : A.V.
 Drafter : A.V.
 Date : 19-10-2020
 Rev : 00
 Rev : 01
 Rev : 02
 Date : 21-12-2020
 Date : 08/03/2022

General Revision : A. Casadei
 F. Bartolini
 F. Bartolini