

01
6204

| REV | DESCRIPTION |
|-----|-------------|
| 01 | 01 |
| 02 | 02 |
| 03 | 03 |
| 11 | 11 |
| 12 | 12 |
| 13 | 13 |
| 14 | 14 |
| 15 | 15 |
| 16 | 16 |
| 21 | 21 |
| 22 | 22 |
| 23 | 23 |
| 31 | 31 |
| 32 | 32 |
| 33 | 33 |
| 34 | 34 |
| 35 | 35 |
| 36 | 36 |
| 37 | 37 |
| 41 | 41 |
| 42 | 42 |
| 43 | 43 |
| 50 | 50 |
| 61 | 61 |
| 62 | 62 |
| 63 | 63 |
| 64 | 64 |
| 65 | 65 |
| 66 | 66 |
| 67 | 67 |
| 68 | 68 |
| 69 | 69 |
| 99 | 99 |

| MATERIAL KEY LIST | |
|-----------------------------|---|
| FINISHINGS | |
| A | MILL FINISH |
| B | BLACK ANODISED |
| C | PREPAINTED PPC RAL 9005 MATT - BLACK |
| D | PREPAINTED LIQUID PAINT RAL 5008 NO METALLIC |
| E | PPC COBALT BLUE METALLIC CL. 2 [TIGER 068/40444] |
| F | PPC ANTRACITE GREY METALLIC CL. 2 [TIGER 068/71426] |
| G | PPC LIGHT GREY METALLIC CL. 2 [TIGER 068/90348] |
| H | PPC RAL 5008 NO METALLIC CL. 1 [TIGER 029/40830] |
| I | PPC RAL 5008 NO METALLIC CL. 2 [TIGER 068/40012] |
| L | PPC RAL 8029 METALLIC CL.2 [TIGER 068/61180] |
| ALUMINIUM COMPONENTS | |
| 01 | ALUMINIUM BRACKET |
| 02 | EXTRUDED ALUMINIUM PROFILE |
| 03 | ALUMINIUM SHEET |
| GALVANIZED STEEL COMPONENTS | |
| 11 | GALVANIZED STEEL PROFILE - BS EN ISO 1461 |
| 12 | GALVANIZED STEEL SHEET |
| 13 | HOT DIPPED GALVANIZED CAST IN CHANNEL |
| 14 | HOT DIPPED GALVANIZED STEEL BRACKET |
| 15 | HOT DIPPED GALVANIZED STEEL REINFORCEMENT |
| 16 | SANDBLASTED STEEL LIQUID PAINTED ANTRACITE GREY METALLIC MATT |
| STAINLESS STEEL COMPONENTS | |
| 21 | STAINLESS STEEL PROFILE AISI 304 |
| 22 | STAINLESS STEEL SHEET AISI 316 |
| 23 | STAINLESS STEEL BRACKET/STRUCTURE AISI 304 |
| EPDM / SILICONE COMPONENTS | |
| 31 | BLACK EPDM GASKET |
| 32 | BLACK SILICONE GASKET |
| 33 | BLACK STRUCTURAL SILICONE |
| 34 | BLACK SILICONE WATERPROOF |
| 35 | PRIMARY DGU SEAL BLACK STRUCTURAL SILICONE |
| 36 | VULCANIZED EPDM GASKET BLACK |
| 37 | VULCANIZED EPDM GASKET COMPATIBLE WITH SILICONE BLACK |
| FIXINGS | |
| 41 | GALVANISED STEEL FIXING |
| 42 | STAINLESS STEEL FIXING A2 |
| 43 | STAINLESS STEEL FIXING A4 |
| GLASS TYPES | |
| 50 | GLASS PANE AS PER GLASS SCHEDULE |
| VARIOUS MATERIAL | |
| 61 | MINERAL WOOL 60 KG/M3 |
| 62 | INSECT MESH |
| 63 | PLASTIC SHIM |
| 64 | FIRE STOP BARRIER |
| 65 | GLAZED TERRACOTTA TILE COLOUR COBALT BLUE |
| 66 | MEMBRANE EPDM |
| 67 | ALUMINIUM FILM |
| 68 | BACKING ROD |
| 69 | SANDWICH INSULATED PANEL |
| 99 | BY OTHERS |

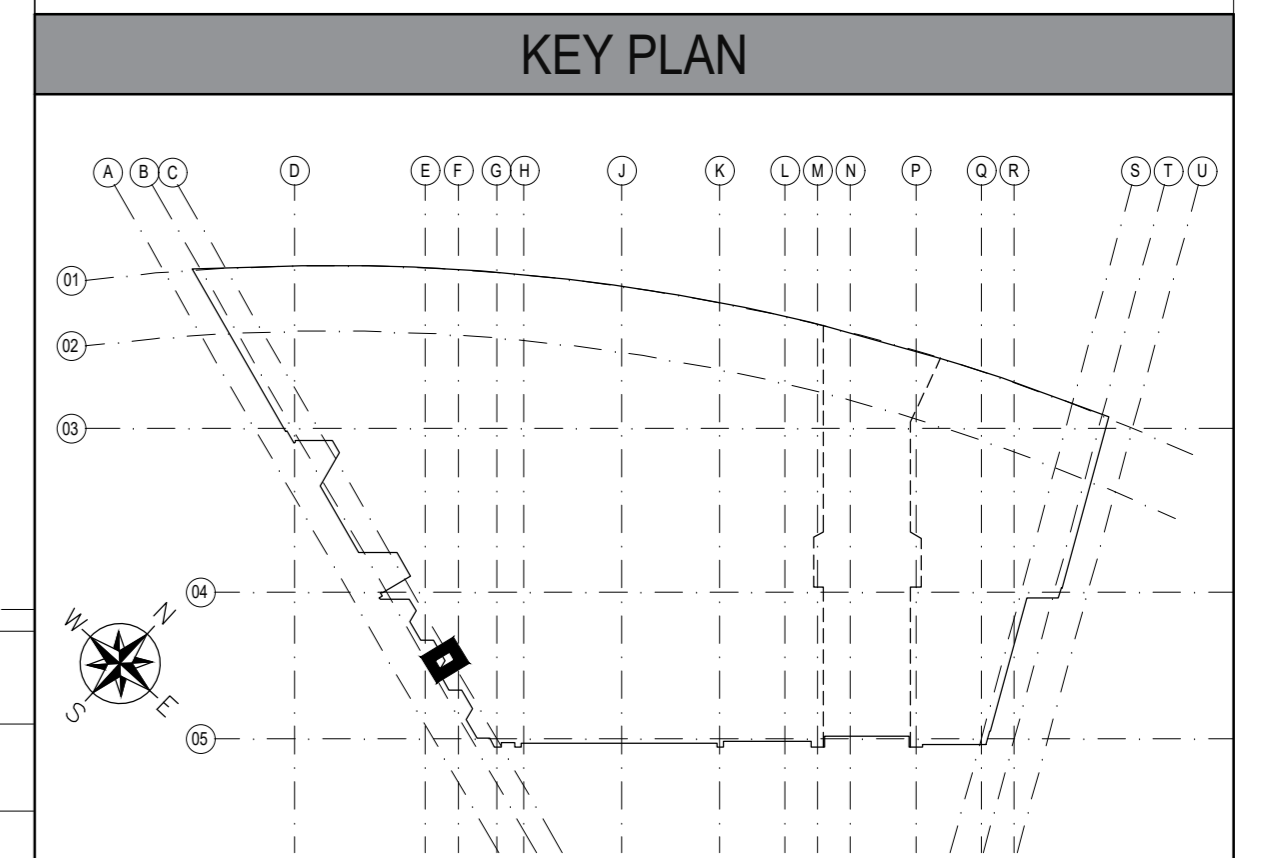

OUTSIDE

SANDBLASTED STEEL LIQUID PAINTED RAL 9016

VENTILATION

1309 FROM G.L. "C"

| | | | |
|--------------|--------------------------------|--------------|--------------------------|
| Project : | KING'S CROSS CENTRAL S3 | Location : | London |
| Architect : | * | Client : | BAM |
| Package : | Curtain wall | Issue : | 1/60 |
| File : | KXC-S3-001-Y-FCI-21-6204GF.DWG | Issued for : | CONSTRUCTION PROPOSAL S3 |
| Scale : | 1:2@A3 | Scale : | 1:2@A3 |
| Checked by : | A.V. | Checked by : | A.V. |
| Drafter : | A.V. | Drafter : | F.B. |
| Date : | 19-10-2020 | Date : | 21-12-2020 |
| Rev : | 00 | Rev : | 01 |
| Rev : | 01 | Rev : | 02 |
| Rev : | 02 | Rev : | 02 |

Dwg title : **ORIEL BAY HORIZONTAL SECTION**