

revisions  
A 07.06.2022 saltire blocks along whole wall

arts lettres techniques ARCHITECT Arts Lettres Techniques Limited 2022 copyright is retained ©  
33A ARLINGTON ROAD LONDON NW1 7ES T: (020) 7383 4778 architect@artslttr.com

PROJECT 23 Gloucester crescent  
SUBJECT Site plan existing

NUMBER GC 501  
REVISION A

SCALE 1:50 @ A3  
DATE 01/05/22

removal of eight courses  
of modern brick/cement  
based mortar

removal of cement based rendered  
coping to retained original wall

removal of cement based soldier course coping  
retain wal where structurally sound - repair fractures  
and eroded bricks using matching reclaimed yellow  
stock bricks with lime mortar and bagged pointing

rebuild around vertical fracture

Note:  
Original Saltire blocks remain in  
East party wall at high level within  
South Lightwell - proposed saltire  
blocks to be produced using  
casts of originals.

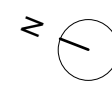
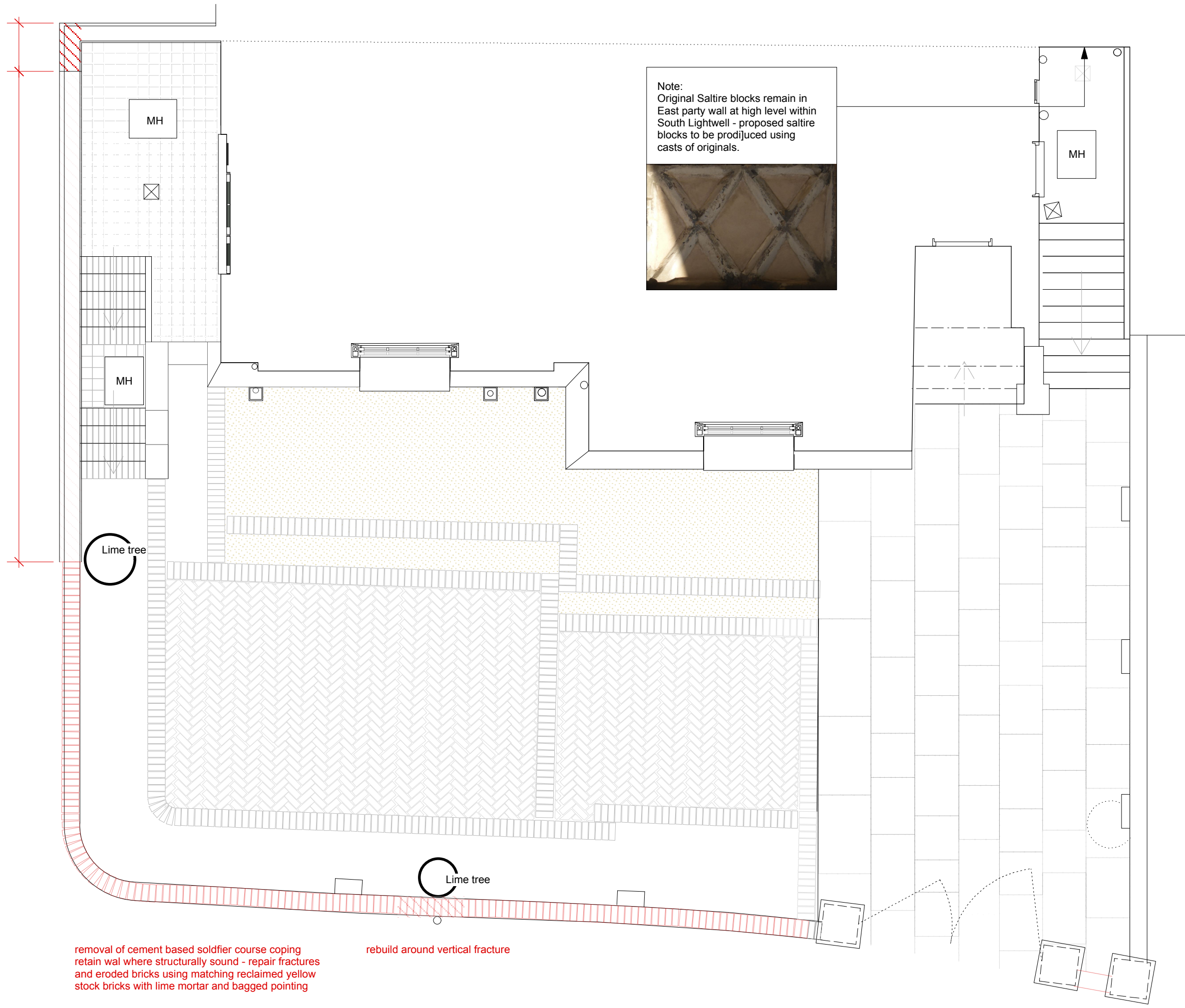

scale 1:50  
1.0m  
5.0m