

REVISIONS:
- 31.05.22 issued for planning

LADIES' POND

NOTES:

L.G lifeguard's building

S.H existing steward's hut
(mobile cabin)

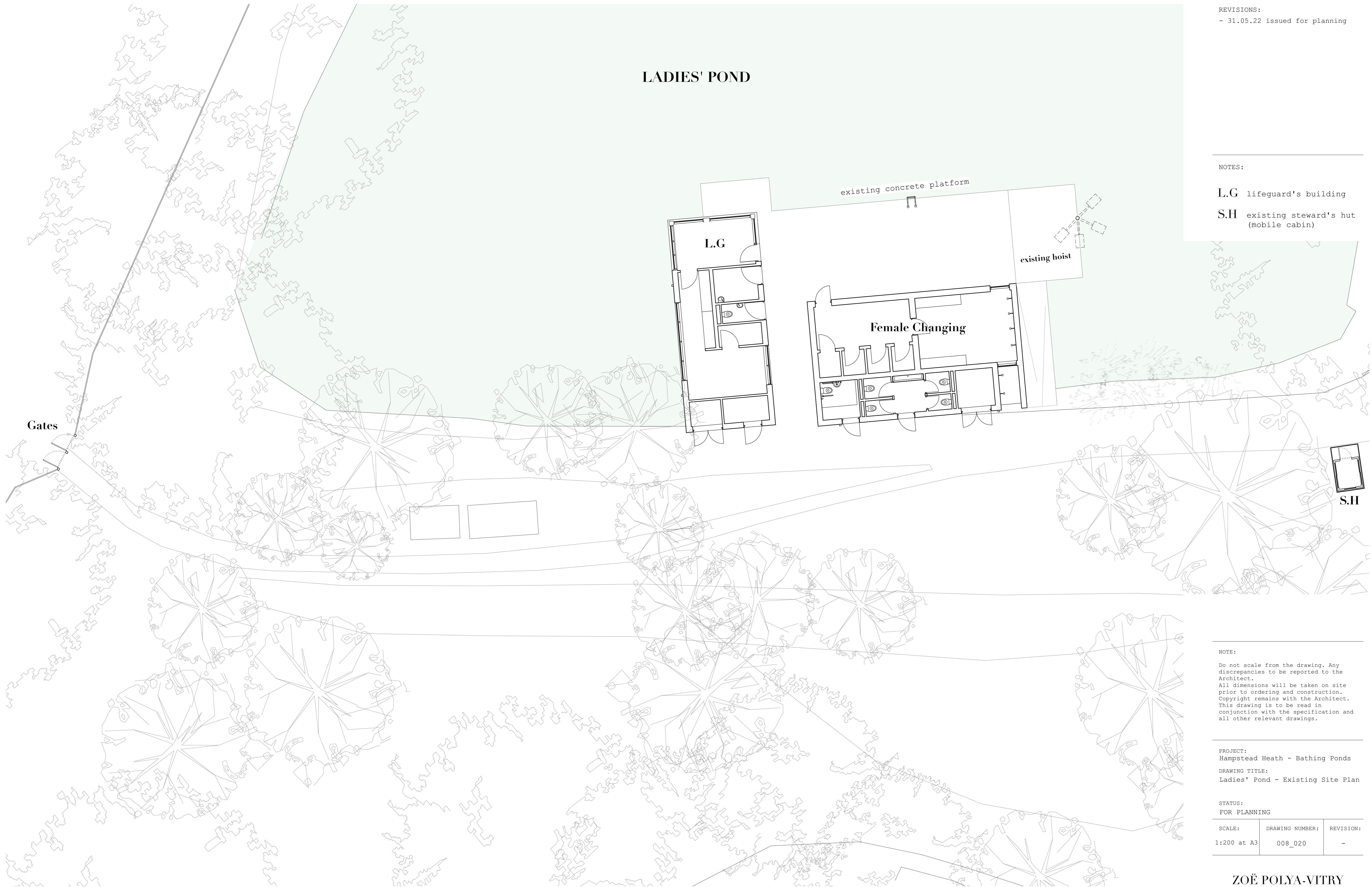

NOTE:

Do not scale from the drawing. Any discrepancies to be reported to the Architect.
All dimensions will be taken on site prior to ordering and construction. Copyright remains with the Architect. This drawing is to be read in conjunction with the specification and all other relevant drawings.

PROJECT:
Hampstead Heath - Bathing Ponds

DRAWING TITLE:
Ladies' Pond - Existing Site Plan

STATUS:
FOR PLANNING

SCALE:	DRAWING NUMBER:	REVISION:
1:200 at A3	008_020	-

ZOË POLYA-VITRY
Architect RIBA

tel +44 (0) 7855587682
zoe@zoepolya-vitry.com





NOTES:

EXISTING GATES - WEST Elevation

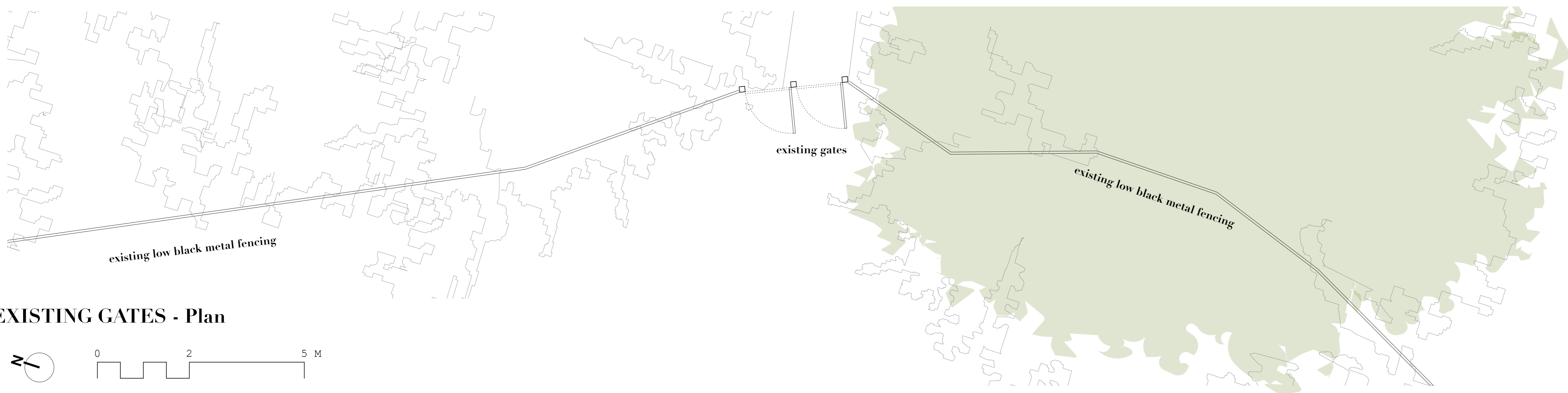

EXISTING GATES - Plan

NOTE:
 Do not scale from the drawing. Any discrepancies to be reported to the Architect.
 All dimensions will be taken on site prior to ordering and construction. Copyright remains with the Architect. This drawing is to be read in conjunction with the specification and all other relevant drawings.

PROJECT:
 Hampstead Heath - Bathing Ponds
 DRAWING TITLE:
 Ladies' Pond
 Existing Rear Gates Elevation
 STATUS:
 FOR PLANNING

SCALE:	DRAWING NUMBER:	REVISION:
1:100 at A3	008_022	-

ZOË POLYA-VITRY
 Architect RIBA

tel +44 (0) 7855587682
 zoe@zoepolya-vitry.com



A



B



C

PHOTOGRAPHIC ELEVATIONS of EXISTING MOBILE CABIN for STEWARD
 Cabin size: ±1850 L x 1500 W x 2100 H (mm)

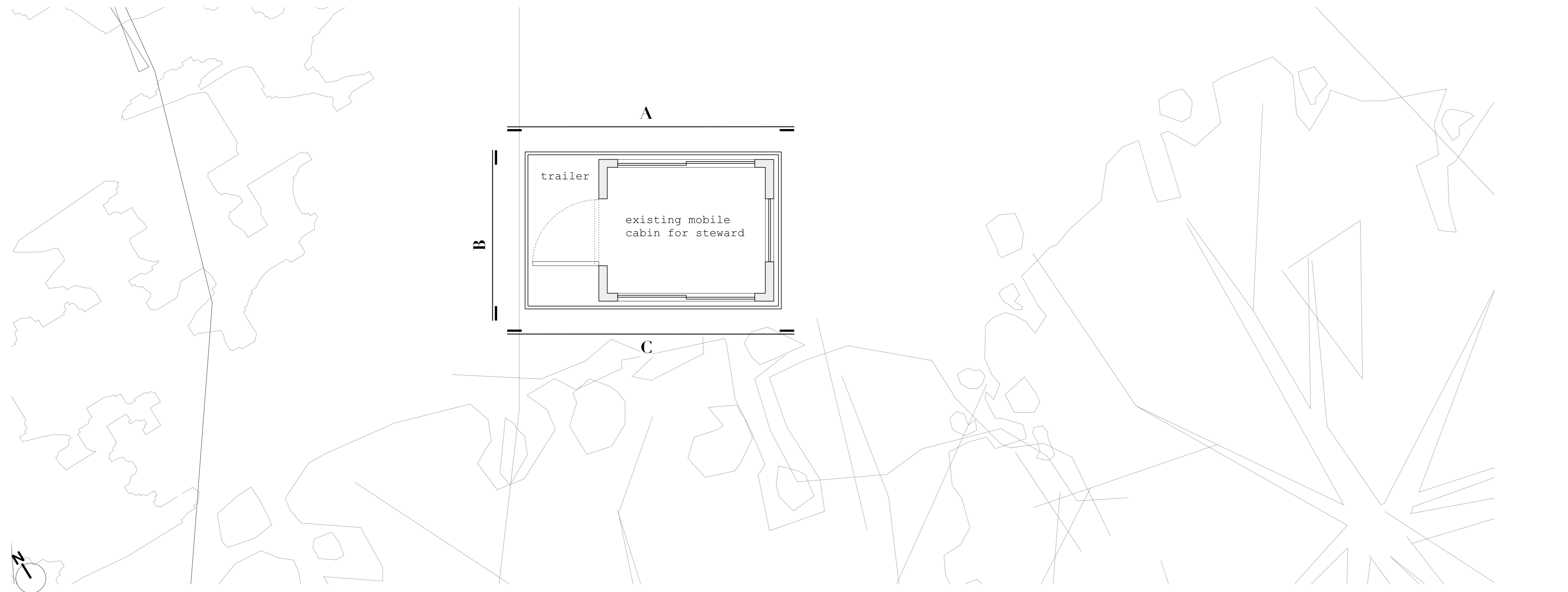

EXISTING MOBILE CABIN for STEWARD - Plan

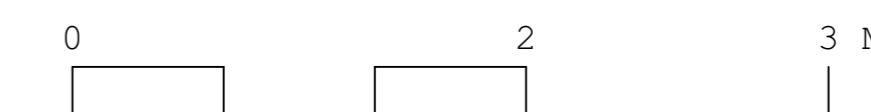

REVISIONS:
 - 31.05.22 issued for planning

NOTES:

NOTE:
 Do not scale from the drawing. Any discrepancies to be reported to the Architect.
 All dimensions will be taken on site prior to ordering and construction. Copyright remains with the Architect. This drawing is to be read in conjunction with the specification and all other relevant drawings.

PROJECT:
 Hampstead Heath - Bathing Ponds
 DRAWING TITLE:
 Ladies' Pond
 Existing Mobile Cabin for Steward

STATUS:
 FOR PLANNING

SCALE:	DRAWING NUMBER:	REVISION:
1:100 at A3	008_023	-

ZOË POLYA-VITRY
 Architect RIBA

tel +44 (0) 7855587682
 zoe@zoepolya-vitry.com