

- KEY:
- ③ Existing PPC Metal projecting canopy- a later addition to the 1960s extension.
 - ④ Existing PPC Metal bulkhead- a later addition to the 1960s extension.
 - ⑤ Existing Portland Stone wall panels to entrance reveals.
 - ⑥ Existing recessed roller shutter, housing and guide rails.
 - ⑦ Existing marble paving area.

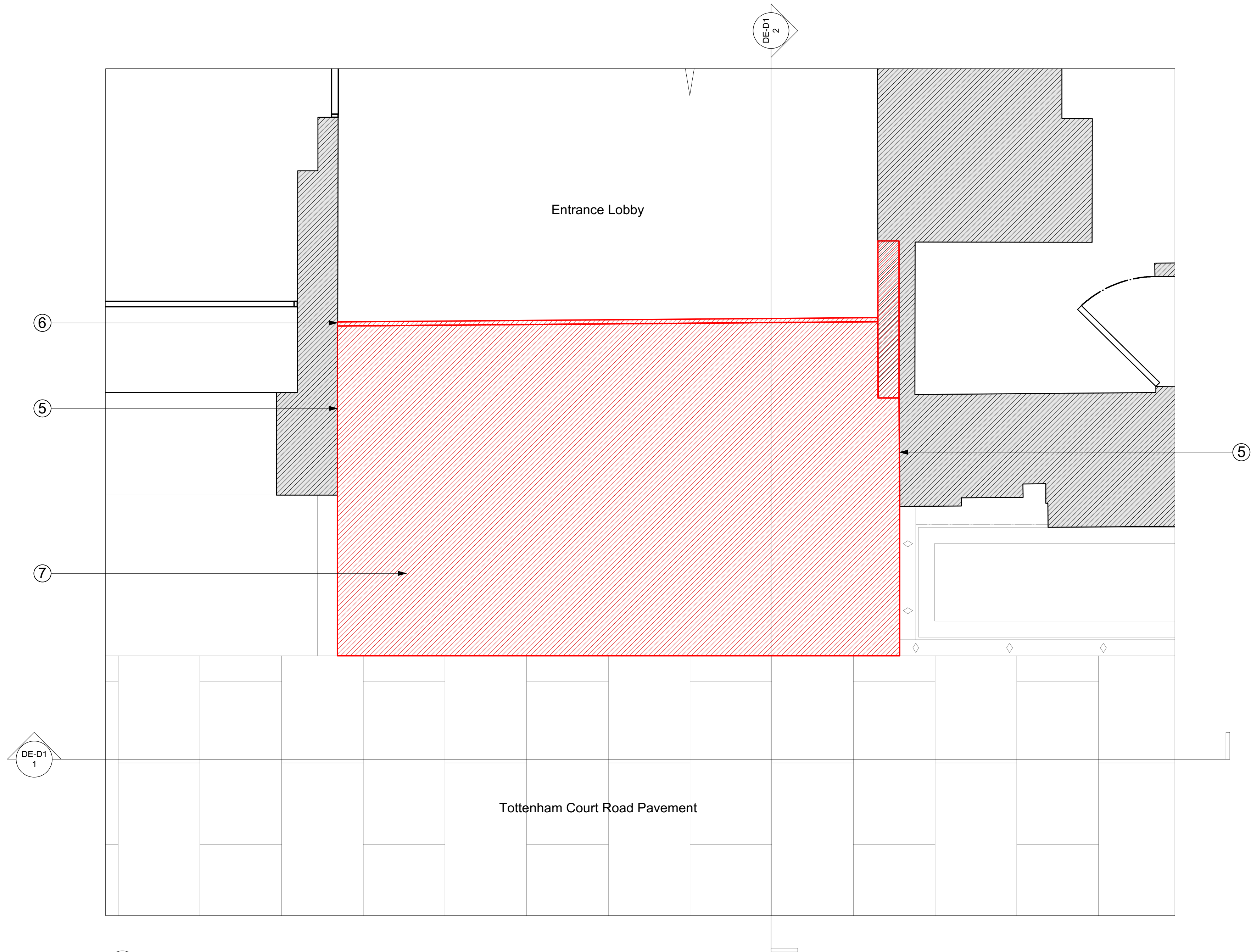

1 Demolition Ground Floor Plan
Scale: 1:20

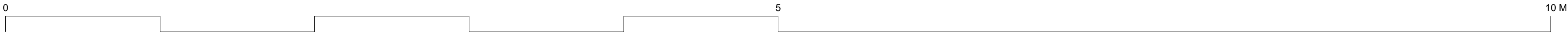

© Buckley Gray Yeoman Ltd.

All dimensions to be checked on site prior to commencement of any works, and/or preparation of any shop drawings. Sizes of and dimensions to any structural elements are indicative only. See structural engineers drawings for actual sizes/dimensions. Sizes of and dimensions to any service elements are indicative only. See service engineers drawings for actual sizes and dimensions.

This drawing to be read in conjunction with all other Architect's drawings, specifications and other Consultants' information. All proprietary systems shown on this drawing are to be installed strictly in accordance with the Manufacturers/Suppliers recommended details.

Any discrepancies between information shown on this drawing and any other contract information or manufacturers/suppliers recommendations is to be brought to the attention of the Architect.

DO NOT SCALE FROM THIS DRAWING.

DRAWING NOTES:

P1	13/05/22	Issued for Planning
REV. DATE		NOTE
		DRAWN

CLIENT	DRAWING	
General Projects	Tottenham Court Road Facade: Heal's Entrance Demolition Plan	
PROJECT	STATUS	APPROVED
Heal's Building	PLANNING	NJ
DWG No.	Revision	SCALE
1215_PL3A-P-02	P1	1:20 @ A1 1:40 @ A3
		DATE
		May 2022

BGY
BUCKLEY GRAY YEOMAN
+ 44 20 7033 9913
BGY.CO.UK