

1 AHSP SCREEN FRAME DETAIL
1 : 10

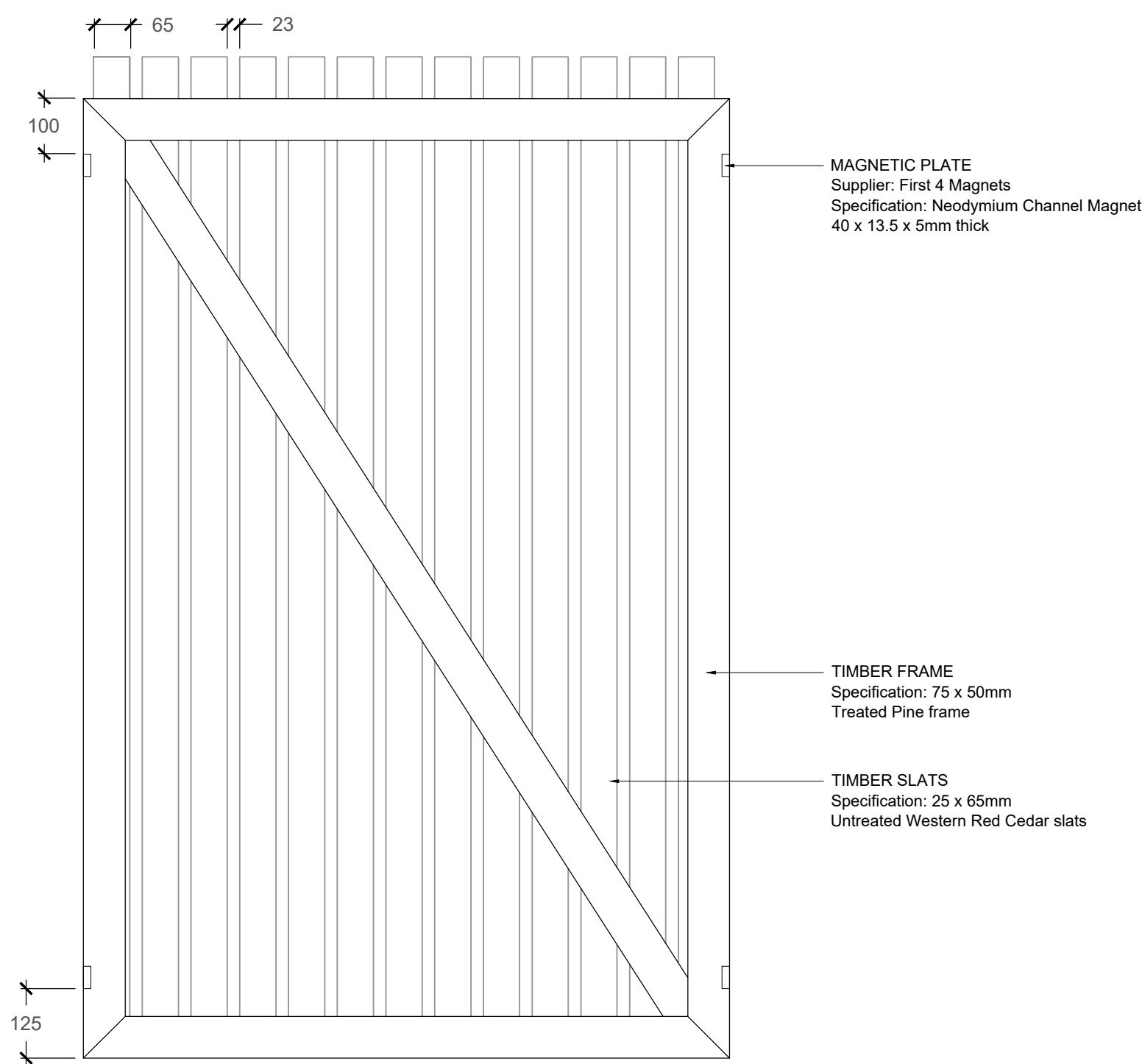

2 SCREEN PANEL
1 : 10

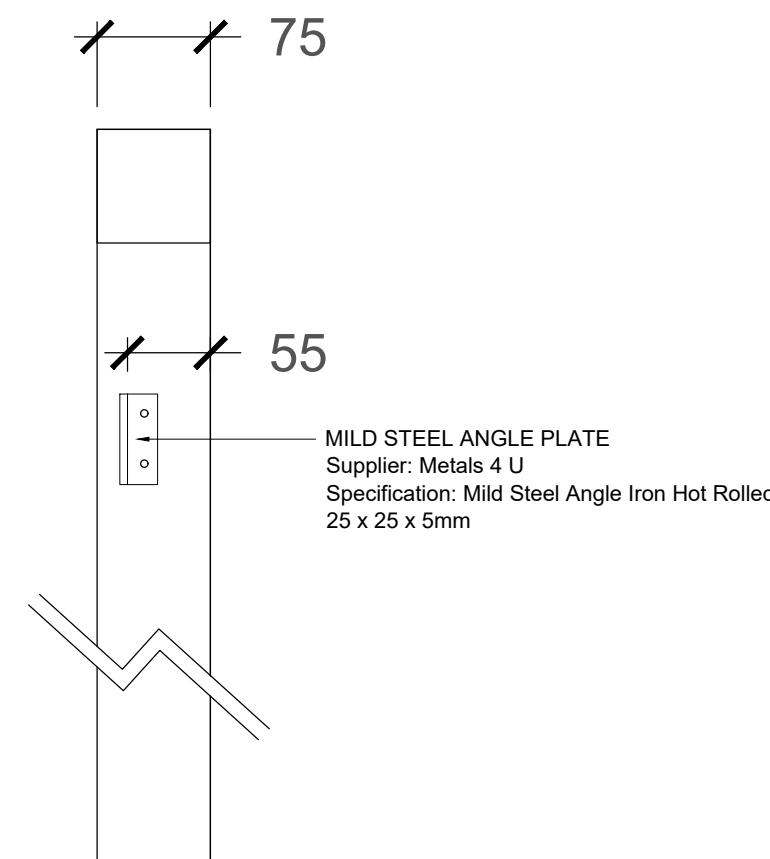

3 ANGLE PLATE ON POST
1 : 5

P01 Initial Issue
revision / date / description / drawn

Gloucester House,
399 Silbury Boulevard,
Milton Keynes,
Buckinghamshire
MK9 2AH
T 01908 303701
W www.enplan.net



client
Brooks Murray Architects

project
51 Calthorpe Street
WC1X 0HH

scale
Varies @ A1
date
May 2022

title
AHSP SCREEN DETAIL

drawn
LB
checked
DC

drawing number
061069-EN-XX-00-DR-L-601

revision
P01

issue
S4 - Suitable for Construction Approval
DO NOT SCALE FROM THIS DWG | DRAWING SUBJECT TO COPYRIGHTS