

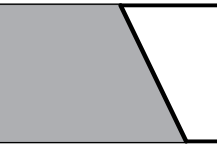

LANDSCAPE KEY



PROPOSED BUILDING LINE



DECORATIVE SHRUB PLANTING  
See drawing no. 061069-EN-XX-00-DR-L-703 for details

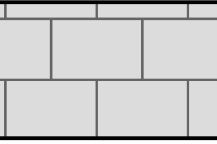

PAVING  
See drawing no. 061069-EN-XX-00-DR-L-503 for details

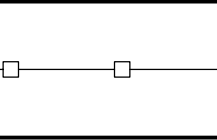

HARDWOOD SCREEN  
See drawing no. 061069-EN-XX-00-DR-L-503 for details



APPLICATION BOUNDARY

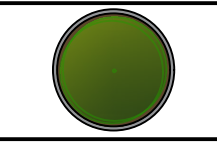

CLAY POT WITH FEATURE TREE  
See drawing no. 061069-EN-XX-00-DR-L-703 for details

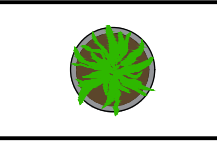

CLAY POT WITH FEATURE SHRUB  
See drawing no. 061069-EN-XX-00-DR-L-703 for details

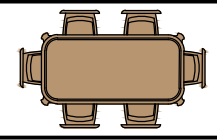

SIX SEATING DINNING TABLE

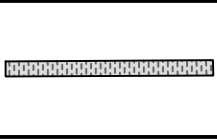

THRESHOLD DRAIN  
See drawing no. 061069-EN-XX-00-DR-L-503 for details

MAIN BUILDING

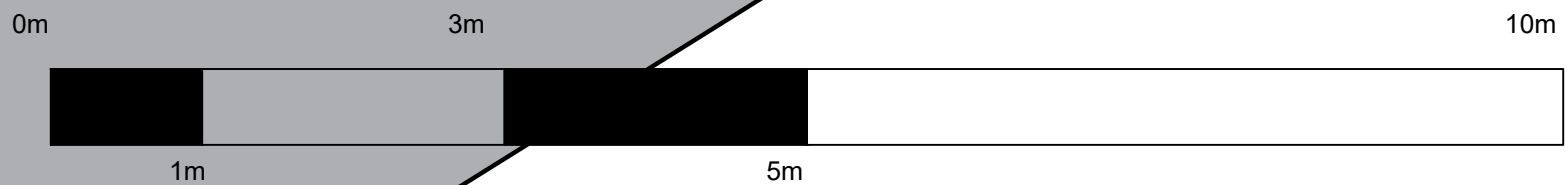
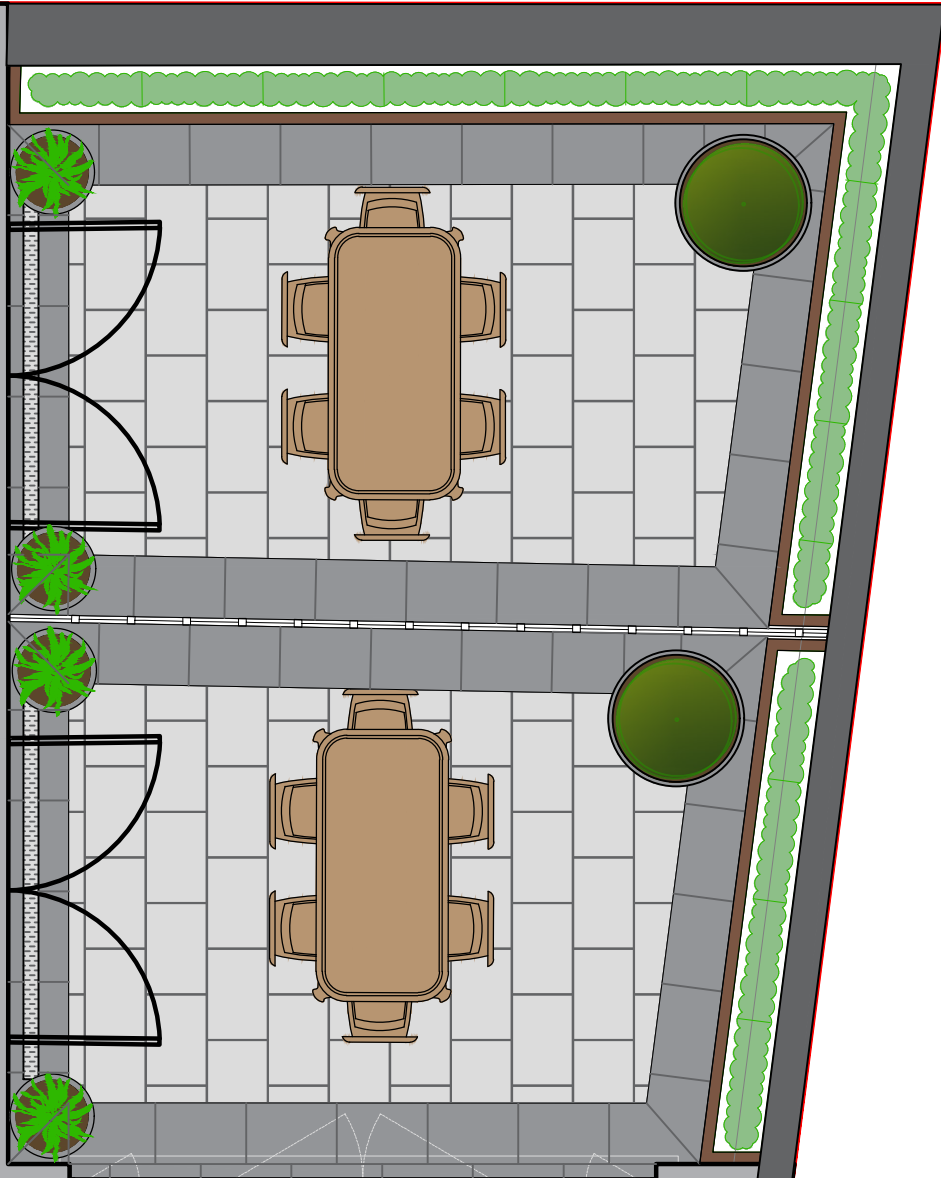

P01 Initial Issue  
revision / date / description / drawn

Gloucester House,  
399 Silbury Boulevard,  
Milton Keynes,  
Buckinghamshire  
MK9 2AH  
T 01908 303701  
W www.enplan.net



client  
Brooks Murray Architects

project  
51 Calthorpe Street  
WC1X 0HH

scale  
1.50 @ A1

date  
MAR 2022

title  
GENERAL ARRANGEMENT  
FIRST FLOOR

drawn  
DC

checked  
LB

drawing number  
061069-EN-XX-00-DR-L-303

revision  
P01

issue  
S4 - Suitable for Construction Approval

DO NOT SCALE FROM THIS DWG | DRAWING SUBJECT TO COPYRIGHTS