

3 Elevation
1 : 25

4 Section
1 : 25

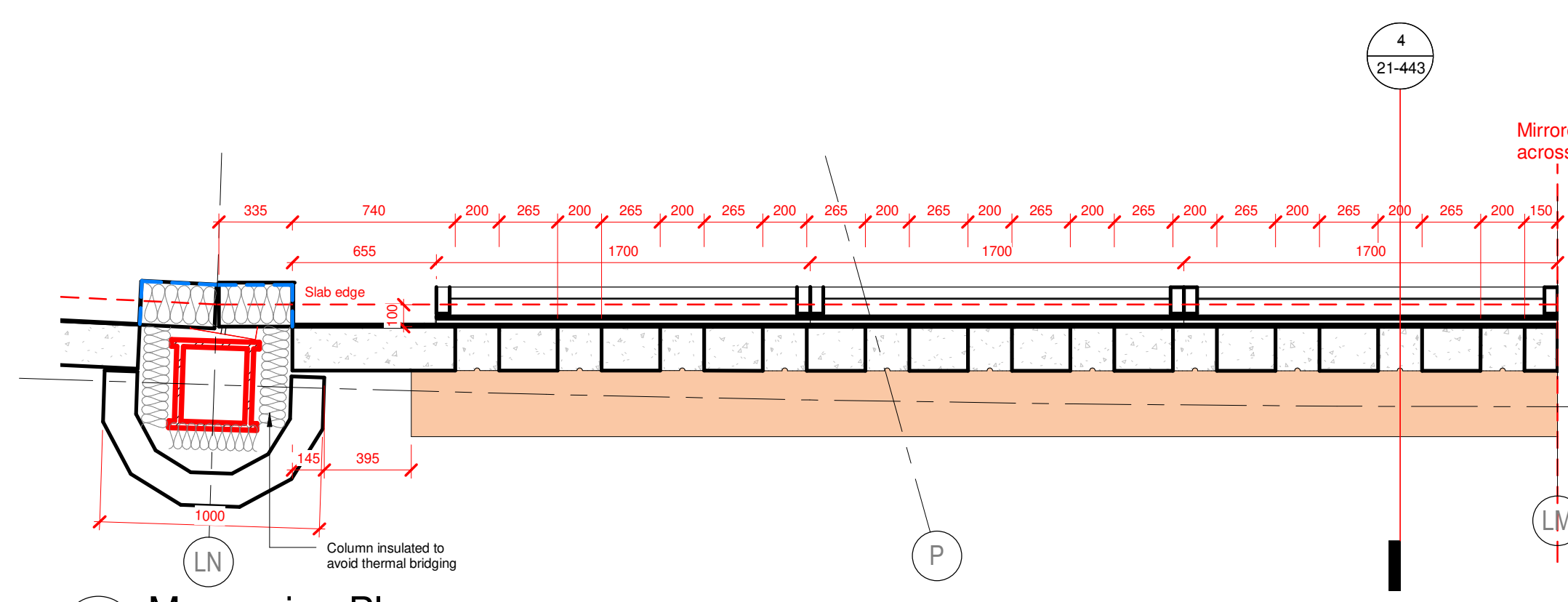

2 Mezzanine Plan
1 : 25

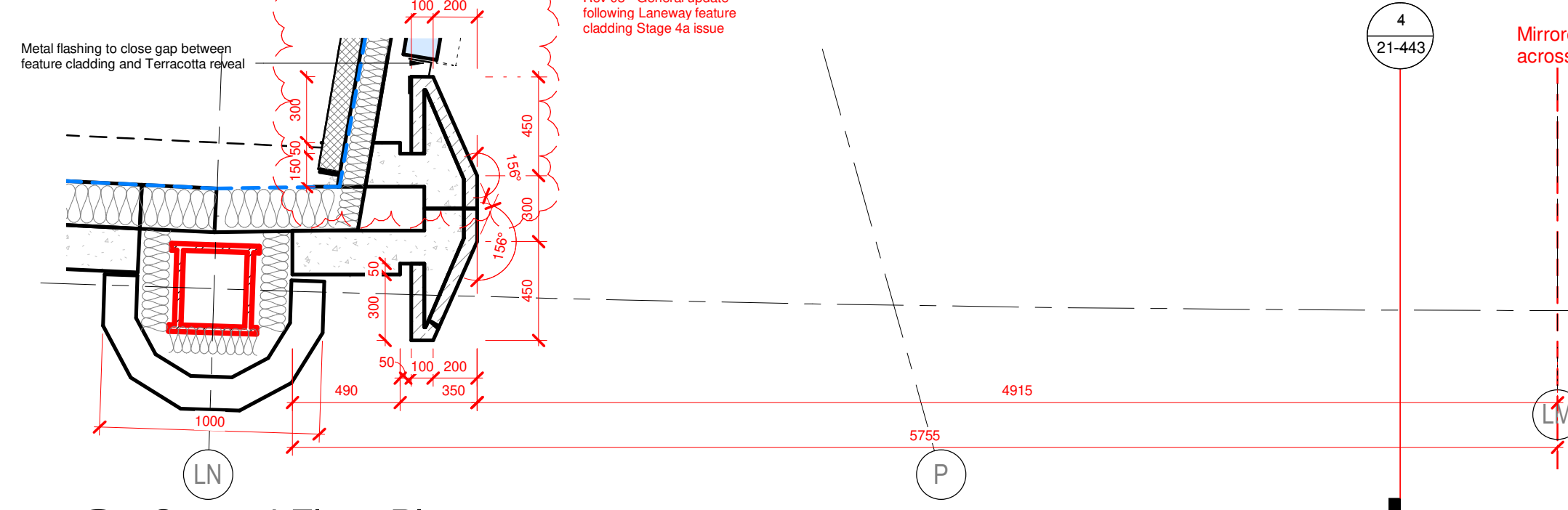

1 Ground Floor Plan
1 : 25

Notes:

- Manifestation to be provided in accordance with UK Building Regulations Approved Documents K and M. Manifestations to Architect's bespoke design.
- Glass types**
- GL 01 - DGU Low iron glass to Shop fronts, Oriol Bays and Cycle Entrance
 - GL 02 - DGU to Offices
 - GL 03 - SGU to Main Entrance Vestibule
 - GL 04 - DGU to Office Vestibules at Terraces
 - GL 05 - DGU Back Painted Glass to Washrooms
 - GL 06 - DGU at Rooflight with toughened glass outer pane
- Terracotta Extrusions** - See dwg 21-505
- T1 - Scaloped Terracotta Extrusion, glazed on all visible sides
 - T2 - Rectangular Terracotta extrusion, glazed on all visible sides
 - T3 - Triangular Terracotta Extrusion, glazed on all visible sides
 - T4 - Portal Frame to Retail, glazed on all visible sides
 - T5 - Portal Frame to Oriol Bays, glazed on all visible sides
 - T6 - Portal Frame to Laneway, glazed on all visible sides
 - T7 - Rectangular Terracotta Extrusion, glazed on all visible sides
- Caps** - See dwg 21-505
- C1 - Split T cap
 - C2 - Split Rectangular Cap, expressed vertically
 - C3 - Twin Rectangular Cap
 - C4 - No cap. Toggle fixed with SG sealant
 - C5 - Square cap
- Louvers**
- LV01 - Architectural louver + Insect Mesh to Retail - PPC finish
 - LV02 - Weathering Louver to Air Plenums + Insect mesh - PPC finish RAL TBC
 - LV03 - Architectural louver + Insect Mesh to Oriol Bays - PPC finish
 - LV04 - Architectural Louver Panel for tenant fit-out in Office + Insect Mesh - PPC finish RAL TBC
- Metal**
- M1 - Aluminium coping and channels - PPC finish
 - M2 - Aluminium closing detail + insulation where required - PPC finish
 - M3 - Folding aluminium panel with PPC finish + insulation with concealed louver
- Structural Engineer model used as background** : steel in red, concrete in dark grey
- To be read in conjunction with the (21) Series bay studies and details and (27) Series information
To be read in conjunction with the (20) Series plans, sections and elevations
To be read in conjunction with FIMDC specification and SketchBook
Refer to Reef information for cleaning & maintenance, loadings and layouts
Refer to Structural Engineer's information for loadings and Movement & Tolerances
Refer to Services information for location and number of services penetrations and outlets
External pavement levels are taken from Townshend Landscape Architect drawing TOWN279.26.04(03)5002 Rev 00
- Legend:**
- Fire Stopping/Cavity barrier
 - Vapour Control Layer
 - Waterproofing Layer
 - Brickslot channel drain
- Revisions:**
- Rev 03 - VE Item 5.14
 - Rev 03 - General update following Laneway feature cladding Stage 4a issue
 - Rev 03 - Plenum floor in place/panels. Details to be developed in line with VE item 7.11
 - Rev 03 - General update following Laneway feature cladding Stage 4a issue
 - Rev 03 - Key amended

Rev	Date	Revision	By	Chk	SL	Notes
01	200925	Issue for Review & Comment	FM	SL	SL	
02	201204	Issue for Contractor's Proposals	FM	SL	SL	
03	210323	Issue for Contractor's Proposals	FM	SL	SL	

Notes

- For Health & Safety related information please refer to the Rolling Designers Risk Register. Where relevant, elements identified on this register are highlighted within the model and on the drawings with the following logo.
- DO NOT SCALE FROM DRAWING.
- Drawing to be printed in colour.
- All information contained in this drawing (including digital data) should be checked and verified prior to any fabrication or construction. Any inconsistencies or omissions should be reported to Bennetts Associates.
- Unless otherwise stated, all grids or co-ordinates are based on the Ordnance Survey National Grid via GPS Observations.
- Unless otherwise stated, all spot heights and levels are expressed as AOD for 'above ordnance datum' based on the Ordnance Survey ODN (Ordnance Datum Newlyn).

Bennetts Associates Architects make no warranties, express or implied, with respect to the reuse of the data provided herewith, regardless of its format or the means of its transmission.

All existing survey data is based on, or reference from, 3rd Party information. Unless otherwise stated, all structural, mechanical, electrical information is based on, or reference from, 3rd Party data.

© Crown Copyright 2019. All Rights Reserved.
Ordnance Survey License 123456

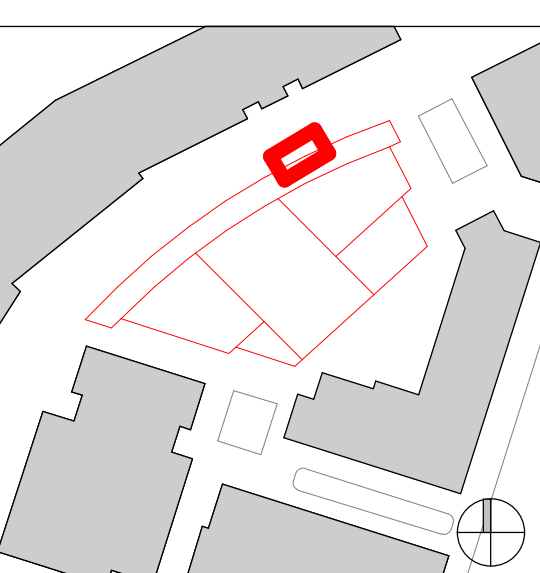

BENNETTS ASSOCIATES

1 Rawstorne Place, London EC1V 7NL
T +44(0)207 5203300 •
www.bennettsassociates.com

For Bennetts Associates' electronic information issue disclaimer -

Project
Kings Cross S3
Kings Cross Central Partnership Ltd

Drawing Title
Facade
Bay Study
Laneway entrance

Project No. 2011

Drawing Number
KXC-S3-001-A- 2011-21-443

Suitability / Revision
D5 / 03

Scale @ A3
1:50

Scale @ A1
As indicated

Revision Date
210323

YY MM DD