

REVISION	DATE	BY	DESCRIPTION
A	21.01.2019	TB	RETAIL REFUSE STORE RELOCATED FOLLOWING INSTRUCTION FROM CLIENT.
B	24.01.2019	TB	DRAWING UPDATED FOLLOWING COMMENTS FROM APPROVED INSPECTOR.
C	21.02.2019	TB	DRAWING UPDATED FOLLOWING COMMENTS FROM CLIENT.
D	13.03.2019	TB	REFUSE STORE ROOF REINSTATED. SEE INFORMATION ADDED AND 2 NO. ADDITIONAL DRAINAGE POINTS ADDED.
E	24.04.2019	TB	DOOR AND 2 NO. ADDITIONAL DRAINAGE CONNECTIONS TO UNIT 20-21 REPOSITIONED AND SET-OUT DIMS ADDED.
F	22.05.2019	KL	REFUSE STORE RELOCATED, REAR DOOR POSITIONS AMENDED, DRAINAGE AMENDED AND DOUBLE WIDTH OPENINGS TO SEPARATING BLOCK WALLS INTRODUCED.
G	21.06.2019	TB	DRAINAGE UPDATED TO PUBLIC HEALTH ENGINEERS' DETAILS.

REFERENCE FILES

NOTES

LEGEND

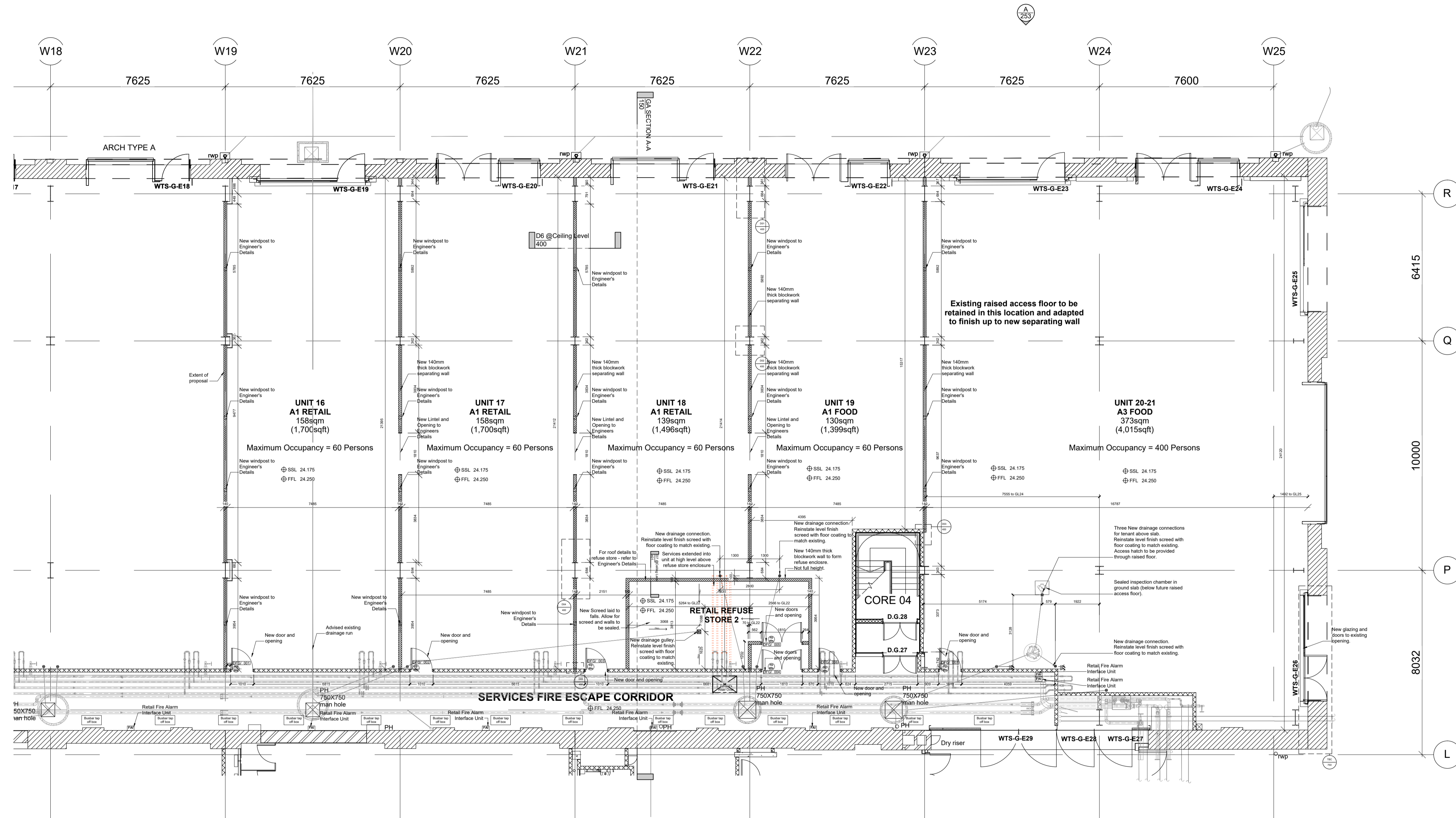

NEW 1000 CONNE L.R BEND I.L.
NEW 1000 CONNE L.R BEND I.L.
NEW RODABLE TRAPPED FLOOR GULLY I.L 23.800

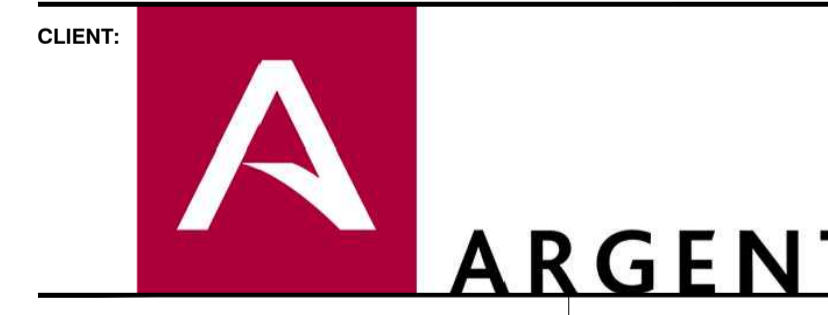
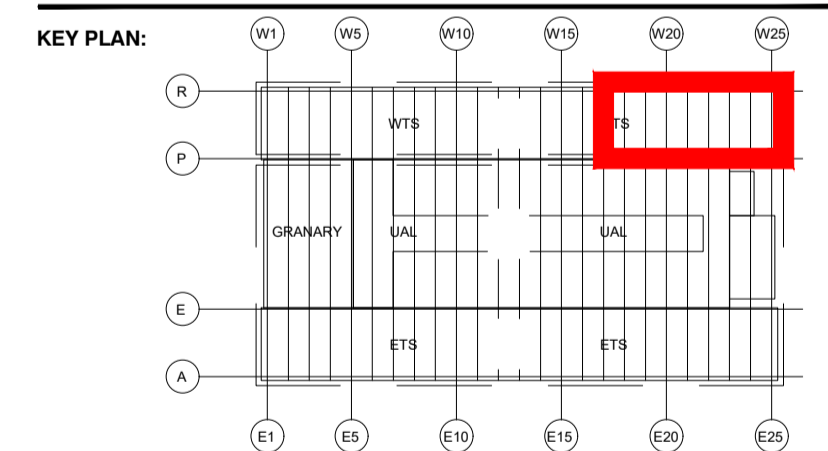

ISSUED FOR:
STAGE 5

dga architects David Gallagher Associates LLP Telephone 0207 834 9474
Studio 107, Food Exchange info@dga-architects.co.uk
New Covent Garden Market www.dga-architects.co.uk
London SW6 5EL

CLIENT	ARGENT LLP
PROJECT	THE BIGGER ROOM, WTS KINGS CROSS
DRAWING	PROPOSED GA PLAN
JOB NO.	1736
DRAWING NO.	050
REVISION	G
DATE DRAWN	07.12.2018
DRAWN BY	KL
SCALE	1:100@A1

1736-050_G

1:100@A1 PROPOSED GA PLAN