

COMMERCIAL SOLAR PROJECT

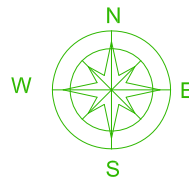

DRAWN BY	
DRAWN BY	TT
CHECKED BY	IBS

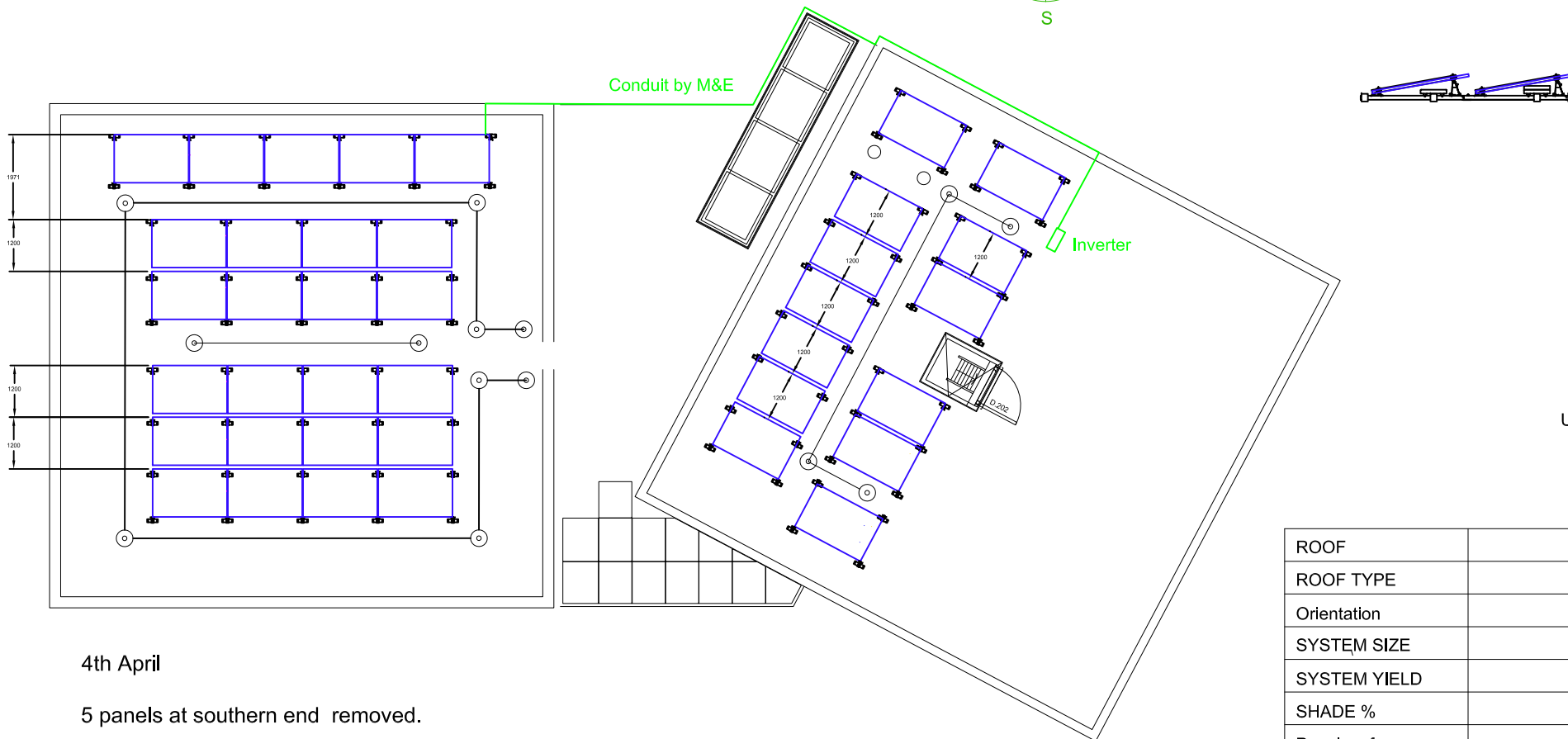

Powersun Ltd
Unit 10 Bicester Park
Charbridge Way
Bicester
OX26 4SS

ROOF	
ROOF TYPE	
Orientation	
SYSTEM SIZE	
SYSTEM YIELD	
SHADE %	
Panel surface area	
Module type	
Module clips (Gap)	
POST CODE	NW1 8EH

20 March 2020

Roundhouse - new

Powersun
Solar PV



Hi-power draft D00

4th April

5 panels at southern end removed.

Panels Suntech 410Wp - 1724 x 1134

Originally : 44 panels @ 385Wp = 16.94kWp

New : 38 panels @ 410Wp = 15.77kWp panel area 74.29m²

Inter row shading will affect performance.