

Do not scale from this drawing. All dimensions to be checked on site. All omissions and discrepancies to be reported to the Architect immediately

This work is copyright and shall not be reproduced or used for any other purpose without the written permission of Squire and Partners.

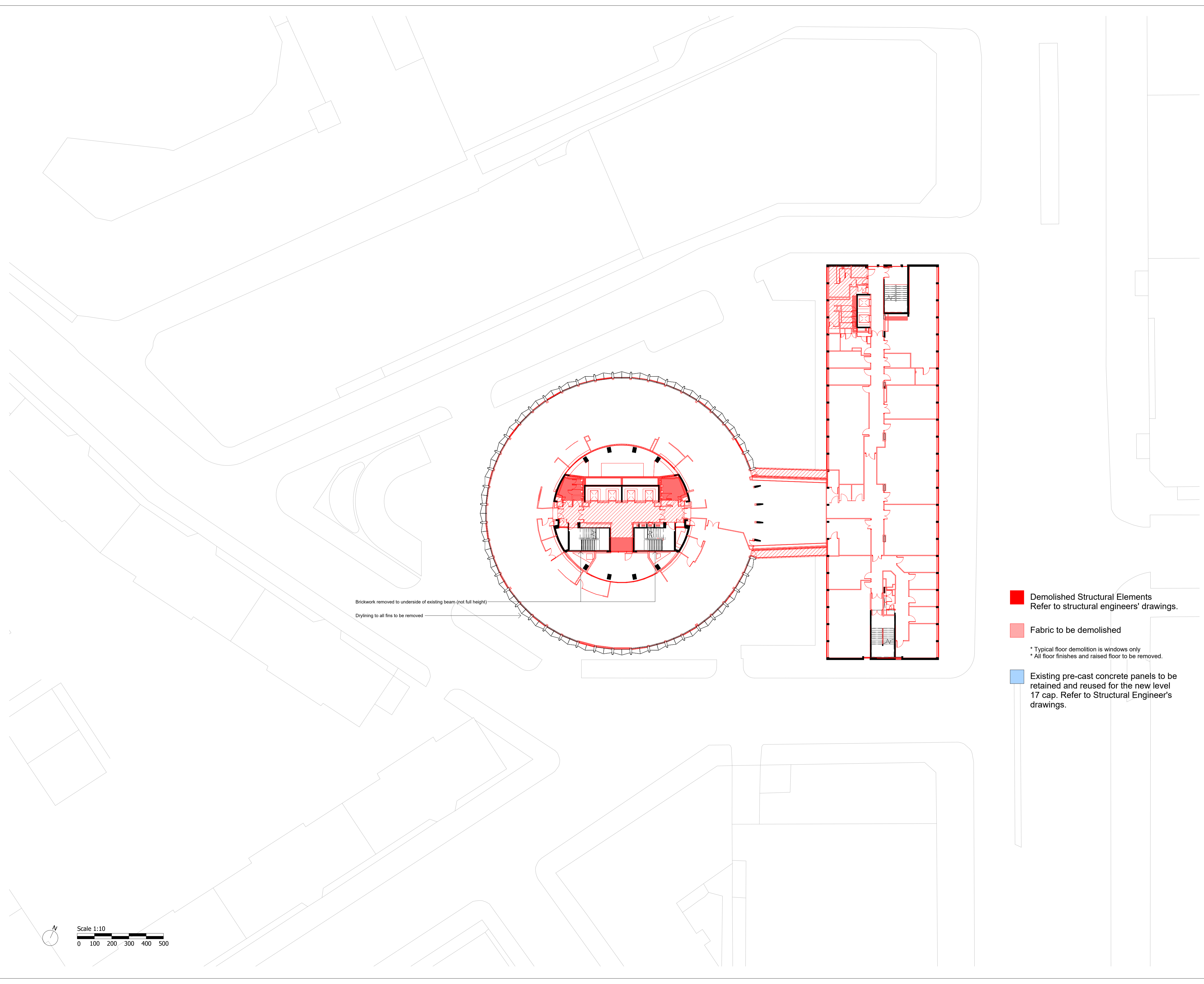

Brickwork removed to underside of existing beam (not full height)
Drylining to all fins to be removed

- Demolished Structural Elements
Refer to structural engineers' drawings.
- Fabric to be demolished
 - * Typical floor demolition is windows only
 - * All floor finishes and raised floor to be removed.
- Existing pre-cast concrete panels to be retained and reused for the new level 17 cap. Refer to Structural Engineer's drawings.

Description	Date	Chk	Rev
Non-Material Amendment Issue	16/05/22	SQP	D
Non-Material Amendment Issue	09/02/22	SQP	C
Pre-Application Advice	08/07/20	SQP	B
Planning Submission	24/05/19	SQP	A

SQUIRE & PARTNERS

Squire and Partners LLP
The Department Store
248 Finsdale Road, London SW9 8FR
T: 020 7278 5555

info@squireandpartners.com
www.squireandpartners.com

Project
Space House
London
WC2

Title
Level 02
Demolition Plan

Status	Scale	Job Number
Planning Submission	@ ISO A1	18077
Date	1 : 250	18077
24/05/19		
Drawing Number	Revision	
18077-SQP-ZZ-02-DP-A-PL01007	D	

