

Glazing Sections

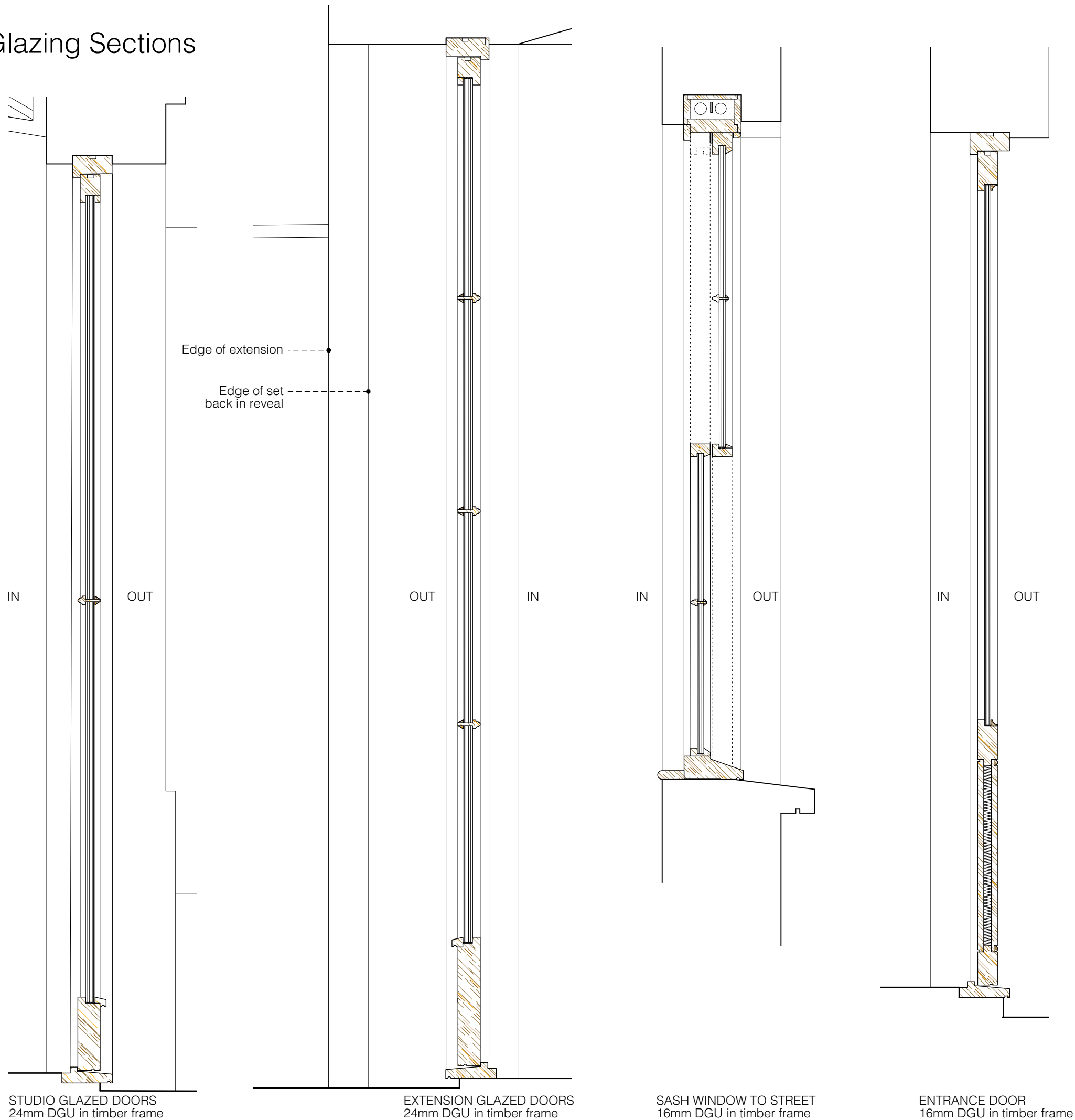

STUDIO GLAZED DOORS
24mm DGU in timber frame

EXTENSION GLAZED DOORS
24mm DGU in timber frame

SASH WINDOW TO STREET
16mm DGU in timber frame

ENTRANCE DOOR
16mm DGU in timber frame

GENERAL NOTES:

This drawing is to be read in conjunction with the contract specification, the engineer's drawings and specification, and where appropriate the drawings and specifications prepared by relevant sub contractors.

All works are to be undertaken in accordance with the Building Regulations and the latest British Standards and Codes of Practice. The contractor must obtain Building Control permissions as necessary and appropriate.

All proprietary materials and products are to be used strictly in accordance with the manufacturers recommendations.

IF IN DOUBT - ASK!

Printed correctly this line will
measure 50mm @ A3 size

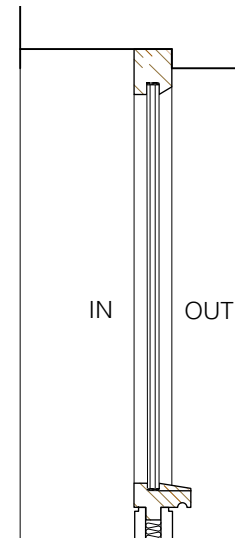

STUDIO LUNETTE WINDOW
16mm DGU in timber frame

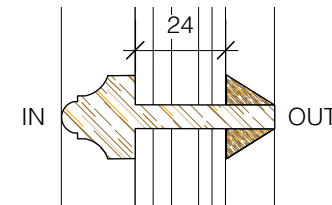

GLAZING ASTRAGAL 1:2
24mm DGU

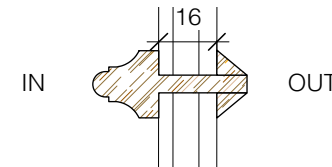

GLAZING ASTRAGAL 1:2
16mm DGU

REV	DATE	DESCRIPTION
-----	------	-------------

TIMOTHY SMITH & JONATHAN TAYLOR LLP
Architects

85 Second Avenue • London • E12 6EN
www.smithandtaylorllp.com • info@smithandtaylorllp.com

020 7241 1494

PROJECT: Stratford Villas

PROJECT ADDRESS 7 Stratford Villas
CLIENT Rose Davey & Joe Lewis
Camden
London NW1 9SJ

DRAWING TITLE Glazing Sections_A3

PROJECT No.	DRAWING No.	REVISION
253	253 P-103	

DRAWN: TS
CHECKED: JT
ISSUE: PLANNING

SCALE: 1:10@A3 /as noted
DATE: 19/5/22

CAD FILENAME: Filename