

CONDITION 7 a) - SASH WINDOW DETAILS

CONDITION 7 b) - TYPICAL NEW RAILINGS AND BALUSTRADE DETAILS

Head Detail Scale 1:10

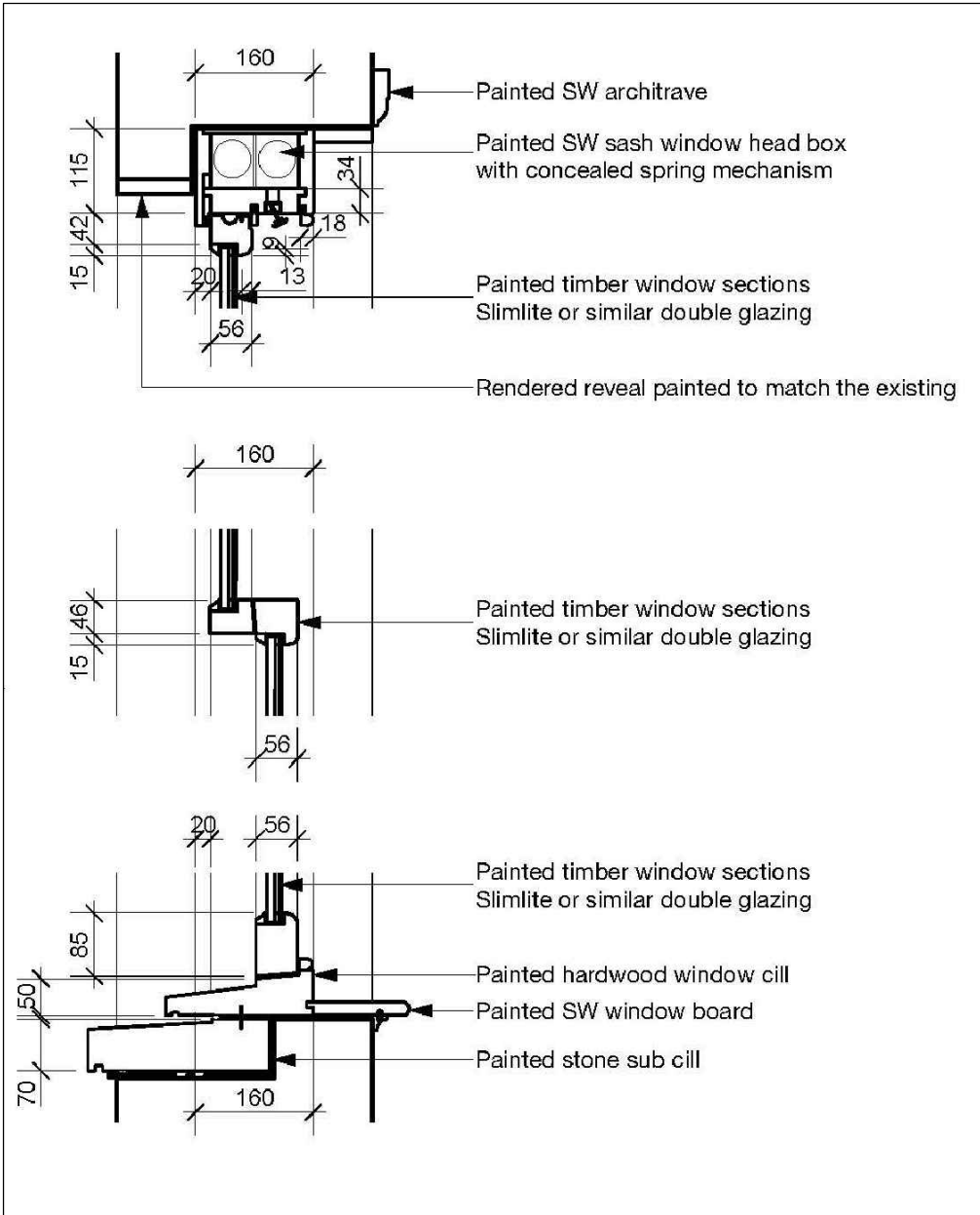

Jamb Detail Scale 1:10

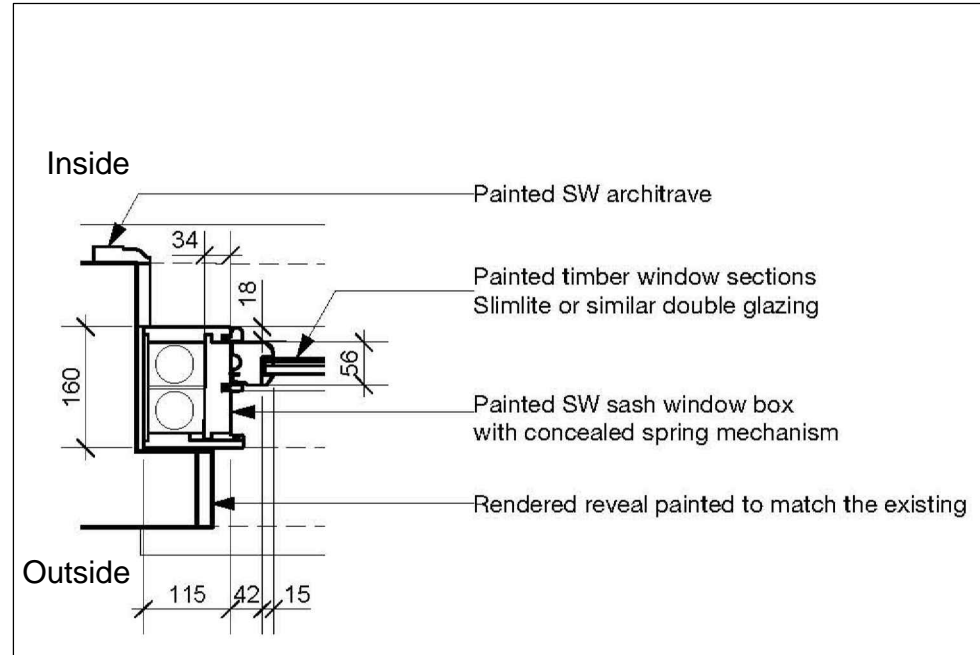

Glazing bar Detail Scale 1:1

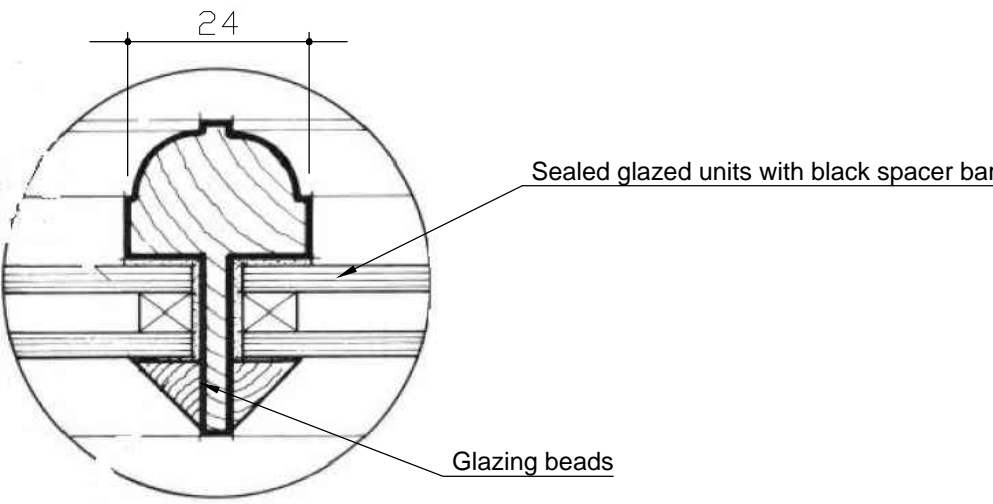

Sill Detail Scale 1:10

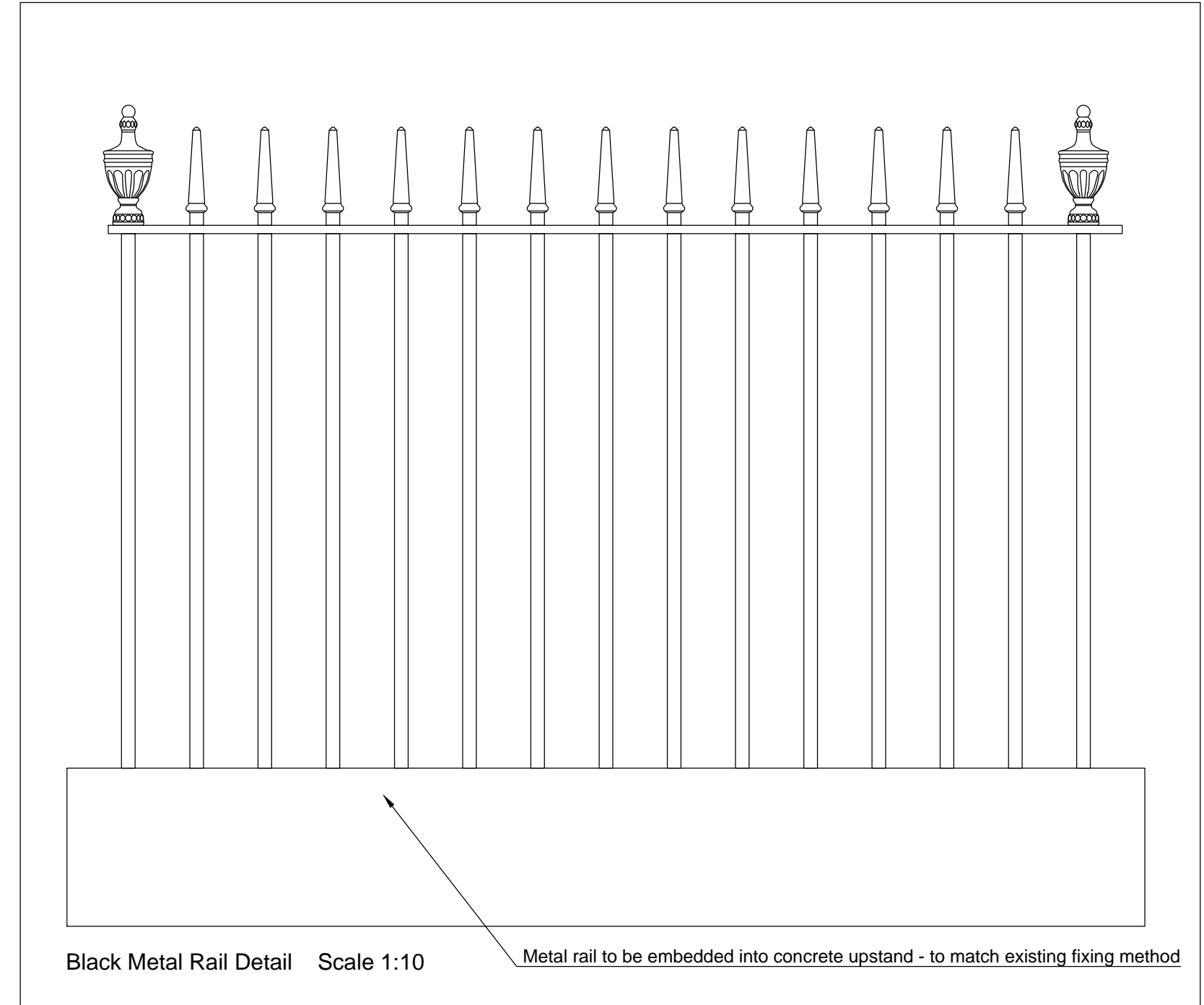

CONDITION 7 a) - EXTERNAL DOOR DETAILS

Head Detail Scale 1:10

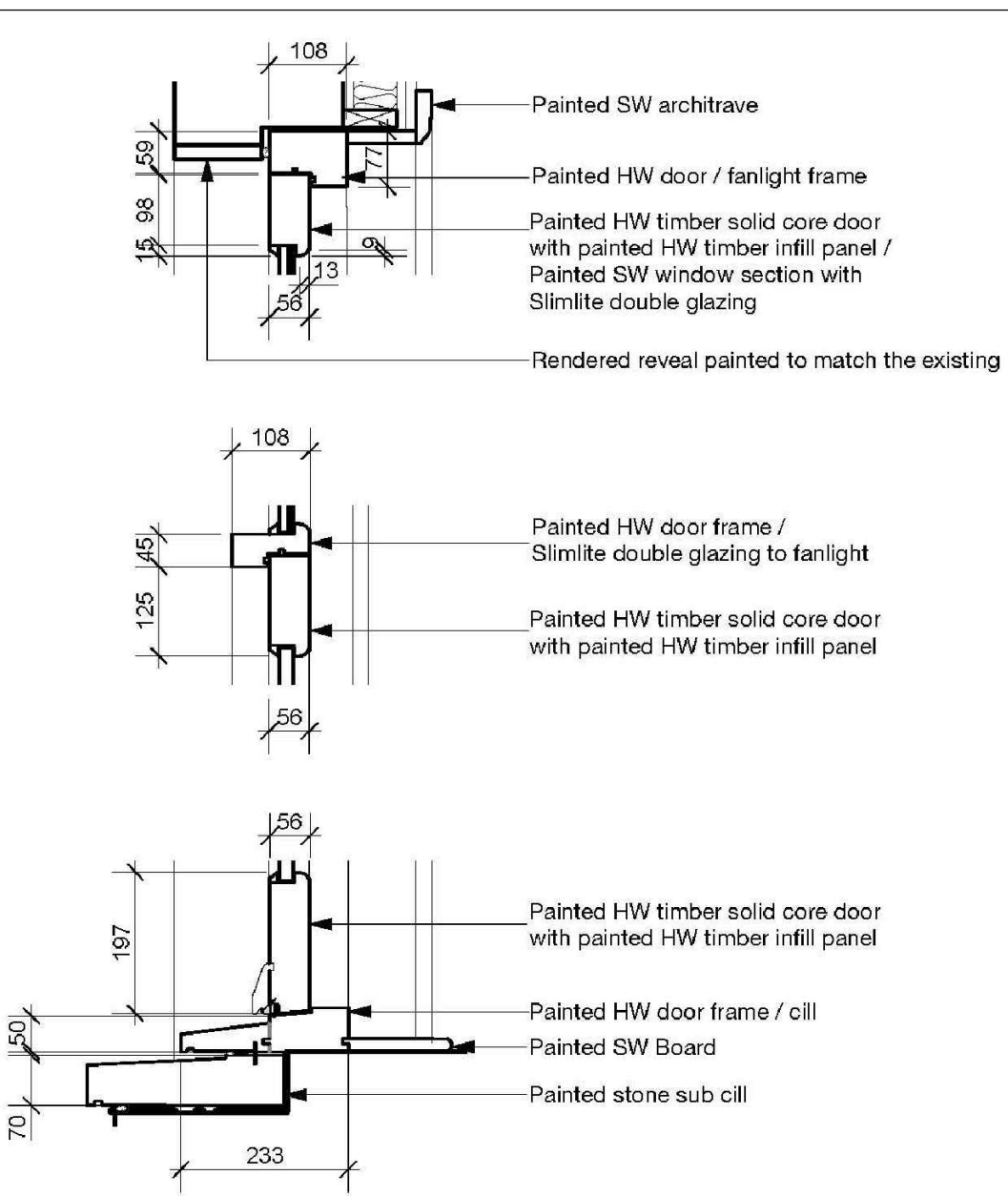

Jamb Detail Scale 1:10

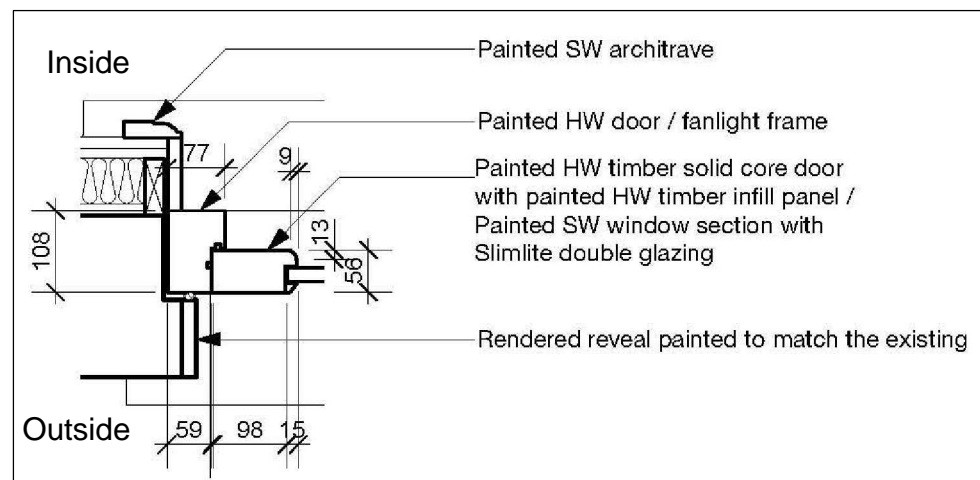

Glazing bar Detail Scale 1:1

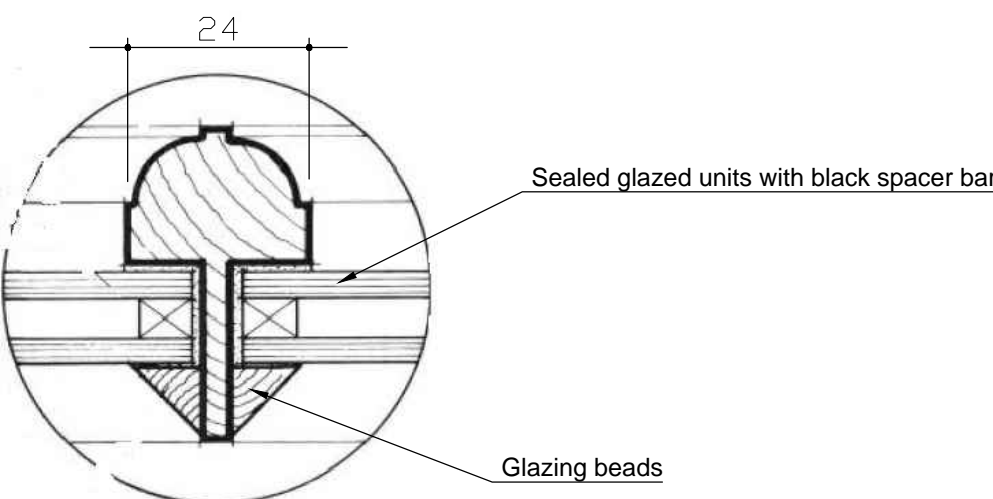

Sill Detail Scale 1:10

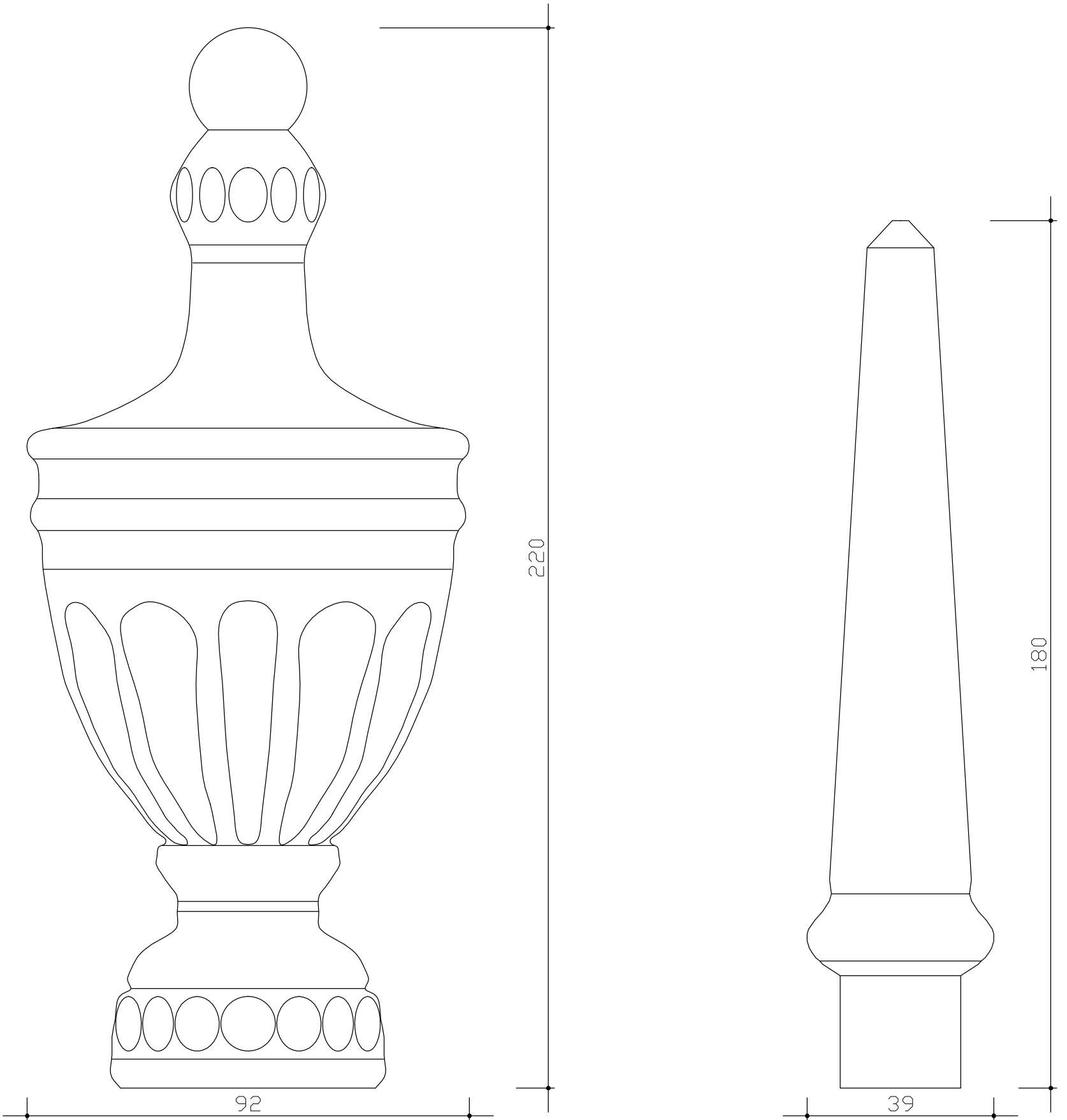

Finials Details - to match neighbouring properties Scale 1:1

General Note

Local authorities (Planning Group or Building Control) might request for additional items information to be added / revised.

Contractor, sub-contractor or supplier is to report any errors, omission or discrepancies on the drawings, and shall not vary any work shown on the drawings without obtaining prior approval from the architect. Contractor, sub-contractor or supplier is responsible for requesting any additional information from the architect for the correct execution of the works.

Contractor, sub-contractor or supplier shall supply to the architect all shop drawings, illustrations, specifications, etc. of all specialist work to be incorporated into the main contract works, and shall immediately inform the architect if any work shown on this drawing is not in accordance with the relevant codes of practice recognised as good practice throughout the industry or if it does not comply with the relevant local authority bye-laws or building regulations.

Contractor to verify all dimensions on site before commencing any work on site or preparing any shop drawings. Figured dimensions to take precedence over scaled dimensions.

Contractor, sub-contractor or supplier shall immediately advise the architect / quantity surveyor of the effect upon programme and cost of any alterations to the proposed works shown on this drawing.

All materials, components and workmanship to comply with the relevant British Standards, Codes of Practice and appropriate manufacturers' recommendations that from time to time shall apply.

This drawing superseeds all previous issues of the same drawing number with earlier revisions

This drawing and design is copyright to Tal Arc Ltd and remains the property of Tal Arc Ltd, and as such the contents must not be disclosed to anyone or reproduced in any way without prior consent from Tal Arc Ltd.

Additional Note

[illegible]

PROJECT

11-12 Grenville Street
London, WC1N 1LZ

CLIENT

11-12 Grenville Street Ltd.
11-12 Grenville Street,
London, WC1N 1JZ

ZONE A	DISCIPLINE ARCHITECTURE	STATUS PLANNING
LEVEL A	DRAWING NUMBER 1112GR-PP5CON-01	REVISION
PAPER SIZE	A1 SHEET	
DRAWING TITLE	CONDITION 7 a) EXTERNAL WINDOWS AND DOORS CONDITION 7 b) TYPICAL RAILINGS AND BALUSTRADES	
SCALE 1:10. 1:1	DATE 09/05/2022	DRAWN KZ CHECKED YS

TAL ARC LTD.
ARCHITECTURE | DESIGN

2A CRESCENT ROAD
LONDON N3 1HP, U.K.
T. 020 3302 9916

E. INFO@TALARC.CO.UK
W. WWW.TALARC.CO.UK

PROJECT TITLE 11-12 Grenville Street, London, WC1N 1LZ

