

4.2.1 Design Proposals - Look & Feel

Doorsets to Workplace

New doors to the workspace areas and teaching spaces will be faced with graphite colour laminate and have oak lippings. Door frames to be oak and all door furniture to be stainless steel. Vision panels and ironmongery to doors will be installed to suit the door type and application.

Doors to new meeting rooms with glazed partitioning will be polyester powder coated aluminium in line with typical details from Phase 1.



Display space and seating benches punctuate walls



Timber framed doorsets and glazed screens to workspace



Timber framed doorsets to Phase 1

4.2.3 Design Proposals - Level 9 Zone C

Existing layout of Level 9 Zone C

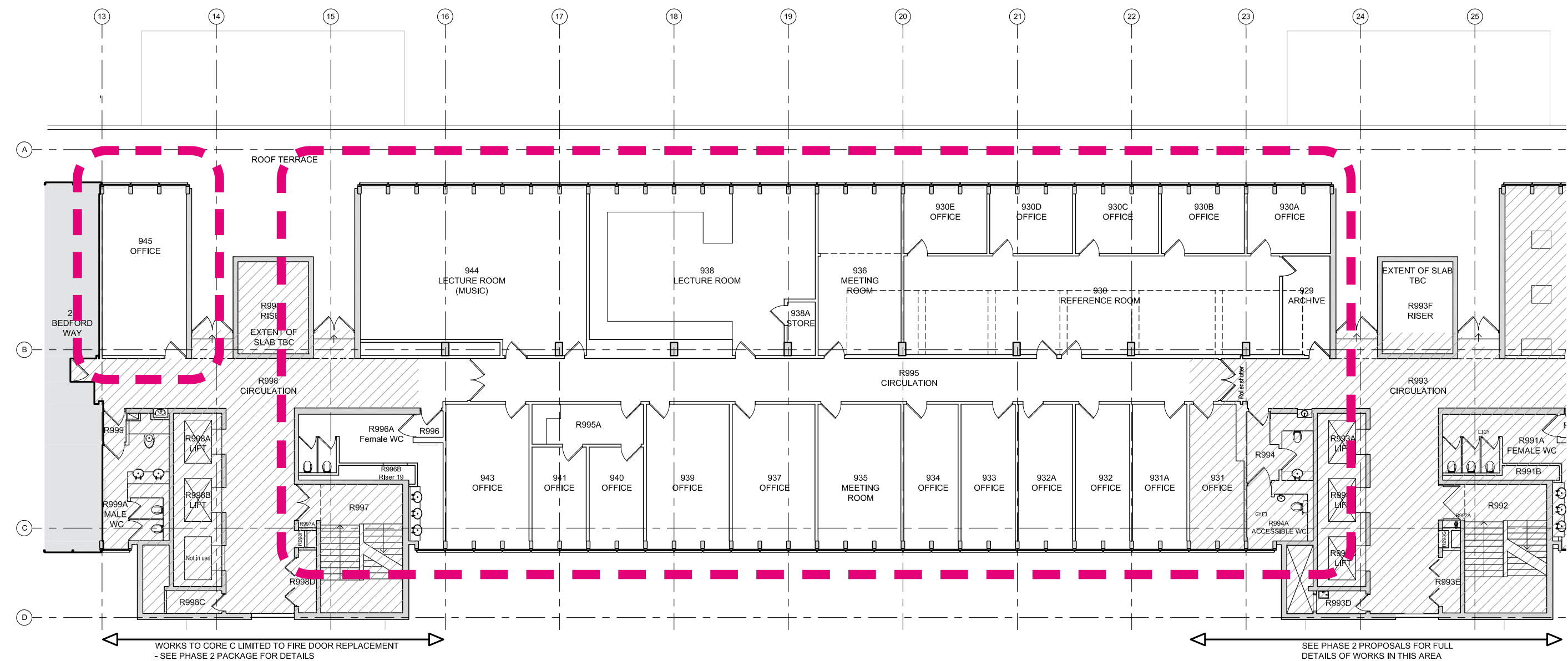

Area of works



4.2.3 Design Proposals - Level 9 Zone C

Photos of the existing condition



Level 9 circulation



Existing teaching rooms



Existing teaching rooms



4.2.3 Design Proposals - Level 9 Zone C

Proposed works:

It is proposed that the whole floor will be stripped out for a full refurbishment as open plan office and cellular office, with the provision of meeting rooms, quiet rooms, kitchenette/tea point and a WC point.

The works will be completed in the look and feel of the approved Phase 1 finish and quality, utilising the 'fin wall' detail with timber edging to main corridor spaces, floor finishes, and exposed soffits with rafts. A new floor finish will be installed throughout the areas being worked in to match that installed in Phase 1. The existing ceiling will be removed, with exposed concrete soffit and acoustic rafts proposed throughout the office space.

It is proposed that the existing corridor that connects Core B and C through the floorplate will still be read in the architecture of the space with the use of

a continuous acoustic raft along the ceiling to define the circulation line within the open-plan layout. This is following the successful principle established in Phase 1, Level 5 Wing Works.

It is proposed that the secondary glazing system utilised in Phase 1 will be installed throughout this area of works as indicated in the drawing package.

Thermal upgrades to the roof (L9 is the top level) and to portions of external wall (insulation lining internally) are also proposed to supplement the secondary glazing system and bring the environmental standards and comforts up to a modern standard.

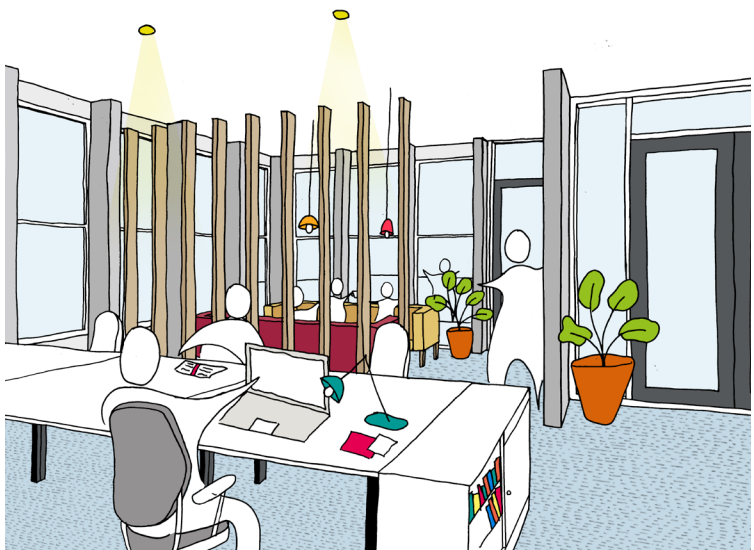

Informal meeting space with access to the external terrace

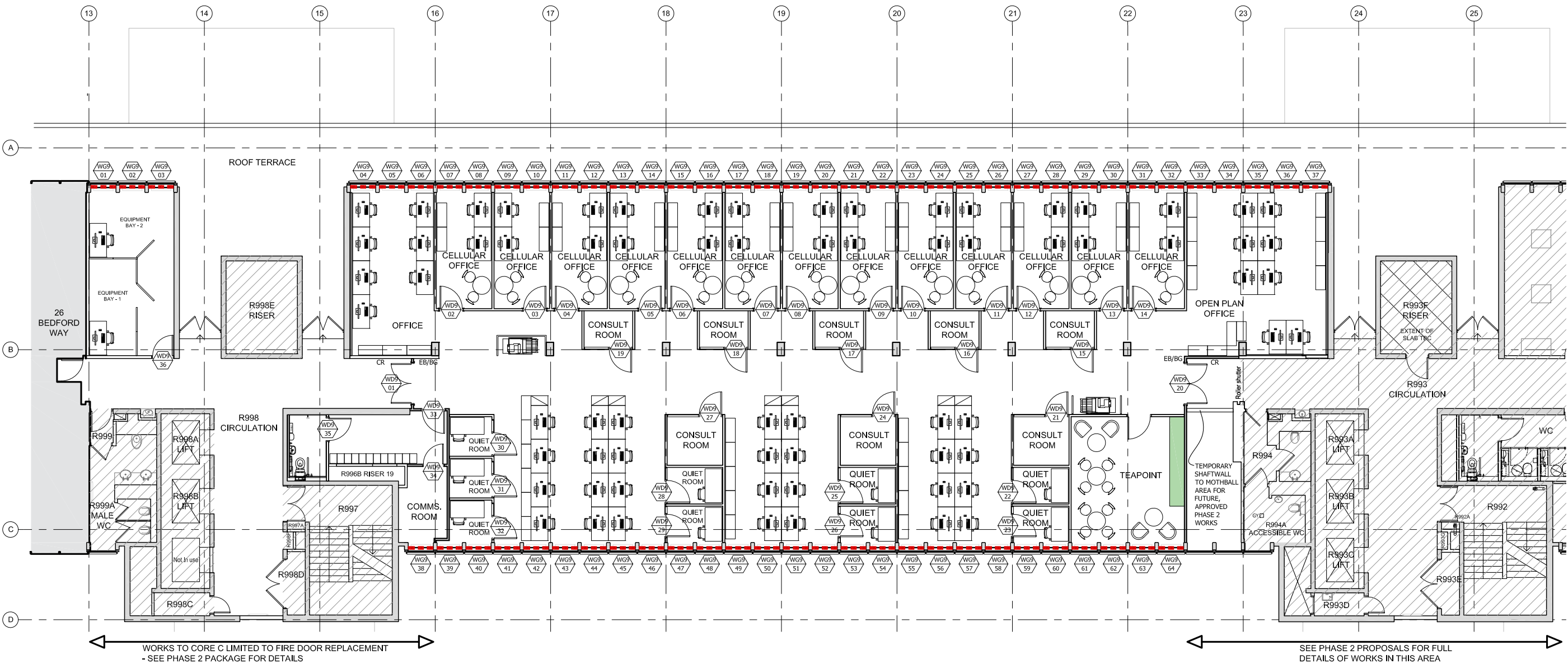

Proposed layout of Level 9 Zone C