

VOID ABOVE EXISTING AND SECONDARY GLAZING TO RECEIVE KINGSPAN KOOLTHERM K106 INSULATION OR SIMILAR APPROVED.

INNER FACES AT JAMBS, HEAD AND CILL BETWEEN EXISTING AND SECONDARY GLAZING TO RECEIVE BRONZE ANNOIDIZED ALUMINIUM LINING SHOWN SHADED TO CONCEAL EXPOSED SUB FRAME. COLOUR TO MATCH PHASE 2 WINDOWS.

INNER FACES AT JAMBS, HEAD AND CILL BETWEEN EXISTING AND SECONDARY GLAZING TO RECEIVE BRONZE ANNOIDIZED ALUMINIUM LINING SHOWN SHADED TO CONCEAL EXPOSED SUB FRAME. COLOUR TO MATCH PHASE 2 WINDOWS.

CILL SUPPORT FRAME TO BE CONSTRUCTED WITH TIMBER FRAME WITH 100mm THICK FOIL FACED ROCKWOOL INSULATION OR SIMILAR APPROVED INFILL WITH DUPONT AIRGUARD VAPOUR CONTROL LAYER FITTED CILL AND BELOW TIMBER FRAME. INNER FACE TO RECEIVE 18mm THICK PLY FIXED TO TIMBER FRAME.

LOCATION WHERE WE HAVE AN EXISTING CONCRETE UPSTAND 50mm THICK FOIL FACE ROCKWOOL INSULATION TO BE FITTED TO INTERNAL FACE OF CLADDING PANEL AND A FURTHER 100mm THICK FOIL FACE ROCKWOOL INSULATION TO BE FITTED TO ALIGN WITH INTERNAL FACE OF UPSTAND.

LAMINATED RADIATOR BACK PANEL FIXED TO PLY LINING FIXING LOCATION TO BE REAR OF RADIATOR.

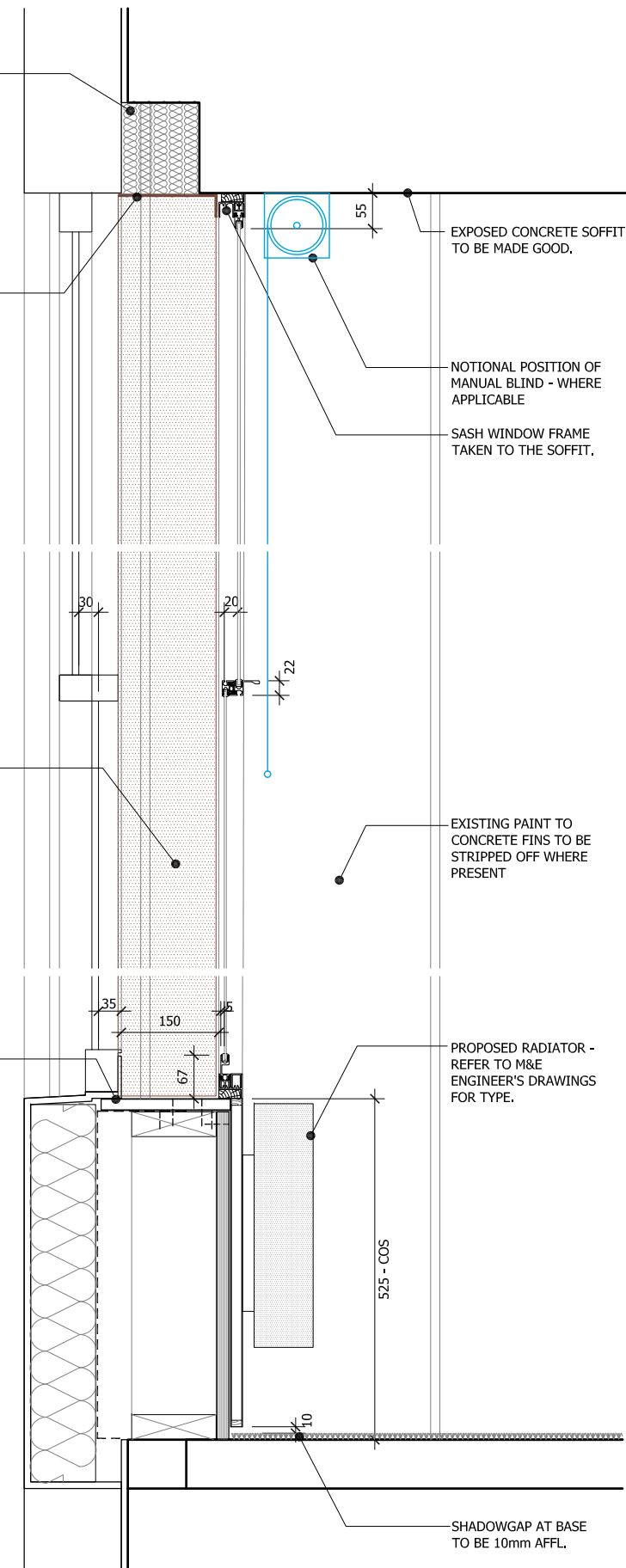

D1 Secondary Glazing and Radiator Casing  
DETAIL SECTION 1:5



1 Secondary Glazing and Radiator Casing  
TYPICAL ELEVATION AND SECTION 1:10

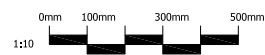

© Architon LLP 2014

This drawing is the property of Architon LLP and must not be divulged to anyone, copied or reproduced, or used for marketing, advertising or promotional purposes without the express written permission of Architon LLP.

All dimensions are to be checked on site and not scaled from this drawing. Contractors must verify all dimensions on site before setting out, commencing work or preparing shop drawings. Any discrepancies on this drawing with other contract documentation to be reported immediately for clarification.

#### Notes

All works - including design, setting-out, detailing, fixtures, fittings and finishes - are to match Phase 1A works, unless agreed otherwise.

Drawing to be read in conjunction with all current and relevant Architon drawings, schedules and specifications.

All works to be fully co-ordinated with M&E / Structural proposals, as appropriate.

All setting-out information to be checked against site dimensions

All works to be in accordance with ALL statutory requirements. Where amended proposals differ from those approved by LA, new approvals to be obtained prior to commencing works.

Fire rated components to be in accordance with over-arching Fire Strategy for the IoE.

Acoustic Rated components to be in accordance with Acoustic Strategy - prepared by BH.

#### PLANNING ISSUE

P3	Planning issue	11.04.2022
P2	Planning issue	07.04.2022
P1	Issued for comment	23.03.2022

Rev	Description	Date
-----	-------------	------



Job title  
University College London  
Institute of Education  
Woburn Square Package  
20 Bedford Way, WC1H 0AL

Drawing title  
Details  
Secondary Glazing & Radiator Casing  
Manually Operated Blindset  
Planning Application WS2

Scale	Date	Drawn
1:10 / 1:5 @A1	Mar 22	MJR



Drawing No  
3147-WS2-0074 P3

ARCHITON LLP  
certified to:  
BS EN ISO 9001  
BS EN ISO 14001  
IIP Accreditation