

© Architon LLP 2014

This drawing is the property of Architon LLP and must not be divulged to anyone, copied or reproduced, or used for marketing, advertising or promotional purposes without the express written permission of Architon LLP.

All dimensions are to be checked on site and not scaled from this drawing. Contractors must verify all dimensions on site before setting out, commencing work or preparing shop drawings. Any discrepancies on this drawing with other contract documentation to be reported immediately for clarification.



Notes

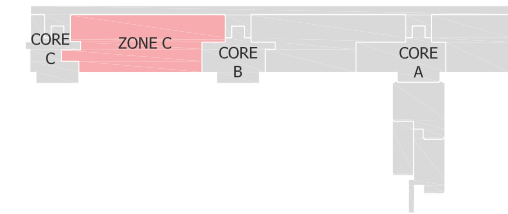

1 LEVEL 9 - KEY PLAN FOR REFERENCE NTS

ENSURE NO STRIP OUT, DEMOLITION OR BUILDING WORKS ARE UNDERTAKEN WITHOUT THE REQUIRED LISTED BUILDING AND PLANNING CONSENTS FROM THE LOCAL AUTHORITY AND ENGLISH HERITAGE.

DRAWINGS ARE BASED ON INFORMATION PROVIDED BY UCL.

- DRAWINGS TO BE READ IN CONJUNCTION WITH:-
- ARCHITECTURAL DRAWINGS, SCHEDULES AND SPECIFICATIONS.
 - STRUCTURAL DRAWINGS AND SPECIFICATIONS.
 - M&E DRAWINGS AND SPECIFICATIONS.
 - ACOUSTIC REPORTS.
 - FIRE STRATEGY.

ALL WORKS TO BE FULLY CO-ORDINATED WITH MEP / STRUCTURAL PROPOSALS, AS APPROPRIATE.

ALL SETTING-OUT INFORMATION TO BE CHECKED AGAINST SITE DIMENSIONS

ALL WORKS TO BE IN ACCORDANCE WITH ALL STATUTORY REQUIREMENTS. WHERE AMENDED PROPOSALS DIFFER FROM THOSE APPROVED BY LA, NEW APPROVALS TO BE OBTAINED PRIOR TO COMMENCING WORKS.

FIRE RATED COMPONENTS TO BE IN ACCORDANCE WITH OVER-ARCHING FIRE STRATEGY FOR THE IOE.

ACOUSTIC RATED COMPONENTS TO BE IN ACCORDANCE WITH ACOUSTIC STRATEGY - PREPARED BY B.H.

PLANNING ISSUE

P2	Planning Issue	07.04.2022
P1	Issued for comment	23.03.2022
Rev	Description	Date

Client
 overbury
 Job title
 University College London
 Institute of Education
 Woburn Square Package
 20 Bedford Way, WC1H 0AL

Drawing title
 Level 9 - Zone C
 Demolition Plan
 Planning Application WS2

Scale	Date	Drawn
1:100 @A1	Mar 22	MJR

ARCHITON LLP
 CHARTERED ARCHITECTS · DESIGN · PLANNING CONSULTANTS · DEVELOPMENT · BUILDING COST MANAGEMENT
 UPPER DECK 17A WEST STREET EPSOM KT18 7RL Email: info@architon.com TEL: 01372 745600

Drawing No
 3147-WS2-0902 P2
 ARCHITON LLP certified to:
 BS EN ISO 9001
 BS EN ISO 14001
 IIP Accreditation

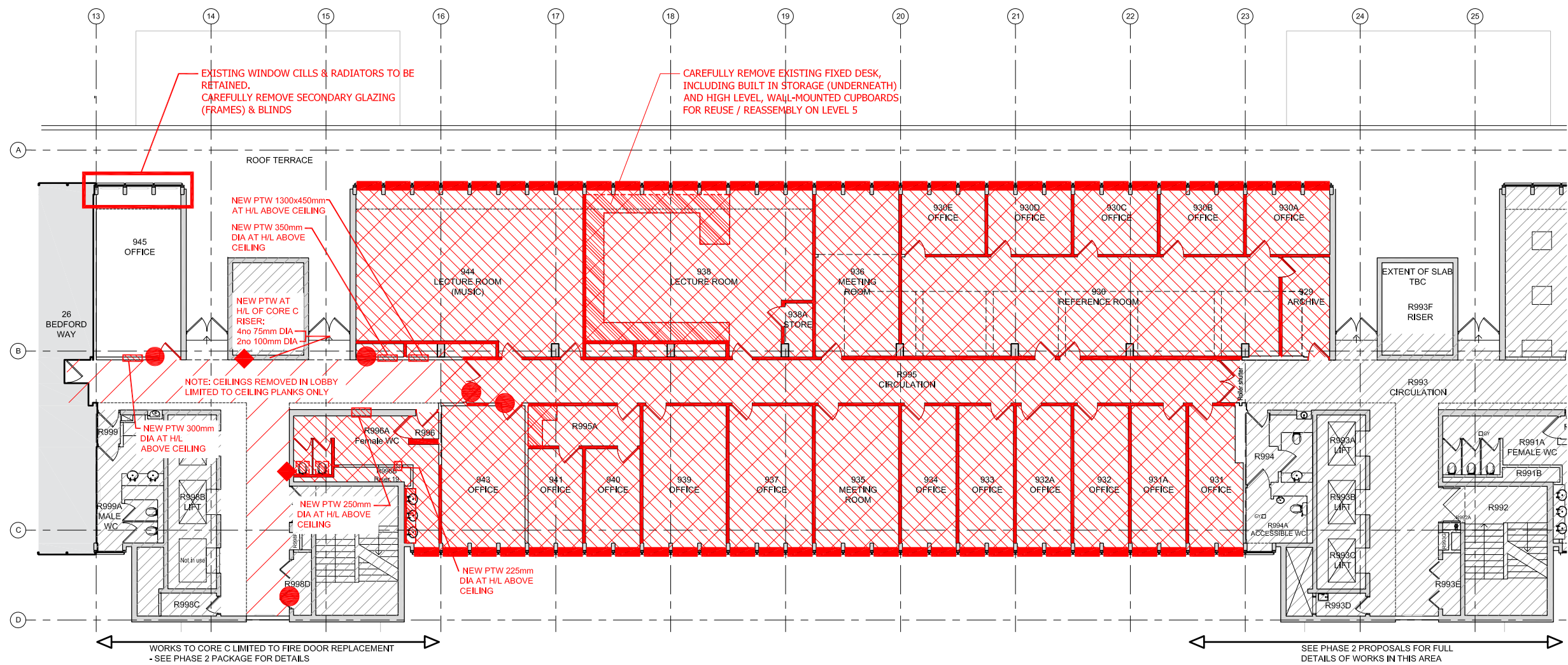

2 LEVEL 9 - DEMOLITION PLAN 1:100

LEGEND

- AREA OUTSIDE SCOPE OF WORKS FOR WOBURN SQUARE PACKAGE, EXCEPT FOR MAKING GOOD WHERE DISTURBED
- CAREFULLY REMOVE NON LOAD-BEARING WALLS, DOORS, FRAMES, WALL LININGS, ALL ASSOCIATED FIXINGS, ETC. TO UNDERSIDE OF STRUCTURAL SLAB / SOFFIT / BEAM / COLUMN. MAKE GOOD ALL ABUTMENTS AND JUNCTIONS INCLUDING AT FLOOR, WALL, SOFFIT AND CEILING, AS APPROPRIATE.
- CAREFULLY REMOVE ALL SUSPENDED CEILINGS. MAKE GOOD ALL ABUTMENTS AS APPROPRIATE.
- CAREFULLY REMOVE ALL FLOOR FINISHES TO INCLUDE ALL SKIRTINGS, UNDERLAY. MAKE GOOD ALL ABUTMENTS AS APPROPRIATE. ALLOW FOR RETAINING CARPET TILES FOR REINSTATING / MAKING GOOD, AS APPROPRIATE.
- CAREFULLY REMOVE COUNTERTOPS BASE AND WALL UNITS, SHUTTERS, APPLIANCES, ETC. MAKE GOOD ALL ABUTMENTS, AS APPROPRIATE.
- CAREFULLY REMOVE ALL WINDOW CILLS, RADIATORS, BACKBOARDS, SECONDARY GLAZING, BLINDS, CURTAINS & ANY MISCELLANEOUS.
- CAREFULLY FORM NEW OPENING IN EXISTING SLAB FOR SERVICES PENETRATIONS, REFER TO M&E CONSULTANTS DRAWINGS FOR SIZES. REFER TO STRUCTURAL ENGINEERS FOR DETAILS OF OPENING WORKS
- CAREFULLY FORM NEW OPENING IN WALL
- PTW AT H/L ABOVE CEILING FOR NEW CONTAINMENT AS L&P PROPOSALS.
- PTW AT H/L ABOVE CEILINGS FOR NEW WATER SERVICES AS L&P PROPOSALS.
- PTW** PENETRATION THROUGH WALL
- PTS** PENETRATION THROUGH SLAB

SERVICES STRIP-OUT AND DEMOLITIONS

CAREFULLY REMOVE ALL REDUNDANT SERVICES TO MEP STRIP-OUT SCOPE. REFER TO MEP CONSULTANT PACKAGE FOR ALL DEMOLITIONS REQUIRED FOR NEW SERVICES.

FOR CAPPING / TERMINATION DETAILS TO ANY SERVICES REMOVED OR RELOCATED AS A RESULT OF STRIP-OUT WORKS, REFER TO MEP CONSULTANTS DRAWINGS / SPECIFICATION

GENERAL NOTES

- ALL FF&E & FURNITURE, AND ALL WALL MOUNTED ITEMS ARE TO BE CAREFULLY REMOVED AND DISPOSED OF IN ACCORDANCE WITH UCL REQUIREMENTS
- ALL STRIP-OUT, DEMOLITION AND REMOVAL OF ASBESTOS-CONTAINING MATERIALS ARE TO BE CAREFULLY UNDERTAKEN AND CERTIFIED PRIOR TO ALL OTHER STRIP-OUT AND DEMOLITION WORKS.**
- ALLOW FOR MAKING GOOD ALL WALLS, FLOORS AND SURFACES DAMAGED DURING STRIP-OUT WORKS (INCLUDING THOSE ASSOCIATED WITH ALL MEP & STRUCTURAL WORKS). INCLUDE FOR INFILLING, FIRE-STOPPING, CAPPING, FINISHING ANY PENETRATIONS IN WALLS AND SLABS, AS APPROPRIATE.
- DEMOLITIONS CONTRACTOR TO PROTECT ALL LISTED FEATURES DURING STRIP-OUT.
- CONTRACTOR / DEMOLITIONS CONTRACTOR TO PROVIDE DUST PROOF HOARDING AROUND SITE OF WORKS AS APPROPRIATE
- DEMOLITION CONTRACTOR TO ALLOW FOR SCRABBLING / LEVELING / LINING OF SURFACES, AS APPROPRIATE FOLLOWING STRIP-OUT AND DEMOLITION WORKS.
- DEMOLITIONS CONTRACTOR TO CONSULT STRUCTURAL ENGINEER PRIOR TO UNDERTAKING ANY DEMOLITIONS WORKS TO (INCLUDING FORMING ANY PENETRATIONS THROUGH) EXISTING LOAD BEARING ELEMENTS.
- ALL WORKS - INCLUDING DESIGN, SETTING-OUT, DETAILING, FIXTURES, FITTINGS AND FINISHES - ARE TO MATCH PHASE 1A & 1B WORKS, UNLESS AGREED OTHERWISE.

