

© Architon LLP 2014

This drawing is the property of Architon LLP and must not be divulged to anyone, copied or reproduced, or used for marketing, advertising or promotional purposes without the express written permission of Architon LLP.

All dimensions are to be checked on site and not scaled from this drawing. Contractors must verify all dimensions on site before setting out, commencing work or preparing shop drawings. Any discrepancies on this drawing with other contract documentation to be reported immediately for clarification.

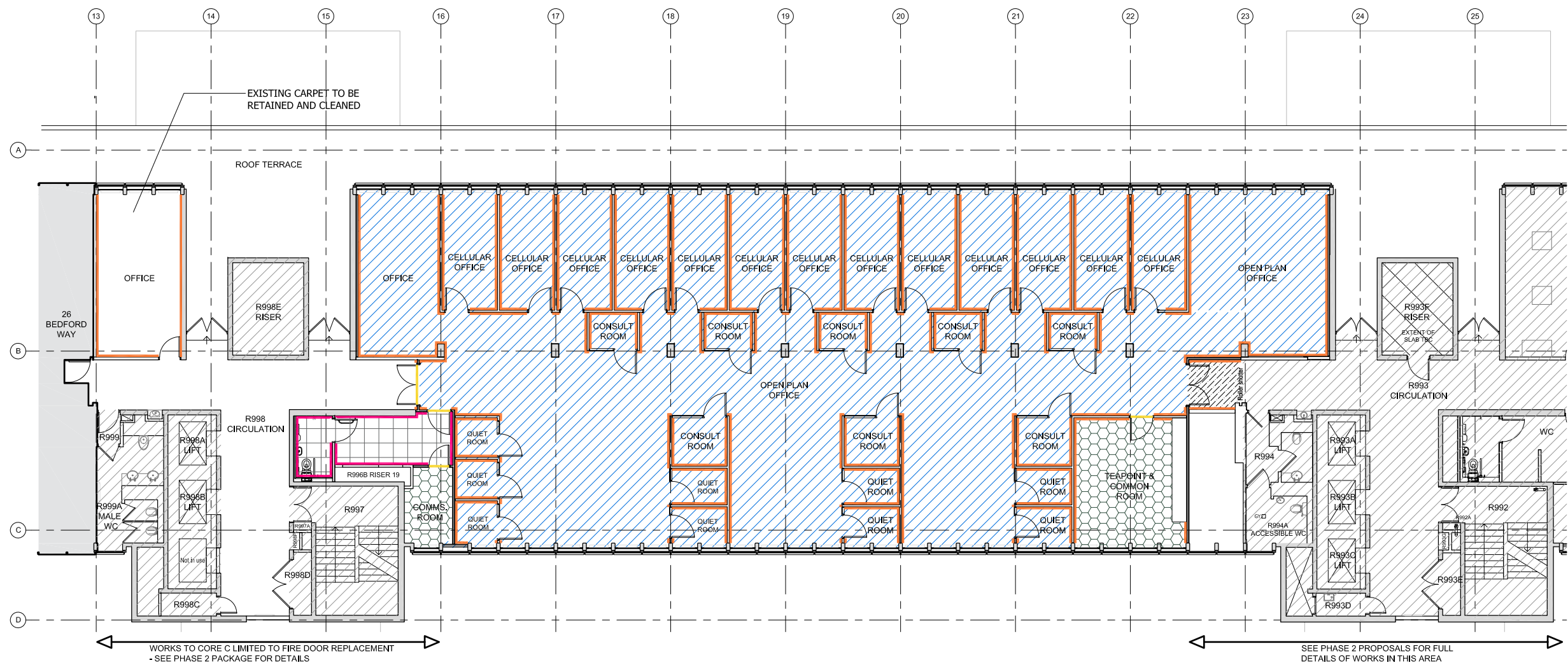
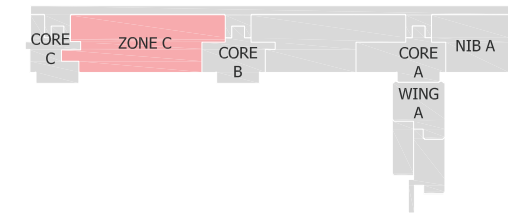

1 LEVEL 9 - KEY PLAN FOR REFERENCE NTS

**ENSURE NO STRIP OUT, DEMOLITION OR BUILDING WORKS ARE UNDERTAKEN WITHOUT THE REQUIRED LISTED BUILDING AND PLANNING CONSENTS FROM THE LOCAL AUTHORITY AND ENGLISH HERITAGE.**

DRAWINGS ARE BASED ON INFORMATION PROVIDED BY UCL.

- DRAWINGS TO BE READ IN CONJUNCTION WITH:-
- ARCHITECTURAL DRAWINGS, SCHEDULES AND SPECIFICATIONS.
  - STRUCTURAL DRAWINGS AND SPECIFICATIONS.
  - M&E DRAWINGS AND SPECIFICATIONS.
  - ACOUSTIC REPORTS.
  - FIRE STRATEGY.

ALL WORKS TO BE FULLY CO-ORDINATED WITH MEP / STRUCTURAL PROPOSALS, AS APPROPRIATE.

ALL SETTING-OUT INFORMATION TO BE CHECKED AGAINST SITE DIMENSIONS

ALL WORKS TO BE IN ACCORDANCE WITH ALL STATUTORY REQUIREMENTS. WHERE AMENDED PROPOSALS DIFFER FROM THOSE APPROVED BY LA, NEW APPROVALS TO BE OBTAINED PRIOR TO COMMENCING WORKS.

FIRE RATED COMPONENTS TO BE IN ACCORDANCE WITH OVER-ARCHING FIRE STRATEGY FOR THE IOE.

ACOUSTIC RATED COMPONENTS TO BE IN ACCORDANCE WITH ACOUSTIC STRATEGY - PREPARED BY B.H.

**PLANNING ISSUE**

P2	Planning Issue	07.04.2022
P1	Issued for comment	23.03.2022
Rev	Description	Date

Client  
 overbury  
 Job title  
 University College London  
 Institute of Education  
 Woburn Square Package  
 20 Bedford Way, WC1H 0AL

Drawing title  
 Level 9 - Zone C  
 Floor Finishes  
 Planning Application WS2

Scale	Date	Drawn
1:100 @ A1	Mar 22	MJR

**ARCHITON LLP**  
 CHARTERED ARCHITECTS · DESIGN · PLANNING CONSULTANTS · DEVELOPMENT · BUILDING COST MANAGEMENT  
 UPPER DECK 17A WEST STREET EPSOM KT18 7RL TEL:01372 745600 Email:info@architon.com

Drawing No 3147-WS2-0906 P2	ARCHITON LLP certified to: BS EN ISO 9001 BS EN ISO 14001 IIP Accreditation
--------------------------------	--

2 LEVEL 9 PLAN - AS PROPOSED 1:100

- LEGEND**
- AREA OUTSIDE SCOPE OF WORKS FOR WOBURN SQUARE PACKAGE, EXCEPT FOR MAKING GOOD WHERE DISTURBED
  - SF-05 - CARPET - CORRIDOR MILLIKEN, ARCTIC SURVEY - ISOTHERM IS79-133 - BEAUFORT. LRV 3,5
  - SF-06 - ANTI-STATIC FLOORING - COMMS ROOM / TEA-POINT / RAMP NORAPLAN. SENTICA ED - 6520 - LRV - 36.74
  - SF-08 - CARPET - TEACHING SPACES MILLIKEN, CULTURE CANVAS STREET ART - SAT152-79 FLICKS. LRV 11
  - SF-13 - 600x600mm NON-SLIP CERAMIC FLOOR TILE NBS SPEC - TBC
  - RETAINED TILES RE-LAID TO MAKE GOOD FOLLOWING DEMOLITIONS / NEW PARTITION INSTALLATIONS
  - SKIRTING SK-01 - TIMBER
  - SKIRTING SK-03 - 100x600mm CERAMIC SKIRTING TILE TO MATCH FLOOR
  - FLOOR TRIM / THRESHOLD STRIP

**GENERAL REQUIREMENTS:**

LEVELING SCREED TO TAKE UP DIFFERENCES / LEVEL SUBSTRATE AS APPROPRIATE INCLUDING WHERE EXISTING WALLS REMOVED AS PART OF DEMOLITION & STRIP-OUT.

FOR DETAILS OF ALL FINISHES INCLUDING THOSE AS REFERENCED, REFER TO FINISHES SCHEDULE

