

© Architon LLP 2014

This drawing is the property of Architon LLP and must not be divulged to anyone, copied or reproduced, or used for marketing, advertising or promotional purposes without the express written permission of Architon LLP.

All dimensions are to be checked on site and not scaled from this drawing. Contractors must verify all dimensions on site before setting out, commencing work or preparing shop drawings. Any discrepancies on this drawing with other contract documentation to be reported immediately for clarification.

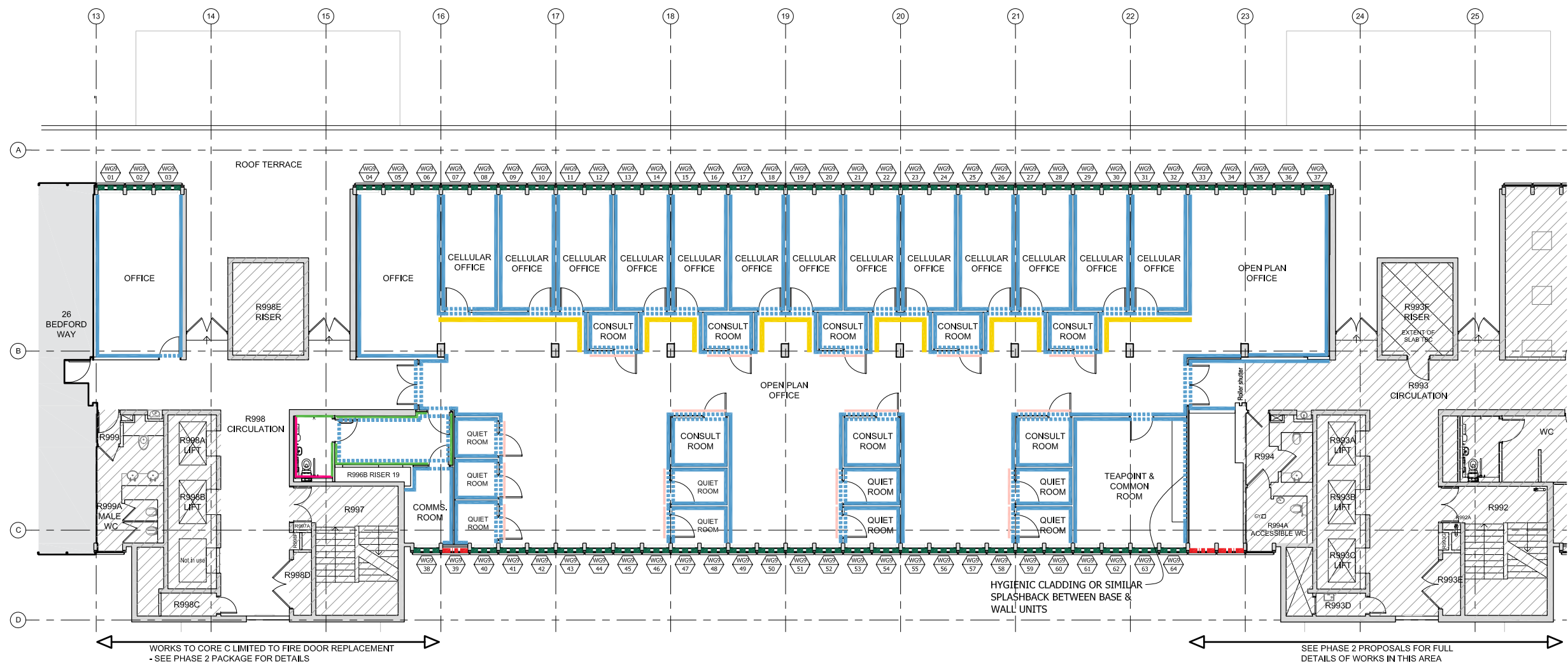
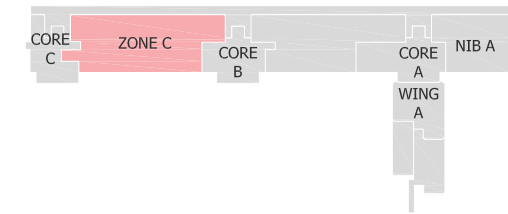

1 LEVEL 9 - KEY PLAN FOR REFERENCE NTS

ENSURE NO STRIP OUT, DEMOLITION OR BUILDING WORKS ARE UNDERTAKEN WITHOUT THE REQUIRED LISTED BUILDING AND PLANNING CONSENTS FROM THE LOCAL AUTHORITY AND ENGLISH HERITAGE.

DRAWINGS ARE BASED ON INFORMATION PROVIDED BY UCL.

- DRAWINGS TO BE READ IN CONJUNCTION WITH:-
- ARCHITECTURAL DRAWINGS, SCHEDULES AND SPECIFICATIONS.
 - STRUCTURAL DRAWINGS AND SPECIFICATIONS.
 - M&E DRAWINGS AND SPECIFICATIONS.
 - ACOUSTIC REPORTS.
 - FIRE STRATEGY.

ALL WORKS TO BE FULLY CO-ORDINATED WITH MEP / STRUCTURAL PROPOSALS, AS APPROPRIATE.

ALL SETTING-OUT INFORMATION TO BE CHECKED AGAINST SITE DIMENSIONS

ALL WORKS TO BE IN ACCORDANCE WITH ALL STATUTORY REQUIREMENTS. WHERE AMENDED PROPOSALS DIFFER FROM THOSE APPROVED BY LA, NEW APPROVALS TO BE OBTAINED PRIOR TO COMMENCING WORKS.

FIRE RATED COMPONENTS TO BE IN ACCORDANCE WITH OVER-ARCHING FIRE STRATEGY FOR THE IOE.

ACOUSTIC RATED COMPONENTS TO BE IN ACCORDANCE WITH ACOUSTIC STRATEGY - PREPARED BY B.H.

PLANNING ISSUE

P2	Planning Issue	07.04.2022
P1	Issued for comment	23.03.2022
Rev	Description	Date

Client

 Job title
 University College London
 Institute of Education
 Woburn Square Package
 20 Bedford Way, WC1H 0AL

Drawing title
 Level 9 - Zone C
 Wall & Window Finishes
 Planning Application WS2

Scale	Date	Drawn
1:100 @ A1	Mar 22	MJR

ARCHITON LLP
 CHARTERED ARCHITECTS · DESIGN · PLANNING CONSULTANTS · DEVELOPMENT · BUILDING COST MANAGEMENT
 UPPER DECK 17A WEST STREET EPSOM KT18 7RL Email: info@architon.com
 TEL: 01372 745600

Drawing No
 3147-WS2-W908 P2
 ARCHITON LLP certified to:
 BS EN ISO 9001
 BS EN ISO 14001
 IIP Accreditation

2 LEVEL 9 PLAN - AS PROPOSED 1:100

- LEGEND**
- AREA OUTSIDE SCOPE OF WORKS FOR WOBURN SQUARE PACKAGE, EXCEPT FOR MAKING GOOD WHERE DISTURBED
 - WINDOW TREATMENT - GLARE BLINDS (MANUAL)
 - WINDOW REFERENCE NUMBER
 - WINDOW TREATMENT - OPAQUE WINDOW FILM
 - WINDOW TREATMENT - MANIFESTATION
 - WALL FINISH - WHITE MATT EMULSION PAINT - HIGH LEVEL ABOVE GLAZING / DOOR / OTHER
 - HYGIENIC CLADDING IN THREE STANDARD COLOURS SUBJECT TO FINAL DESIGN - COLOUR TBC -
 - IPS PANELING - REFER TO JOINERY PACKAGE/ TOILET DETAIL DRAWING FOR DETAIL
 - BESPOKE JOINERY / ACOUSTIC CLADDING / LINING PANEL

CONTRACTOR TO REVIEW ALL WINDOWS AND PREPARE A SCHEDULE OF REMEDIAL WORKS REQUIRED TO MAKE EACH FULLY OPERATIONAL. THIS SHOULD INCLUDE REPLACEMENT OF HANDLES / SEALS/ RESTRICTORS /ETC AS MAY BE REQUIRED AS WELL AS GENERALLY CLEAN AND LUBRICATION.

ALL HIGH LEVEL PLASTERBOARD BULKHEADS TO BE FINISHED TO MATCH ADJACENT PARTITIONS / LININGS.

