

AS ADVISED BY THE FIRE ENGINEER (BURO HAPPOLD) THIS BUILDING IS DEEMED NOT A 'RELEVANT BUILDING' AND DOES NOT NEED TO MEET NON-COMBUSTIBLE REQUIREMENTS OF APPROVED DOCUMENT PART B VOLUME 2 : 2019.

FIXING NOTE(S):

- BRASS / STAINLESS STEEL CLADDING:**
- 1a. Straight Facade Standing Seam clips fixed into PLY at seam c/c and along seams at 200mm c/c max, 150mm c/c from edges with 2 No. CWS-SS 5.0 x 25.
 - 1b. 18mm PLY Deck fixed into Aluminium Rail at 450mm c/c with GDS3-SS-CSK 4.8 x 45.
 - 2a. Curved Facade Standing Seam clips fixed into and isolated from Galv Flatplate at seam c/c and along seams at 200mm c/c max, 150mm c/c from edges with 2 No. DF3-SS-CF 4.8 x 16.
 - 2b. Galv Flatplate fixed into Galv Rails at rail c/c and along rail at 300mm c/c with R-SS 4.8 x 10 Multigrip Stainless Steel Rivets.
 - 2c. Galv Rails fixed into and isolated from Aluminium Rail at each junction with 2 No. R-SS 4.8 x 10 Multigrip Stainless Steel Rivets.
 3. Aluminium Rail fixed into Helping Hand Bracket with 2 No. SDA5 5.5 x 22, fixings into holes for fixed brackets, fixings into slots for sliding brackets.
 - 4a. Helping Hand Bracket on Isolator Pads fixed into steel stud wall with 2 No. SS-LS 5.5 x 50 S16.
 - 4b. Helping Hand Bracket on Isolator Pads fixed into concrete with Fischer SXR 10 x 80 A4.
 5. Rockwool Rainscreen Duo Slab Insulation fixed into substrate with 3 No. fixings per square meter; 1 No. Metal Washer & Fixing and 2 No. Polypropylene Tube & Fixing.

- BRASS ROOFING:**
1. Standing Seam clips fixed into PLY at seam c/c with 2 No. CWS-SS 5.0 x 25. Up to 430mm panel- clips along seams at 200mm c/c max, 600mm panel- clips along seams at 150mm c/c max.
 2. 18mm PLY Deck fixed into C16 Timber Counter Battens at 200mm c/c with CWS 5.0 x 50.
 3. 50x50mm C16 Timber Counter battens fixed into C24 Timber Rafter at 400mm c/c with CWS 5.0 x 100.
 4. 250x50mm C24 Timber Rafter fixed to Primary Steels to MBP SE Design.

- BRASS SOFFIT:**
1. Standing Seam clips fixed into PLY at seam c/c and along seams at 200mm c/c max, 150mm c/c from edges with 2 No. CWS-SS 5.0 x 25.
 2. 18mm PLY Deck fixed into Aluminium Rail at 450mm c/c with GDS3-SS-CSK 4.8 x 45.
 3. NS1 Aluminium Rail fixed into drop rail with 2 No. JT3 6.3 x 25.
 4. NS1 Soffit Drop Rail fixed to hanger bracket with 2 No. JT3 6.3 x 25.
 5. NS1 Soffit Hanger Bracket fixed into concrete with 2 No. SFS-Multi-Monit-S 7.5 x 75.
 6. Rockwool Soffit Slab Insulation fixed into substrate with Egot DDT70 Metal Washer & Egot DDS Fixing, 6 No. fixings per slab.

- Cavity Barrier locations and details to be reviewed and approved by Building Control and Fire Specialist. AMR are not responsible for the fire strategy of this project.
- Higher performing Cavity Barriers take priority and run continuous, lower performing Cavity Barriers abut tightly. Cavity Barriers to be finished to manufacturers recommendations.
- Isolation required between ALL dissimilar metals.
- All Galv Angle dimensions indicative only, to confirm on site.
- Details are typical representations, pitches and dimensions are to be adapted to suit various site conditions. All levels to be confirmed on site.
- Bauder systems shown indicatively, membrane build-up thickness can vary up to 4x single layer thickness where required, true overlap locations to be determined on site.

P01 17.12.21 Initial Issue TM RS

REV	DATE	DESCRIPTION	DR	CH
		Based on Client's Drawing:		Rev:
		TP2-BMJ-ZZ-XX-DT-A-2145		P04

Client: 8BUILD LIMITED

AMR
All Metal Roofing Limited
Unit 1 Meridian Business Park
Fleming Road
Waltham Abbey
EN9 3BZ
Tel: 020 8498 0789
e: info@allmetalroofing.co.uk | www.allmetalroofing.co.uk

Project Name: LSOH&TM (TAVISTOCK PLACE)

Drawing Title:
**FLAT ROOF DETAILS
PAVING AREA LEVEL 03 TYPICAL UPSTAND
JUNCTION TO CLADDING BASE**

Purpose of Issue: FOR COMMENT / APPROVAL Status: NS

Drawn By: TM Drawing Issue Size: A3 Scale: 1:4

AMR	4901	(400)	208	P01
-----	------	-------	-----	-----

UNDER NO CIRCUMSTANCES SHOULD DIMENSIONS BE SCALED FROM THIS DRAWING "IF IN DOUBT ASK".

Drawing Number: AMR 4901 (400) 208 P01

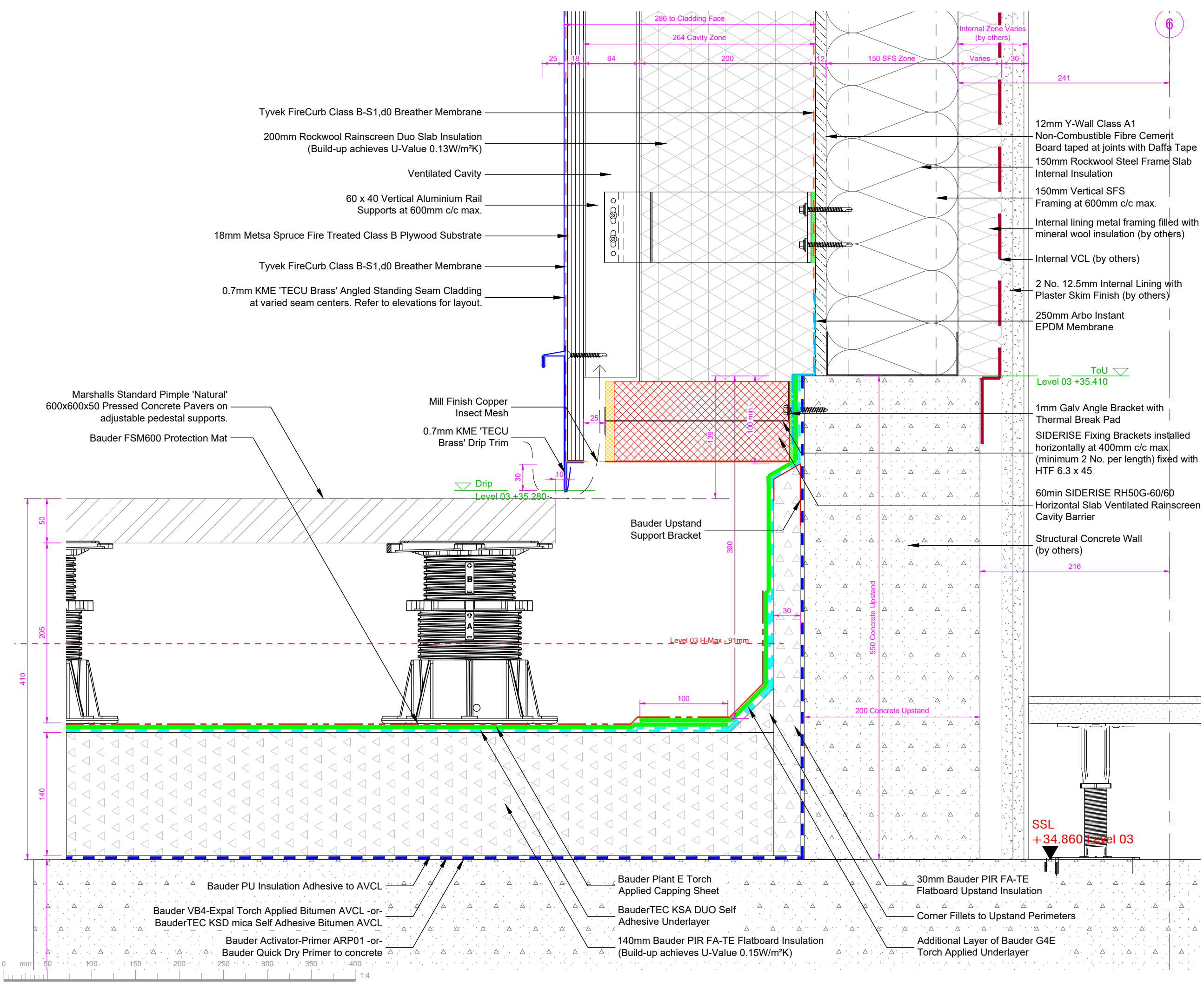

AMR DRAWINGS ARE PRODUCED TO EMPHASISE AMR WORKS ONLY USING ARCHITECT'S DRAWINGS PROVIDED AT THE TIME. ARCHITECT/CONTRACTOR HAVE RESPONSIBILITY FOR OTHER SUB-CONTRACTOR COMPONENTS/INTERFACES AND COORDINATION. AMR WILL NOT AMEND/ADD/SUBTRACT OR IN ANYWAY ALTER OTHER COMPONENTS THAT ARE NOT IN OUR PACKAGE. AMR CAN PROVIDE DWGS IF NEEDED TO ALLOW THESE COMPONENTS TO BE UPDATED/INCLUDED/COORDINATED BY THE RESPECTED PARTY. AMR UNDERSTANDS THIS MAY BE A CDP PROJECT HOWEVER WE WILL DESIGN/DRAW WHAT FALLS WITHIN OUR EXPERTISE AND WOULD EXPECT TO RECEIVE COORDINATED DRAWINGS TO ALLOW US DO SO.