

Verify all dimensions on site before commencing any work or preparing the drawings.  
 All materials, components and workmanship are to comply with all the relevant British Standards, Codes of Practice, and appropriate manufacturer recommendations that from time to time shall apply.  
 For all specialist work, see relevant drawings.  
 This drawing and design are copyright of PELLINGS LLP

PLAN AS EXISTING

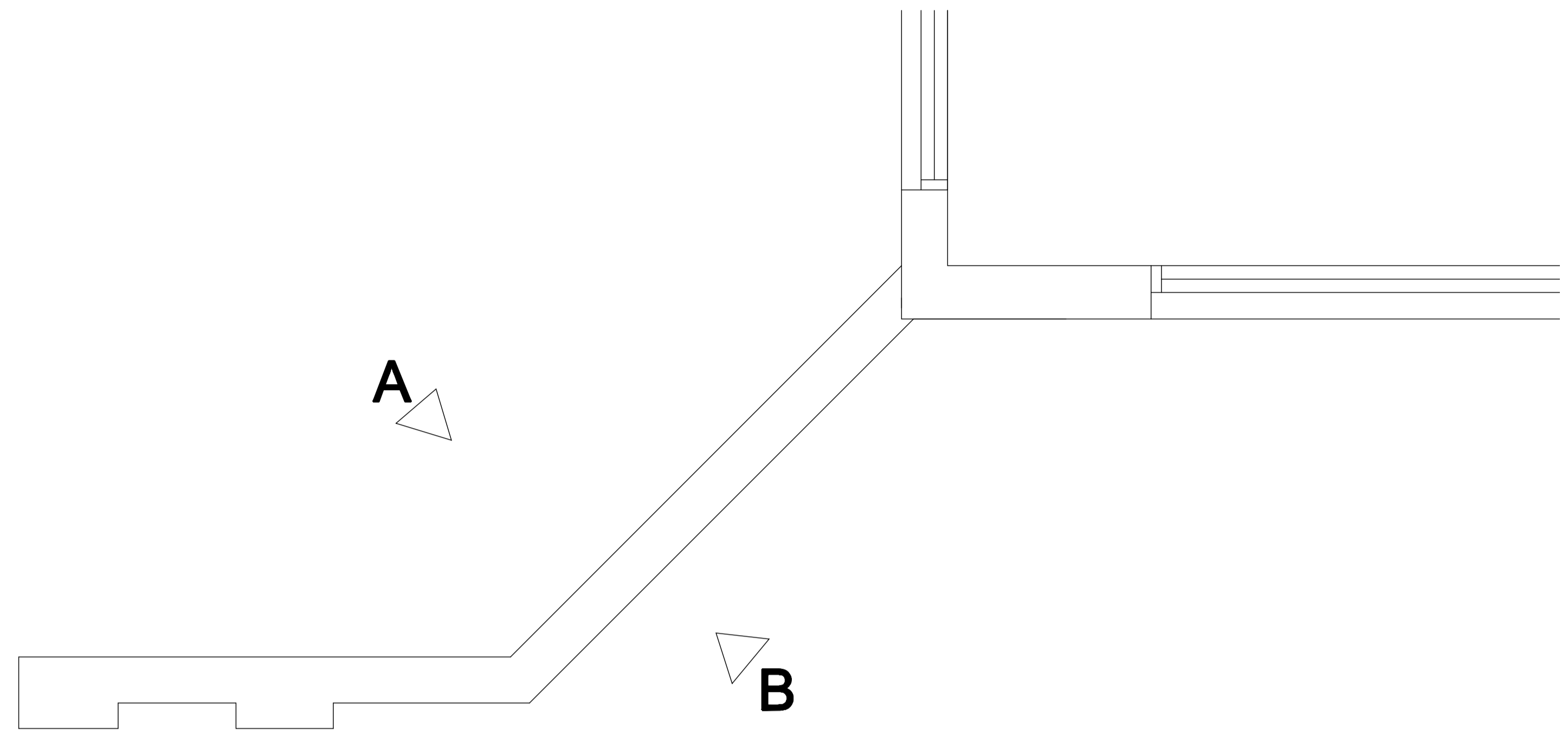

SOUTH WEST ELEVATION AS EXISTING  
A

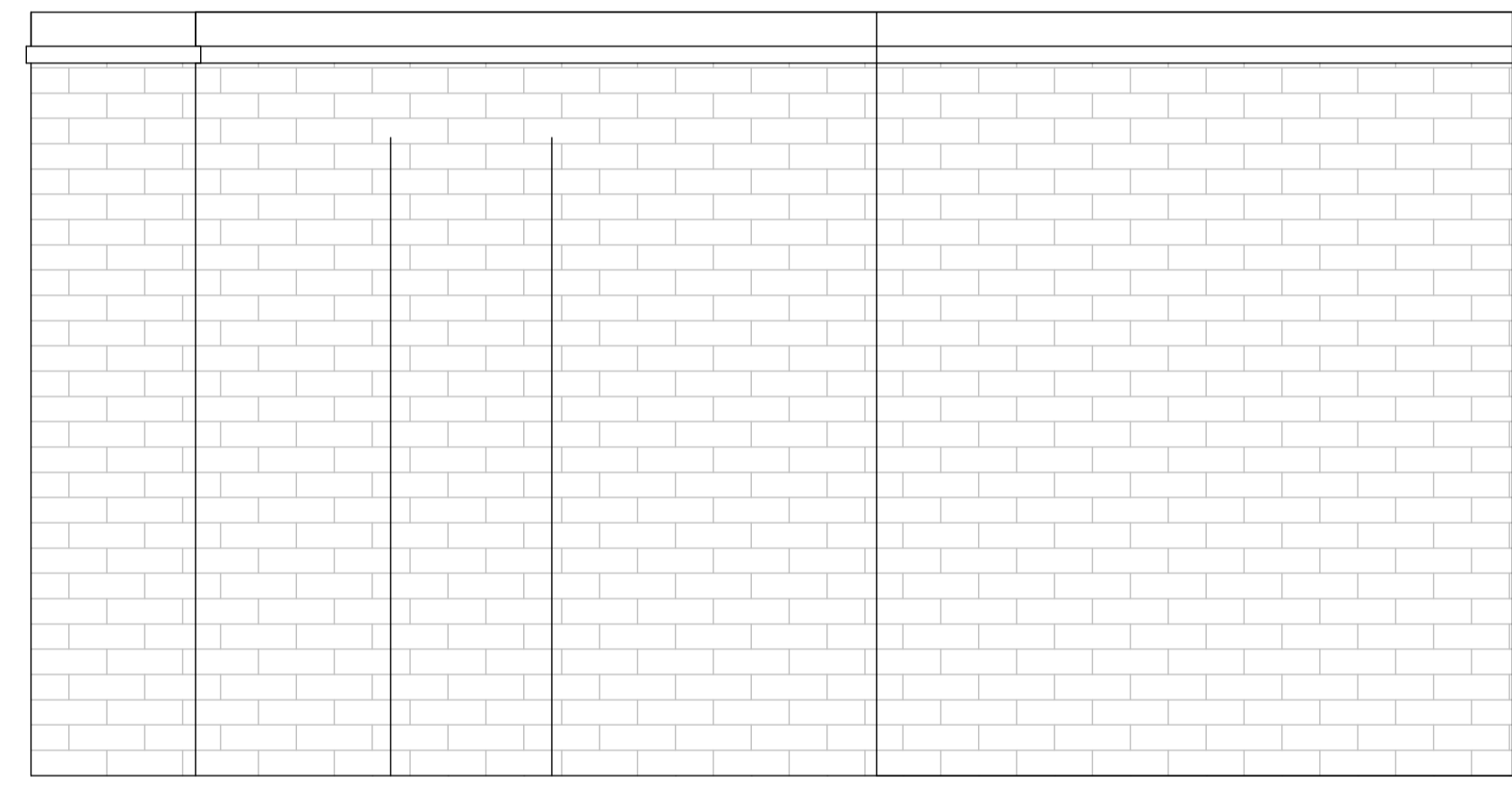

NORTH EAST ELEVATION AS EXISTING  
B

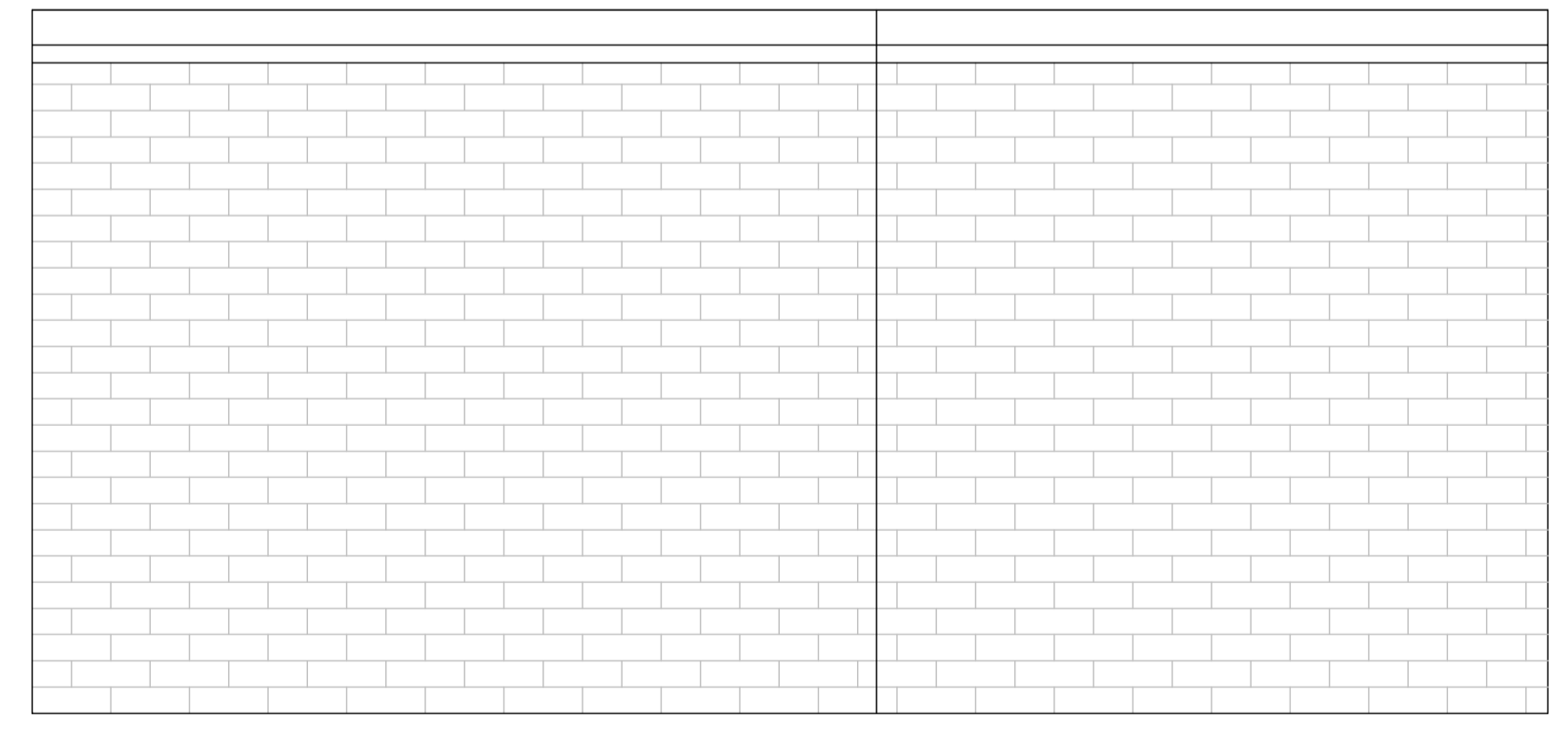

Rev	Date	Description	Name



Pellings LLP  
 Northde House Mount Pleasant Barnet EN4 9EB  
 t 020 8441 8000 f 020 8441 4916 e barnet@pellings.co.uk  
 www.pellings.co.uk  
 Architecture & Planning • Building Surveying • Project Management •  
 Cost Consultancy • CDM Co-ordination

CLIENT  
 LONDON BOROUGH OF CAMDEN

PROJECT  
 Argyle Primary School  
 Tonbridge Street,  
 London  
 WC1H 9EG

TITLE  
 PLAN & ELEVATIONS  
 AS EXISTING  
 WALL

DATE 01/04/2022 SCALE 1:50 DRAWN RH

DRAWING No.  
 252 | 0800 | 201 |

