

PLAN AS PROPOSED

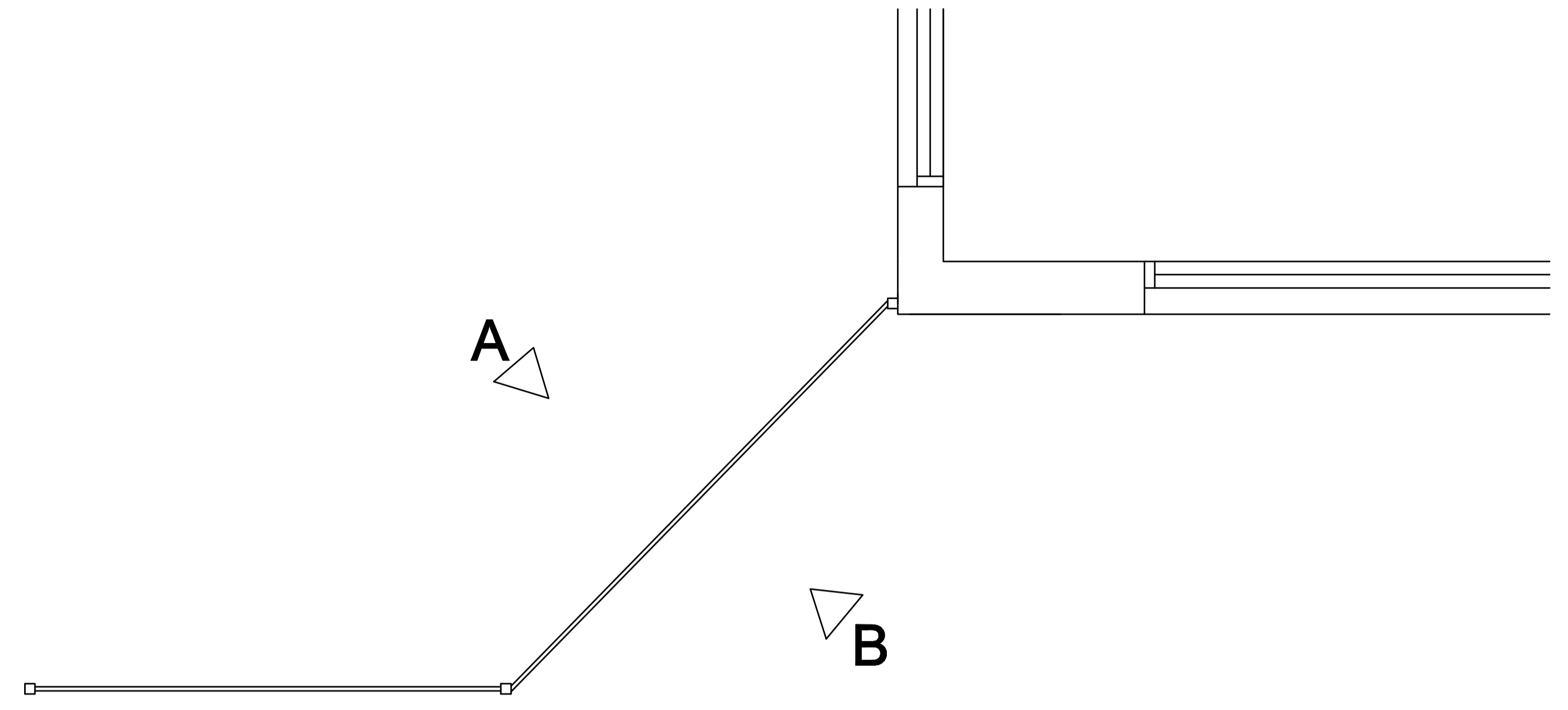

SOUTH WEST ELEVATION  
AS PROPOSED  
A

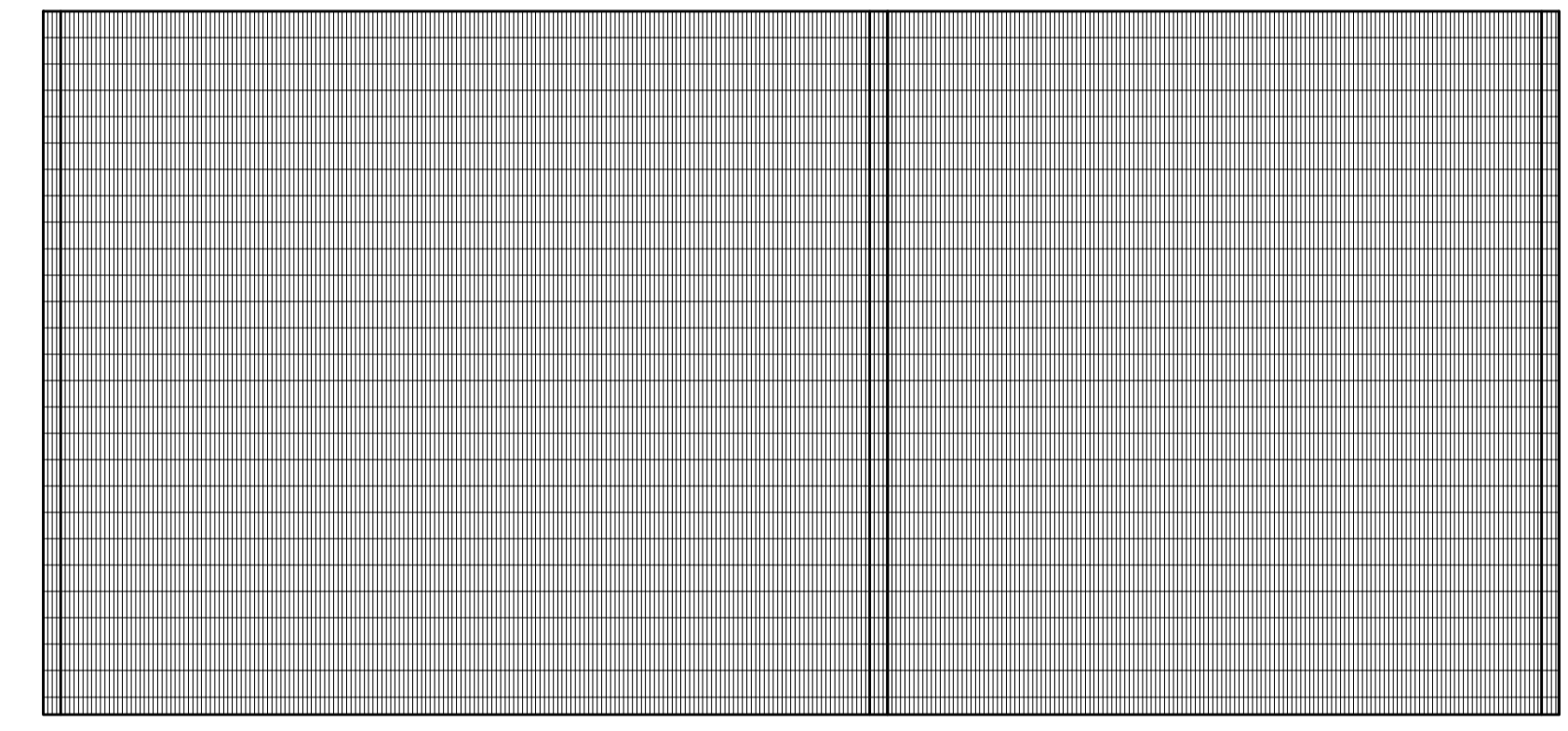

NORTH EAST ELEVATION  
AS PROPOSED  
B

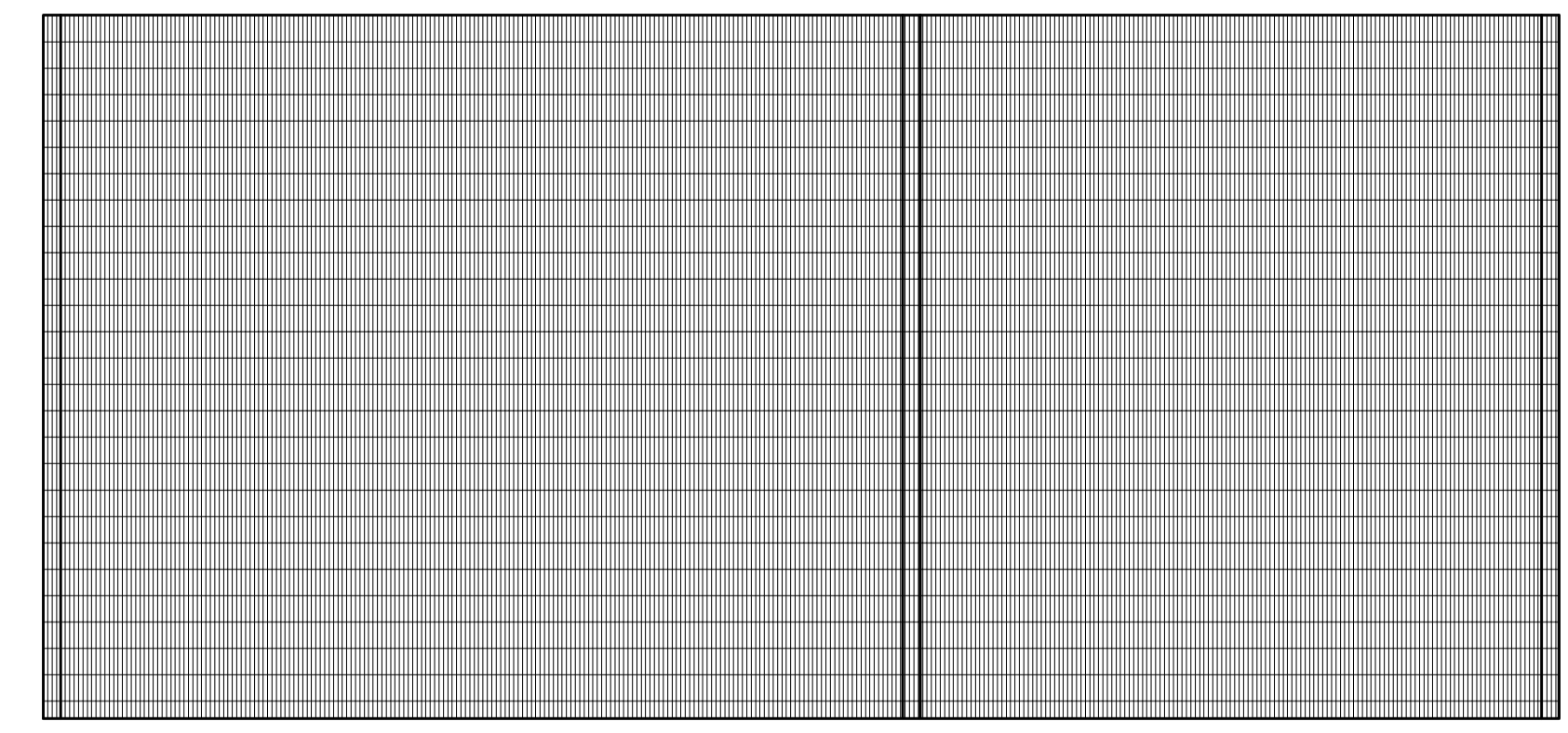

Rev	Date	Description	Name



Pellings LLP  
 Northside House Mount Pleasant Barnet EN4 8ED  
 t 020 8441 9500 f 020 8441 4916 e barret@pellings.co.uk  
 www.pellings.co.uk  
 Architecture & Planning • Building Surveying & Project Management •  
 Cost Consultancy & CDM Co-ordination

CLIENT  
**LONDON BOROUGH OF CAMDEN**

PROJECT  
**Argyle Primary School  
 Tonbridge Street,  
 London  
 WC1H 9EG**

TITLE  
**PLAN & ELEVATIONS  
 AS PROPOSED  
 WALL**

DATE	01/04/2022	SCALE	1:50	@A1	DRAWN	RH
------	------------	-------	------	-----	-------	----

DRAWING No.  
**252 | 0800 | 202 |**