

SPRATLEY & PARTNERS
7 CENTENARY BUSINESS PARK, STATION ROAD, HENLEY-ON-THAMES, OXFORDSHIRE RG9 1DS. 01491 411277
ISSUED ONLY FOR THE PURPOSE INDICATED. THIS DRAWING TO BE READ IN CONJUNCTION WITH ALL CONSULTANTS
INFORMATION. ALL DIMENSIONS TO BE CHECKED ON SITE. THIS DRAWING IS COPYRIGHT.

REV.	ISSUED	DESCRIPTION	DRAWN	CHECKED
-	-	-	-	-
-	-	-	-	-
-	-	-	-	-

PROJECT
HOLBORN LINKS
EXTERNAL WORKS

DESCRIPTION
20-22 SP EXISTING
ROOF PLAN

DATE
MAR '22
STATUS
DRAFT
DRAWN
JO
CHECKED
RE

SCALE AT A1
1:50
JOB NO
22.963
DRAWING NO
PL0311
REV
-

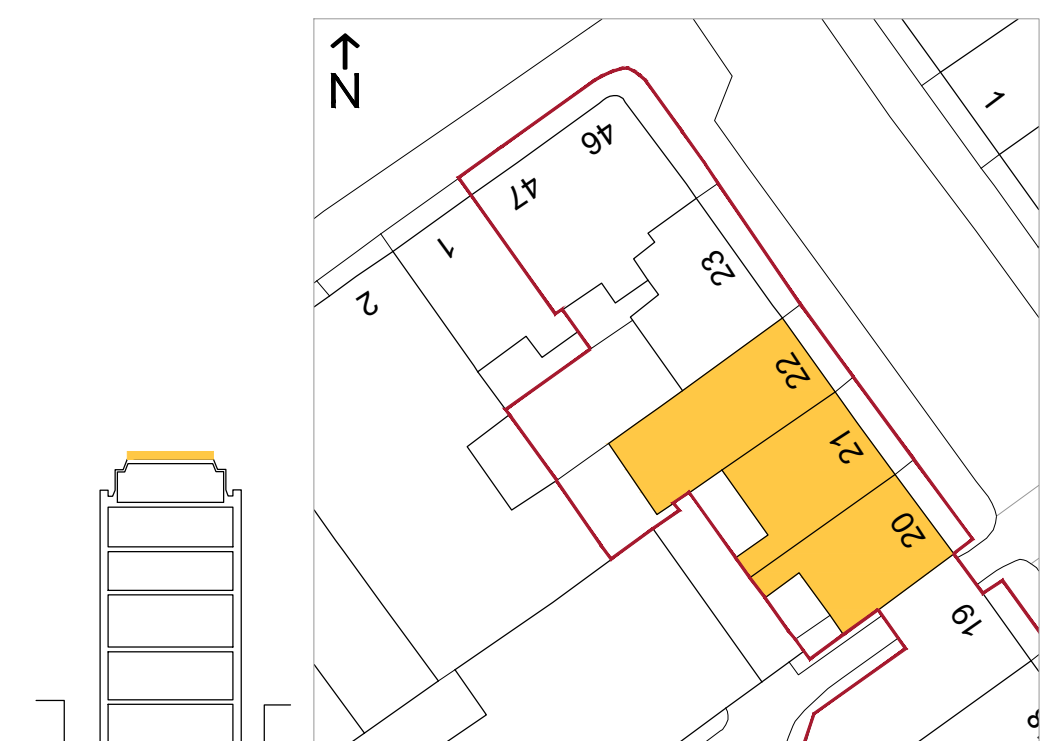

S
& P