

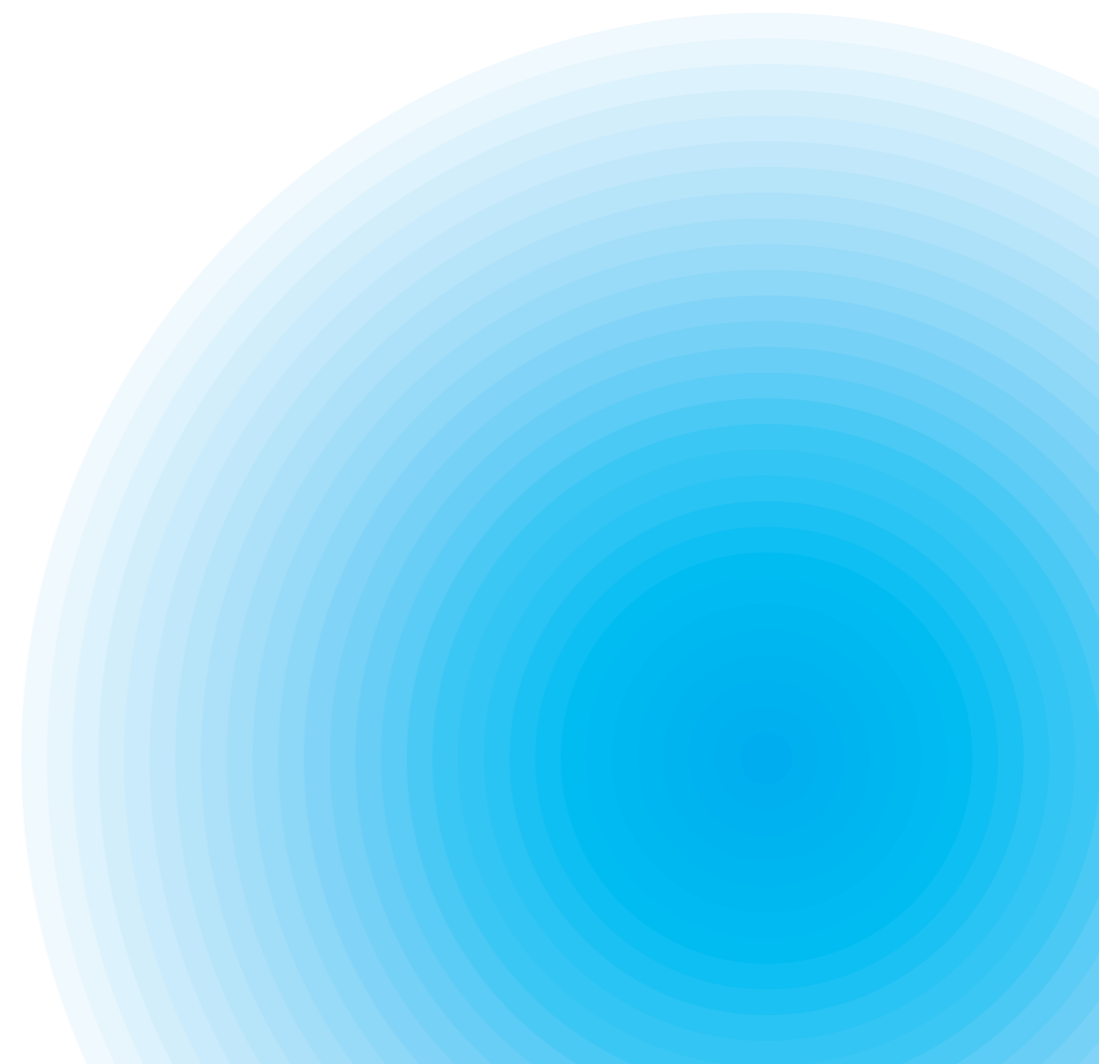

0164 - STEPHENSON HOUSE

Architectural Lighting to External Entrances

Condition 3E
04/04/2022
First Issue



STEPHENSON HOUSE - EXTERIOR ENTRANCE INFORMATION

Exterior Entrances

The exterior entrances define the different gateways into Stephenson House, the three entrances include:

- The main office entrance on the corner of Drummond Street and Hampstead Road
- The residential entrance on Hampstead Road
- The SME entrance on the corner of Hampstead Road and William Road

The lighting to the entrances has been designed to highlight the entrance area and to illuminate architectural features, highlighting materiality whilst providing safe and functional entrance points into Stephenson House. The lighting to all entrances consist of downlights in a range of beams and outputs to suit the application and are all DALI dimmable and form part of the architectural control system. All lighting is directed down towards the ground or columns therefore minimal spill light and light pollution. Some of the downlights also double up as emergency fittings to aid safe escape from the building. The downlights are all warm white 3000K which create a warm and pleasant atmosphere and compliment the facade. Long life span low energy LED's have been selected.

There are no set lighting guidelines for architectural lighting to exterior entrances, instead a combination of a number of elements can be reviewed to select an appropriate light level, these include;

- ILP Reduction of Obtrusive Light Guide
- CIBSE Lighting Guide 06: The Exterior Environment, Table 2.2 Excerpt from BS EN 12464:2-2104 with the recommended minimum level of 5 lux for walkways exclusively for pedestrians.
- BS 5266-1 and CIBSE LG12 for emergency lighting with a lux level minimum of 1 lux along the centre line of the defined path for final exit routes.

The entrance points to Stephenson House should have a raised level of illuminance compared to the surrounding public realm to define the entrances and create an inviting and safe access point to the building.

During the daytime daylight will supplement the artificial lighting to create a bright and inviting entrance and during the night the artificial light will be balanced to reflect the internal reception lighting to ensure there is not a vast contrast in light levels between spaces as it would make it harder for the eyes to adjust.

During daylight hours it is expected that the light levels will be 1000 lux+ due to daylight and during the evening between 100-150 lux to balance with the reception for the main office and 75-100 lux for the SME and residential entrances. All light levels will be carefully commissioned on site to ensure a suitably lit environment. Vertical surfaces will also be illuminated to create balance and interest, highlighting materiality and provide a three dimensional design.

Photoshop render of Stephenson House Main Office Entrance

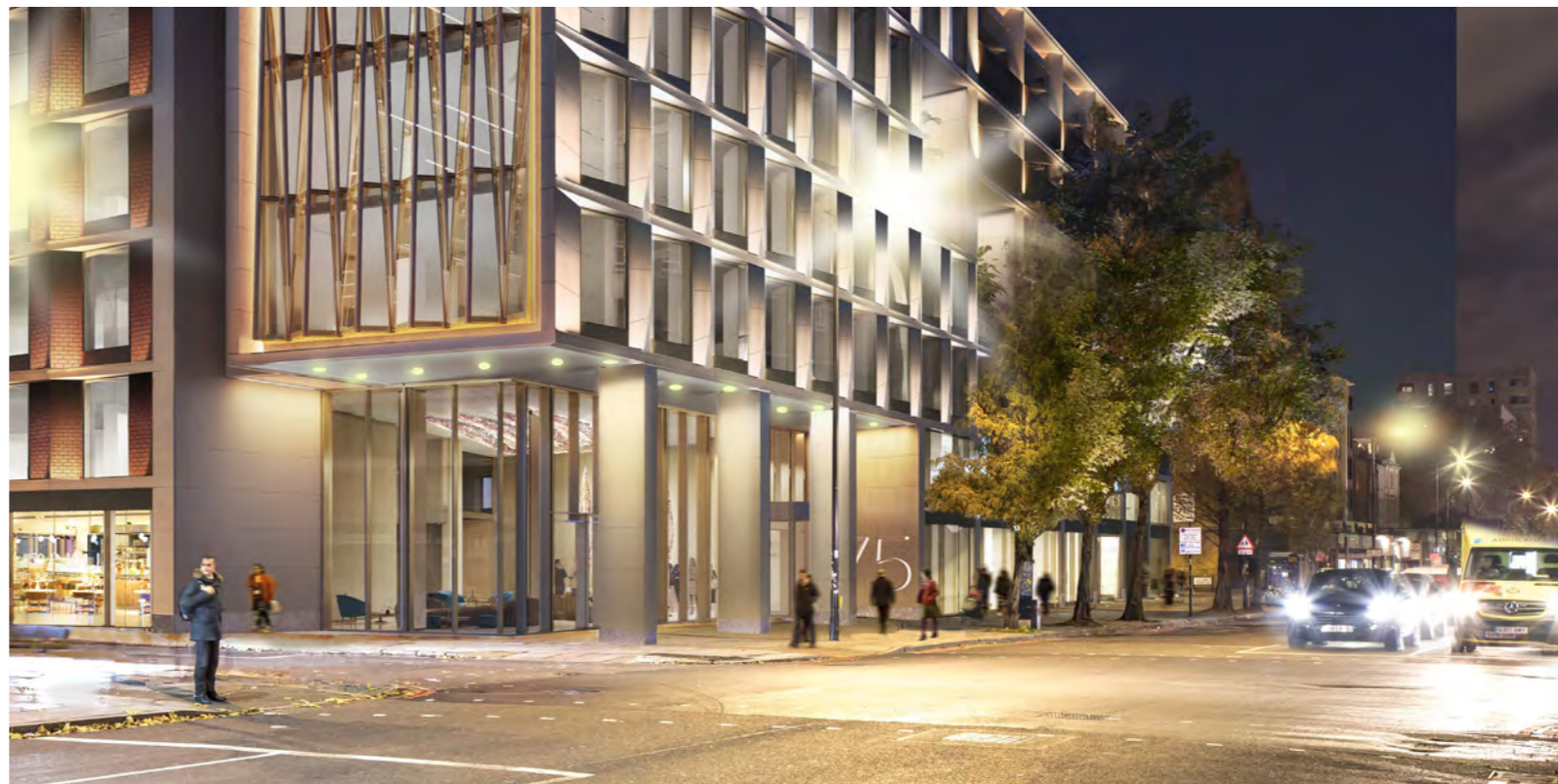

Concept Images Demonstrating the Design Intent

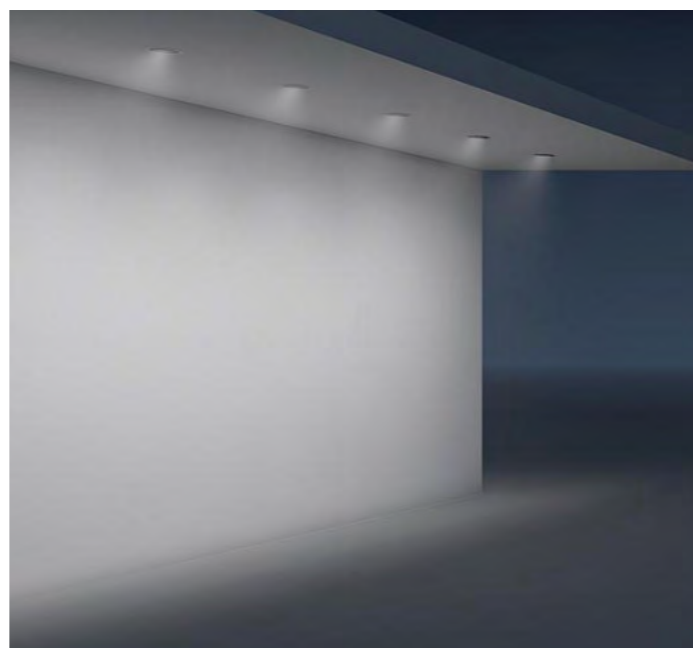

Wall wash downlights to surrounding walls

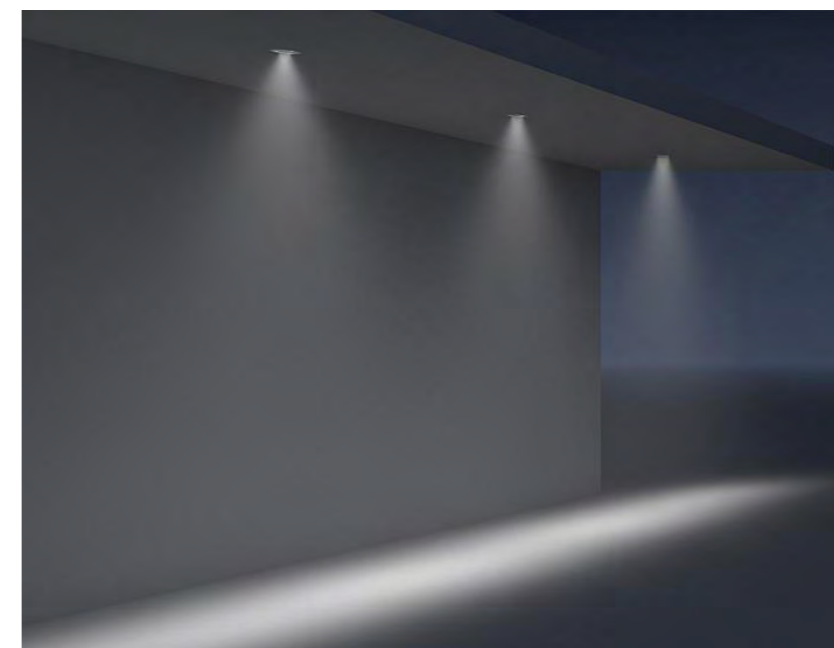

Recessed downlights for general ambient light

STEPHENSON HOUSE - EXTERIOR ENTRANCE INFORMATION

Exterior Entrances - Architectural and Emergency Lighting

Light Fixture Key Design Features

Recessed Downlights
Reference: DL7, DL11, DL13

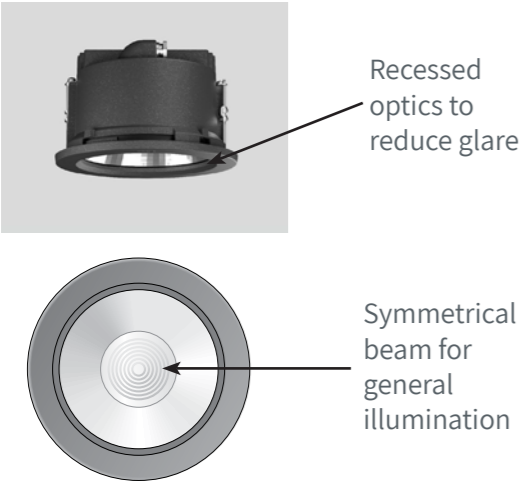

Key Features

- Multiple sized downlights providing general illumination and lighting to the columns.
- RAL coloured to blend with the surrounding soffit
- Emergency battery packs can be used in conjunction with them to save the requirement for a separate light, minimising clutter on the soffit
- Warm white 3000K light to provide a safe and welcoming space
- Different beam angles selected for each application;
 - Narrow beam to columns to minimise spill light and highlight architectural features
 - Wide beam optic between columns to provide a suitable light level to the floor and create a welcoming atmosphere
- Multiple light outputs selected depending on its application. The lighting to the exterior canopy is designed to minimise the contrast in light levels between the interior and exterior to ensure the transition between the different spaces is smooth as recommended within the lighting guidelines.
- The fittings are all DALI dimmable and form part of the architectural control system.
- Energy efficient LED's with long lifespans

Recessed Wallwash Lights
Reference: DL9, DL14

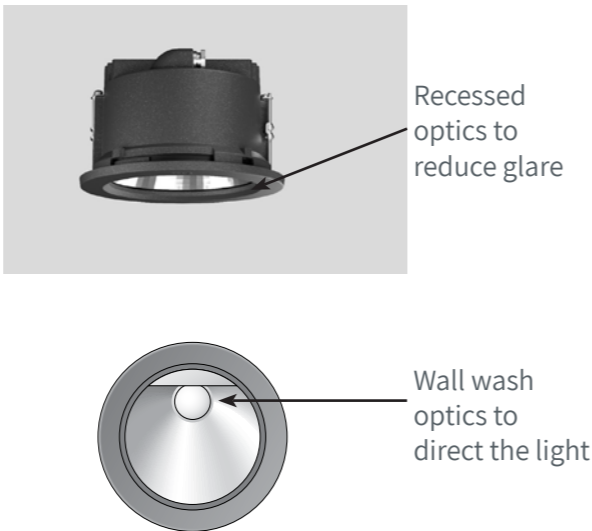

Key Features

- The fittings form part of the same family as the downlights to ensure they visually all harmonise
- RAL coloured to blend with the surrounding soffit
- Warm white 3000K light to provide a safe and welcoming space
- Wall wash optics chosen to direct the light towards the entrance walls to light the vertical planes and highlight the architectural finishes.
- DALI dimmable and forms part of the architectural control system.
- Energy efficient LED's with long lifespans
- Emergency battery packs can be used in conjunction with them to save the requirement for a separate light, minimising clutter on the soffit

Architectural Light Levels
Main Entrance - Corner of Drummond Street and Hampstead Road

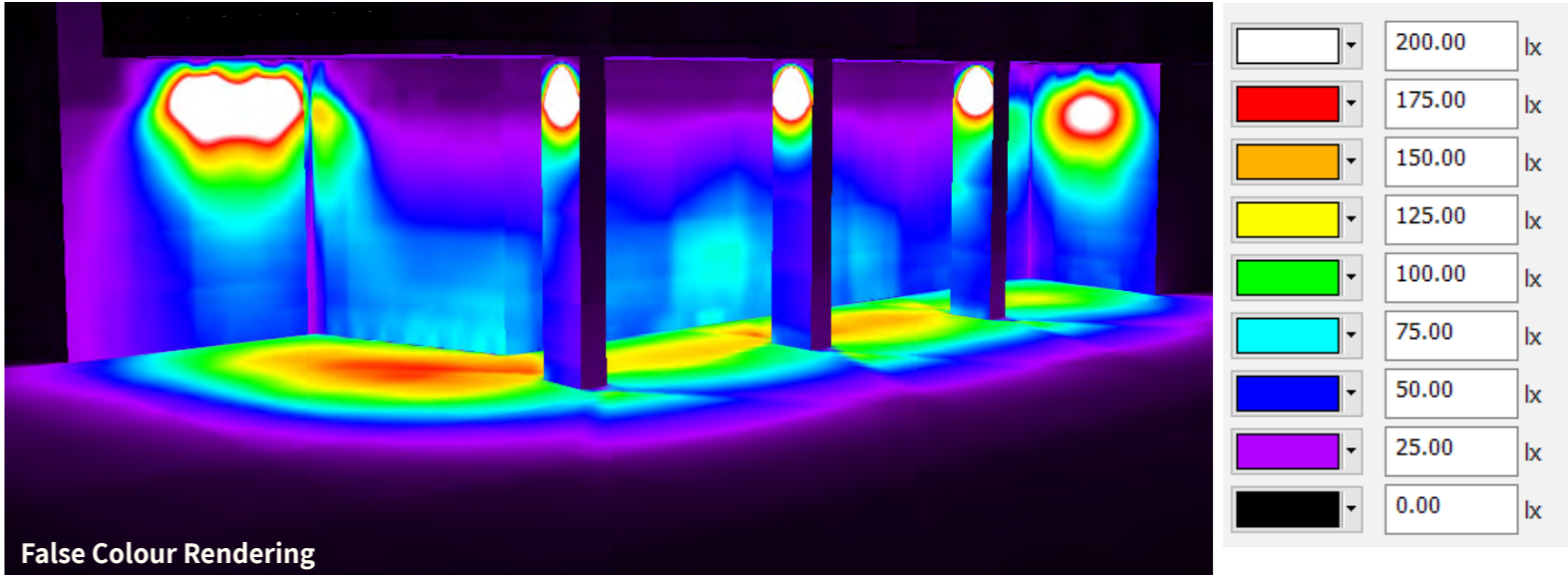

The light levels range from around 125-175 lux with the lighting on at 100% output. This surpasses the minimum recommendation of 5 lux for walkways exclusively for pedestrians and balances with the minimum required internal light levels of 100 lux for entrance halls. The lighting will be commissioned on site and dimmed to balance with the external surrounding light levels and internal reception light levels.

The lighting is all directed downwards to minimise any upward light, the use of carefully selected beam angles ensures the lighting is mainly contained to the entrance canopy area only

Emergency Light Levels
Main Entrance - Corner of Drummond Street and Hampstead Road

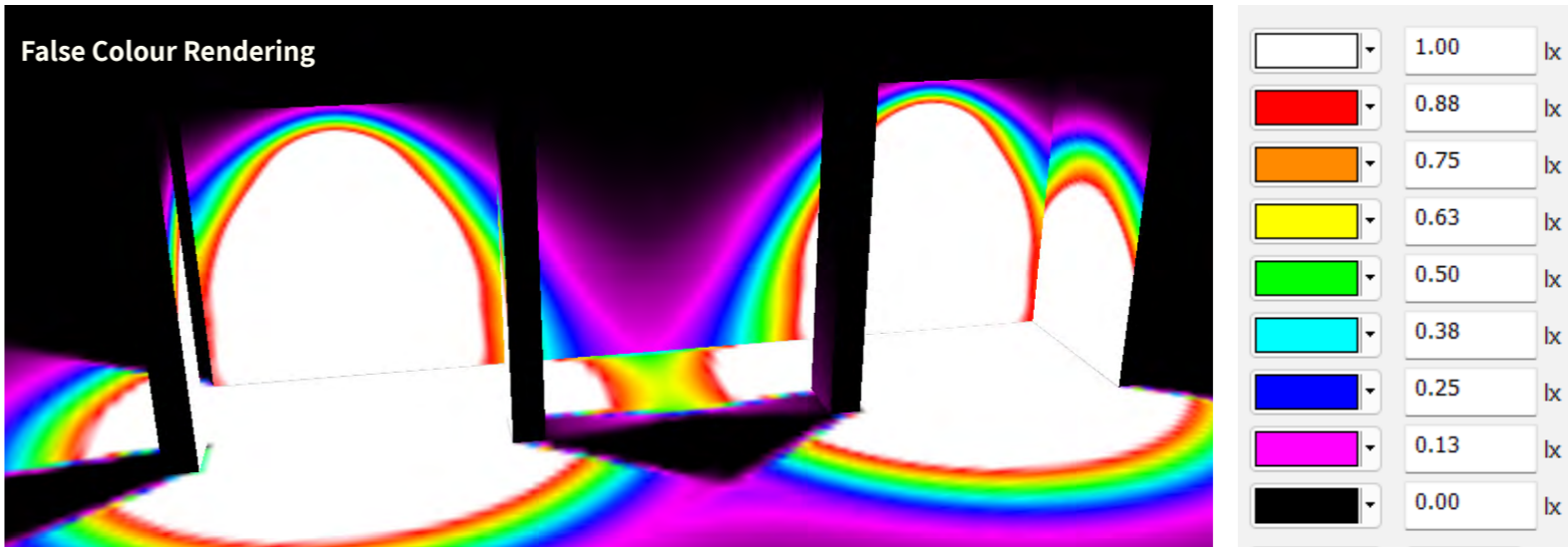

The light level at the exterior exits surpasses the minimum requirement of 1 lux. The average lux level by the exits is 8 lux.

STEPHENSON HOUSE - EXTERIOR ENTRANCE INFORMATION

Exterior Entrances - Architectural and Emergency Lighting

Architectural Light Levels
SME Entrance - Corner of William Road and Hampstead Road

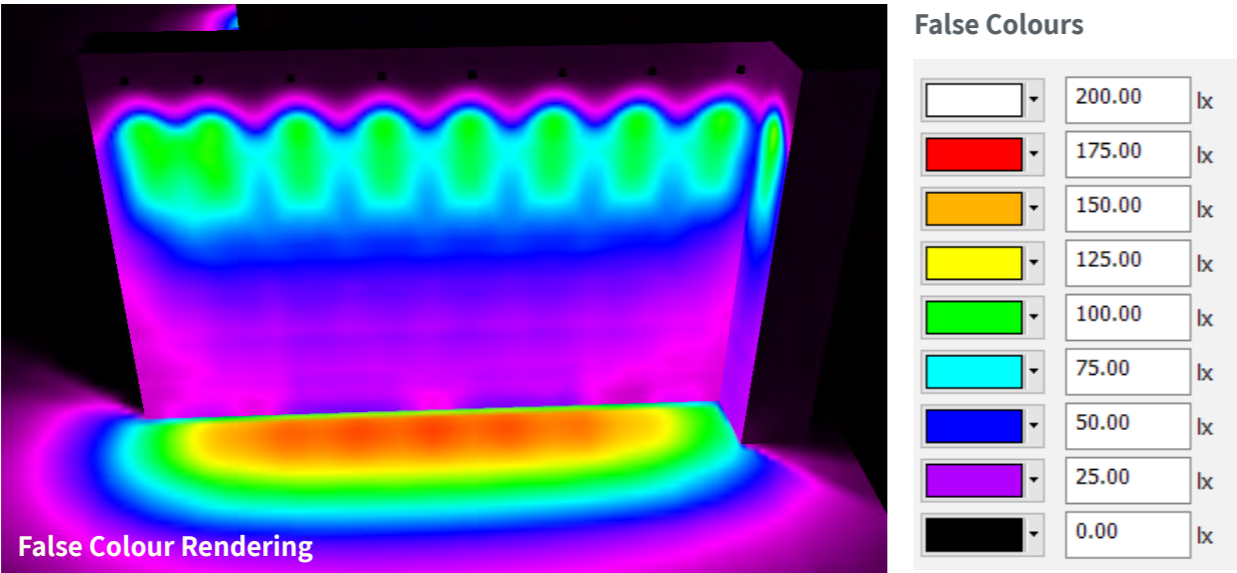

The light levels range from around 100-150 lux with the lighting on at 100% output. This surpasses the minimum recommendation of 5 lux for walkways exclusively for pedestrians and balances with the minimum required internal light levels of 100 lux for entrance halls. The lighting will be commissioned on site and dimmed to balance with the external surrounding light levels and internal light levels. The lighting is all directed downwards to minimise any upward light, the use of carefully selected beam angles ensures the lighting is mainly contained to the canopy area only.

Emergency Light Levels
SME Entrance - Corner of William Road and Hampstead Road

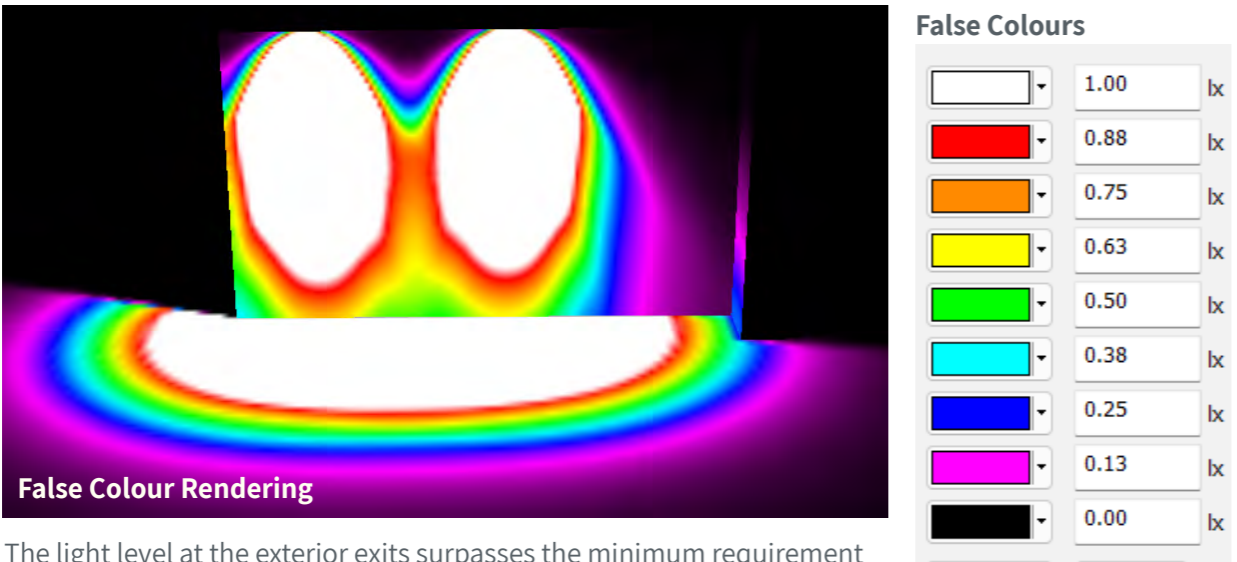

The light level at the exterior exits surpasses the minimum requirement of 1 lux. The average lux level by the exit is 6 lux.

Architectural Light Levels
Residential Entrance - Hampstead Road

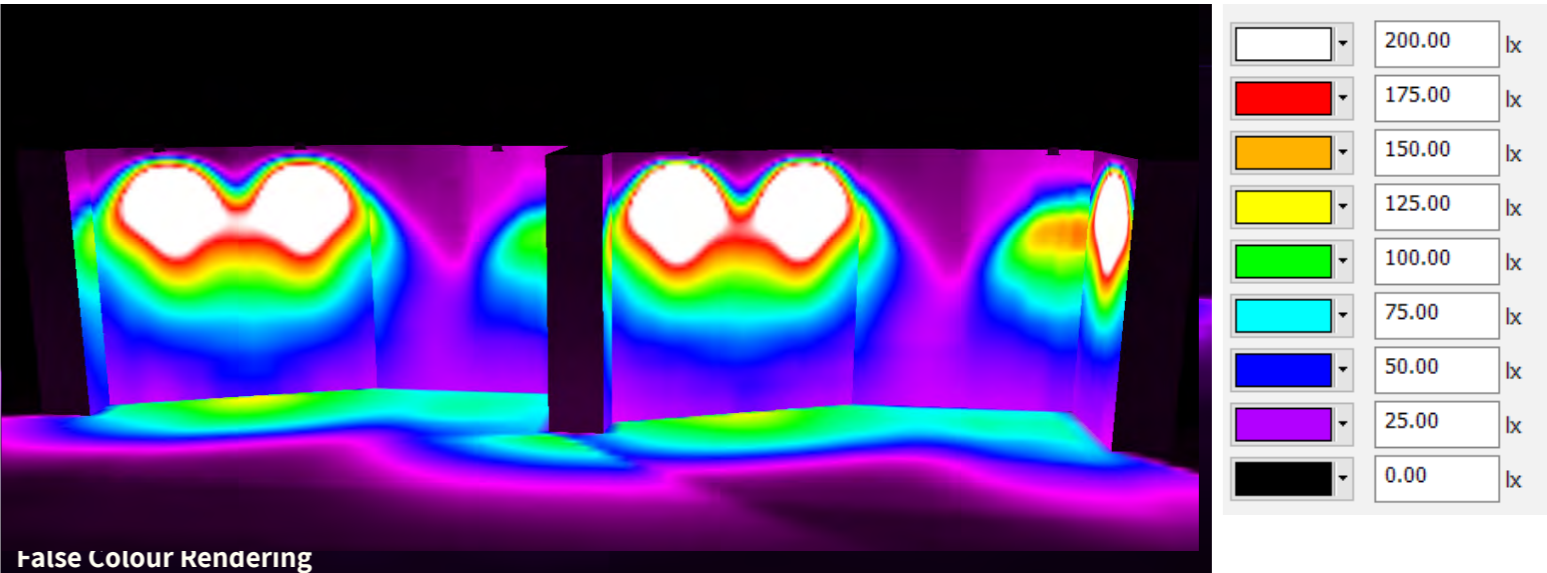

The light levels range from around 75-125 lux with the lighting on at 100% output. This surpasses the minimum recommendation of 5 lux for walkways exclusively for pedestrians and balances with the minimum required internal light levels of 100 lux for entrance halls. The lighting will be commissioned on site and dimmed to balance with the external surrounding light levels and internal light levels. The lighting is all directed towards walls to minimise any upward light, the use of wallwasher optics ensures the lighting is mainly contained to the canopy area only

Emergency Light Levels
Residential Entrance - Hampstead Road

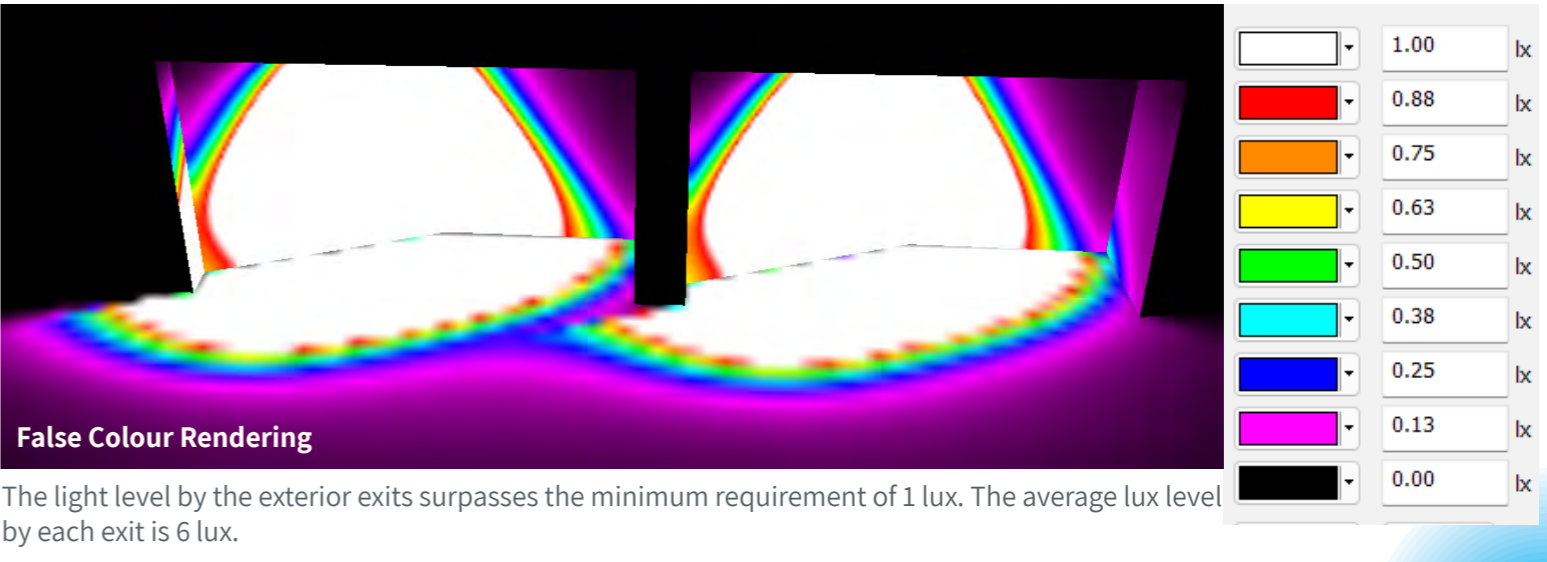





The light level by the exterior exits surpasses the minimum requirement of 1 lux. The average lux level by each exit is 6 lux.

STEPHENSON HOUSE - EXTERIOR ENTRANCE INFORMATION

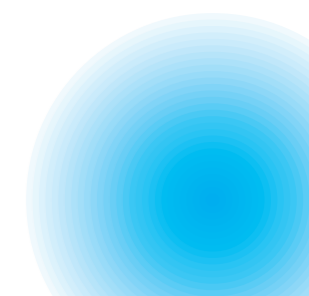
APPENDIX

DRAWINGS



LEGEND	
TYPE	DESCRIPTION
 DL11	Recessed downlight with wide beam, high output, warm white
 DL11 E	Recessed maintained emergency downlight with wide beam, high output, warm white, supplied with 3hr emergency pack
 DL13	Recessed downlight with narrow beam, warm white
 DL14	Recessed downlight with wallwash beam, high output, warm white

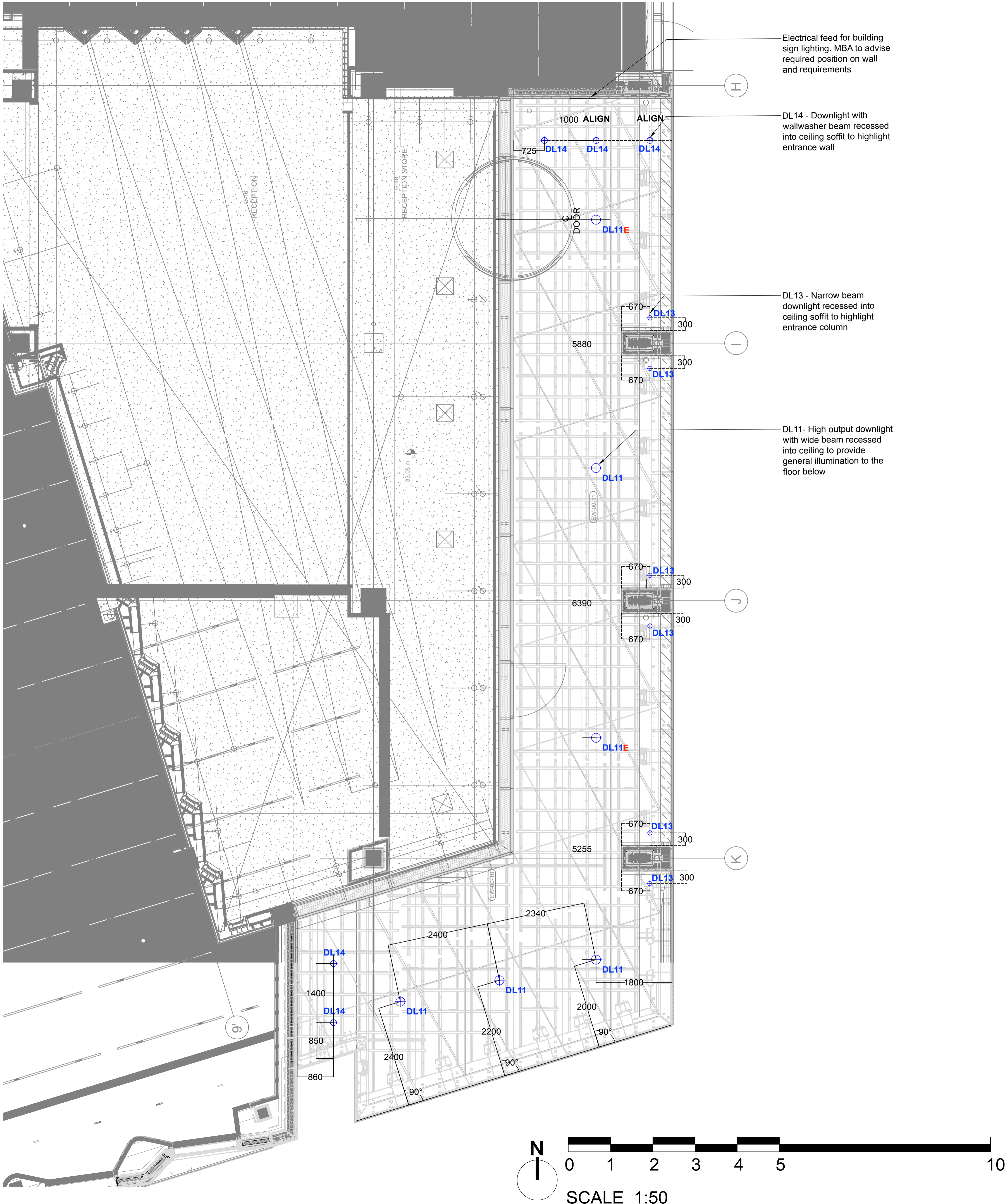

Date	Rev	Description
10/06/21	C2	Co-ordination for construction
22/04/21	F	Revised location of downlights to columns
23/03/21	E	Draft for Co-ordination
04/09/20	D	North arrow and scale bar added for planning
17/07/20	C1	Notes updated
03/07/20	C	L5 removed; setting out added; legend and annotation updated
29/05/20	B	Downlights added
09/11/18	A	Generally updated following comment from MBA
12/07/18	DFT	First Issue DRAFT

Notes

All emergency lighting in this area is DALI reporting and forms part of the Lutron system for monitoring

The drawing has been updated following the workshop meeting 20.04.21. As per the discussions the edge ceiling structure adjacent to the columns would need to be addressed to accommodate the downlights to the columns. Co-ordination to be completed by Permasteelisa and 8Build

DALI drivers and emergency packs for luminaires are remote and are to be housed in the ceiling void behind the fitting. Maximum driver distances and dimensions can be found in the luminaire specification.

Remote emergency LED indicators are to be located adjacent to the relevant luminaires.

Important Note

Where Dimensions are not given, drawings must not be scaled.

For complete luminaire breakdown refer to schedules

In the event of conflict between this drawing and lead consultants drawing the matter must be referred prior to proceeding

CLIENT	Lazari Investments Ltd	
PROJECT	Stephenson House, 75 Hampstead Road, London, NW1 2PL	PROJECT NO. 0164
STATUS	For Construction	
SCALE	1:50 @ A1 1:100 @ A3	DATE 12/07/2018
TITLE	Colonnade First Floor RCP	
DRAWING NO.	0164 - 201	REVISION C2

A

CLIENT	Lazari Investments Ltd		
PROJECT	Stephenson House, 75 Hampstead Road, London, NW1 2PL	PROJECT NO.	0164
STATUS	For construction		
SCALE	1:25 @ A1 1:50 @ A3	DATE	12/07/2018
TITLE	Colonnade Ground Floor Exterior RCP		
DRAWING NO.	0164 - 202	REVISION	C2

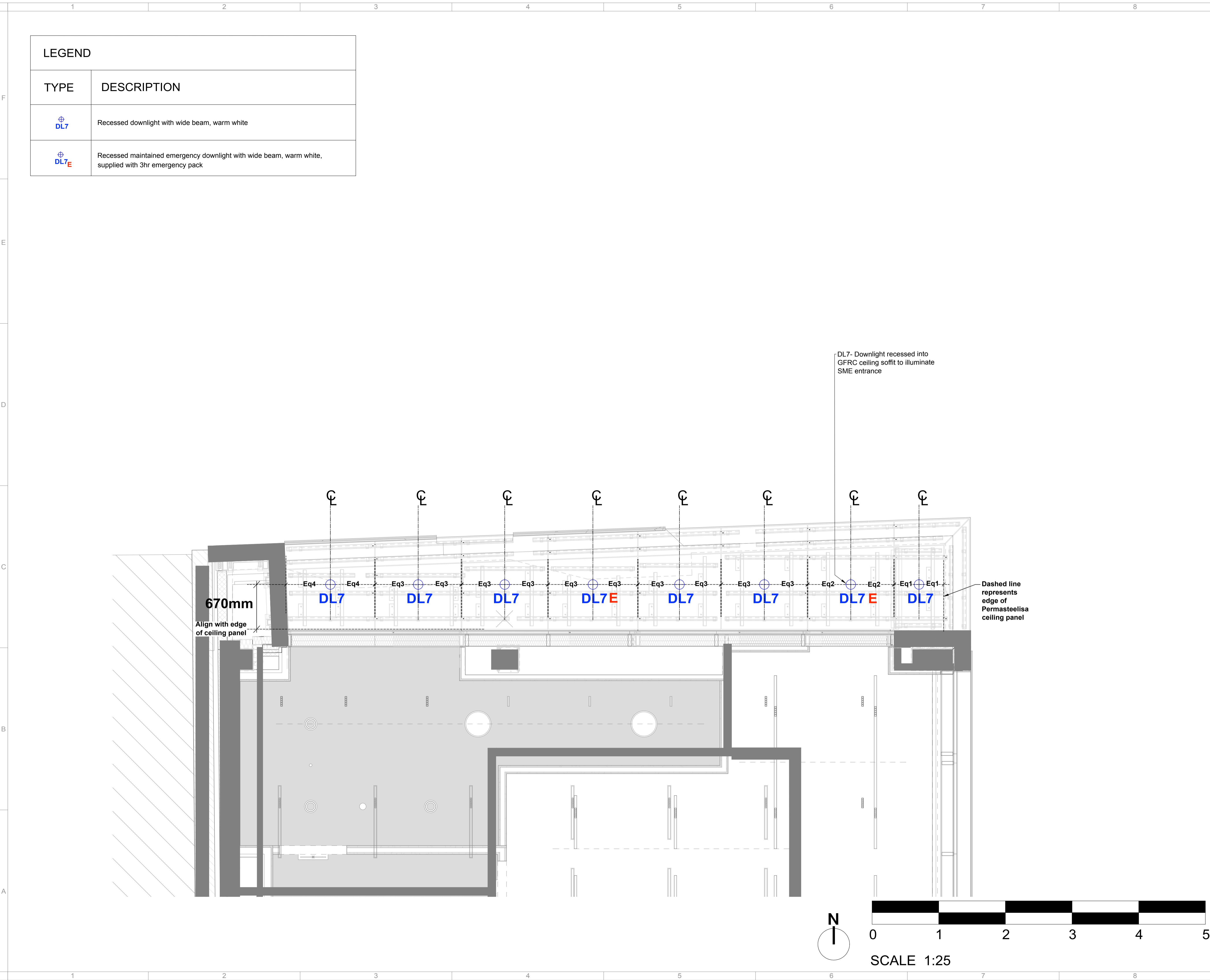

studio 29

Studio 29 The Boathouse,
1A Embankment, London SW15 1LB
t:020 8780 9006 w:studio29lighting.com

21/05/21	C2	Lighting aligned with Permasteelisa structure Draft for Co-ordination
23/03/21	E	
04/09/20	D	North arrow and scale bar added for planning
17/07/20	C1	Updated notes
03/07/20	C	L5 removed; setting out added; legend and annotation updated
29/05/20	B	Downlights added
09/11/18	A	Generally updated following comment from MBA
12/07/18	DFT	First Issue DRAFT
Date	Rev	Description

Notes

All emergency lighting in this area is DALI reporting and forms part of the Lutron system for monitoring

Final co-ordination of luminaires required with facade contractor

DALI drivers for luminaires are remote and are to be housed in the ceiling void adjacent to fitting. Maximum driver distances and dimensions can be found in the luminaire specification.

Emergency battery packs fit through downlight cut-out and are to be placed in the ceiling void adjacent to the downlight.

Emergency indicators are remote and are to be located in the ceiling adjacent to the emergency downlight

Important Note

Where Dimensions are not given, drawings must not be scaled.

For complete luminaire breakdown refer to schedules

In the event of conflict between this drawing and lead consultants drawing the matter must be referred prior to proceeding

CLIENT	Lazari Investments Ltd		
PROJECT	Stephenson House, 75 Hampstead Road, London, NW1 2PL	PROJECT NO.	0164
STATUS	For Construction		
SCALE	1:25 @ A1 1:50 @ A3	DATE	12/07/2018
TITLE	SME Entrances First Floor Exterior RCP		
DRAWING NO.	0164 - 203	REVISION	C2

STEPHENSON HOUSE - EXTERIOR ENTRANCE INFORMATION

APPENDIX

EXTERIOR ENTRANCE
SPECIFICATIONS

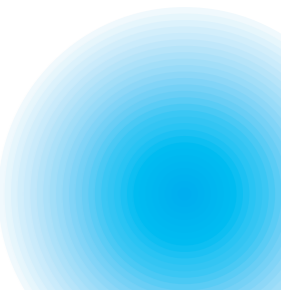

DETAILED LUMINAIRE SCHEDULE

the language of light

Project: Stephenson House – Exterior Lighting
Reference: 0164 – SC2

LUMINAIRE REF:

DL7 – UPDATED 17.07.20

Manufacturer: Bega (supplied by Fagerhult)
Tel: Office: 020 7403 4123 Mobile: 075 8550 9782
Contact: Sam Ashdown Email: sam.ashdown@fagerhult.co.uk

Location: SME Entrance
Cat. Reference: **24823 K3 W RAL**
Description: Recessed downlight / 35° / 3000K / IP65
Dimensions: 145 mm diameter
80 mm depth
90 mm recessed depth required
Ceiling cut-out: 128 mm diameter

Accessories: -
Control Gear: Remote driver / DALI dimming
Colour: Custom RAL 9016 Traffic White
CDM/H&S: -
Notes:

Driver dimensions as noted in adjacent image

Maximum Driver Distance: 0.5m – Please locate adjacent to luminaire in ceiling void

Longer driver distances can be requested if required

Circuit Wattage: 10 W
Voltage: 170-280 V
Beam Angle: 35°
Colour Kelvin: 3000K
Luminous Flux: 1151 lm
CRI (Ra) 80

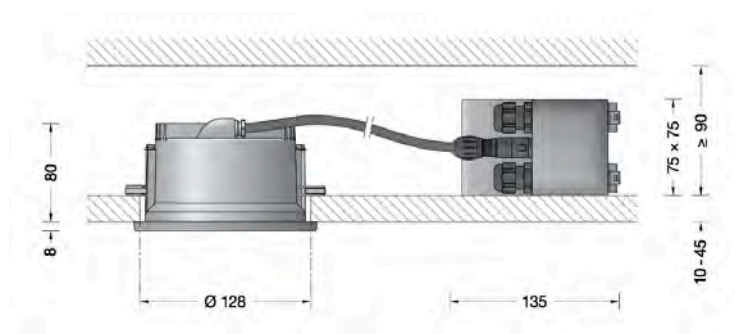

DETAILED LUMINAIRE SCHEDULE

the language of light

Project: Stephenson House – Exterior Lighting
Reference: 0164 – SC2

LUMINAIRE REF:

DL7E – UPDATED 21.05.21

Manufacturer: Bega (supplied by Fagerhult)
Tel: Office: 020 7403 4123 Mobile: 075 8550 9782
Contact: Sam Ashdown Email: sam.ashdown@fagerhult.co.uk

Location: SME Entrance
Cat. Reference: **24823 K3 W RAL**
Description: Recessed downlight / 35° / 3000K / IP65
Dimensions: 145 mm diameter
80 mm depth
90 mm recessed depth required
Ceiling cut-out: 128 mm diameter

Accessories: **3-hour emergency battery pack**

Control Gear: Remote driver / DALI dimming

Colour: Custom RAL 9016 Traffic White

CDM/H&S: -

Notes: **Architectural luminaire to be used as maintained emergency fitting and to be supplied with remote 3 hour emergency DALI battery pack to link up to the Lutron system**
Driver dimensions as noted in adjacent image
Maximum Driver Distance: 0.5m – Please locate adjacent to luminaire in ceiling void
Longer driver distances can be requested if required
Emergency pack dimensions 230mm x 80mm x 65mm to fit through cut-out

Circuit Wattage: 10 W
Voltage: 170-280 V
Beam Angle: 35°
Colour Kelvin: 3000K
Luminous Flux: 1151 lm
CRI (Ra) 80

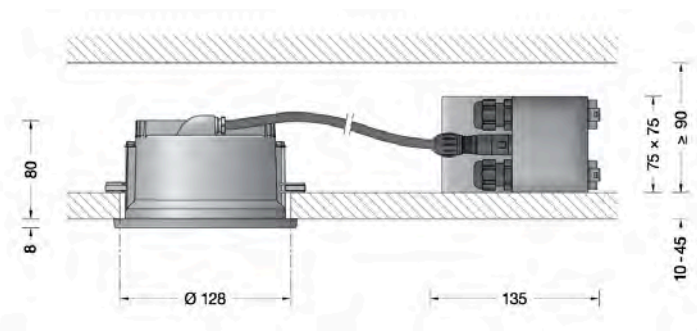

DETAILED LUMINAIRE SCHEDULE

the language of light

Project: Stephenson House – Exterior Lighting
Reference: 0164 – SC2

LUMINAIRE REF:

DL9 – UPDATED 17.07.20

Manufacturer: Bega (supplied by Fagerhult)
Tel: Office: 020 7403 4123 Mobile: 075 8550 9782
Contact: Sam Ashdown Email: sam.ashdown@fagerhult.co.uk

Location: Residential Entrance
Cat. Reference: **24841 K3 RAL**
Description: Recessed downlight / wallwash beam / 3000K / IP65
Dimensions: 145 mm diameter
80 mm depth
90 mm recessed depth required
Ceiling cut-out: 128 mm diameter

Accessories: -
Control Gear: Remote driver / DALI dimming
Colour: Custom RAL 9005 Jet Black
CDM/H&S: -
Notes:

Driver dimensions as noted in adjacent image

Maximum Driver Distance: 0.5m – Please locate adjacent to luminaire in ceiling void

Longer driver distances can be requested if required

Circuit Wattage: 14 W
Voltage: 176-280 V
Beam Angle: 63/64°
Colour Kelvin: 3000K
Luminous Flux: 1212 lm
CRI (Ra) 80

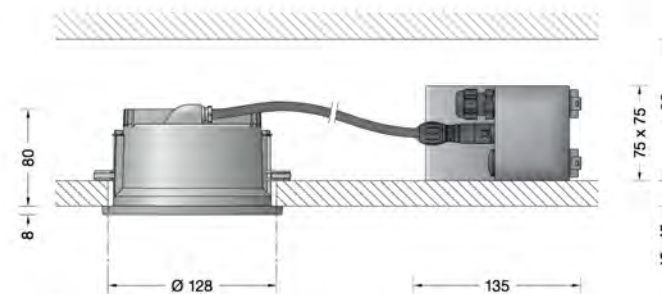

DETAILED LUMINAIRE SCHEDULE

the language of light

Project: Stephenson House – Exterior Lighting
Reference: 0164 – SC2

LUMINAIRE REF:

DL9E – UPDATED 21.05.21

Manufacturer: Bega (supplied by Fagerhult)
Tel: Office: 020 7403 4123 Mobile: 075 8550 9782
Contact: Sam Ashdown Email: sam.ashdown@fagerhult.co.uk

Location: Residential Entrance
Cat. Reference: **24841 K3 RAL**
Description: Recessed downlight / wallwash beam / 3000K / IP65
Dimensions: 145 mm diameter
80 mm depth
90 mm recessed depth required
Ceiling cut-out: 128 mm diameter

Accessories: 3-hour emergency battery pack

Control Gear: Remote driver / DALI dimming

Colour: Custom RAL 9005 Jet Black

CDM/H&S: -

Notes: **Architectural luminaire to be used as maintained emergency fitting and to be supplied with remote 3 hour emergency DALI battery pack to link up to the Lutron system**
Driver dimensions as noted in adjacent image
Maximum Driver Distance: 0.5m – Please locate adjacent to luminaire in ceiling void
Longer driver distances can be requested if required
Emergency pack dimensions 230mm x 80mm x 65mm to fit through cut-out

Circuit Wattage: 14 W
Voltage: 176-280 V
Beam Angle: 63/64°
Colour Kelvin: 3000K
Luminous Flux: 1212 lm
CRI (Ra) 80

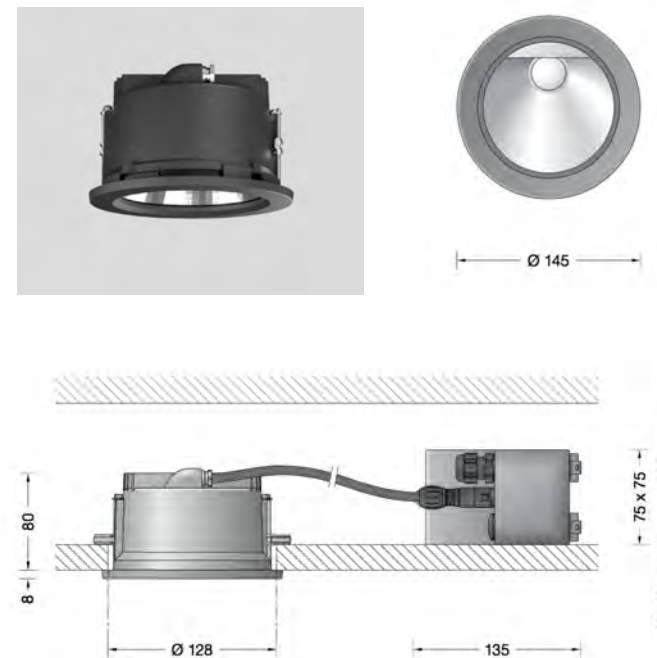

DETAILED LUMINAIRE SCHEDULE

the language of light

Project: Stephenson House – Exterior Lighting
Reference: 0164 – SC2

LUMINAIRE REF:

DL11 – UPDATED 17.07.20

Manufacturer: Bega (supplied by Fagerhult)
Tel: Office: 020 7403 4123 Mobile: 075 8550 9782
Contact: Sam Ashdown Email: sam.ashdown@fagerhult.co.uk

Location: Main Entrance Colonnade
Cat. Reference: **24831 K3 W RAL**
Description: Recessed downlight / 56° / 3000K / IP65
Dimensions: 220 mm diameter
105 mm depth
115 mm recessed depth required
Ceiling cut-out: 202 mm diameter

Accessories: -
Control Gear: Remote driver / DALI dimming
Colour: Custom RAL 9016 Traffic White
CDM/H&S: -
Notes:

Driver dimensions as noted in adjacent image

Maximum Driver Distance: 0.5m – Please locate adjacent to luminaire in ceiling void

Longer driver distances can be requested if required

Circuit Wattage: 19.4 W
Voltage: 176-276 V
Beam Angle: 56°
Colour Kelvin: 3000K
Luminous Flux: 2454 lm
CRI (Ra) 80

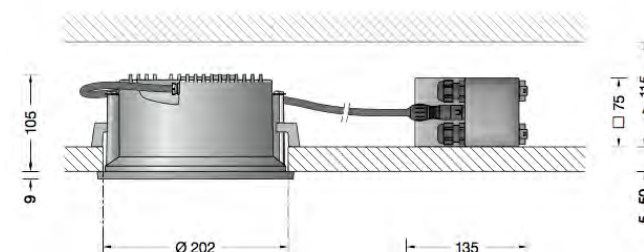

DETAILED LUMINAIRE SCHEDULE

the language of light

Project: Stephenson House – Exterior Lighting
Reference: 0164 – SC2

LUMINAIRE REF:

DL11E – UPDATED 17.07.20

Manufacturer: Bega (supplied by Fagerhult)
Tel: Office: 020 7403 4123 Mobile: 075 8550 9782
Contact: Sam Ashdown Email: sam.ashdown@fagerhult.co.uk

Location: Main Entrance Colonnade
Cat. Reference: **24831 K3 W RAL**
Description: Recessed downlight / 56° / 3000K / IP65
Dimensions: 220 mm diameter
105 mm depth
115 mm recessed depth required
Ceiling cut-out: 202 mm diameter

Accessories: 3-hour emergency battery pack

Control Gear: Remote driver / DALI dimming

Colour: Custom RAL 9016 Traffic White

CDM/H&S: -

Notes: **Architectural luminaire to be used as maintained emergency fitting and to be supplied with remote 3 hour emergency DALI battery pack to link up to the Lutron system**
Driver dimensions as noted in adjacent image
Maximum Driver Distance: 0.5m – Please locate adjacent to luminaire in ceiling void
Longer driver distances can be requested if required

Circuit Wattage: 19.4 W
Voltage: 176-276 V
Beam Angle: 56°
Colour Kelvin: 3000K
Luminous Flux: 2454 lm
CRI (Ra) 80

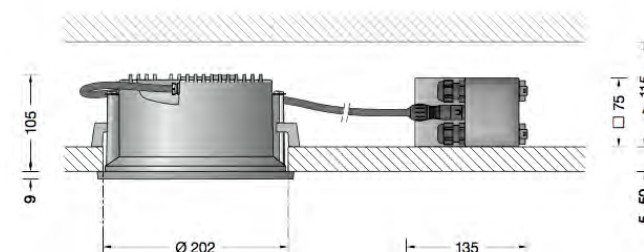

DETAILED LUMINAIRE SCHEDULE

the language of light

Project: Stephenson House – Exterior Lighting
Reference: 0164 – SC2

LUMINAIRE REF:

DL13 – UPDATED 17.07.20

Manufacturer: Bega (supplied by Fagerhult)
Tel: Office: 020 7403 4123 Mobile: 075 8550 9782
Contact: Sam Ashdown Email: sam.ashdown@fagerhult.co.uk

Location: Main Entrance Colonnade
Cat. Reference: **24382 K3 W RAL**
Description: Recessed downlight / 16° / 3000K / IP65
Dimensions: 110 mm diameter
70 mm depth
110 mm recessed depth required
Ceiling cut-out: 97 mm diameter

Accessories: -
Control Gear: Remote driver / DALI dimming
Colour: Custom RAL 9016 Traffic White
CDM/H&S: -
Notes:

Driver dimensions as noted in adjacent image

Maximum Driver Distance: 0.5m – Please locate adjacent to luminaire in ceiling void

Longer driver distances can be requested if required

Circuit Wattage: 14 W
Voltage: 230 V with remote driver
Beam Angle: 16°
Colour Kelvin: 3000K
Luminous Flux: 1459 lm
CRI (Ra) 80

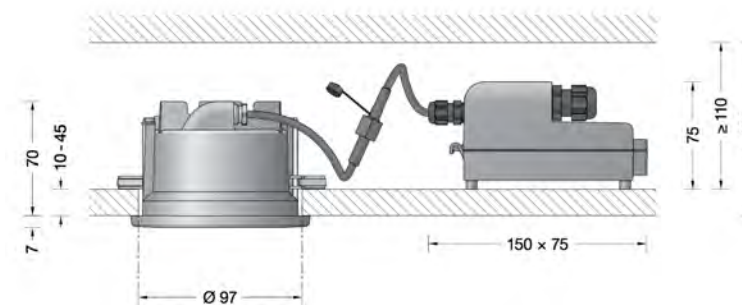

DETAILED LUMINAIRE SCHEDULE

the language of light

Project: Stephenson House – Exterior Lighting
Reference: 0164 – SC2

LUMINAIRE REF:

DL14 – UPDATED 17.07.20

Manufacturer: Bega (supplied by Fagerhult)
Tel: Office: 020 7403 4123 Mobile: 075 8550 9782
Contact: Sam Ashdown Email: sam.ashdown@fagerhult.co.uk

Location: Main Entrance Colonnade
Cat. Reference: **24842 K3 W RAL**
Description: Recessed downlight / wallwash beam / 3000K / IP65
Dimensions: 175 mm diameter
90 mm depth
95 mm recessed depth required
Ceiling cut-out: 160 mm diameter

Accessories: -
Control Gear: Remote driver / DALI dimming
Colour: Custom RAL 9016 Traffic White
CDM/H&S: -
Notes:

Driver dimensions as noted in adjacent image

Maximum Driver Distance: 0.5m – Please locate adjacent to luminaire in ceiling void

Longer driver distances can be requested if required

Circuit Wattage: 19.6 W
Voltage: 176-280 V
Beam Angle: 70/67°
Colour Kelvin: 3000K
Luminous Flux: 1902 lm
CRI (Ra) 80

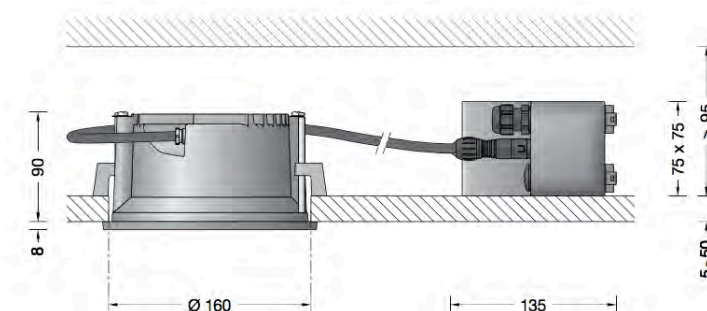



47 Landford Road
London
SW15 1AQ
UK

+44 (0)20 8780 9006
info@studio29lighting.com

studio29lighting.com

