

Dimensions are not to be scaled from this drawing

Luminaire Schedule	City	Label	Arrangement	Description	Lum. Lumens
4	A	SINGLE	20.5w LED 4000K (1 module) 525mA Italo 1 with STE-M Optic column mounted at 6m.	2610	
17	BE	SINGLE	6w LED 4000K Semita Urban bulkhead with cycle optic + Comfort Glass building mounted at 4m.	738	
18	C	SINGLE	17.5w LED 4000K (Deco 2.0) 1m high bollard	700	
7	Existing	SINGLE	20.5w LED 4000K (1 module) 525mA Italo 1 with STE-M Optic column mounted at 6m.	2610	

Calculation Summary	Label	CalcType	Units	Avg	Max	Min	Min/Avg	Min/Max
Building Walkway	1	ILLUMINANCE	Lux	11.26	14	7	0.62	0.50
Pathway	1	ILLUMINANCE	Lux	16.33	33	5	0.31	0.15
Roadway/Highway	1	ILLUMINANCE	Lux	18.90	36	6	0.32	0.17
Top Building Footcandle	1	ILLUMINANCE	Lux	12.86	29	4	0.31	0.14



Kingfisher Lighting

Part of the Luceco PLC group of companies **LUCECO**

BREEAM New Construction 2018 (UK)



Part of the Luceco PLC group of companies **LUCECO**

City	Range	Light Source	Lamp Lumens	Circuit Watts	LowW	LOR	Luminaire Lumens	UCLOR	Upward Lumens	RA	REI (hour per Day)	CCP Calculation for year
11	Italo 1	STE-M 525mA 1 Module	2610	21	129.44	100.0%	2700	0.0%	0	20	12	0.23
17	Semita Urban	6w LED Comfort OC Optic	738	6	122.00	100.0%	1246	0.0%	0	20	12	0.20
18	Deco 2.0 LED	17.5w LED	847	8	112.93	100.0%	1246	13.8%	2104	90	12	0.24

Total Installation Lumens 55482.00 Total UCL 3.80%

Table 1 compliance	Target	Achieved	Status
Environmental zone	E3		Pass
Sky Glow	3.00%	3.00%	Pass
Source Intensity (candelas)	10,000		Pass
Post-curb	3,000		Pass
Light Trespass into windows (E/c)	10		Pass
Pre-curb	2		Pass
Building Luminaire (cd/m²)	10		Pass
Compliance Status			Pass
Site 01	Reduction of night time light pollution		Pass
Site 02	Energy efficient exterior lighting		Pass
Site 03	Internal and external lighting levels		Pass

Kingfisher Lighting Ltd
Ratcliffe Way, Crown Farm Business Park
Mansfield, Nottinghamshire
NG19 0FS

T: +44 (0)1623 415920
E: sales@kingfisherlighting.com
W: www.kingfisherlighting.com

Part of the Luceco plc group of companies **LUCECO**

WAT No. 509145/6-8 Company No. 2235337

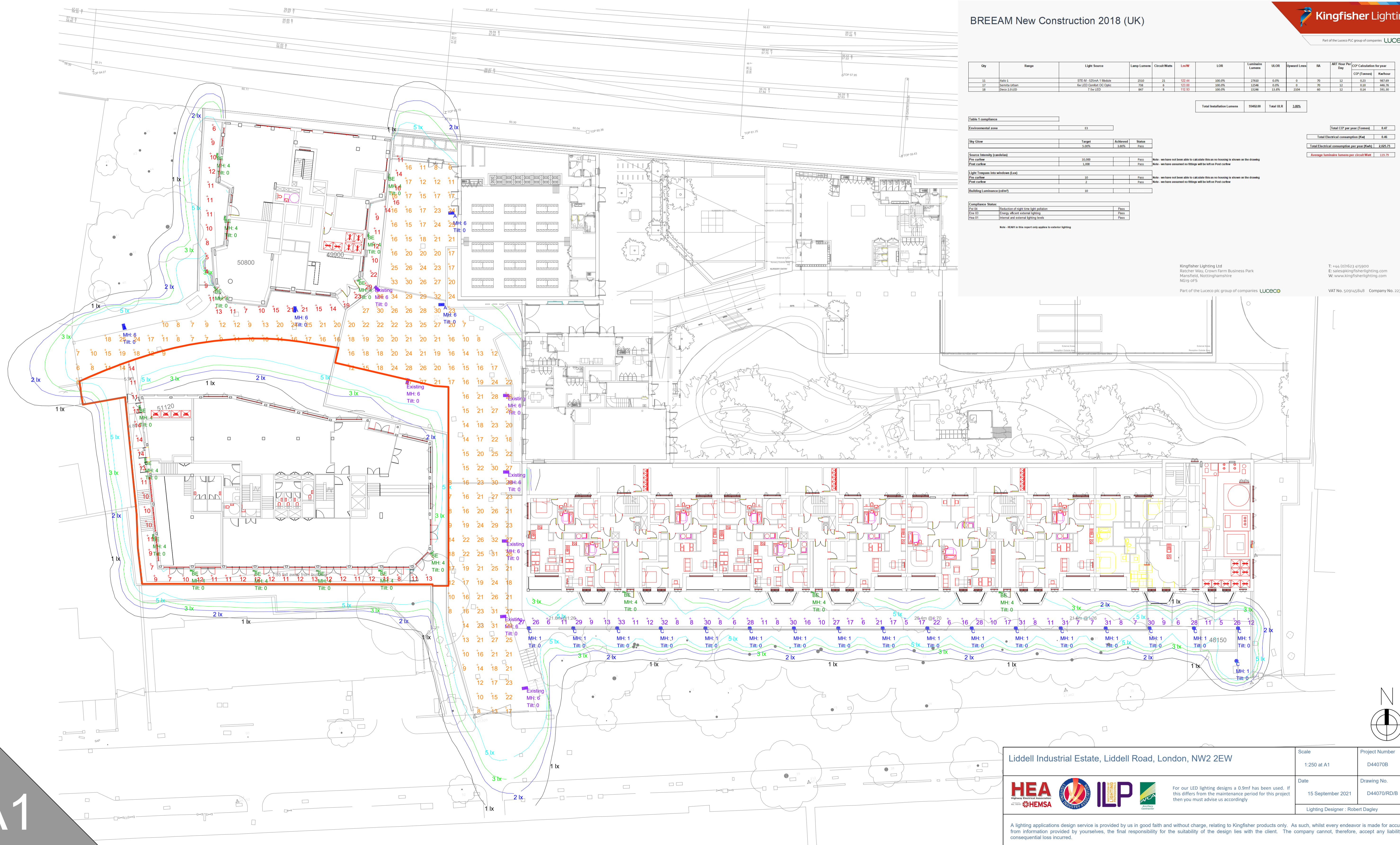

A1

Liddell Industrial Estate, Liddell Road, London, NW2 2EW

Scale: 1:250 at A1 Project Number: D44070B

Date: 15 September 2021 Drawing No.: D44070/RD/B

Lighting Designer: Robert Dagley

HEA **HEMSA** **ILP**

For our LED lighting designs a 0.9m has been used. If this differs from the maintenance period for this project then you must advise us accordingly

A lighting applications design service is provided by us in good faith and without charge, relating to Kingfisher products only. As such, whilst every endeavor is made for accuracy from information provided by yourselves, the final responsibility for the suitability of the design lies with the client. The company cannot, therefore, accept any liability or consequential loss incurred.