

- + Proposed new minimal frame sliding skylight, positioned centrally above existing stair;
- + Providing safer access to roof for maintenance than existing method of access (temporary ladder to external elevation)
- + Providing increased natural ventilation capacity to second floor
- + Providing increased natural light to core of building
- + Set back from roof edge, low profile with minimal frame to reduce visual impact, will not be seen from Swains Lane, refer also to street elevation

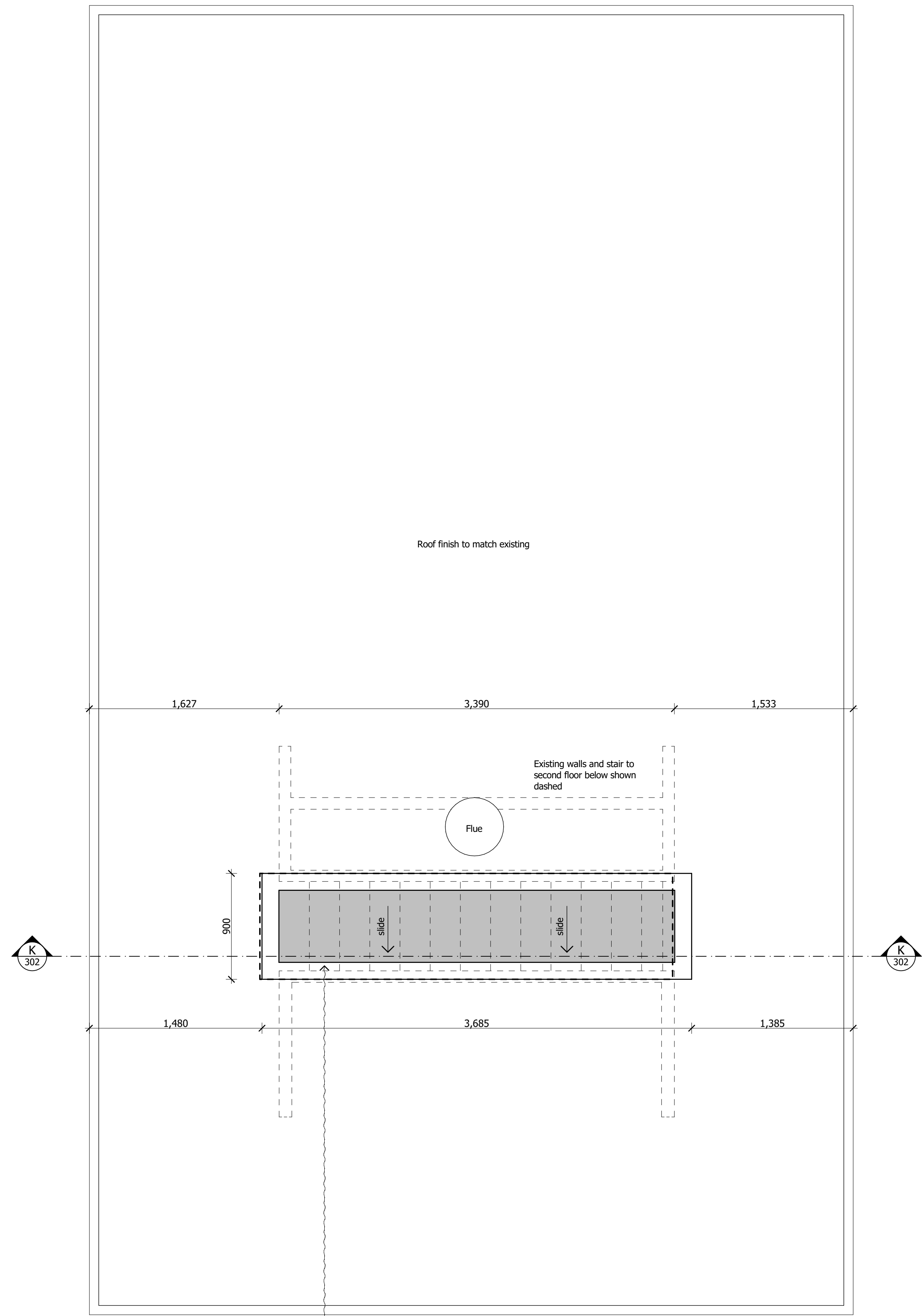

- + Proposed new minimal frame sliding skylight, positioned centrally above existing stair;
- + Providing safer access to roof for maintenance than existing method of access (temporary ladder to external elevation)
- + Providing increased natural ventilation capacity to second floor
- + Providing increased natural light to core of building
- + Set back from roof edge, low profile with minimal frame to reduce visual impact, will not be seen from Swains Lane, refer also to street elevation

DO NOT SCALE FROM THIS DRAWING

Figured dimensions only are to be taken from this drawing. All dimensions are to be checked on site before any work is put in hand.
If in doubt, ask.

All SHH drawings to be read in conjunction with relevant SHH Finishes, Sanitaryware, Lighting & Ironmongery schedules.

Any discrepancies to be highlighted to SHH prior to procurement and in good time.

Copyright © Spence Harris Hogan Limited 2021
Registered in England & Wales. Registered No. 261 0615
SHH is the trading name of Spence Harris Hogan Limited

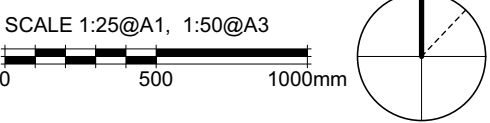

Legends & Notes:

PL01	01.04.2022.	Planning	sm
Rev	Date	Descriptor	Athr.



SHHARCHITECTS|INTERIORDESIGNERS

RIBA 

Chartered Practice

MEMBER

1 Vencourt Place, Ravenscourt Park
Hammersmith, London W6 9NU
Phone +44 (0) 20 8600 4171 Email info@shh.co.uk
shh.co.uk

Project:

Winter House

Client:

Drawing Title:
020 General Arrangements

Proposed Second and Proposed Roof Plan

(Project number)DWG number_Revision:
(828)027_PL01

Checked: