

1 SECTION A-A'
SCALE 1:50

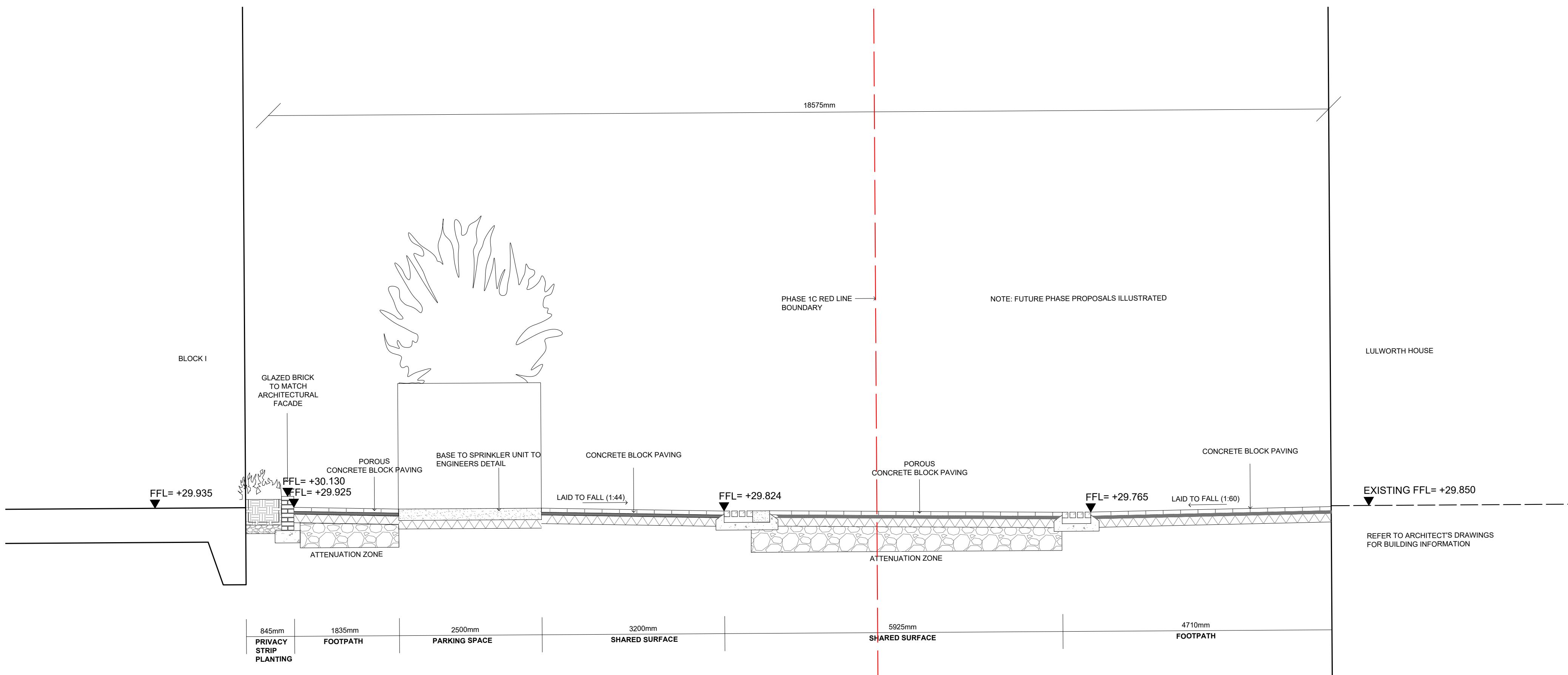

2 SECTION B-B'
SCALE 1:50

- GENERAL NOTES:
- All dimensions and levels to be checked and verified on site before commencing any work or producing shop drawings
 - This drawing is to be read in conjunction with all other relevant drawings, specifications and schedules
 - Any discrepancy concerning the drawings should be referred to the originator / CA immediately
 - All dimensions in millimetres unless noted otherwise
 - All levels in metres
 - Existing service alignments to be checked on site by the contractor on site by the contractor prior to construction work commencing
 - The content of this drawing is to be read in conjunction with the latest project CDM risk register

- NOTES:
- Refer to General Arrangement drawings, Landscape Details and Landscape Specification as cross reference documents for all landscape proposals.
 - Refer to Civil Engineer's details and specification for all proposed paving makeups and drainage. Shown indicatively in Landscape Architect's drawings.
 - Refer to M+E Engineer's details and specification for all utilities and lighting proposals. Shown indicatively in Landscape Architect's drawings.
 - Refer to Structural Engineer's information for all external structures and footings. Shown indicatively in Landscape Architect's drawings.
 - All works to existing trees or within the Root Protection Zone (RPZ) of the existing trees to be carried out in strict accordance with BS 5837:2012. To be read in conjunction with the Arboricultural Impact Assessment (AIA) by Hayden's Arboricultural Consultants.
 - Contractor to make provision for further site investigation to determine the exact extent of existing tree roots and localised level survey at each tree.
 - Please refer to the site wide drawing by Hawkins Brown, reference AGV-HBA-NE-00-DR-A-20-0001 for the Active Site Boundary including proposed hoarding lines.
 - Contractor to allow for positive connections of all tree drains to existing/proposed surface water drainage system or soakaway agreed with Engineer's prior to commencement. Refer to Engineer's details and specification for all structural, services, drainage and pavement makeup requirements.
 - Softworks Details to be read in conjunction with Soiling General Arrangement and Soft Landscape General Arrangement plans AGC377-AL-TZ-1-001 to 004 and AGC377-AL-SW-1-001 to 004 and Plant Schedules.
 - Exact location of aeration pipes to tree pits to be set out on site to allow for correct positioning of tree rootball in tree pits. Shown indicatively only on Landscape Details.

FOR SECTION LOCATIONS REFER TO
DRAWING:
AGC377-GRA-1C-XX-DR-L-1123

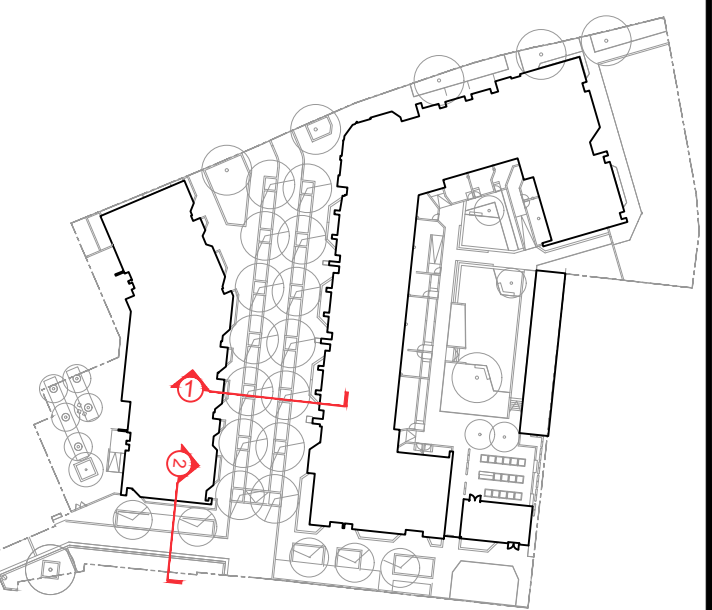

02	08/10/2021	STAGE 4 - FOR APPROVAL	PJ	PC
01	16/09/2021	STAGE 4 - FOR COORDINATION	PJ	PC
00	17/03/2021	STAGE 4 - DRAFT FOR COORDINATION	PJ	PC
Rev.	Date	Description	Drawn	Ch'd

grant associates
Landscape Architecture, Urban Design, Creative Ecology
22 Milk Street, Bath BA1 1UT
T: +44 (0) 1225 332664, F: +44 (0) 1225 420803
E: info@grant-associates.uk.com

CLIENT LB CAMDEN				
PROJECT AGAR GROVE REGENERATION PHASE 1C				
TITLE GENERAL ARRANGEMENT SECTIONS A-A', B-B'				
Scale: 1:50@ A1	Date: 25/06/2019	Drawn: MA	Checked: CH	Approved: PC
Status: STAGE 4 DRAFT				
Drawing Number: AGC377-GRA-1C-XX-DR-L-1321				Rev: 02

S4 – For Stage Approval