

revision / date / amendments
- / 25/10/21 / FIRST ISSUE

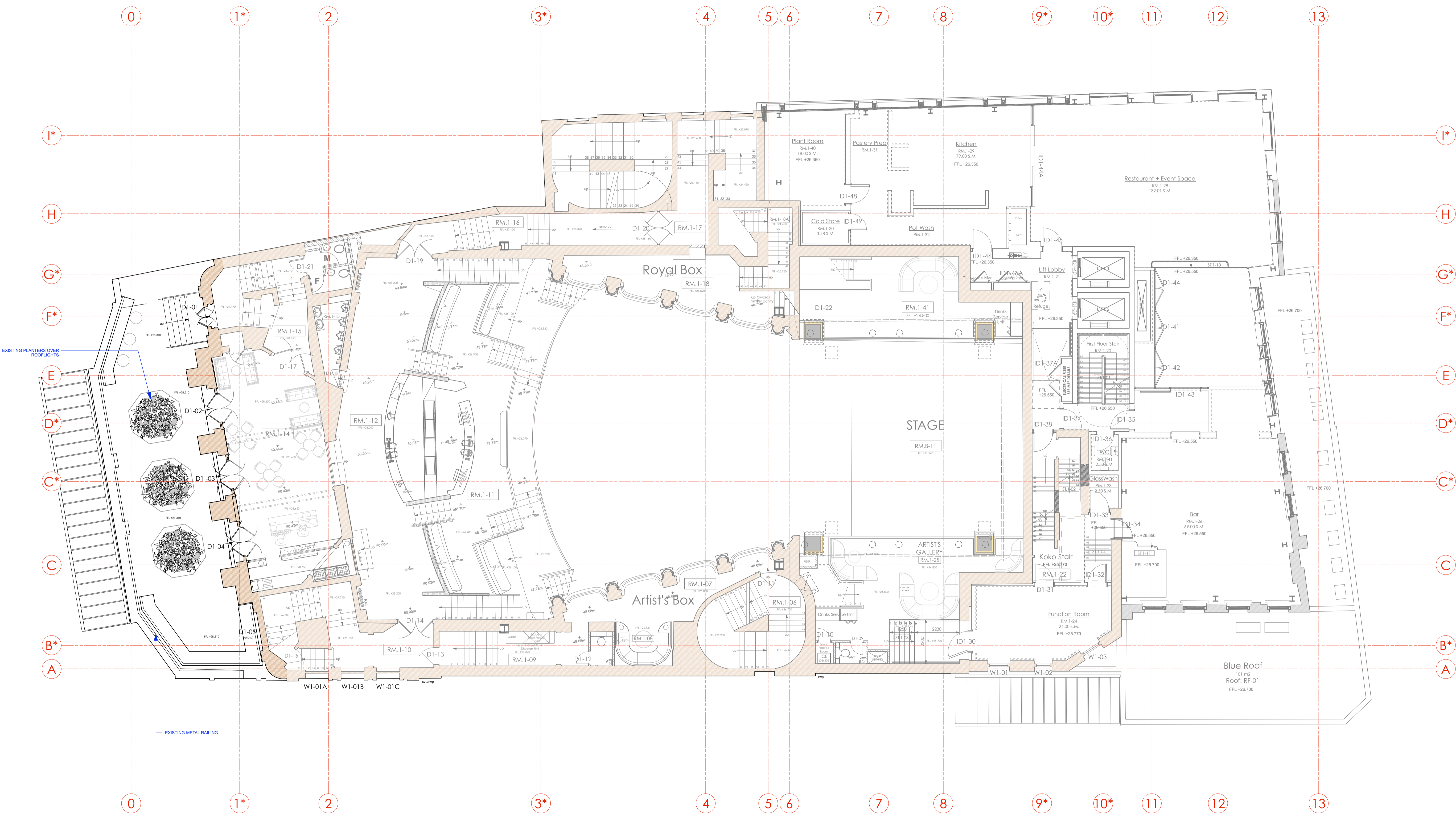

LEGEND
 Existing Building Fabric KOKO née Camden Palace Theatre (1900)

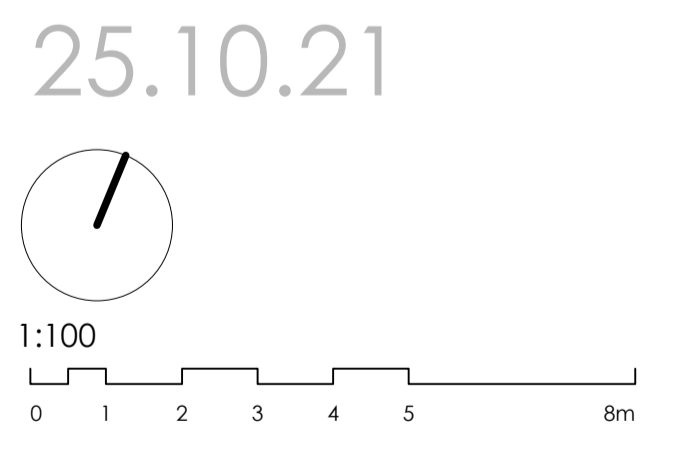

PLANNING

Archer Humphryes Architects

Basement
 Central House
 142 Central Street
 London, United Kingdom
 EC1V 8AR
 T: +44 (0) 20 7251 8555

project title KOKO + Hope & Anchor + Bayham Place, Camden, London	
drawing title Existing First Floor Plan Signage + Lighting	scale / date 1:100 / 01.10.20
drawing number AHA/ KKS / EX / 101	drawn / checked / revision FR / DA / -