

Copyright: All rights reserved. This drawing must not be reproduced without permission.

Only the original drawing should be relied upon. Contractors, subcontractors and suppliers must verify all dimensions on site before commencing any work or making any shop drawings.

All shop drawings to be submitted to the architect for comment prior to fabrication.

This drawing is to be read in conjunction with the Architect's specification, bills of quantities / schedules, structural, mechanical & electrical drawings and all discrepancies are to be reported to the architect.

Do not scale from this drawing. Dimensions are in millimetres unless otherwise stated.

revision / date / amendments  
- / 19.01.2022 / First Issue

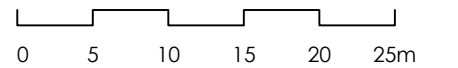
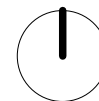
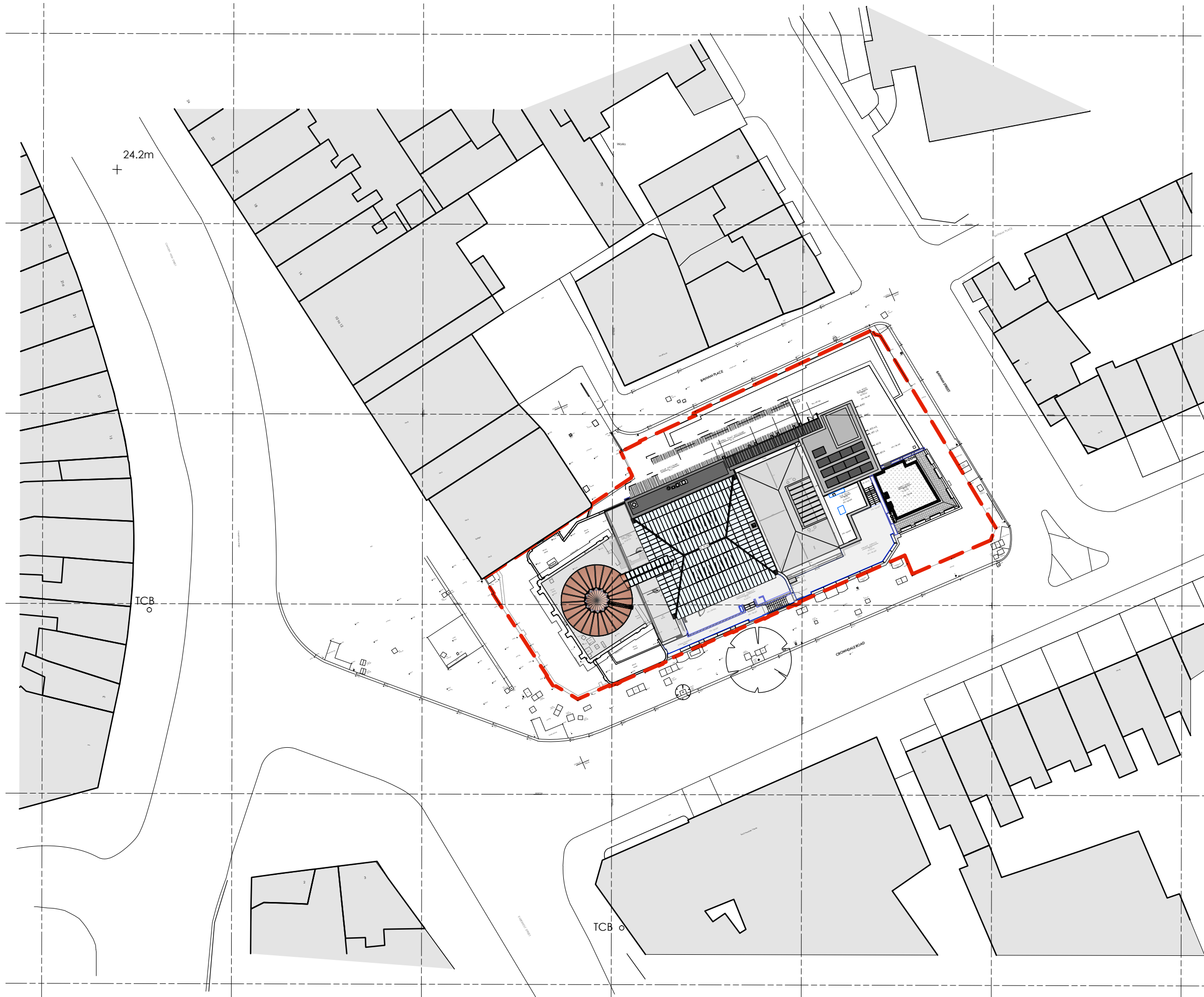

## PLANNING

Archer Humphryes Architects

Basement  
Central House  
142 Central Street  
London, United Kingdom  
EC1V 8AR  
T: +44 (0) 20 7251 8555

project title		
KOKO + Hope & Anchor + Bayham Pl. Camden, London		
drawing title	scale	date
Existing Block Plan	1:500 @ A3	25.10.21
	drawn FR	checked DA
drawing number	revision	
AHA/ KKS / EX /0002	-	