

**Important note**

All dimensions in millimetres. Where dimensions are not given, drawings must not be scaled and the matter referred back to Charlton Brown Architects.

All dimensions and conditions are to be checked on site by the contractor prior to preparing drawings or commencing any work. The contractor is responsible for checking that there is no conflict between site dimensions and drawn dimensions.

In the event of any detail or dimensional conflict between Charlton Brown Architects drawings, the matter must be referred back to Charlton Brown Architects for clarification

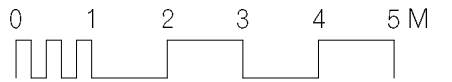
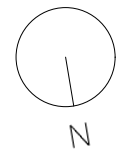
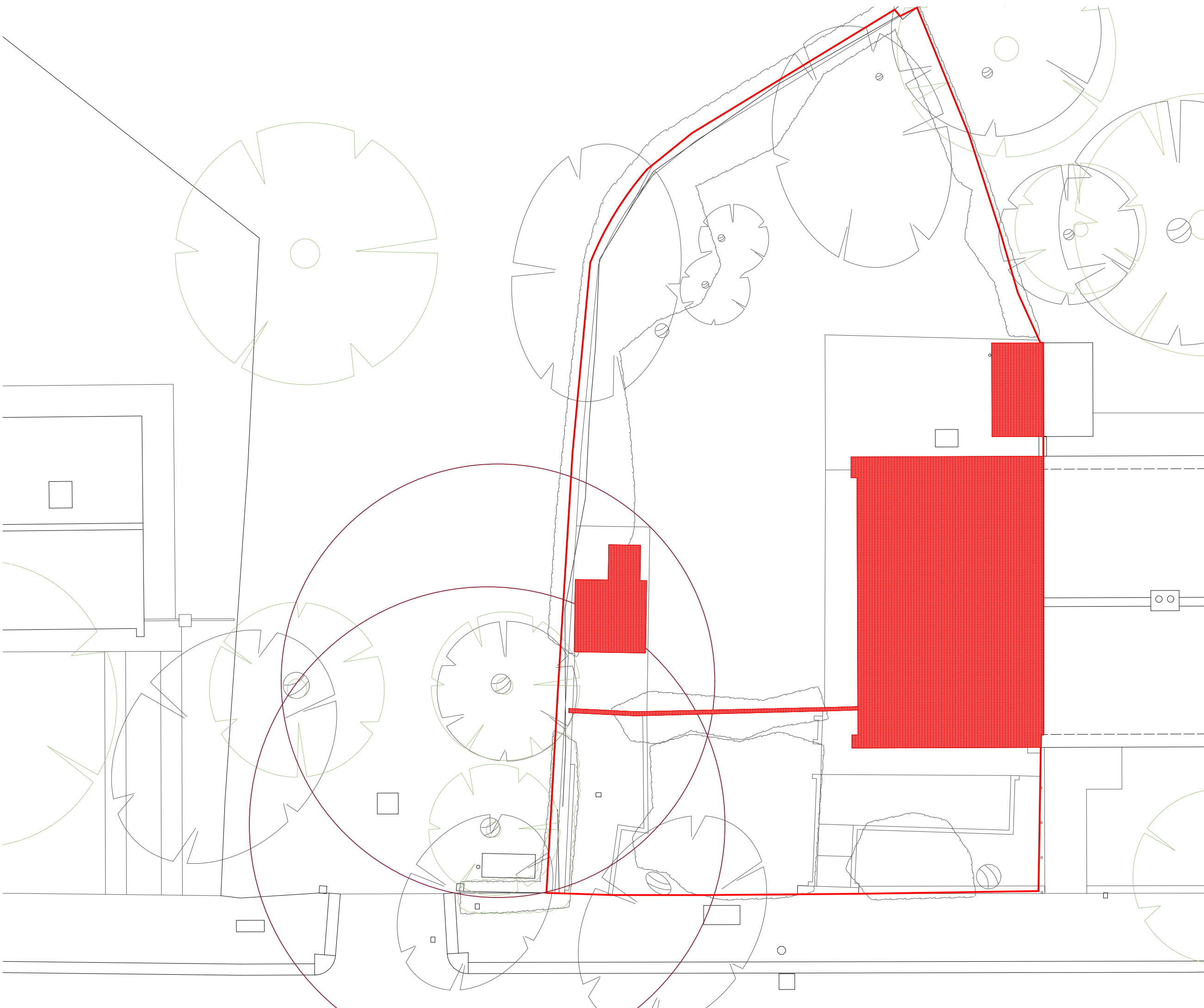

Rev	Date	Details	By

**Charlton Brown  
Architecture & Interiors**

The Belvedere, 2 Back Lane, Hampstead, London, NW3 1HL  
 Telephone +44(0)20 7794 1234  
 Email office@charltonbrown.com  
 Website www.charltonbrown.com

Client  
**Alma Flores and Jeremie Berton**

Project  
**13 Kemplay Road**

Drawing Title  
**Demolition plan**

Date	Drawn	Checked
11/03/2022	JK	DB

Scale  
**1:100**

Issue Status  
**For Planning**

Project Number	Drawing Number	Revision
1923	EX-00-111	